

FED. ROAD REG. NO.	STATE	FEDERAL AID PROJECT NO.	SHEET NO.	TOTAL SHEETS
I	N.Y.		9/3	15
DELAWARE PT. 2, S.H. 41				
ALBANY COUNTY				

DESIGNED BY: *Ray H. Collette* DATED: 3-27-75
 CHECKED BY: *William J. Kelly* DATED: 3-27-75
 REVIEWED BY: *J. J. Smith* DATED: 4-1-75
 IN CHARGE OF: *Ray H. Collette*

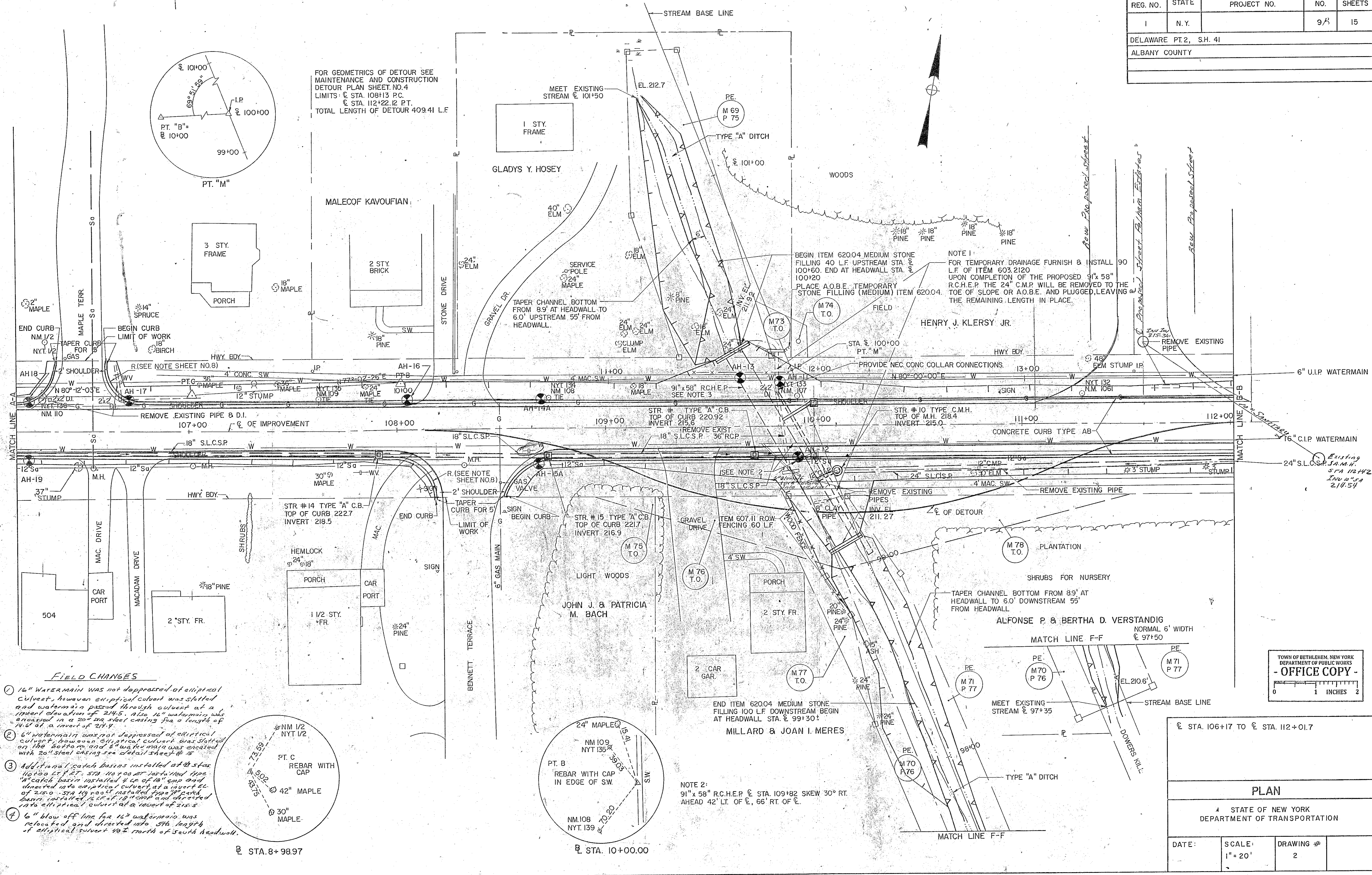

FOR GEOMETRICS OF DETOUR SEE
 MAINTENANCE AND CONSTRUCTION
 DETOUR PLAN SHEET NO. 4
 LIMITS: @ STA. 108+13 P.C.
 @ STA. 112+22.12 P.T.
 TOTAL LENGTH OF DETOUR 409.41 L.F.

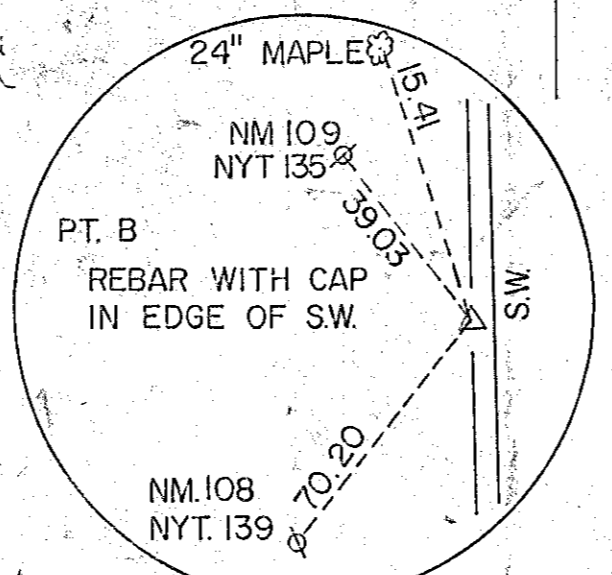
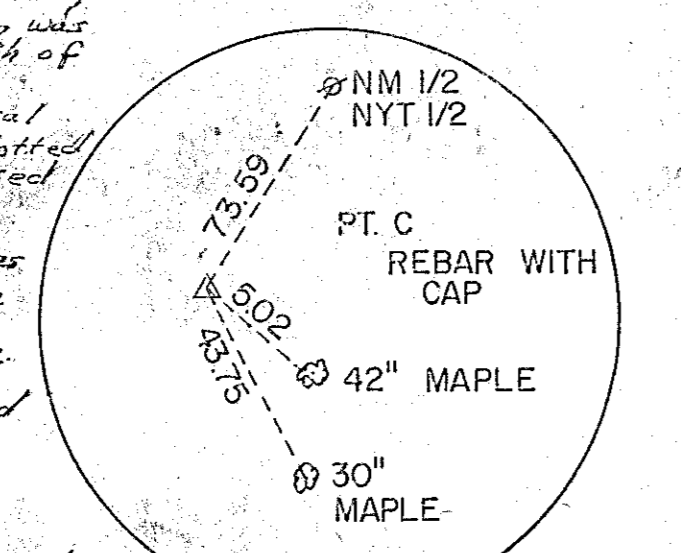
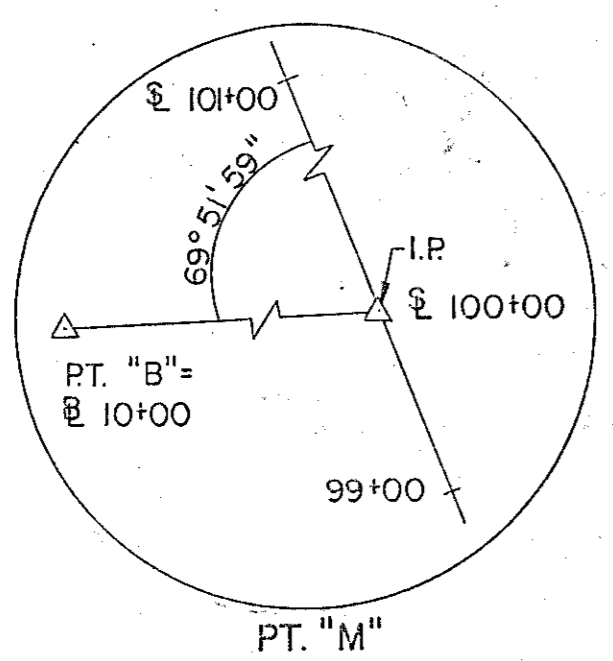

- FIELD CHANGES**
- 16" Watermain was not depressed at elliptical culvert, however elliptical culvert was slotted and watermain passed through culvert at a invert elevation of 214.5. Also 16" watermain was encased in a 20" dia steel casing for a length of 14.6' at a invert of 214.4.
 - 6" watermain was not depressed at elliptical culvert, however elliptical culvert was slotted on the bottom and 6" watermain was encased with 20" steel casing see detail sheet # 15.
 - Additional catch basins installed at 107+00 and 108+00. At 107+00 installed type "A" catch basin installed 4' of 18" c.m.p. and directed into elliptical culvert, at a invert of 215.0. At 108+00 installed type "A" catch basin installed 12' of 18" c.m.p. and directed into elliptical culvert at a invert of 215.5.
 - 6" blow off line for 16" watermain was relocated and directed into 5th length of elliptical culvert 10' north of south headwall.

TOWN OF BETHLEHEM, NEW YORK
 DEPARTMENT OF PUBLIC WORKS
OFFICE COPY
 0 1 INCHES 2

@ STA. 106+17 TO @ STA. 112+01.7			
PLAN			
STATE OF NEW YORK DEPARTMENT OF TRANSPORTATION			
DATE:	SCALE:	DRAWING #	
	1" = 20'	2	