

GENERAL NOTES

- A. DASHED LINES: INDICATE EXISTING ELECTRICAL ITEMS TO REMAIN UNLESS NOTED OTHERWISE.
- B. SOLID LINES: INDICATE NEW ELECTRICAL WORK.
- C. OTHER UTILITIES: COORDINATE ALL ELECTRICAL SITE WORK WITH OTHER SITE AND UNDERGROUND UTILITIES, SEE WORK AND LANDSCAPE DRAWINGS FOR SITE LAYOUT, GRADING, UTILITY WORK, ETC.
- D. PROTECT EXISTING UNDERGROUND UTILITIES: PRIOR TO DIGGING OR PROVISIONING, FIELD VERIFY, MARK LOCATIONS AND PROTECT ALL EXISTING UNDERGROUND UTILITIES.
- E. CONDUIT BURIAL DEPTH: INSTALL ALL UNDERGROUND ELECTRICAL CONDUITS AT 30" BELOW FINISHED GRADE, UNLESS INDICATED OTHERWISE.
- F. MINIMUM CONDUIT SIZE: ALL UNDERGROUND ELECTRICAL CONDUITS TO BE MINIMUM 1" SIZE, LARGER AS INDICATED OR REQUIRED.
- G. OWNER'S TELECOMMUNICATION CABLES: NOT IN CONTRACT, NOT SHOWN, PROVIDE CONDUITS AND BOXES INDICATED.
- H. LIGHTING POLE BASES: PROVIDE POLE BASE FOR EACH SITE LIGHTING FIXTURE, SEE DETAILS ON SITE DRAWINGS.

KEYED NOTES

- 1. EXISTING UTILITY COMPANY UNDERGROUND PRIMARY ELECTRIC, TELEPHONE AND CATV LINES.
- 2. EXISTING N-GRID PAD MOUNTED PRIMARY SWITCHGEAR.
- 3. EXISTING N-GRID PRIMARY JUNCTION PAD.
- 4. EXISTING TELCO AND/OR CATV FEEDSTALS(S).
- 5. EXISTING N-GRID URD 1-PHASE PAD MOUNTED TRANSFORMER.
- 6. NEW UTILITY COMPANY UNDERGROUND PRIMARY ELECTRIC, TELEPHONE AND CATV LINES.
- 7. (3) 4" SCHEDULE 80 PVC ROAD CROSSING CONDUITS FOR PRIMARY OR SECONDARY ELECTRIC AND TELEPHONE AND CATV LINES (TYPICAL).
- 8. NEW N-GRID URD 1-PHASE PAD MOUNTED TRANSFORMER, WITH SECONDARY HAND HOLE (PLUS TELCO AND CATV FEEDSTALS).
- 9. UNDERGROUND SECONDARY SERVICE LATERAL: 2" SCHEDULE 40 PVC CONDUIT WITH 3 #4/0 (PLUS UTILITY COMPANY TELEPHONE AND CATV LINES).
- 10. 120/240 VOLT, 1-PHASE, 3-WIRE, 200A NEMA-3R TWO-GANG (VERTICAL STACK) METER SOCKET WITH 125A METER (MAXIMUM 12" WIDE).
- 11. UNDERGROUND SECONDARY SERVICE LATERAL: 1-1/4" SCHEDULE 40 PVC CONDUIT WITH 3 #2.
- 12. 120/240V, 1-PHASE, 3-WIRE, NEMA-3R COMBINATION METER SOCKET AND LOAD CENTER, WITH 125A METER SOCKET, 100A MAIN BREAKER, 12-POLE LOAD CENTER, WITH 20A/2P CB FOR WET LOCATIONS, 30A/2P CB FOR GRINDER PUMP STATION, 30A/2P CB FOR TELCO AND CATV AERATOR, PLUS TWO 20A/1P AND ONE 20A/2P SPARE CB'S.
- 13. PROVIDE 1-1/4" SCHEDULE 80 PVC CONDUIT WITH 3 #10 + 1 #0G FROM LOAD CENTER (30A/2P CB) TO GRINDER PUMP CONTROL PANEL (CP FURNISHED WITH PUMP).
- 14. PROVIDE 1-1/4" SCHEDULE 80 PVC CONDUIT FROM GRINDER PUMP CONTROL PANEL TO GRINDER PUMP STATION, INSTALL TWO PUMP POWER/CONTROL CABLES (FURNISHED WITH PUMP), TERMINATE AT EACH END, AND SEAL CONDUIT AT EACH END.
- 15. 1-1/4" SCHEDULE 80 PVC CONDUIT WITH 2 #8 (STREET LIGHTS), 2 #8 (AERATOR), 2 #8 (SPARES) + 1 #8G.
- 16. 1-1/4" SCHEDULE 80 PVC CONDUIT WITH 2 #8 (STREET LIGHTS), 2 #8 (SPARES) + 1 #8G.
- 17. 1-1/4" SCHEDULE 80 PVC CONDUIT WITH 2 #8 (AERATOR), 2 #8 (SPARES) + 1 #8G. STUB UP AT SAFETY SWITCH WITH RGS CONDUIT.
- 18. 240V, 30A/2P + 3 NEMA-3R HEAVY DUTY SAFETY SWITCH FOR DETENTION POND AERATOR.
- 19. PROVIDE 1-1/4" SCHEDULE 80 PVC CONDUIT TO 20' PAST DRAINAGE PIPE (STUB UP AT SAFETY SWITCH WITH RGS CONDUIT). INSTALL AERATOR POWER CABLE FROM AERATOR TO CONDUIT. PROVIDE 1" PULL BOX AT EACH END. PROVIDE 1" PULL BOX (20' LENGTH) SUPPLIED WITH KEYS, BEFORE PROCEEDING. CONDUIT SIZE IS ADEQUATE FOR CABLE, BEFORE PROCEEDING.
- 20. EXISTING TELECOMMUNICATIONS AND FIRE ALARM IN-GRADE PULL BOX. CONFIRM EXACT LOCATION.
- 21. NEW MINIMUM 1" X 18" IN-GRADE PULL BOX.
- 22. TWO 2-1/2" SCHEDULE 80 PVC CONDUITS, ONE WITH REQUIRED FIRE ALARM CABLES FROM NEW FACP IN BEVERWYCK PHASE III, TERRACE BUILDING TO EACH COTTAGE; THE SECOND RESERVED FOR OWNER PROVIDED TELECOMMUNICATIONS CABLES.
- 23. TWO 1-1/2" SCHEDULE 80 PVC CONDUITS, ONE WITH REQUIRED FIRE ALARM CABLE FROM NEW FACP IN BEVERWYCK PHASE III, TERRACE BUILDING TO EACH COTTAGE; THE SECOND RESERVED FOR OWNER PROVIDED TELECOMMUNICATIONS CABLES.
- 24. COTTAGE TELECOMMUNICATIONS AND FIRE ALARM TERMINAL BOX IN GARAGE. SEE COTTAGE ELECTRICAL DRAWINGS.

Angerme
Architects, P.C.

Architecture
Planning
Interior Design

30 Essex St.
Albany
New York 12206 - 2027
P 518 454 9300
F 518 454 9333
W www.angerme.com

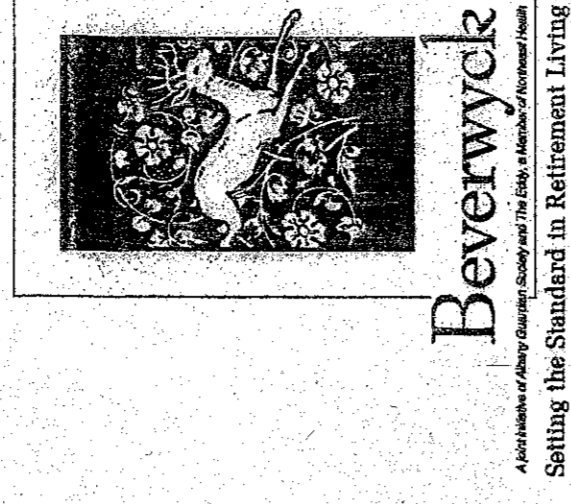

PHASE IV COTTAGES

Beverwyck, Inc.
40 Autumn Drive
Slingerlands, New York 12159

Consultants

Civil:
Brett Steenburgh, P.E., P.L.L.C.
2932 Rosendale Road, Niskayuna, NY 12304
Phone: (518) 565-0675
Landscape Architect:
Miller Associates
164 Haviland Road, Queensbury, NY 12304
Phone: (518) 742-4455 Fax: (518) 742-8511

Electrical:

MAC Engineering
P.O. Box 688, Round Lake, NY 12151
Phone: (518) 844-0000 Fax: (518) 844-0002

Revisions:

-FOR REFERENCE ONLY-

Title
SITE ELECTRICAL PLAN-PART A

Do not scale drawings - see dimension lines for dimensions. All dimensions are in feet unless otherwise noted. This drawing is the property of the Designer and shall not be reproduced, stored in a retrieval system, or transmitted in any form or by any means, electronic, mechanical, photocopying, recording, or by any information storage and retrieval system, without the prior written consent of the Designer, P.C.

Drawing Number

E-101

Date: **APRIL 17, 2006**

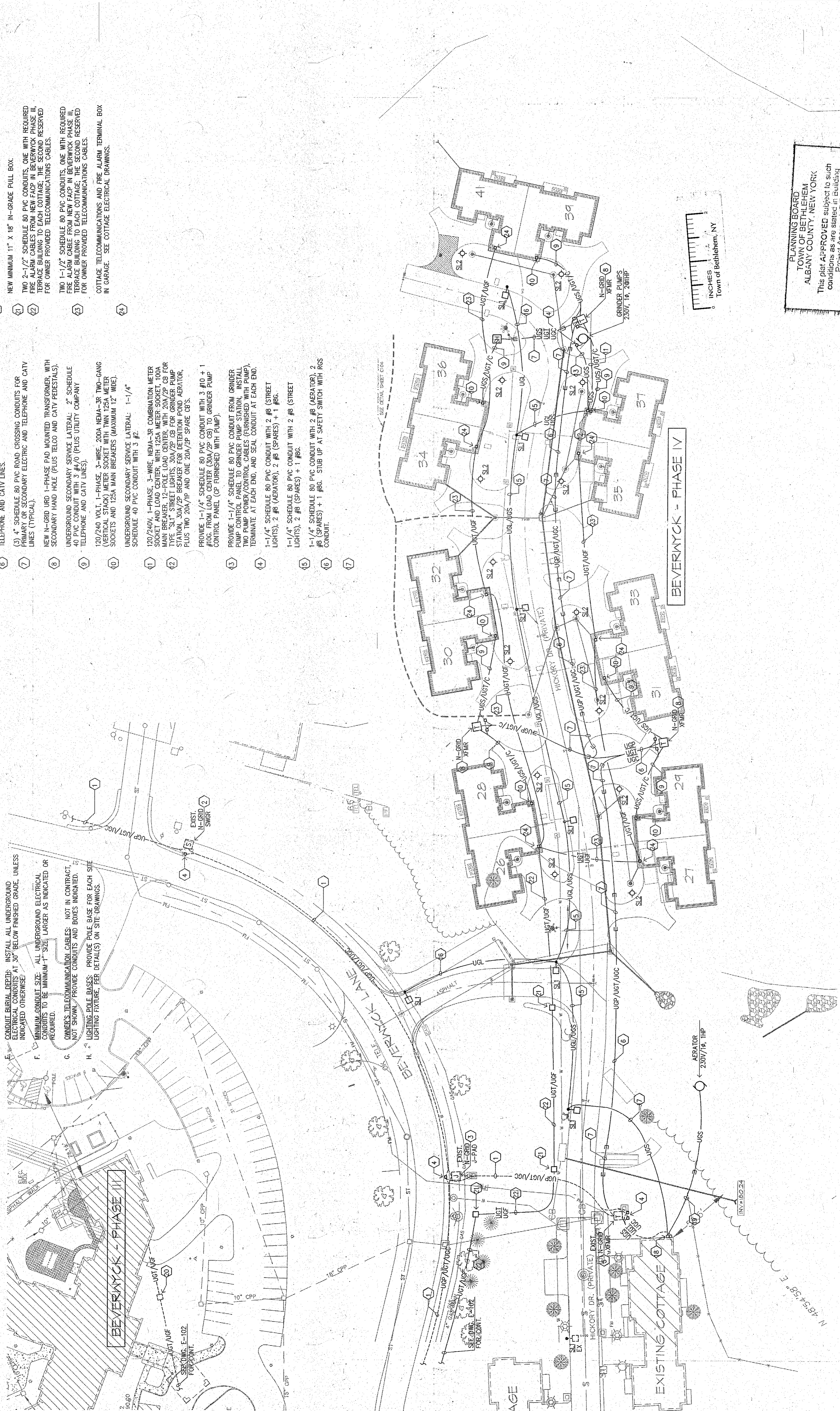

BEVERWYCK - PHASE IV

PLANNING BOARD
TOWN OF BETHLEHEM
ALBANY COUNTY, NEW YORK
This plan APPROVED subject to such conditions as are stated in existing Project Approval (B/P/A) No. 2005-26 Dated 3-7-06
Approved: [Signature] Date: [Signature]
Title: [Signature]
Date: [Signature]

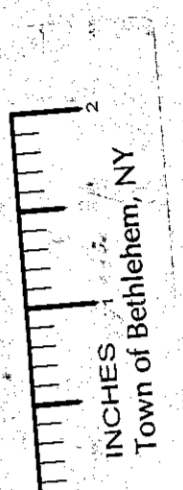

SITE ELECTRICAL PLAN-PART A
SCALE: 1" = 40'-0"

1
E-101