

- NOTES**
1. ALL UNDERGROUND UTILITIES ARE SHOWN IN THEIR RELATIVE POSITION AND ARE FOR INFORMATION ONLY. THEIR EXACT LOCATION SHALL BE CHECKED AT THE SITE BEFORE CONSTRUCTION BEGINS.
  2. SEWER MAINS IN RELATION TO WATER MAINS: WHERE POSSIBLE, SEWER SHALL BE LAID AT LEAST 10 FEET HORIZONTALLY FROM ANY EXISTING OR PROPOSED WATER MAIN. VERTICAL SEPARATION SHALL BE MAINTAINED TO PROVIDE UNOBTAINED INCHES BETWEEN TOP OF SEWER AND THE INVERT OF THE WATER MAIN AT UTILITY CROSSINGS. WHEN IMPASSIBLE TO OBTAIN THE PROPER VERTICAL SEPARATION, PRESSURE RATED PIPE SHALL BE USED (10 FEET) FEET ON EACH SIDE OF THE WATER MAIN BEING CROSSED.
  3. A 3 FEET SEPARATION WILL BE MAINTAINED BETWEEN CATCH BASINS AND WATER MAIN.
  4. CONTRACTOR SHALL RESTORE LAWNS, DRIVEWAYS, WALLS, CURBS, FENCES ETC. TO A CONDITION AT LEAST AS GOOD AS THEY WERE BEFORE BEING OBTURED. MAILBOXES, POSTS, ETC. SHALL BE PROTECTED OR REMOVED AND REPLACED EXACTLY AS THEY WERE BEFORE BEING DISTURBED. DAMAGED ITEMS SHALL BE REPLACED AT THE CONTRACTOR'S EXPENSE.
  5. BOX ALL TREES AND HOUSE ALL SHRUBS & HEDGES BEFORE PLACING EARTH AGAINST OR NEAR THEM. SHRUBS & HEDGES WHICH MUST BE REMOVED DURING CONSTRUCTION SHALL BE HEAVED AND REPLANTED IN AS GOOD A CONDITION AS THEY WERE BEFORE THEIR REMOVAL AND DAMAGED TREES, SHRUBS AND/OR HEDGES SHALL BE REPLACED AT THE CONTRACTOR'S EXPENSE.
  6. NO WORK, STORAGE OR TRESPASS SHALL BE PERMITTED BEYOND THE BOUNDARIES OF ANY EASEMENTS.

**1 PLAN - ELM AVENUE EAST WATER CONNECTION WEST STA 0+00 TO 14+18**  
 SCALE: 1" = 50'  
 CROSS REFERENCE: NONE

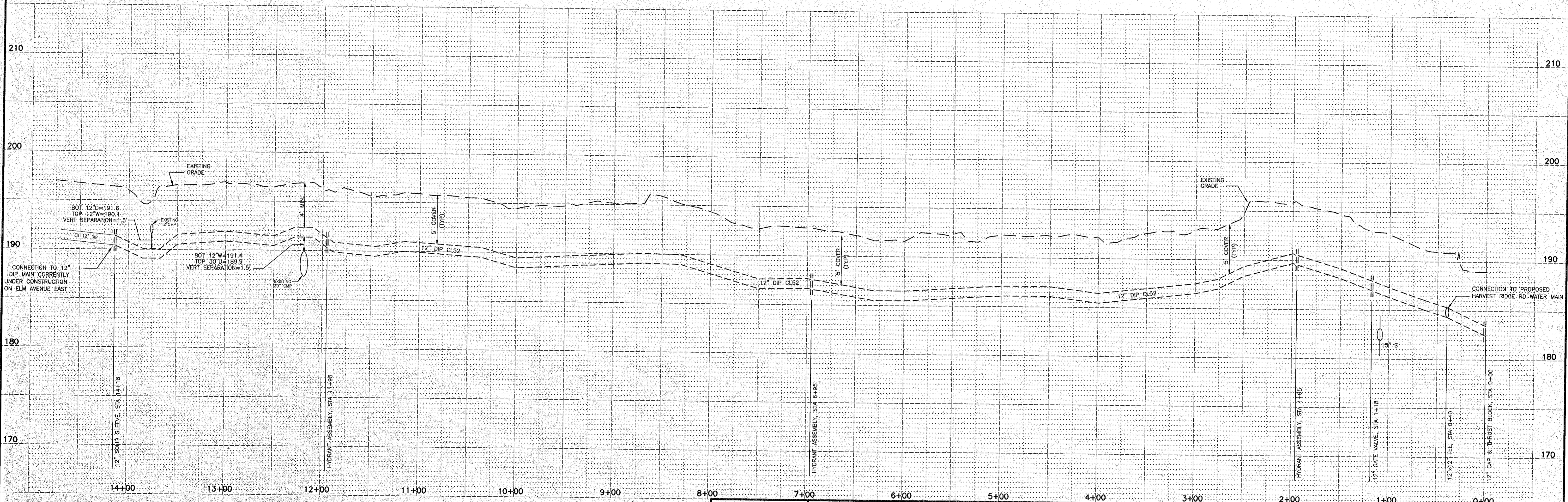

**2 PROFILE - ELM AVENUE EAST WATER CONNECTION - WEST STA 0+00 TO 14+18**  
 SCALE: HORIZ. 1" = 50'  
 VERT. 1" = 5'  
 CROSS REFERENCE: NONE

APPLICANT/OWNER/DEVELOPER  
 SLINGERLANDS GROUP, LTD.  
 835 KENWOOD AVENUE  
 SLINGERLANDS, NY 12159

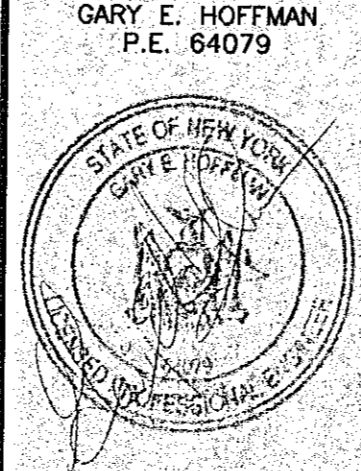
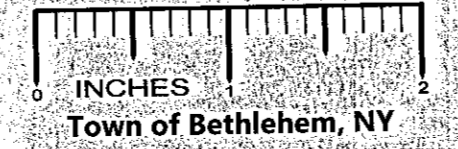

DATE	REVISIONS RECORD/ DESCRIPTION	DRAFTER	CHECK	APPR.
12/18/98	REVISIONS PER T/O BETHLEHEM 11/24/98 LETTER	JAM	GEH	
2/10/99	REVISIONS PER T/O BETHLEHEM 2/2/99 LETTER	JAM	GEH	
5/18/99	REVISIONS PER T/O BETHLEHEM 5/13/99 LETTER	JAM	GEH	
5/27/99	REVISIONS PER T/O BETHLEHEM 5/26/99 LETTER	JAM	GEH	
9/8/99	REVISED PER ACHD COMMENTS	JAM	GEH	

**PLAN / PROFILE  
 ELM AVENUE EAST - WATER CONNECTION**

**DOWERSKILL VILLAGE  
 PLANNED RESIDENCE DISTRICT NO. 4 , SECTION 3**

TOWN OF BETHLEHEM ALBANY COUNTY, NY

UNAUTHORIZED ALTERATION OR ADDITION TO THIS DOCUMENT IS A VIOLATION OF SECTION 7209 SUBDIVISION 2 OF THE NEW YORK STATE EDUCATION LAW.

© 1998  
 C.T. MALE ASSOCIATES P.C.

PROJ. NO: 93.2699  
 DESIGNED: KRV  
 DRAFTED: JAM  
 CHECKED: GEH

**C.T. MALE ASSOCIATES, P.C.**  
 50 CENTURY HILL DRIVE, P.O. BOX 727, LATHAM, NY 12110  
 518.786.7400 • FAX 518.786.7299

ARCHITECTURE & BUILDING SYSTEMS ENGINEERING • CIVIL ENGINEERING  
 ENVIRONMENTAL SERVICES • SURVEY & LAND INFORMATION SERVICES

SCALE: AS SHOWN  
 SHEET 35 OF 36  
 DATE: APRIL 2, 1998  
 DWG. NO: 90-439

CAD DWG. FILE NAME: PP-EA-WWDWG