

NEW YORK STATE ROUTE 396

NY STATE HIGHWAY - US ROUTE 9W

UNDEVELOPED LANDS OF SUTTON

MILLER AVENUE

NEIL BLVD.

(FUTURE STREET)

BLVD.

NOTE
THE FORMER MILLER SUBDIVISION LOTS SHOWN ABOVE WERE NOT INCLUDED IN THE PRELIMINARY APPROVAL FOR "20 ACRES" GRANTED JUNE 3, 1969.

LANDS CONVEYED TO JOHN R. AND AGNES M. GOOD JULY 26, 1961 BK1276 PG. 477

PARCEL 42 R-2 ACQUIRED FOR CONSTRUCTION OF RAVENA-BECKERS CORNERS STATE HIGHWAY DATED APRIL 1, 1930 AND FILED AS MAP 26, DRAWER 64,800X.64 VOLUME 2

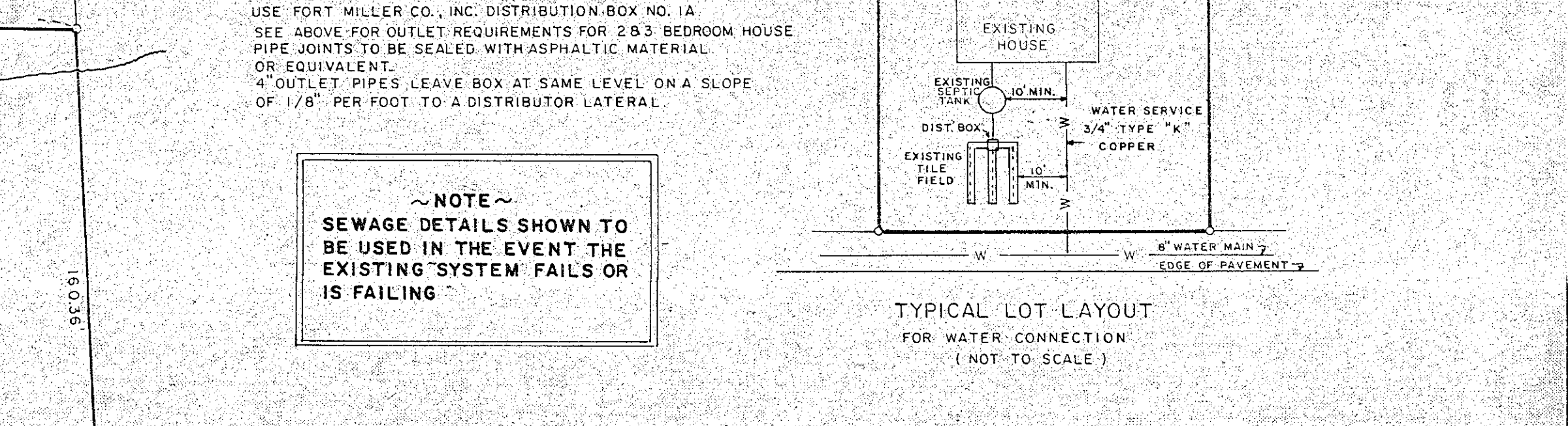
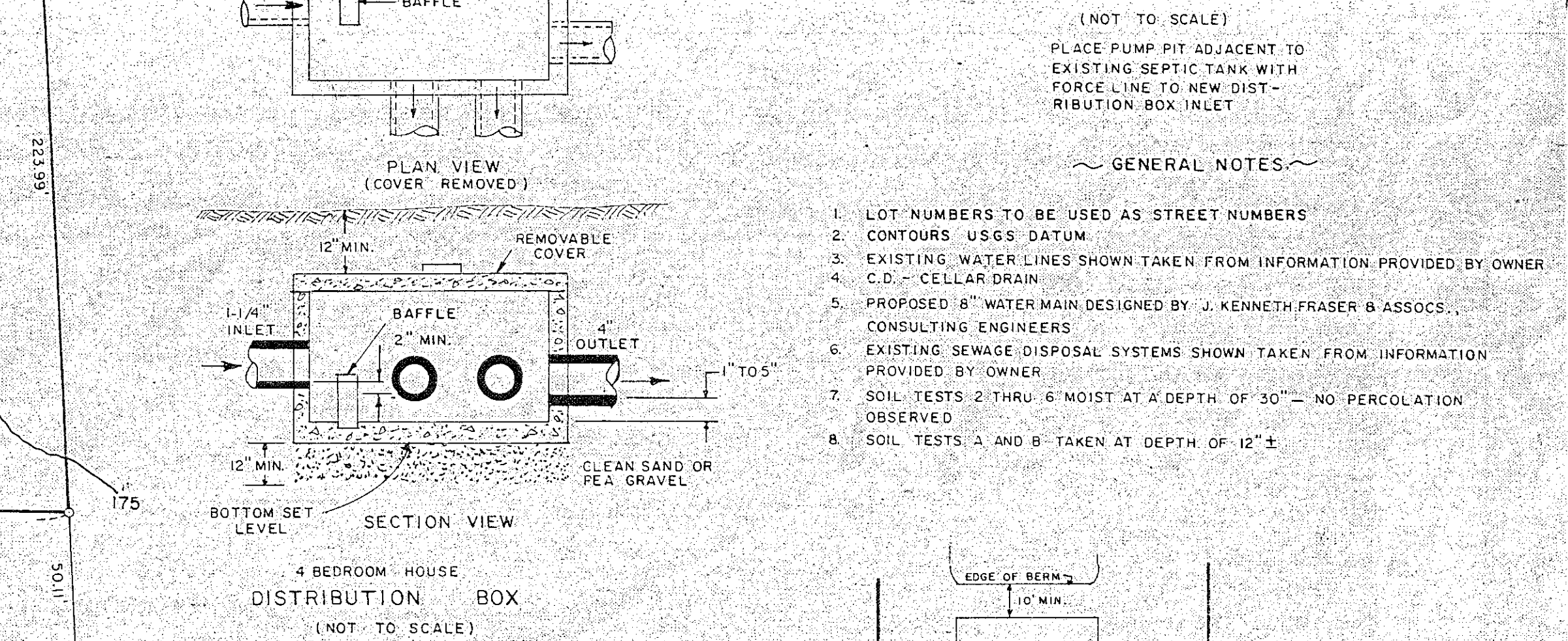
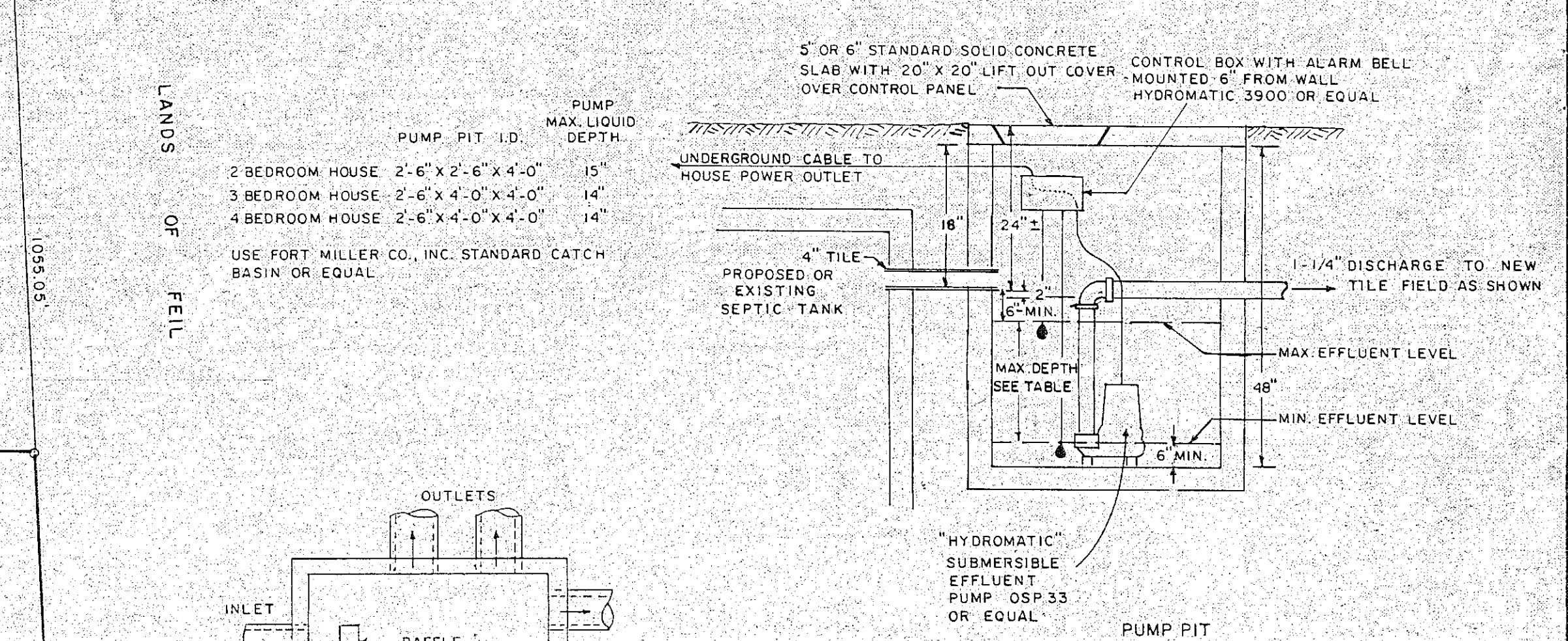
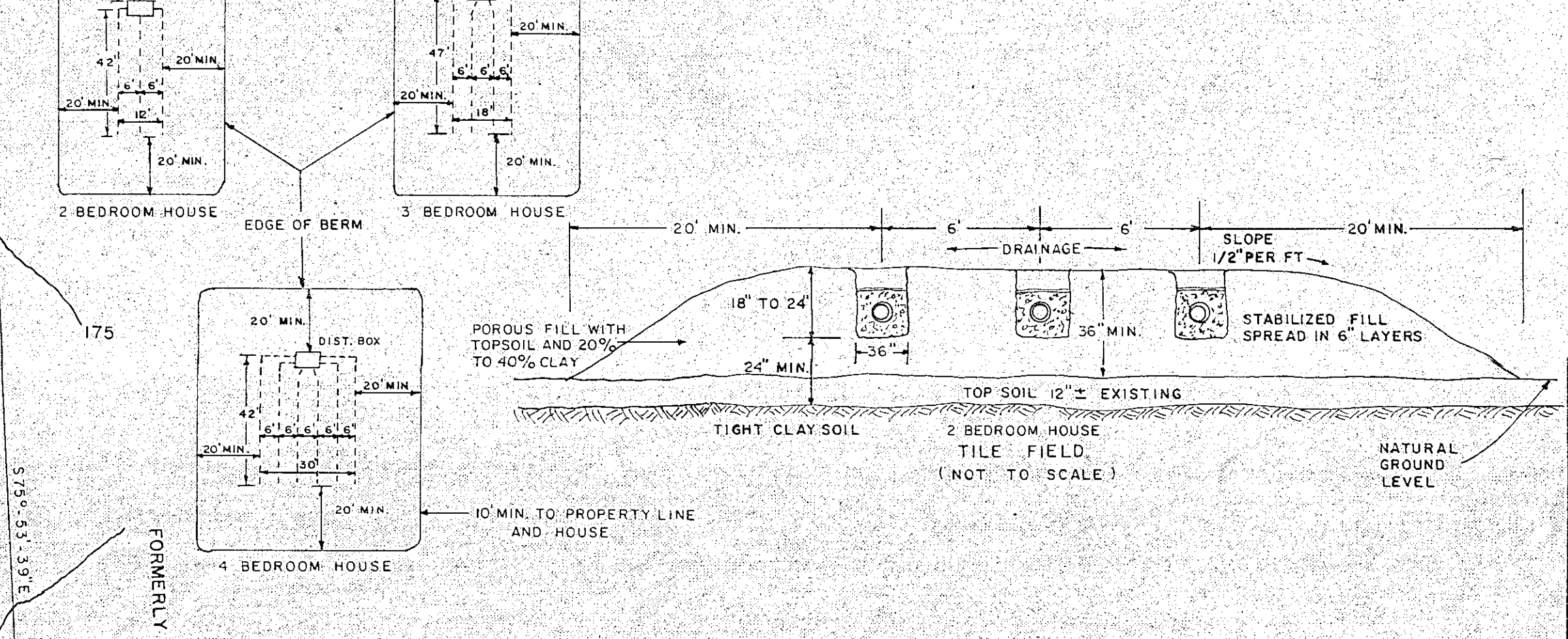
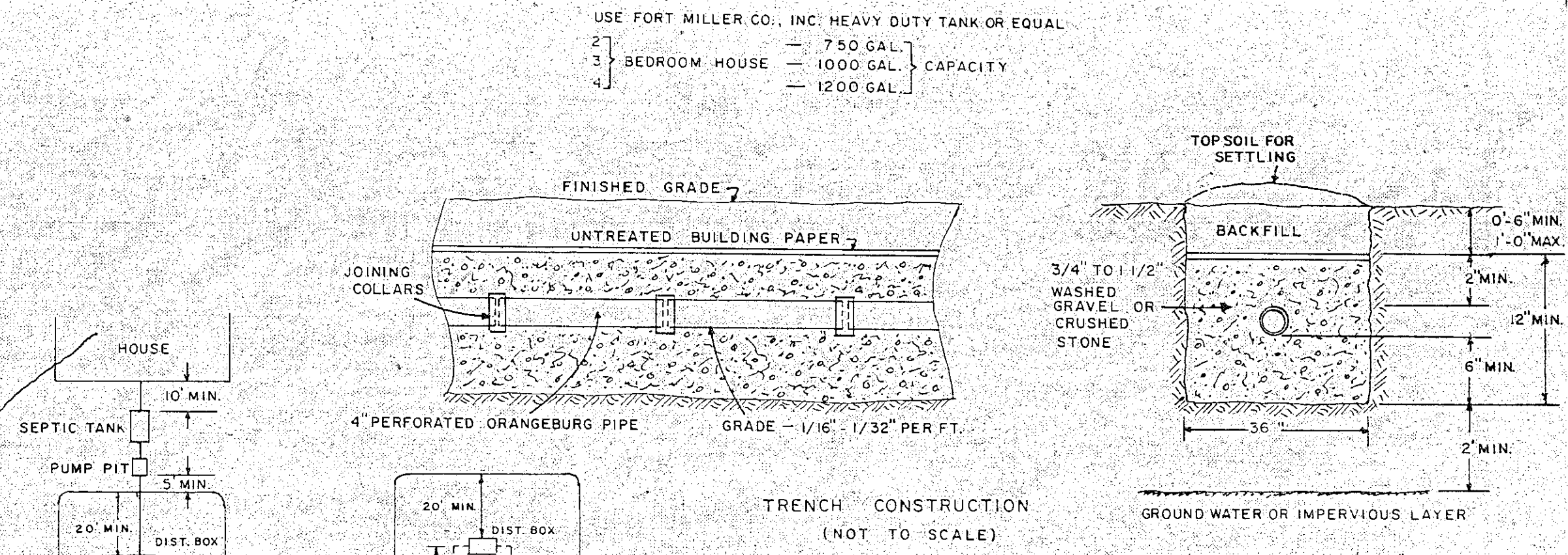
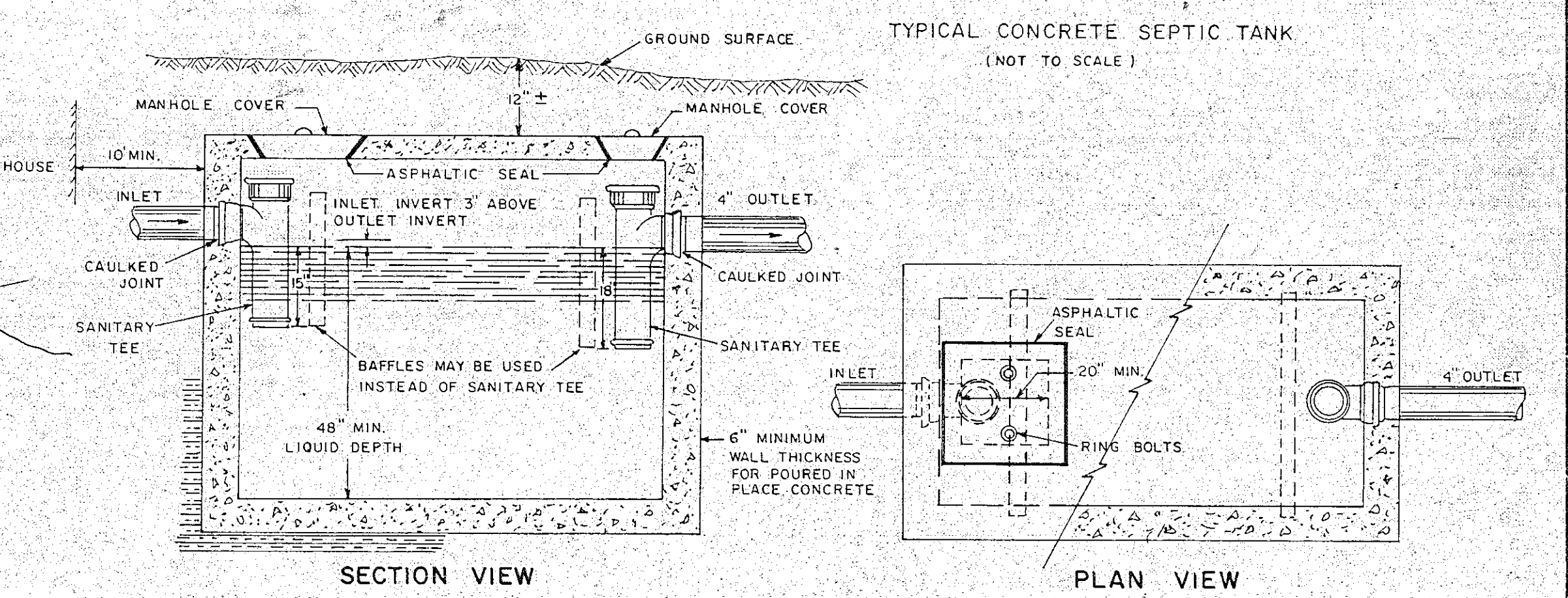

NOTE
SEWAGE DETAILS SHOWN TO BE USED IN THE EVENT THE EXISTING SYSTEM FAILS OR IS FAILING

ALBANY COUNTY HEALTH DEPARTMENT APPROVAL
ALBANY COUNTY DEPARTMENT OF HEALTH
This is to certify that the proposed arrangements for water supply and sewerage for 20 Acres of realty development in the Town of Bethlehem are approved subject to the conditions listed in letter of this date, and in accordance with Article X of the Albany County Sanitary Code. Consent is hereby given for the filing of this plan in the Office of the Albany County Clerk.
Date: JUL 27 1982
Commissioner of Health
Dir. Div. Environmental Health Services

INCHES
Town of Bethlehem, NY

ALBANY COUNTY HEALTH DEPARTMENT APPROVAL
ALBANY COUNTY DEPARTMENT OF HEALTH
This is to certify that the proposed arrangements for water supply and sewerage for 20 Acres of realty development in the Town of Bethlehem are approved subject to the conditions listed in letter of this date, and in accordance with Article X of the Albany County Sanitary Code. Consent is hereby given for the filing of this plan in the Office of the Albany County Clerk.
Date: JUL 27 1982
Commissioner of Health
Dir. Div. Environmental Health Services

REVISIONS:
REVISED JUN 30, 1982 DISPOSAL SYSTEM SKETCHES CHANGED
REVISED DEC 16, 1981 PROP WATER MAIN ADDED
REVISED DEC 17, 1981 CELLAR DRAIN ADDED TO WATER MAIN/DRAIN
REVISED OCT 20, 1981 DISPOSAL SYSTEM SKETCHES CHANGED
REVISED OCT 13, 1981 LOT 7 REVISED
REVISED AUG 31, 1981 EXIST WATER LINES ADDED

MAP OF "20 ACRES" PROPERTY OF TWENTY ACRES, INC. TOWN OF BETHLEHEM ALBANY COUNTY NEW YORK MAY 10, 1981 SCALE 1"=40'

PLAN BY EDWARD W. MOFFELLE & SON CIVIL ENGINEERS AND SURVEYORS DELMAR, NEW YORK