

FEURA BUSH ROAD ENTRANCE

PLANNING BOARD  
TOWN OF BETHLEHEM  
ALBANY COUNTY, NEW YORK

This Site Plan Approved *at the*

Title Chairman  
SPA 60-A10  
Date 4-4-07

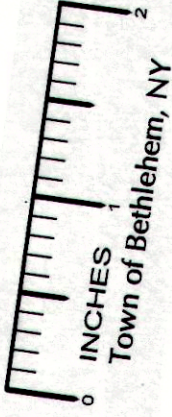

PROPOSED D.F. GROUND SIGN 3/8" = 1'-0"

SUBJECT TO THE APPROVAL OF THE MUNICIPALITY'S PLANNING BOARD

**BENDERSON  
DEVELOPMENT**  
570 DELAWARE AVENUE, BUFFALO, NEW YORK, 14202

PROPERTY GLENMONT PLAZA

GLENMONT, NEW YORK

PROP. # 4005 DRWG. # 4005GR

DATE 12.2.06 BY D.MAVIS

REVISION 9.27.06 REMOVE TT CAB. DM

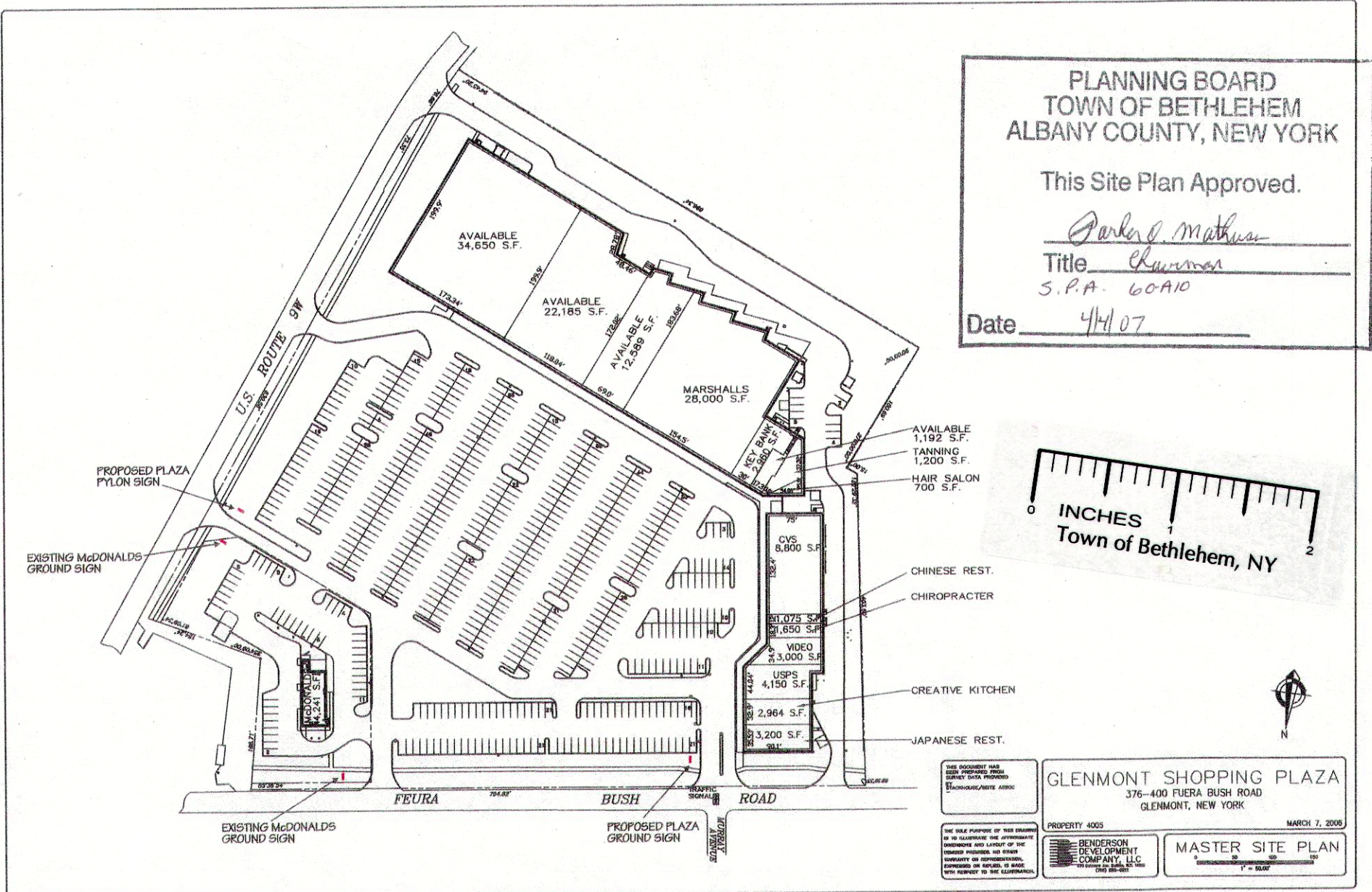

PLANNING BOARD  
 TOWN OF BETHLEHEM  
 ALBANY COUNTY, NEW YORK

This Site Plan Approved.

*Barbara Mathias*  
 Title *Chairman*  
 S.P.A. 60A10

Date 4/1/07

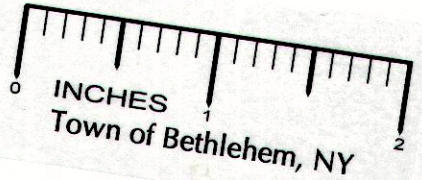

- AVAILABLE 1,192 S.F.
- TANNING 1,200 S.F.
- HAIR SALON 700 S.F.
- CHINESE REST.
- CHIROPRACTER
- CREATIVE KITCHEN
- JAPANESE REST.



THIS DOCUMENT HAS BEEN PREPARED FROM SURVEY DATA PROVIDED BY ARCHON/ALBANY ASSOC.

THE SOLE PURPOSE OF THIS DRAWING IS TO ILLUSTRATE THE APPROXIMATE DIMENSIONS AND LAYOUT OF THE PROPERTY DESCRIBED. NO OTHER WARRANTY OR REPRESENTATION, EXPRESSED OR IMPLIED, IS MADE WITH RESPECT TO THE ACCURACY.

GLENMONT SHOPPING PLAZA  
 376-400 FEURA BUSH ROAD  
 GLENMONT, NEW YORK

PROPERTY 4005 MARCH 7, 2006

BENDERSON DEVELOPMENT COMPANY, LLC  
 125 WEST 100th ST. SUITE 200  
 CHICAGO, IL 60642

MASTER SITE PLAN  
 0 50 100  
 1" = 50.00'

SPA 60A10

RT 9W ENTRANCE

PLANNING BOARD  
 TOWN OF BETHLEHEM  
 ALBANY COUNTY, NEW YORK

This Site Plan Approved.  
*Robert J. Mathias*

8'-0" TENANT CABINET

Title *Chairman*  
 SPA 60-A10  
 Date 4-4-07

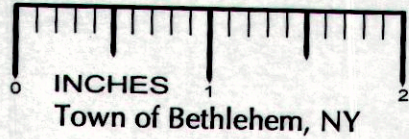
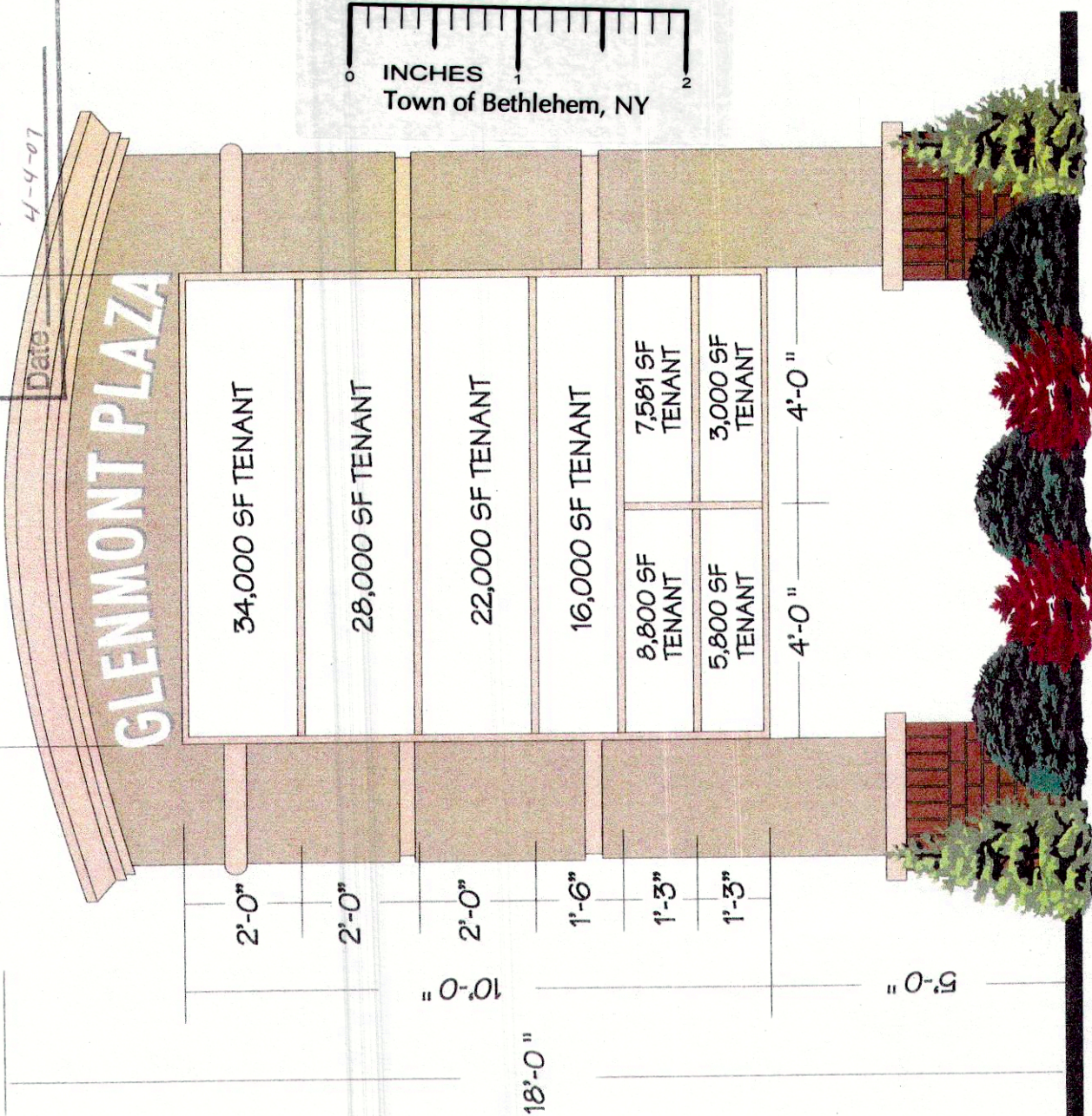

PROPOSED D.F. PYLON SIGN 3/8" = 1'-0"

SUBJECT TO THE APPROVAL OF THE MUNICIPALITY'S PLANNING BOARD

80 SQUARE FEET  
 15' SETBACK

**BENDERSON DEVELOPMENT**  
 570 DELAWARE AVENUE, BUFFALO, NEW YORK, 14202

PROPERTY GLENMONT PLAZA  
 GLENMONT, NEW YORK  
 PROP. # 4005 DRWG. # 4005FY  
 DATE 10.10.05 BY D.MAVIS  
 REVISION 10.4.06 HEIGHT DM  
 10.07 CABINET DM

*Handwritten initials and date: 10/10/05*

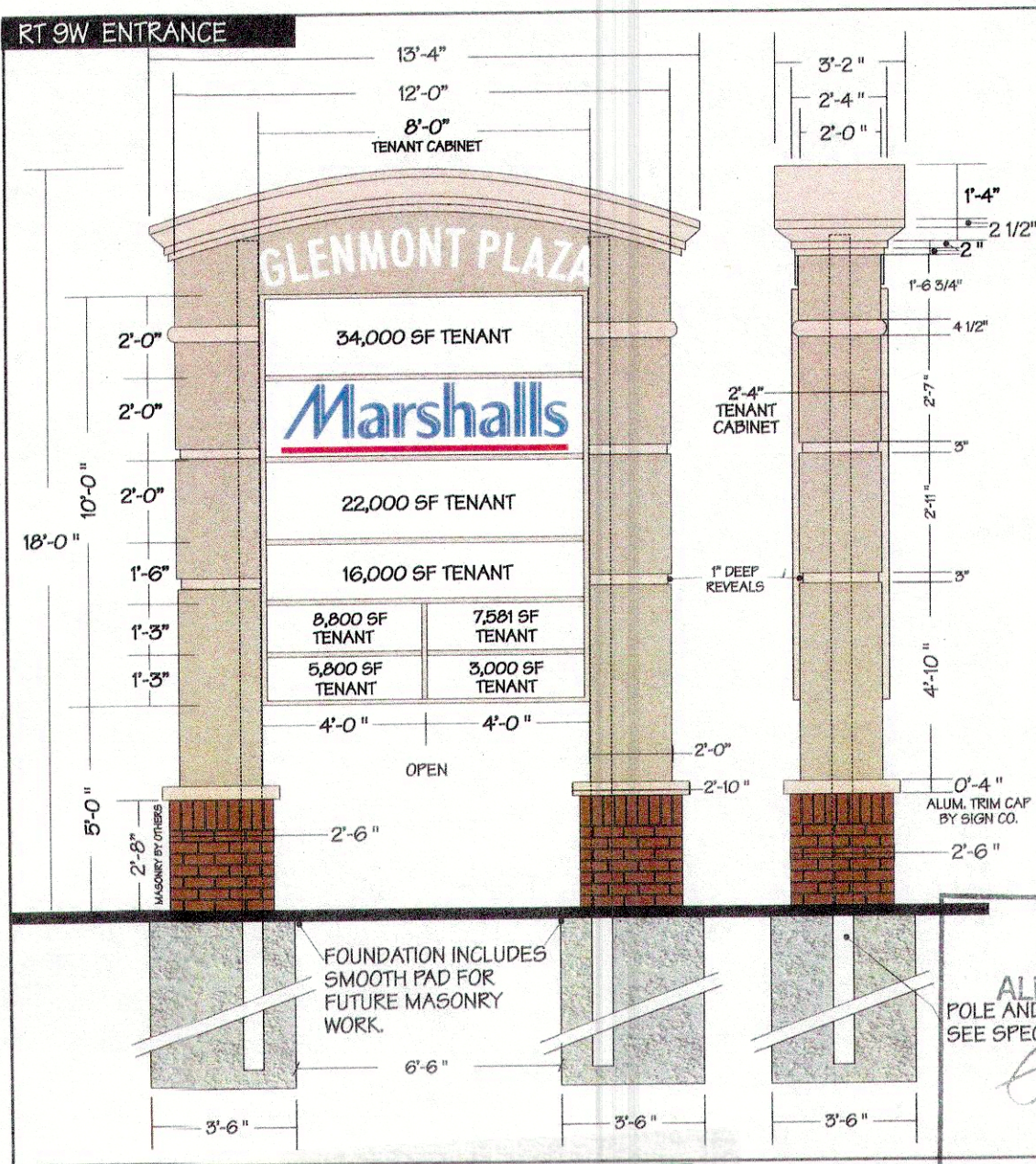

**SPECIFICATIONS**      **D.F. PYLON SIGN**      **3/8"=1'-0"**

PLAZA CABINET: FAB. .090" ALUM. CABINET W/ 1 1/2" ALUM. ANGLE FRAMEWORK TO PREVENT DEFLECTION. H.O. FLUORESCENT LAMPS 10" O.C. HORIZONTALLY. 800MA T-12 RAPID START. ALL WIRING TO BE RUN IN ALUM. RACEWAYS. .125" FLAT ALUMINUM FACES WITH ROUTED PUSH THRU COPY. THE ROUTED COPY IS TO BE BACKED WITH 1/4" PIGMENTED WHITE ACRYLIC WITH 3/4" CLEAR PUSH THRU ACRYLIC COPY. THE FACE OF THE ACRYLIC IS TO HAVE H.P. PSV INSTALLED FIRST SURFACE. THE ACRYLIC BACK-UP IS TO BE DRILLED OVERSIZE, MOUNTED WITH MECHANICAL FASTENERS AND SOLVENT WELDED AROUND THE ACRYLIC PERIMETER. EACH END OF THE CABINET IS TO HAVE REMOVABLE ACCESS PANELS INSTALLED WITH C.S. ALUMINUM FASTENERS.

TENANT CABINET: FAB. 090" ALUM. W/ EXTRUDED 2" ALUM. RETAINERS. 15/8" DIVIDER BARS. ILLUMINATION- SEE ABOVE SPECS. RETAINERS TO HAVE C.S. REMOVABLE SCREWS FOR ACCESS. .187" FLAT LEXAN POLYCARBONATE MATERIAL, SOLAR CLEAR FIRST SURFACE, WITH H.P. TRANSLUCENT PSV GRAPHICS ON THE FIRST SURFACE.

POLE COVERS: FAB. 090" SEAMLESS ALUM. W/ 1 1/2" ALUM. ANGLE FRAMEWORK TO PREVENT DEFLECTION. PLAZA SIDE FACE (INSIDE LEG) OF POLE COVER TO HAVE A FLUSH MOUNTED REMOVABLE ACCESS COVER.

MASONRY: BY OTHERS.

STEEL/FOUNDATION: STEEL STRUCTURE W/ CONCRETE FOUNDATIONS PER LOCAL CODE/ NATIONAL ENGINEERING WIND LOAD GUIDELINES. STRUCTURAL STEEL SHALL BE ASTM-36. STRUCTURAL STEEL TUBING SHALL BE ASTM-A55. ALL WELDING SHALL CONFORM TO AWS SPECIFICATIONS. STEEL TO BE PRIMED & PAINTED W/ A RUST PROHIBITING PAINT. 3000 PSI CONCRETE. SIGNS ARE TO HAVE FLAT CONCRETE PADS AT GRADE (DIMENSIONS AS SHOWN ON DRAWING TO THE LEFT) TO PROVIDE A SMOOTH SURFACE FOR THE MASONRY CONTRACTOR. THE SIGN COMPANY WILL FIRST INSTALL THE STEEL STRUCTURE AND CABINETS. THE MASONRY CONTRACTOR WILL THEN INSTALL THE MASONRY AROUND THE SIGN.

ELECTRICAL: ALL FABRICATION AND ELECTRICAL DETAILS SHALL MEET UL & NEC REQUIREMENTS. SIGNS TO HAVE UL LABELS DISPLAYED. **BDCI TO PROVIDE 120V ELECTRICAL SERVICE** TO THE BASE OF THE SIGNS W/ FINAL ELECTRICAL CONNECTION BY SIGN CONTRACTOR.

PAINT: ALL METAL SURFACES TO BE PRIMED AND PAINTED WITH AN ACRYLIC POLYURETHANE PAINT. ALL METAL SURFACES TO HAVE A SATIN FINISH.

GENERAL NOTES: MIG WELDED CONSTRUCTION THROUGHOUT, NO RIVETS. FACE SEAMS, IF ANY, TO BE FILLED W/ METAL FILLER AND GROUND SMOOTH TO PROVIDE A SEAMLESS APPEARANCE. THE QUOTATION IS TO INCLUDE THE TENANT GRAPHICS INDICATED AT THE TIME OF INSTALLATION. ALL EXCAVATED SPOILS ARE TO BE REMOVED FROM THE SITE. NO GAPS, LIGHT LEAKS OR "OIL CANNING" WILL BE ACCEPTED. AT COMPLETION OF INSTALLATION, ALL SURFACES ARE TO BE CLEANED IN ACCORDANCE WITH MANUFACTURERS INSTRUCTIONS.

PLANNING BOARD  
 TOWN OF BETHLEHEM  
 ALBANY COUNTY, NEW YORK  
 POLE AND FOUNDATION:  
 SEE SPECIFICATIONS SHEET  
*This Site Plan Approved,*  
*Parker D. Mathusa*  
 Title Chairman  
 SPA 60-A10  
 Date 4-4-07

**BENDERSON DEVELOPMENT**  
 570 DELAWARE AVENUE, BUFFALO, NEW YORK 14202

PROPERTY GLENMONT PLAZA  
 GLENMONT, NEW YORK  
 PROP. # 4005 DRWG. # 4005PY/FAB/BID  
 DATE 12.26.06 BY D.MAVIS  
 REVISION

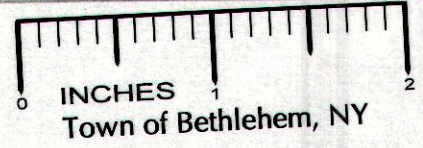

FEURA BUSH ROAD ENTRANCE

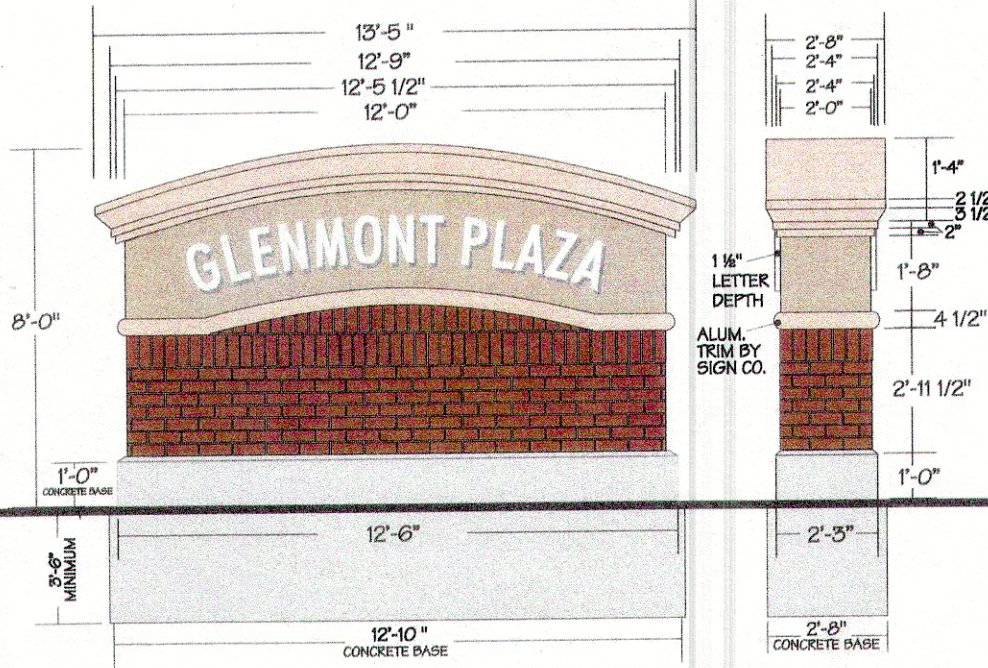

SPECIFICATIONS/ NON-ILLUMINATED SIGN

DECORATIVE CORNICE AND TRIM: FAB. 0.90" ALUM. W/ 1 1/2" ALUM. ANGLE FRAMEWORK TO PREVENT DEFLECTION. THE BOTTOM OF THE CABINET WILL NEED TO BE OPEN TO ALLOW OVERLAP OF THE MASONRY "CURVE" WHICH WILL NOT BE SMOOTH, THE BRICK WILL BE STEPPED. CABINET TO BE LAG BOLTED INTO MASONRY.

PLAZA NAME: FAB. NON-ILLUMINATED 12" x 1 1/2" ALUM. DIMENSIONAL CHANNEL LETTERS WITH .063" ALUMINUM RETURNS, .125" ALUMINUM FACES, PAINTED WHITE WITH A SATIN FINISH. FLUSH STUD AND TEMPLATE MOUNT.

MASONRY: BY OTHERS.

FOUNDATION: SIGN IS TO HAVE FLAT CONCRETE PAD ONE (1') FOOT ABOVE GRADE TO PROVIDE A SMOOTH SURFACE FOR THE MASONRY CONTRACTOR. THE MASONRY COMPANY WILL FIRST INSTALL THE FOUNDATION, AND PROVIDE REBAR COMING OUT (MINIMUM OF 3') OF BASE TO TIE THE WALL INTO. PLAZA CABINET TO BE INSTALLED UPON COMPLETION OF THE MASONRY WORK.

PAINT: ALL METAL SURFACES TO BE PRIMED AND PAINTED WITH AN ACRYLIC POLYURETHANE PAINT. ALL METAL SURFACES TO HAVE A SATIN FINISH.

GENERAL NOTES: MIG WELDED CONSTRUCTION THROUGHOUT, NO RIVETS. FACE SEAMS, IF ANY, TO BE FILLED W/ METAL FILLER AND GROUND SMOOTH TO PROVIDE A SEAMLESS APPEARANCE. ALL EXCAVATED SPOILS ARE TO BE REMOVED FROM THE SITE. AT COMPLETION OF INSTALLATION, ALL SURFACES ARE TO BE CLEANED IN ACCORDANCE WITH MANUFACTURERS INSTRUCTIONS.

PLANNING BOARD  
 TOWN OF BETHLEHEM  
 ALBANY COUNTY, NEW YORK

This Site Plan Approved,  
*Parker D. Mathusa*  
 Title Chairman  
 SPA 60-A10

Date 4-4-07

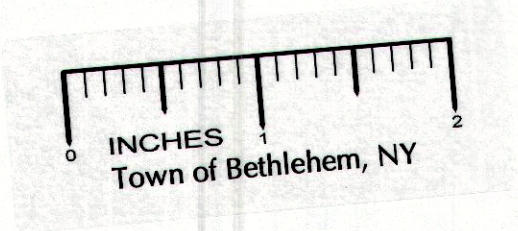

**BENDERSON DEVELOPMENT**  
 578 DELAWARE AVENUE, BUFFALO, NEW YORK, 14202

PROPERTY GLENMONT PLAZA  
 GLENMONT, NEW YORK

PROP. # 4005 DRWG. # 4005GR  
 DATE 12.29.06 BY D.MAVIS

REVISION

D.F. GROUND SIGN 3/8"=1'-0" (1 SIGN REQUIRED)