

- To be installed under "DRIVE THRU" Directional Sign located at access driveway on Feura Bush Road

Scale: 2"=1'

Copyright © 2004 Signal-Technologies, Inc.

05032004

Direct-View LED Traffic Controller TCL718GR-220 OPEN / FULL

ILLUMINATION SOURCE

Super bright, wide viewing angle LED's
Also available in Green, Red, Blue, or Amber LED's
Messages "Blankout" when turned off eliminating confusion.
Long life: Up to 100,000+hours



ELECTRICAL

Integrated solid state power supply
120 VAC Standard; Optional Voltages 12 V, 24 V, 277 V
OPEN 0.04 Amps Maximum; FULL 0.03 Amps Maximum

CONSTRUCTION

Cabinet - Slim Line single piece extruded aluminum housing 2.5" deep
Back plate - 0.050" Aluminum with two 7/8" diameter knockouts for electrical connections and four 3/8" knockouts for wall mounting.
Face Material - Impact resistant tinted polycarbonate

FINISH

Cabinet - Standard Duranodic Bronze
Custom colors available upon request

INSTALLATION

Lift 'n Shift wall mounted back plate bolts to wall surface; unit hinges on back plate allowing easy electrical connection without holding sign. Back is secured to cabinet frame using two screws to complete installation.

OPTIONS

- | | |
|---|---|
| <input type="checkbox"/> Ceiling Mount Bracket | <input type="checkbox"/> Custom Paint _____ Pantone Color |
| <input type="checkbox"/> Projection Mount Bracket | <input type="checkbox"/> RF Remote |
| <input type="checkbox"/> Dual Angle Mount Bracket 42" | <input type="checkbox"/> Flasher Unit |
| <input type="checkbox"/> Projection Double Post Mount | <input type="checkbox"/> Photo Electric Sensor |
| <input type="checkbox"/> Single Post Mount _____ Length | <input type="checkbox"/> Piezo Buzzer |
| <input type="checkbox"/> Double Post Mount _____ Length | <input type="checkbox"/> Flashing Beacon |
| <input type="checkbox"/> Recessed Frame Mount | <input type="checkbox"/> Switches _____ Gang _____ Qty |
| <input type="checkbox"/> Base Plates _____ Qty | Available in 1, 2, 3, 4, 5, 6, 7, 8, 9 gang |

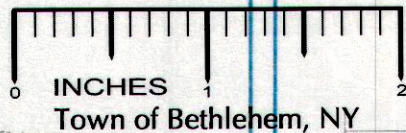

Product View

NOTE: LED quantity and placement not exact. For illustration purposes only.



Front View

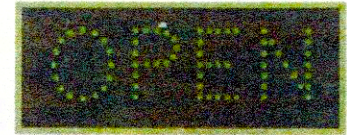

Overlaid Messages Shown Separately
For Illustration Purposes

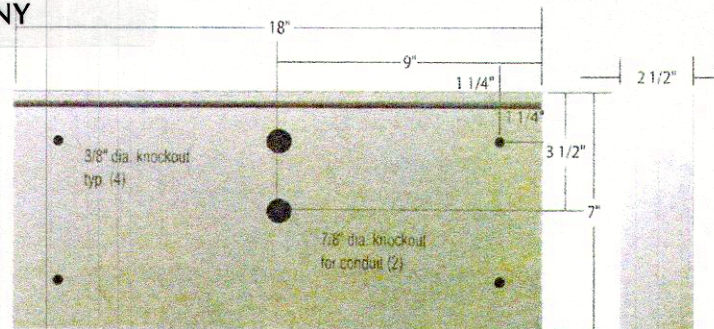

Back View

Side View

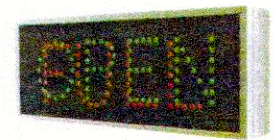

MODEL NUMBER

TCL718GR-220

CABINET DIMENSIONS

7" H x 18" L x 2.5" D

CHARACTER HEIGHT

3.5 Inches

MESSAGE

OPEN / FULL

MESSAGE COLOR

Green / Red

LIGHT SOURCE

Direct-View LED

Optional Mounting Methods

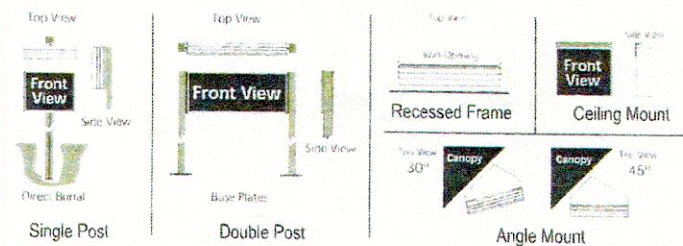

Optional Switches and Switchplates



SIGNAL TECHNOLOGIES INC.
4985 Pittsburgh Ave
Erie, PA 16509-6206
Phone: 877 / 547-9900
Fax: 814 / 835-2300
Email: sales@signal-tech.com
Online: www.signal-tech.com



Proudly Made In The USA

| PROPOSED SIGNAGE TABLE | | | | |
|------------------------|--|---------------------------------|-------|------------|
| SIGN SCHEDULE | | | | |
| SYM | DESCRIPTION | SIGN AREA | QUAN. | TOTAL AREA |
| (A) | PROPOSED WALL SIGN | 16.70 S.F. | 1 | 16.70 S.F. |
| (B) | DUNKIN DONUTS DIRECTIONAL SIGNS | 2.98 S.F. | 2 | 5.96 S.F. |
| (C) | APPROVED/EXISTING MONUMENT | 32.0 S.F. | 1 | 32.0 S.F. |
| (D) | EXISTING WALL SIGN | 12.57 S.F. | 1 | 12.57 S.F. |
| (E) | "OPEN/FULL" SIGN TO BE MOUNTED UNDER "DRIVE-THRU" DIRECTIONAL SIGN | N/A | N/A | N/A |
| | | PROPOSED TOTAL AREA: 67.23 S.F. | | |

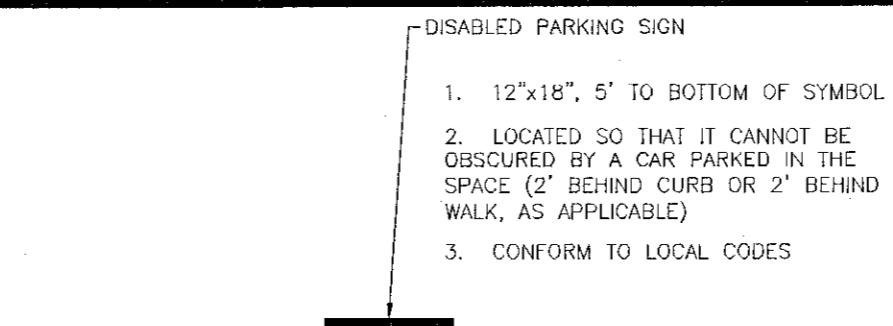

GENERAL NOTES

- THIS PLAN REFERENCES DRAWINGS BY: CAPITAL ARCHITECTURE
37 DAVIS AVENUE
ALBANY, NY 12203
- THIS CONCEPT WAS PREPARED STRICTLY BASED UPON INFORMATION IDENTIFIED ABOVE.
- THE CONCEPT REPRESENTED HEREIN IDENTIFIES A DESIGN CONCEPT RESULTING FROM LAYOUT PREFERENCES IDENTIFIED BY OWNER COUPLED WITH A PRELIMINARY REVIEW OF ZONING AND LAND DEVELOPMENT REQUIREMENTS AND ISSUES. THE FEASIBILITY WITH RESPECT TO OBTAINING LOCAL, COUNTY, STATE, AND OTHER APPLICABLE APPROVALS IS NOT WARRANTED AND CAN ONLY BE ASSESSED AFTER FURTHER EXAMINATION AND VERIFICATION OF SAME REQUIREMENTS AND PROCUREMENT OF JURISDICTIONAL APPROVALS.
- THE CONCEPTUAL PLAN IS PREPARED FOR CONCEPTUAL PRESENTATION PURPOSES ONLY AND IS NOT INTENDED FOR UTILIZATION AS A ZONING AND/OR CONSTRUCTION DOCUMENT. THE EXISTING CONDITIONS SHOWN HEREON ARE BASED UPON INFORMATION THAT WAS SUPPLIED TO OUR OFFICE AT THE TIME OF PLAN PREPARATION AND MAY BE SUBJECT TO CHANGE UPON PERFORMANCE OF ADDITIONAL DUE DILIGENCE.

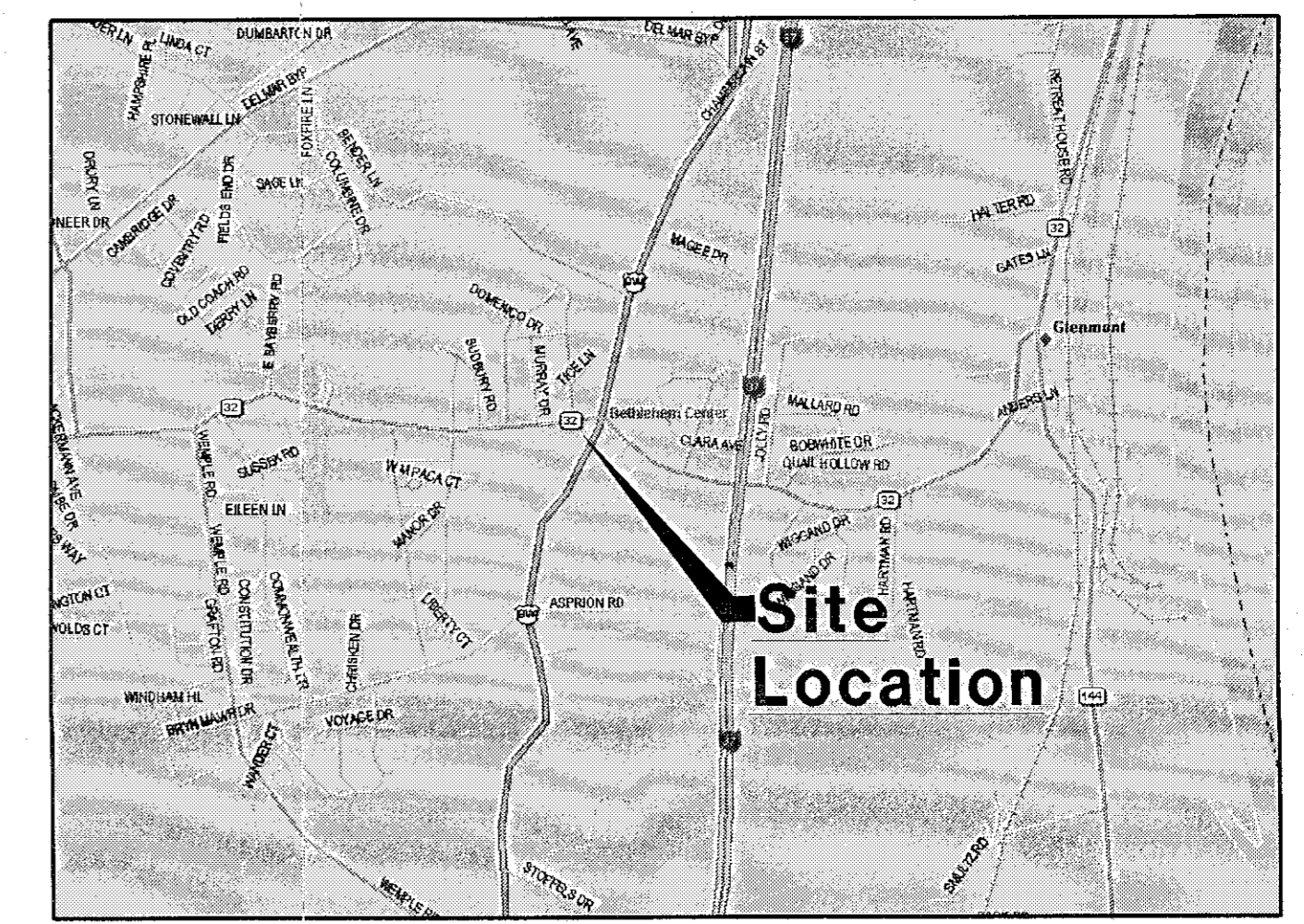

BOHLER ENGINEERING

CORPORATE OFFICE:
WARREN, NJ

OFFICES:
ALBANY, NY
BETHLEHEM, PA
CHAMONT, PA
GLENVIEW, IL
HARTFORD, CT
MONTICELLO, NY
PORT LAURENCE, PA

CIVIL & CONSULTING ENGINEERS
SURVEYORS
PROJECT MANAGERS
ENVIRONMENTAL CONSULTANTS
LANDSCAPE ARCHITECTS

| REVISIONS: | | | |
|------------|---------|------------------------------------|-----|
| REV. | DATE | COMMENT | BY |
| 4 | 9/23/08 | "OPEN/FULL" SIGN ADDED | AML |
| 3 | 8/26/08 | REVISED PER TOWN PLANNING COMMENTS | AML |
| 2 | 8/13/08 | SIGN TABLE ADDED | BHR |
| 1 | 6/17/08 | REVISED PER TOWN PLANNING COMMENTS | ECR |

NOT APPROVED FOR CONSTRUCTION

PROJECT No.: 8080133
DRAWN BY: ECK
CHECKED BY: CEB
DATE: 4/19/08
SCALE: AS NOTED
CAD.I.D.: SITE-REV.4 SUBMITTAL

PROPOSED DRIVE-THRU

FOR **Frank Hessari (Prestige Petroleum)**

N.Y.S. ROUTE 9W
TOWN OF GLENMONT
ALBANY COUNTY
NEW YORK STATE

BOHLER ENGINEERING

5 COMPUTER DRIVE WEST
ALBANY, NY 12205
PH: (518) 438-9900
FX: (518) 438-0900
www.BohlerEngineering.com

W.D. GOEBEL

PROFESSIONAL ENGINEER
NEW YORK LICENSE No. 071284
MASSACHUSETTS LICENSE No. 42044
CONNECTICUT LICENSE No. 21854
NEW HAMPSHIRE LICENSE No. 10280
MAINE LICENSE No. 9490

DRIVE-THRU IMPROVEMENT PLAN / DETAILS

SHEET NUMBER: **1**
OF 1
REVISION 4

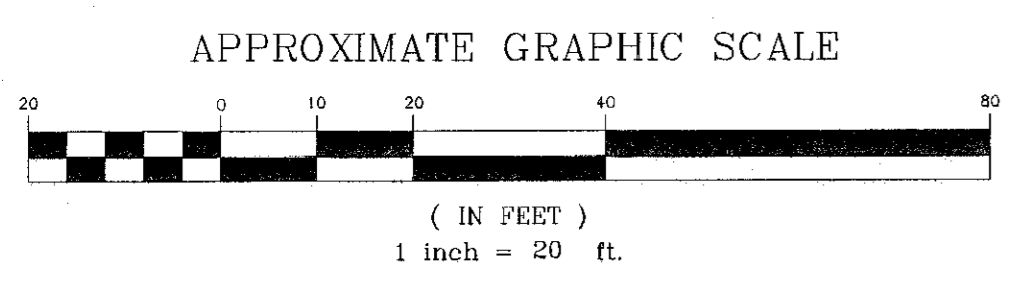
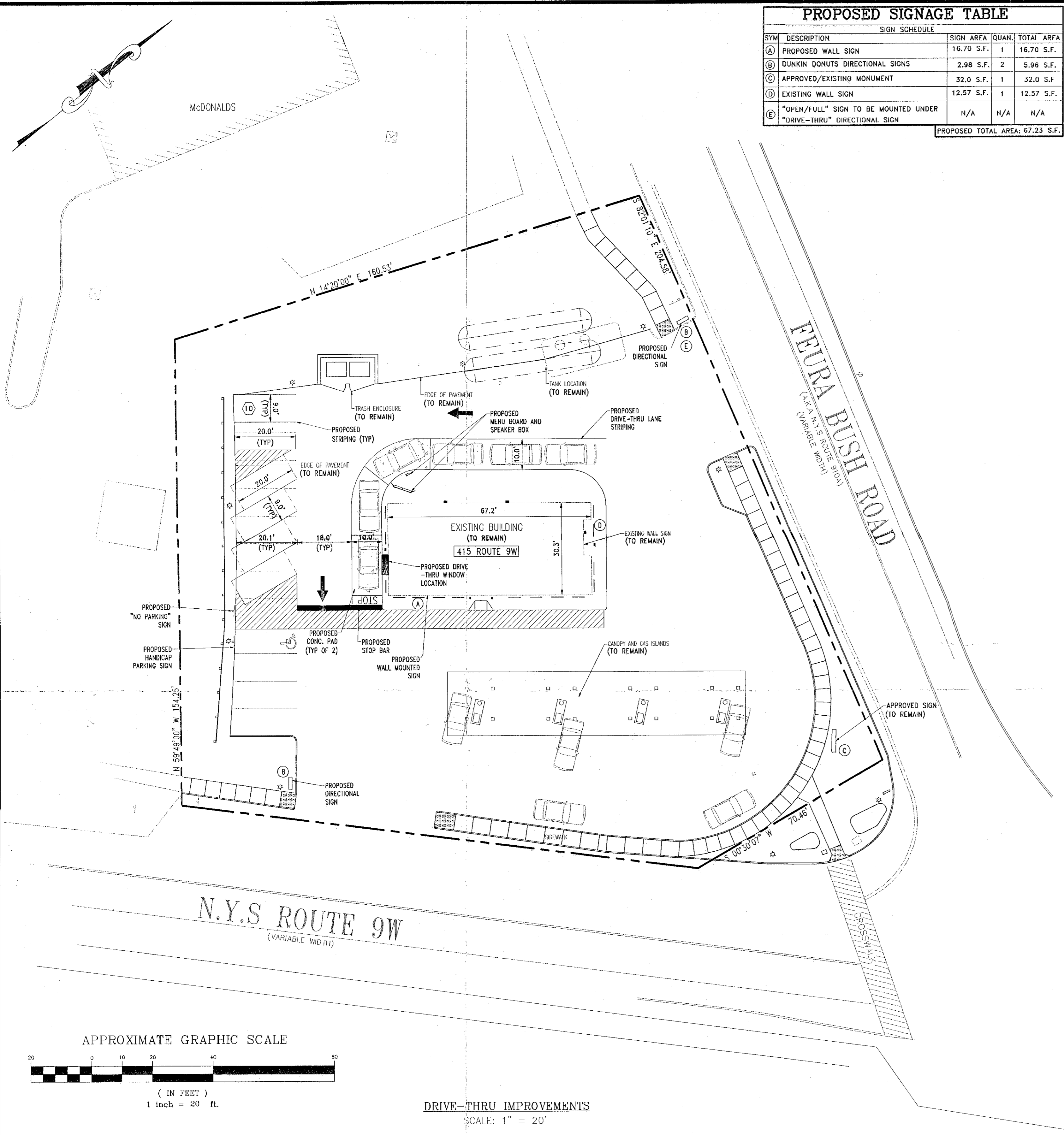

DRIVE-THRU IMPROVEMENTS
SCALE: 1" = 20'

NOTE: THIS PLAN IS BASED ON PRELIMINARY BACKGROUND DATA (BY OTHERS) AND LIMITED DUE DILIGENCE.

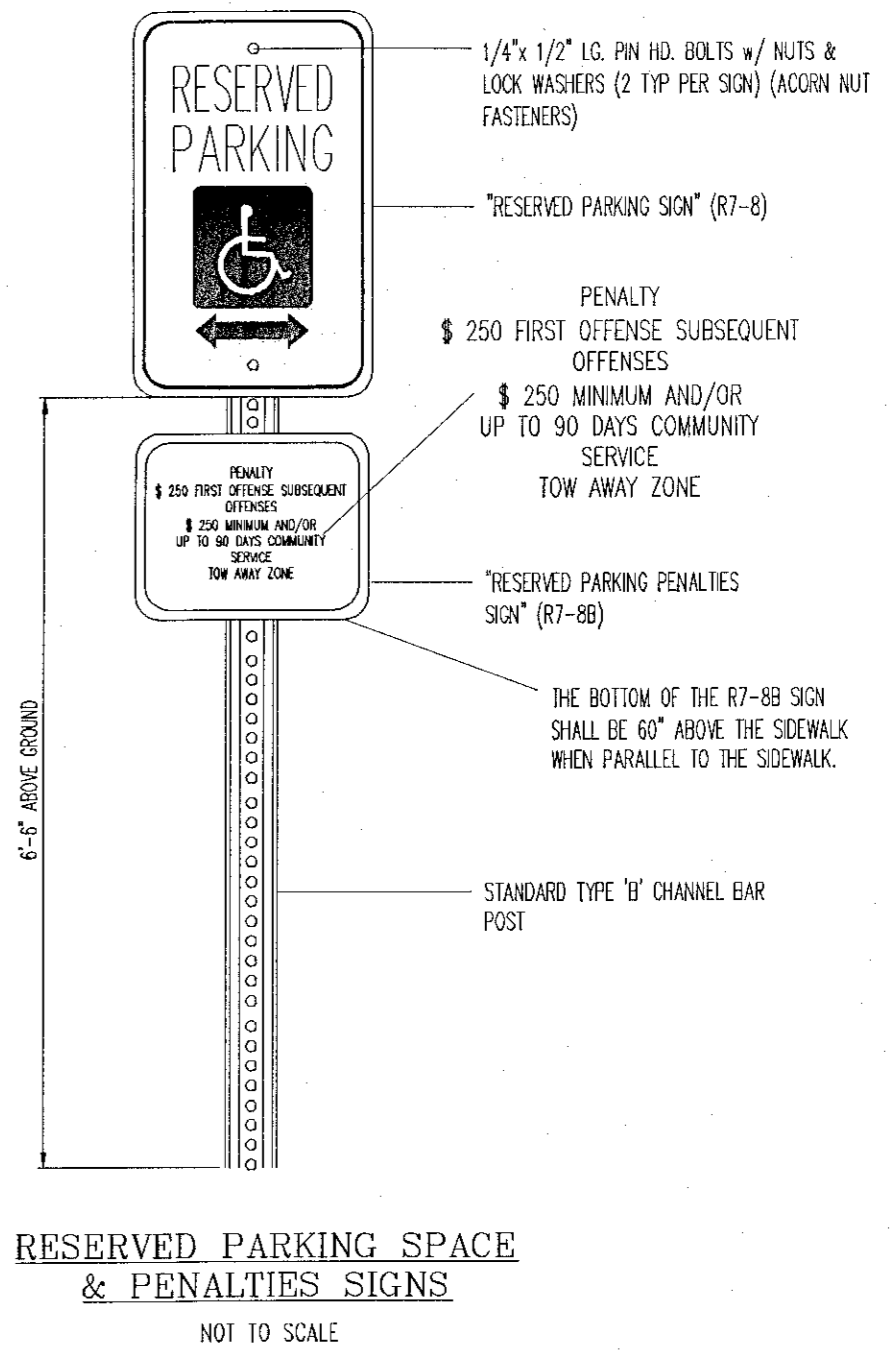
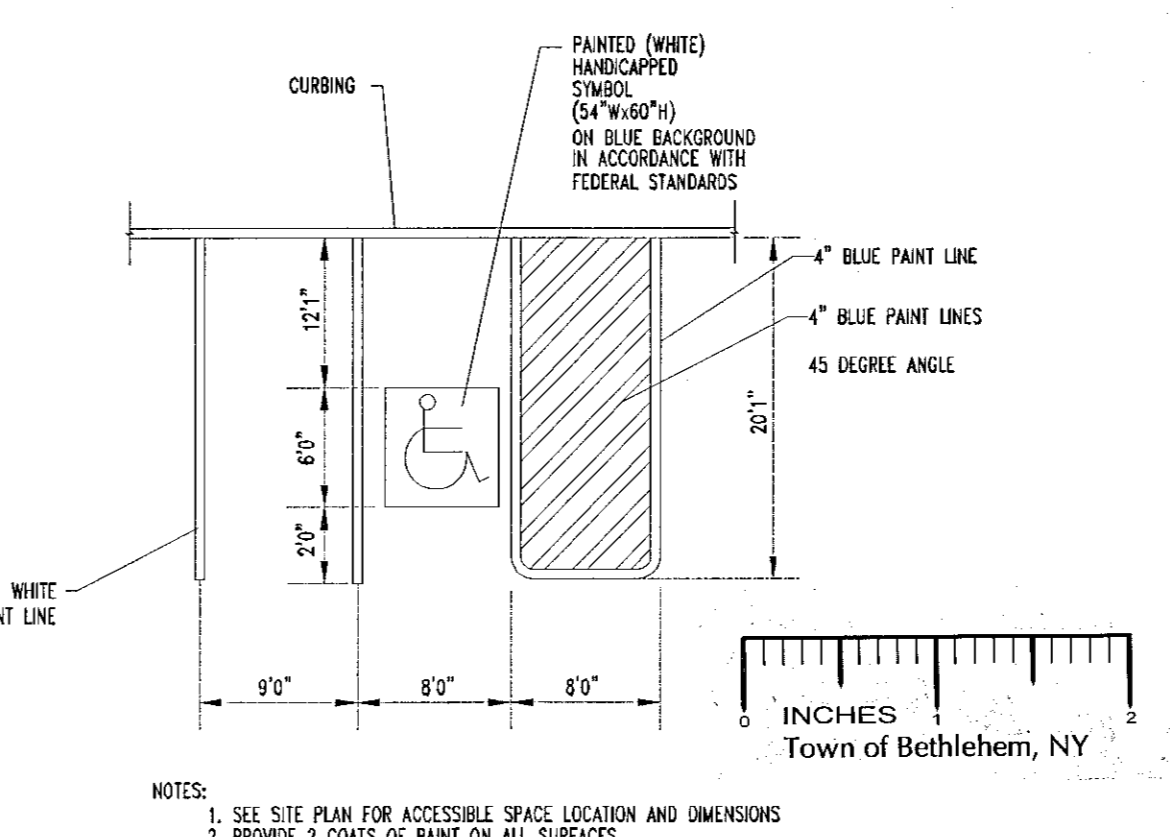
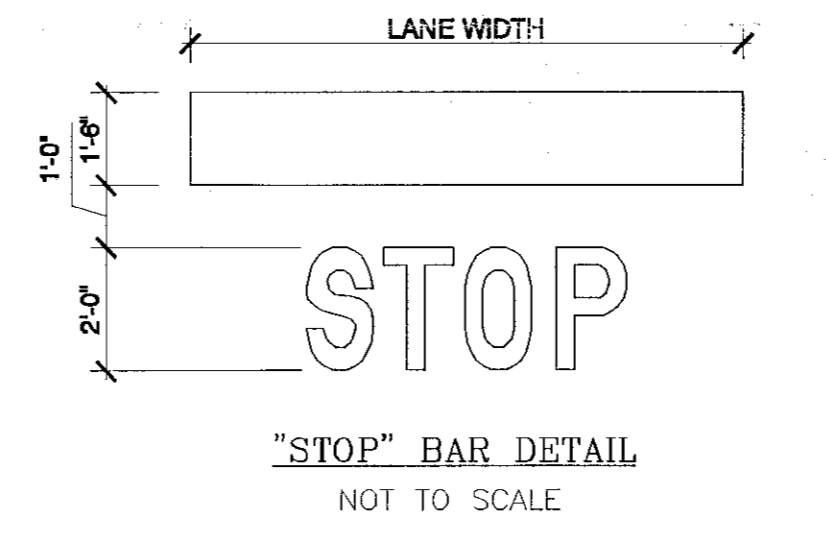
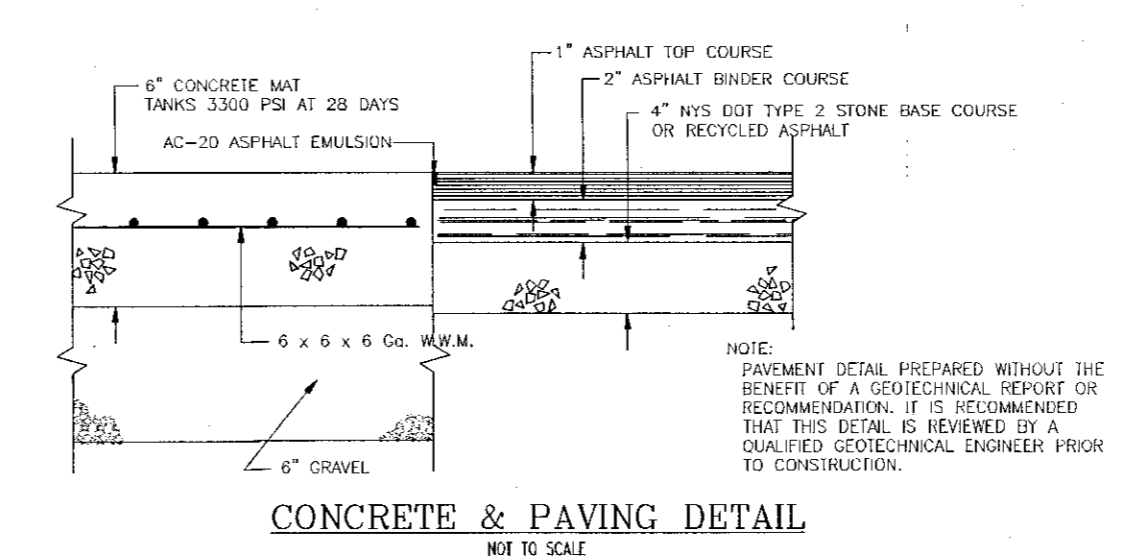
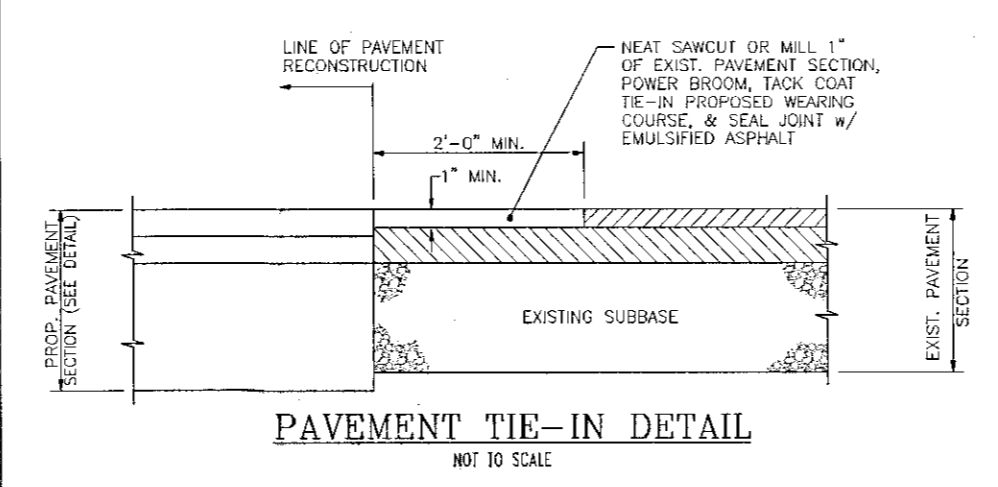

PLANNING BOARD
TOWN OF BETHLEHEM
ALBANY COUNTY, NEW YORK

This Site Plan Approved.

W.D. Goebel
Title: *Commissioner*
SDA 136 A-1

Date: 9/30/08

TOWN OF BETHLEHEM APPROVAL AREA

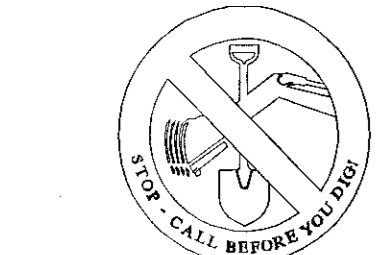

ANY PERSON IS PROHIBITED FROM ALTERING ANYTHING ON THESE DRAWINGS AND/OR THE ACCOMPANYING SPECIFICATIONS, UNLESS IT IS UNDER THE WRITTEN DIRECTION OF A LICENSED PROFESSIONAL ENGINEER OF THE FIRM. IN THE EVENT SUCH ALTERATIONS ARE MADE, THE PROFESSIONAL ENGINEER OF THE FIRM MUST SIGN, SEAL, DATE, AND DESCRIBE THE FULL EXTENT OF THE ALTERATION ON THE DRAWINGS AND/OR IN THE SPECIFICATIONS. (NYS EDUCATION LAW SECTION 2209-2)

THE STATE OF NEW YORK REQUIRES NOTIFICATION BY EXCAVATORS, DESIGNERS, OR ANY PERSON PREPARING TO OBTAIN THE EARTH'S SURFACE ANYWHERE IN THE STATE.

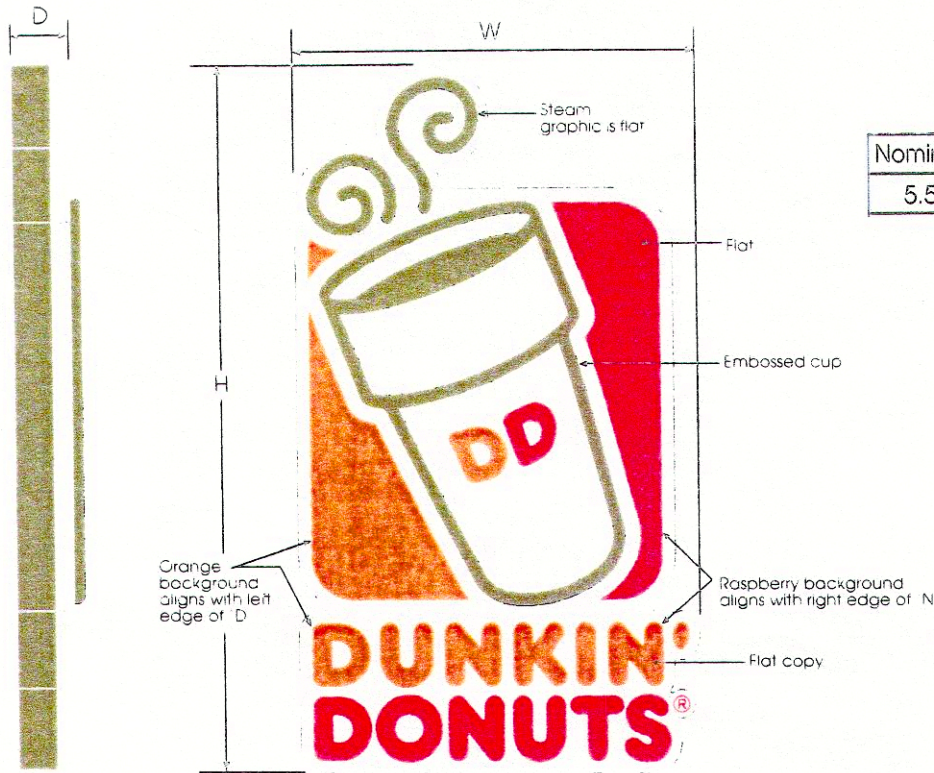

| Nominal Size | H | W | D | Area (sq. Ft.) | Lamps |
|--------------|-----|-----|----|----------------|--------------|
| 5.5 x 3 | 65" | 37" | 5" | 16.70 | HO/CW Fluor. |

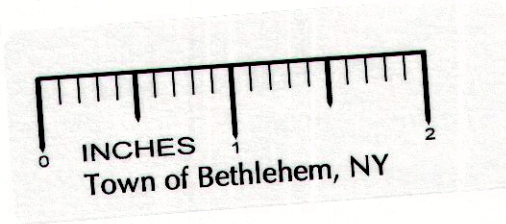

SIDE VIEW

35.43 SQ. FT. SINGLE FACE WALL MTD. CLOUD SIGN

*Area (sq ft)= Square Footage is calculated by boxing the entire sign including the dead space

NOTE: This is a concept drawing only and is subject to final engineering. Some material and dimensional specifications may vary or change per final engineering.

If questions regarding 3M films, please contact:
Deborah Giampolo-3M Corporation at 800.714.9865

COLOR & MATERIAL NOTES:

Face to be formed clear polycarbonate decorated second surface vinyl.
Cup to be embossed only. Balance of graphics to be flat.
Formed "cap-over" face fits over aluminum cabinet.
Vinyl colors to be:
DD Orange- 3M #3630-3123
DD Magenta 3M #3630-1379
Dark Brown (on cup logo)- 3M #3630-55

Cabinet to be 5" deep and pda to match Benjamin Moore 2116-10 Nightsnade semi-gloss finish.
Illumination to be HO/CW fluorescent lamps



Main St. & Newbury St. Sign Program

DESIGN CONTROL DOCUMENTS

THESE DRAWINGS ARE FOR IMAGE DESIGN GUIDANCE ONLY. IT IS THE RESPONSIBILITY OF THE ARCHITECTS AND ENGINEERS RETAINED BY THE FRANCHISEE TO PREPARE ALL NECESSARY CONSTRUCTION DOCUMENTS FOR THE PARTICULAR PROJECT LOCATION. ALLIED DONUTS CO. OR THEIR AGENTS AND EMPLOYEES, DO NOT WARRANT THE ACCURACY OF THESE DRAWINGS, NOR DOES ALLIED DONUTS CO. GUARANTEE THAT THESE DRAWINGS AND THEIR COMPONENTS MEET THE REQUIREMENTS OF ANY FEDERAL, STATE OR LOCAL LAWS, REGULATIONS, ORDINANCES, BUILDING CODES OR INDIVIDUAL SITE CONDITIONS. IT IS THE SOLE RESPONSIBILITY OF THE FRANCHISEE AND OF THE ARCHITECTS AND ENGINEERS RETAINED BY THE FRANCHISEE, TO ENSURE COMPLIANCE WITH ALL APPLICABLE LAWS, REGULATIONS, ORDINANCES, CODES AND OTHER REQUIREMENTS, INCLUDING, WITHOUT LIMITATION, AMERICANS WITH DISABILITIES ACT.

| No. | Revisions / Submission | Date |
|-----|--------------------------|----------|
| 1 | Add size and for 3 sizes | 12/19/07 |
| | | |
| | | |
| | | |
| | | |
| | | |
| | | |
| | | |

| | |
|------------------------|-------------|
| Drawing Title | |
| DD S/F Cloud Wall Sign | |
| Scale | Drawing No. |
| Not to Scale | DD-7 |
| Drawn | |
| Date | Sheet No. |
| December, 2007 | 7 |