

MX-SERIES
MX-250WMM
Mounting Height= 18 feet.
From Pole to Photometric Center= 1.2 feet.
IES Candela File: C:\ACAD\IES\MX250MH.IES
Initial Lumens per Lamp= 20500,
Light Loss Factor (LLF) = 1.0
Number Poles and Fixtures (10)

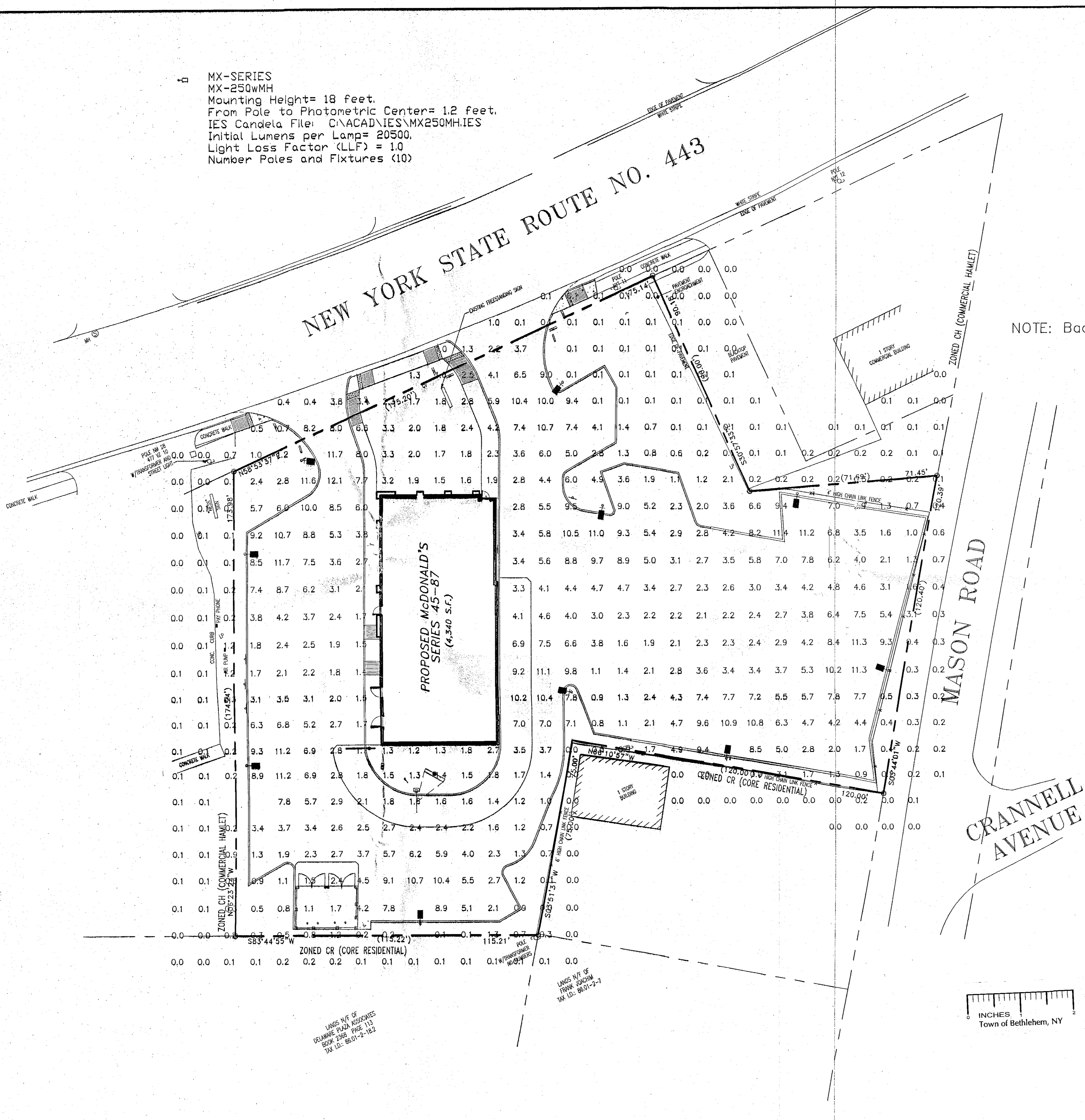

NOTE: Back Shield all Fixtures

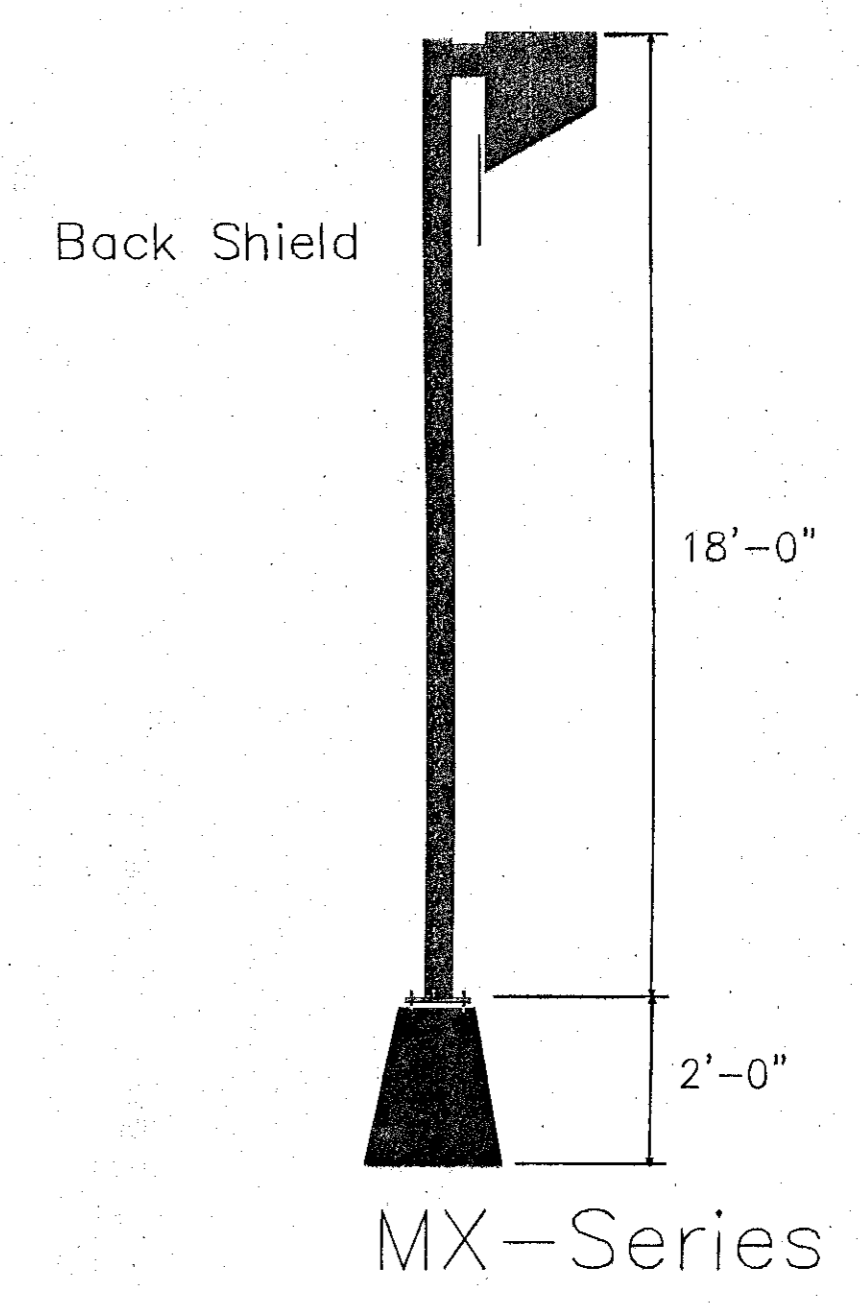

ILLUMINANCE IS IN HORIZONTAL FOOTCANDLES.
TARGET PLANE AT Z = 0 FEET.

Summary	
# POINTS	554
AVERAGE	2.7
MAXIMUM	12.1
MINIMUM	0.0
AVG/MIN	9999.99
MAX/MIN	9999.99
STD. DEV	3.12
COEF VAR	1.14

PLANNING BOARD
TOWN OF BETHLEHEM
ALBANY COUNTY, NEW YORK

This Site Plan Approved.

Paul D. Miller
Title: *Chairman*
SPN 138

Date: 4/1/07

Reference File Number

McDonald's Restaurant
132 Delaware Ave
Bethlehem, NY

Revision Number	Date
"E"	08/23/07

Drawn By: J.A.J.

Designer: Jim Johns

Reviewed By: Carolyn Johns

Date:	Scale:
06/10/06	1"=40'

Southco Job Number
060603E

THIS DRAWING IS THE PRIVATE PROPERTY OF SECURITY LIGHTING, INC. AND MUST BE RETURNED UPON REQUEST. THIS DRAWING MAY NOT BE COPIED OR REPRODUCED, IN WHOLE OR PART, WITHOUT THE EXPRESSED WRITTEN CONSENT OF C.J. ENTERPRISES.

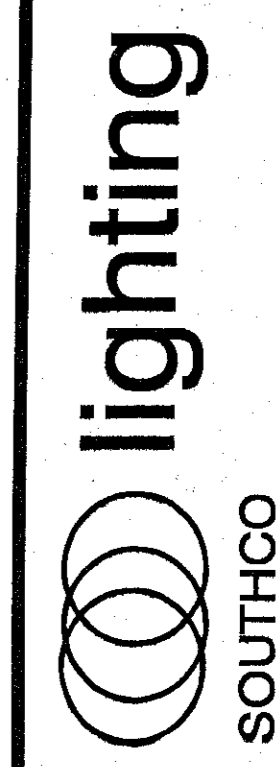

SOUTHCO
7006 Christopher Dr.
St. Louis, MO 63129
Phone : 314-846-9900 Fax: 314-846-4501
E-MAIL: SouthcoLighting@Charter.net - WEB SITE: www.southcolighting.com

Representing: SECURITY LIGHTING, INC. A HUBBELL LIGHTING CO.