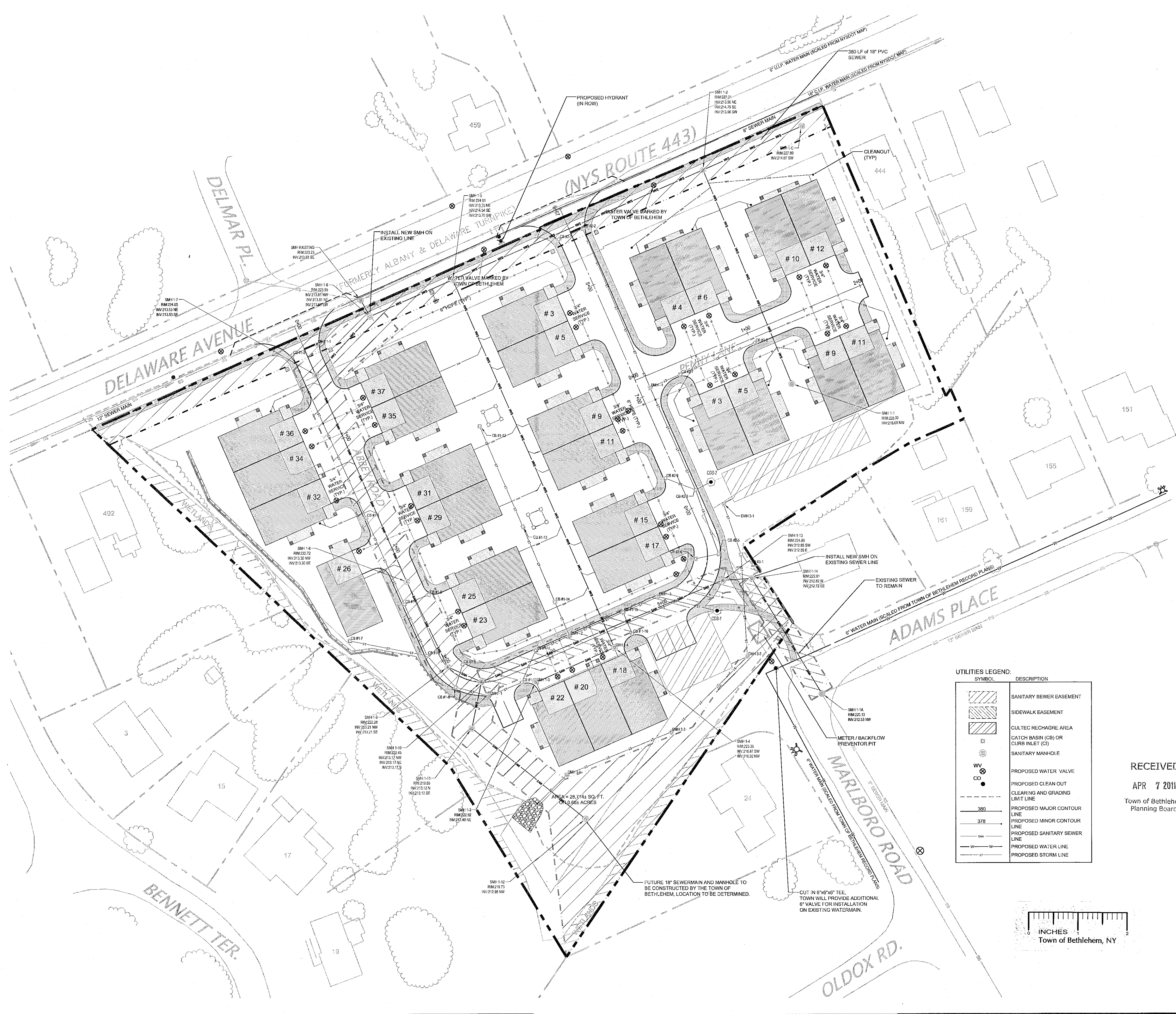

FIG. 11 WEYBOSICH BUILDERS/DELMAR/DRAWINGS/PRELIMINARY SITE PLAN SELECT UTILITY PLANNING. Scale: 1/4" = 40'. 4/2/2011 11:36:48 AM. Plotted: 4/2/2011 11:40:07 AM. User: hrd.Randow



UTILITY NOTES:

1. LOCATION OF UTILITIES PUBLIC AND/OR PRIVATE, INDICATED AS EXISTING AND/OR TO BE CONSTRUCTED AS SHOWN ON THE PLANS ARE APPROXIMATE ONLY. THEIR EXACT LOCATION SHALL BE DETERMINED IN THE FIELD. ADDITIONAL UTILITY LINES, WHETHER ABANDONED OR IN SERVICE, MAY EXIST AND IT SHALL BE THE CONTRACTOR'S RESPONSIBILITY TO CONDUCT OPERATIONS AND TAKE THE NECESSARY PRECAUTIONS TO PREVENT INTERFERENCE WITH, OR DAMAGE TO, THESE OR OTHER FACILITIES DURING THE COURSE OF CONSTRUCTION.
2. IN THE EVENT THE CONTRACTOR DAMAGES AN EXISTING UTILITY SERVICE CAUSING INTERRUPTION IN SAID SERVICE, THE CONTRACTOR SHALL IMMEDIATELY COMMENCE WORK TO RESTORE SERVICE AND MAY NOT CEASE WORK OPERATIONS UNTIL SERVICE IS RESTORED.
3. THE METHOD OF REMOVAL OF EXISTING ROADWAY OR SHOULDER PAVEMENT IN THE IMMEDIATE VICINITY OF UNDERGROUND UTILITIES SHALL BE SUBJECT TO THE APPROVAL OF THE ENGINEER.
4. THE SITE CONTRACTOR SHALL REFER TO THE BUILDING MECHANICAL AND PLUMBING PLANS FOR THE EXACT LOCATIONS AND INVERTS OF ALL THE BUILDING SERVICE CONNECTIONS.
5. THE SITE CONTRACTOR IS ADVISED THAT THE BUILDING CONTRACTOR SHALL BRING ALL UTILITY SERVICES TO A POINT FIVE (5) FEET OUTSIDE THE EXTERIOR FACE OF THE BUILDING WALL. THE EXTENSION OF ALL UTILITIES BEYOND THIS POINT IS THE RESPONSIBILITY OF THE SITE CONTRACTOR.
6. THE SITE CONTRACTOR IS ADVISED THAT OTHER CONTRACTOR AND/OR UTILITY COMPANIES SHALL BE WORKING IN THE AREA AT THE SAME TIME. THE CONTRACTOR SHALL COORDINATE HIS WORK SUCH THAT THERE WILL BE NO CONFLICT IN OPERATIONS.
7. WATER - 6" MINIMUM COVER
8. SEWER - 4" MINIMUM COVER

PRIVATE UTILITIES:

1. THE CONTRACTOR SHALL NOT INSTALL ANY PORTION OF THE PAVEMENT SECTION INCLUDING CURBING UNTIL ALL PRIVATE UTILITY AND/OR CONDUITS HAVE BEEN INSTALLED.
2. THE SITE CONTRACTOR SHALL BE RESPONSIBLE FOR TRENCH EXCAVATION AND BACKFILL FOR ALL GAS, ELECTRIC AND TELEPHONE LINES/CONDUITS. EXCAVATION AND BACKFILL MATERIAL SHALL CONFORM TO THE REQUIREMENTS OF THE INDIVIDUAL UTILITY COMPANY.
3. THE CONTRACTOR SHALL REFER TO PLANS PREPARED BY EITHER THE APPROPRIATE UTILITY COMPANY OR THE SITE ELECTRICAL ENGINEER FOR THE EXACT LOCATION, SIZE AND TYPE OF THE PROPOSED GAS, ELECTRIC OR TELEPHONE SYSTEMS. ANY LOCATIONS SHOWN ON THESE DRAWINGS ARE PRELIMINARY AND SHOULD NOT BE USED FOR CONSTRUCTION.
4. ALL ROOF DRAINSGUTTERS SHALL BE CONNECTED DIRECTLY TO THE STORM PIPE SYSTEM.
5. FOR STORM, SANITARY AND WATER SYSTEM DETAILS SEE TOWN OF BETHLEHEM STANDARD DETAIL SHEETS ATTACHED TO THIS DRAWING SET.

PUBLIC UTILITIES:

1. NEW 18" SANITARY SEWER LINE TO BE LAID @ SLOPE = 0.12%
2. ALL 18" SEWER MAIN WITHIN EASEMENT AREA SHALL BE CONSTRUCTED IN ACCORDANCE WITH THE TOWN OF BETHLEHEM STANDARDS AND DETAILS.
3. THE EXISTING SANITARY SEWER EASEMENT IS TO BE ABANDONED BY THE TOWN OF BETHLEHEM AND REVERTED BACK TO THE APPLICANT.

LEGEND:

—	EXISTING WATER LINE
—SS—	EXISTING SANITARY LINE
—G—	EXISTING GAS LINE
—CHW—	EXISTING OVERHEAD UTILITY LINE
- - -	EXISTING CONTOUR
- - - - -	PROPERTY LINE
⊙	PROPERTY CORNER
⊙	PROPERTY CORNER FOUND
⊙	EXISTING SIGNAGE
⊙	EXISTING UTILITY POLE
⊙	EXISTING UNIVERSAL MANHOLE
⊙	EXISTING SANITARY MANHOLE
⊙	EXISTING CATCH BASIN
⊙	EXISTING HYDRANT
⊙	EXISTING AT&T CABLE MARKER
⊙	EXISTING AT&T CABLE AS FLAGGED
⊙	EXISTING WATER VALVE
⊙	EXISTING VERIZON MANHOLE
⊙	EXISTING AT&T CABLE MARKER
⊙	EXISTING CORRUGATED METAL PIPE
⊙	EXISTING PLANTER
⊙	EXISTING WELAND FLAG
⊙	EXISTING TREES
⊙	EXISTING TREE LINE

UTILITIES LEGEND:

SYMBOL	DESCRIPTION
[Hatched Box]	SANITARY SEWER EASEMENT
[Hatched Box]	SIDEWALK EASEMENT
[Hatched Box]	CULTEC RECHARGE AREA
[Hatched Box]	CATCH BASIN (CB) OR CURB INLET (CI)
⊙	SANITARY MANHOLE
⊙	PROPOSED WATER VALVE
⊙	PROPOSED CLEAN OUT
—	CLEARING AND GRADING LIMIT LINE
—380—	PROPOSED MAJOR CONTOUR LINE
—378—	PROPOSED MINOR CONTOUR LINE
—SAN—	PROPOSED SANITARY SEWER LINE
—W—W—	PROPOSED WATER LINE
—ST—	PROPOSED STORM LINE

RECEIVED
APR 7 2011
Town of Bethlehem
Planning Board

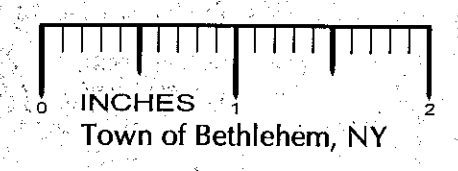

TOWN OF BETHLEHEM APPROVAL

PLANNING BOARD
TOWN OF BETHLEHEM
ALBANY COUNTY, NEW YORK

This Site Plan Approved by
George J. Jurek
Title: Chairman

Date: 4/13/2011 SPA153A2

infinigly
engineering

11 Herbert Drive
Latham, New York 12110
(518) 690-0790

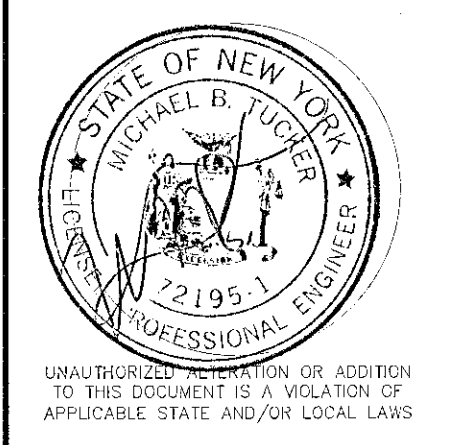

No.	Submital / Revision	App'd	Date
5	TOWN COMMENTS	MBT	4/11
4	TOWN COMMENTS	MBT	3/11
3	TOWN COMMENTS	MBT	1/11
2	TOWN COMMENTS	MBT	12/10
1	TOWN COMMENTS	MBT	12/10

Drawn: MBT Date: 10/10
Designed: MBT Date: 10/10
Checked: MBT Date: 10/10

Project Number
182-122

Project Title
The Gables at Delmar
Delaware Avenue
Delmar, NY 12054

Prepared For
Keystone Builders Inc.

Drawing Title
Utility Plan

Drawing Scale:
1" = 40'
Date:
4/04/2011

Issued For
SITE PLAN APPROVAL

Drawing Number
C-7