

MATCH LINE SEE SHEET C18

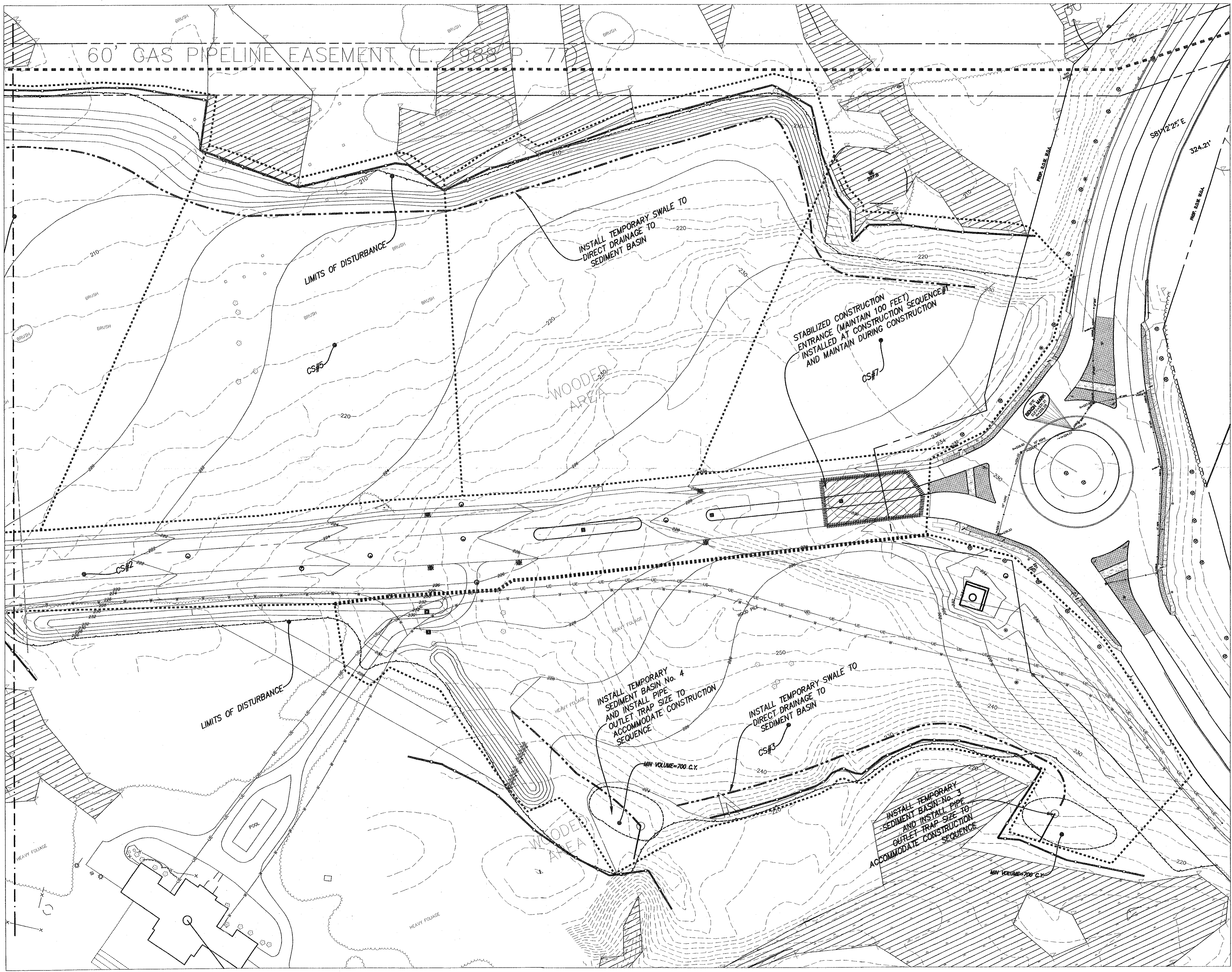

PLANNING BOARD
TOWN OF BETHLEHEM
ALBANY COUNTY, NEW YORK

This Site Plan Approved.

George J. Finner
Title: CHAIRMAN

Date: 8/22/2011 SP#169

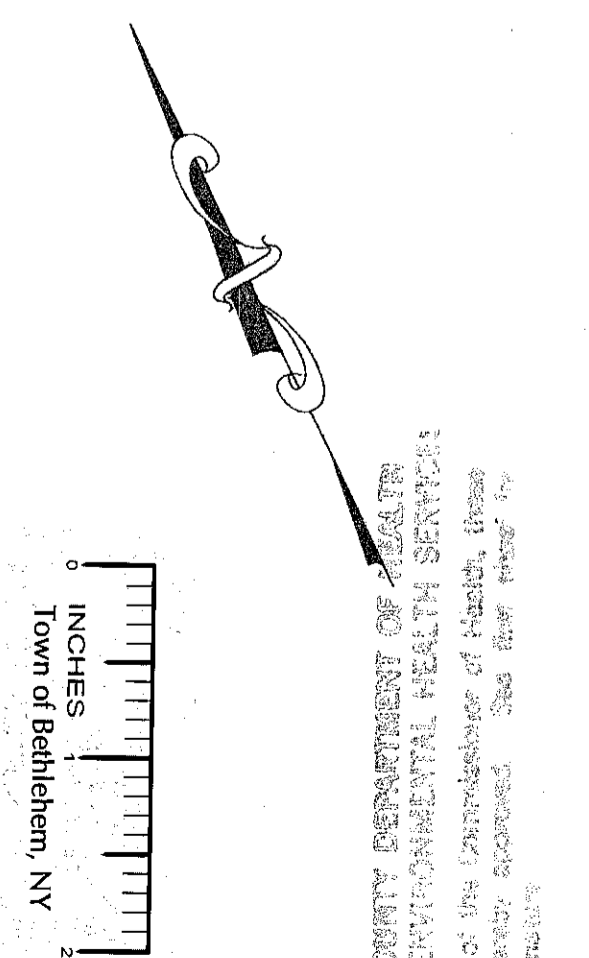

ALBANY COUNTY DEPARTMENT OF HEALTH
DIVISION OF ENVIRONMENTAL HEALTH SERVICES

By direction of the Commissioner of Health, these plans are hereby approved. See file # 169-11-001 and approvals.

HERSHBERG & HERSHBERG
Consulting Engineers and Land Surveyors
18 Locust Street
Albany, New York 12203

ALTERATION OF THIS DOCUMENT EXCEPT BY A LICENSED PROFESSIONAL ENGINEER OR LAND SURVEYOR, IS ILLEGAL.

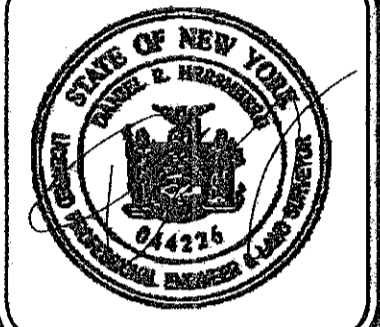

REVISIONS	DATE	REMARKS
SWPPP	11/20/08	
GENERAL	11/26/08	
TOWN COMMENTS SUBMISSION	3/30/09	
TOWN COMMENTS RE-SUBMISSION	6/8/09	
TOWN COMMENTS RE-SUBMISSION	8/19/09	
TOWN COMMENTS RE-SUBMISSION	2/8/10	

RECEIVED
AUG 12 2011
Town of Bethlehem Planning Board

FILE: 070145
SCALE: 1"=50'
CITY: WNY
CIRC: DRN
CADD: phase1.dwg
DATE: 7/27/08