

5/22/2013
 J:\36397178 Air Products Access Road Site Design\5.0 CADD\Re-Start 05_2012\36397178_profile_A&B.dgn

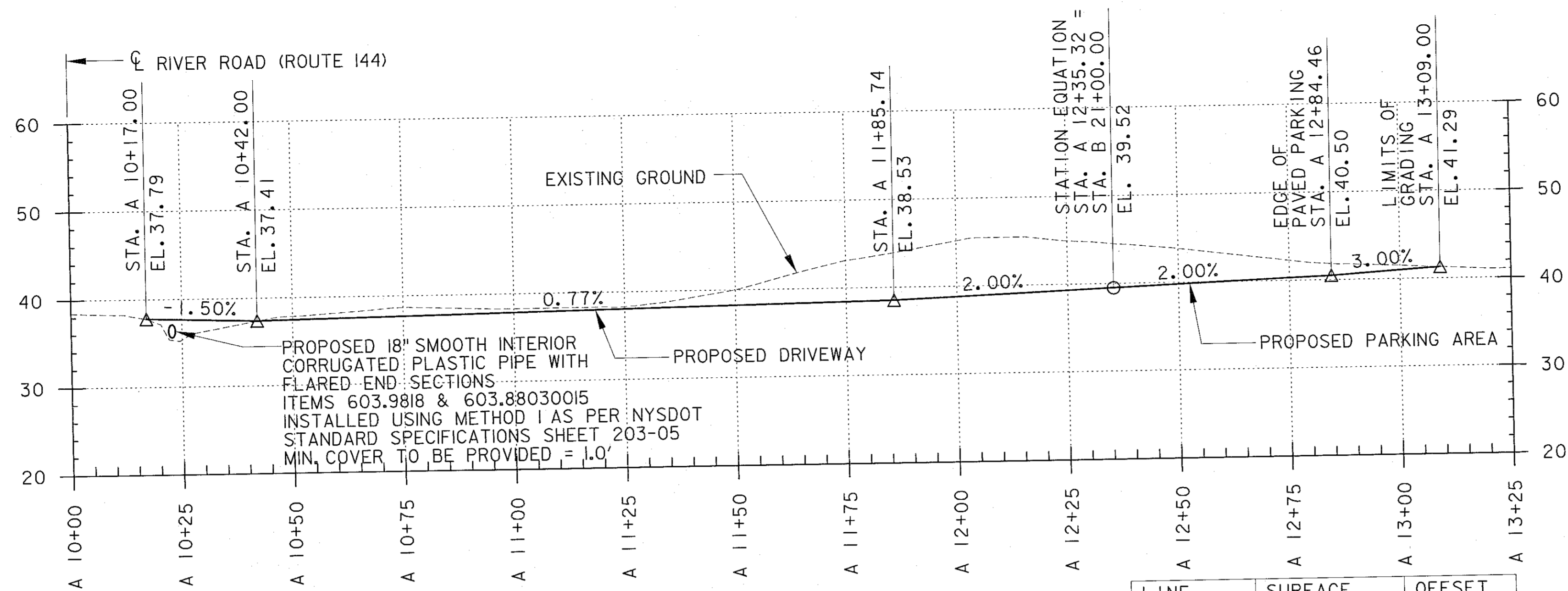

LINE	SURFACE	OFFSET
---	7178_existing	0.00
Scaled	2.0000	Times Ver.
Scaled	1.0000	Times Hor.

PROPOSED PROFILE - ALIGNMENT "A"

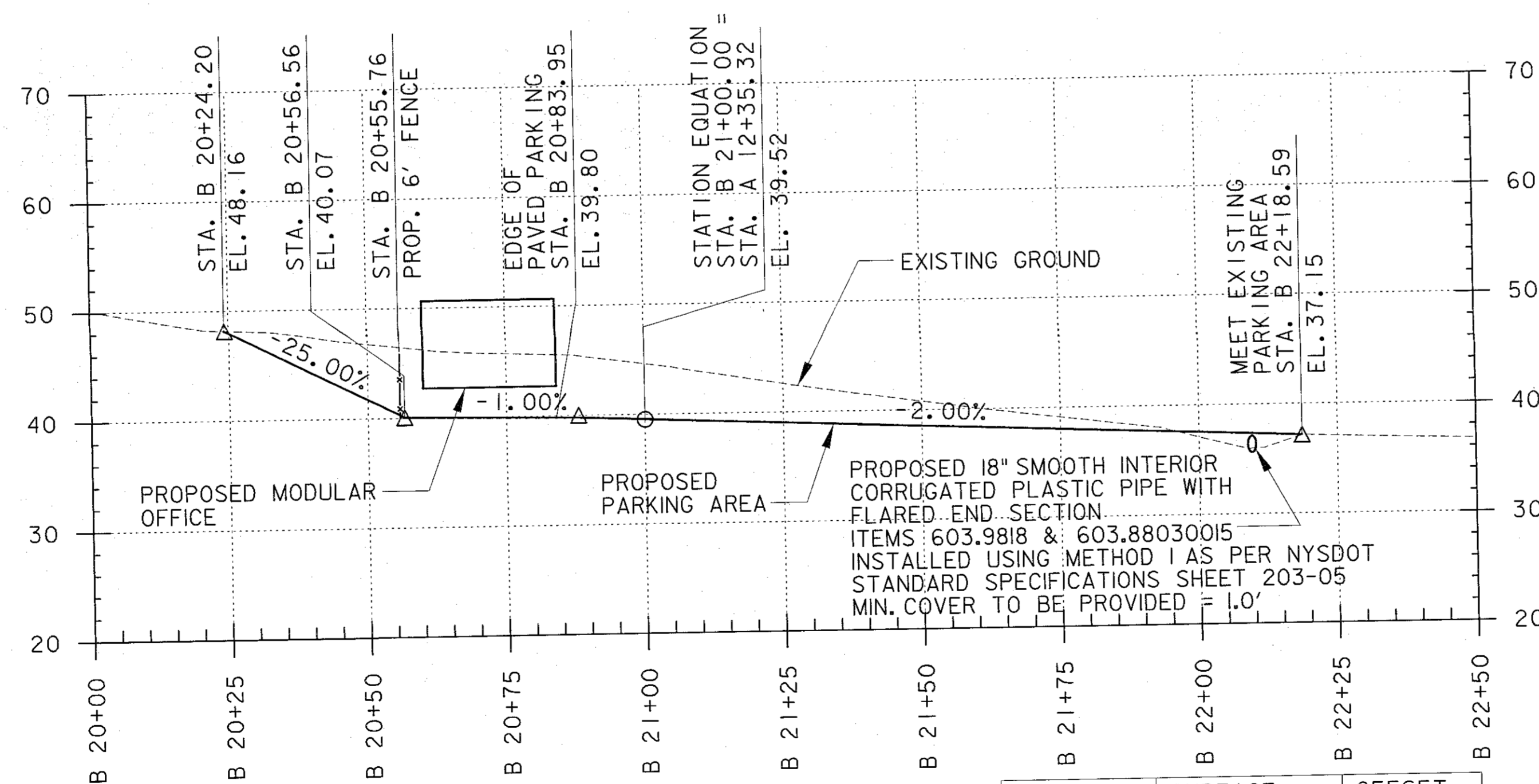

LINE	SURFACE	OFFSET
---	7178_existing	0.00
Scaled	2.0000	Times Ver.
Scaled	1.0000	Times Hor.

PROPOSED PROFILE - ALIGNMENT "B"

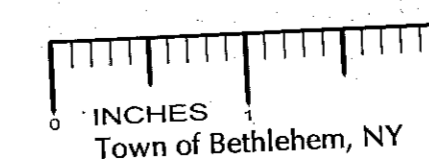

Town of Bethlehem Planning Board
 By direction of the Chairman
 these plans are hereby Approved.
 See first sheet for date & signature.



URS
URS CORPORATION
 3 CORPORATE DRIVE
 SUITE 203
 CLIFTON PARK, NY 12065
 1-(518)-688-0015

PROFESSIONAL SEAL



REVISIONS

PROJECT NO: 38397178
 DRAWN BY: A.R.Z.
 DESIGNED BY: A.R.Z.
 CHECKED BY: M.K.C.

THE INFORMATION CONTAINED IN THIS SET OF DOCUMENTS IS PROPRIETARY BY NATURE. ANY USE OR DISCLOSURE OTHER THAN THAT WHICH RELATES TO THIS PROJECT IS STRICTLY PROHIBITED.

PROPOSED ENTRANCE AND PARKING IMPROVEMENTS
GLENMONT, N.Y.
 461 RIVER ROAD (ROUTE 144)
 GLENMONT, NEW YORK

PROFILES

SCALE: AS SHOWN
 DATE: 5/22/2013
 DRAWING 5 OF 13

PR-1