

System Details;  
 System Size: 2,000kw AC 2,610kW DC  
 Estimated 1st Year Output: 3,315,463kWh  
 Module Type: 290 Watt  
 Total Modules: 9,000  
 Modules/Inverter: 2,250  
 Modules/String: 18  
 Inverter Type: 500 kW  
 Total Inverters: 4  
 Rack Type: Ground Mounted  
 Rack Configuration: 2 Rows x 18 Columns  
 Module Orientation: Portrait  
 Inter Row Distance: 16.7 feet  
 Rack Height Above Grade: 3 feet  
 Rack Attachment: Driven Posts  
 Array Tilt: 25 Degrees  
 Array Azimuth: 180 (true south)  
 Interconnection Voltage: 13.8kV  
 Utility: National Grid

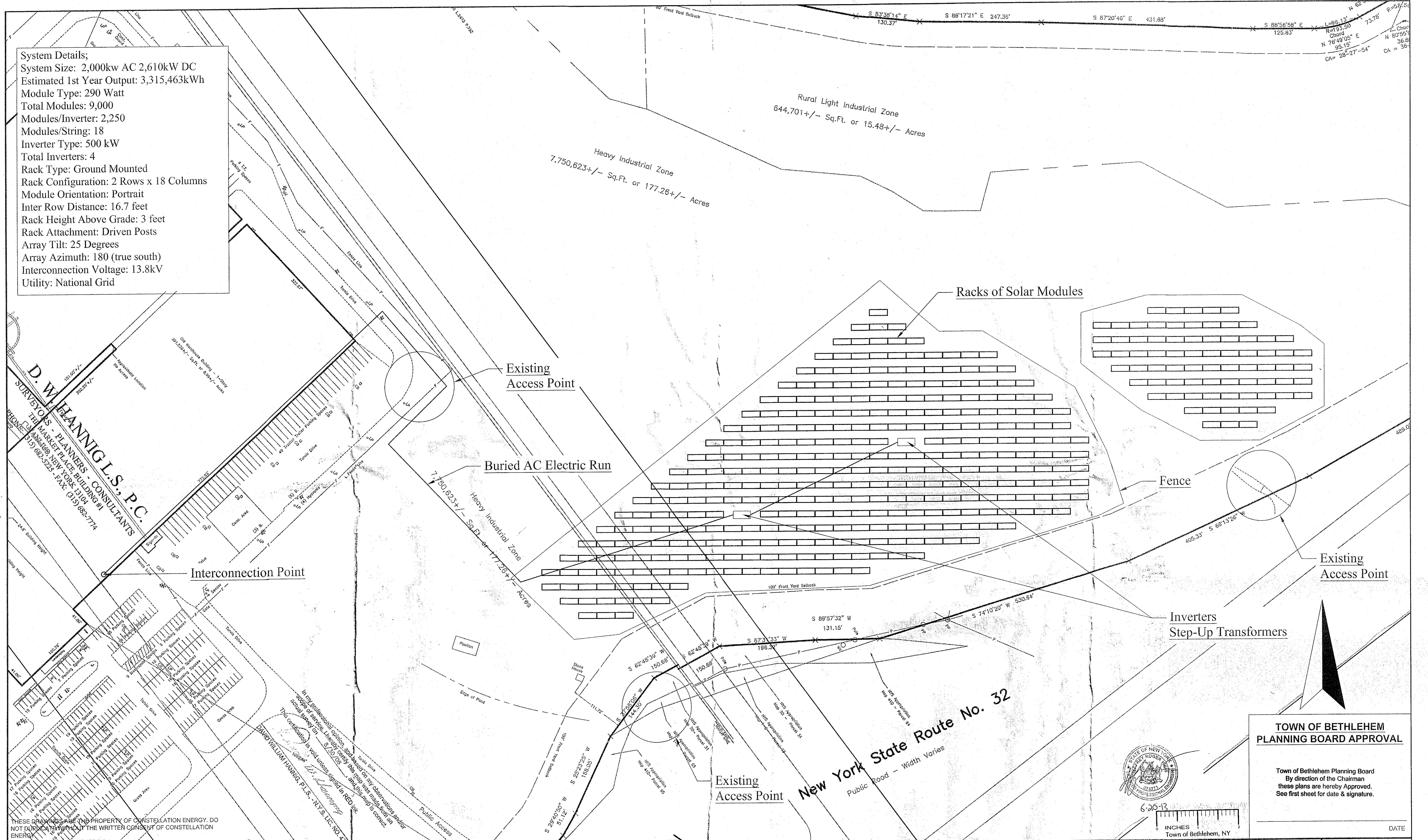

**D. W. HANNIG L.S., P.C.**  
 SURVEYORS - PLANNERS - CONSULTANTS  
 THE MARKET PLACE BUILDING #1  
 100 MARKET PLACE, NEW YORK, NY 10038  
 PHONE: (212) 682-5225 - FAX: (212) 682-7774

THESE DRAWINGS ARE THE PROPERTY OF CONSTELLATION ENERGY. DO NOT DUPLICATE WITHOUT THE WRITTEN CONSENT OF CONSTELLATION ENERGY.  
 © 2008 CONSTELLATION ENERGY

REV. NO.	DATE	DESCRIPTION	CEP&S APPROVAL

SITE ADDRESS  
 1277 FEURA BUSH ROAD  
 FEURA BUSH, NY 12067

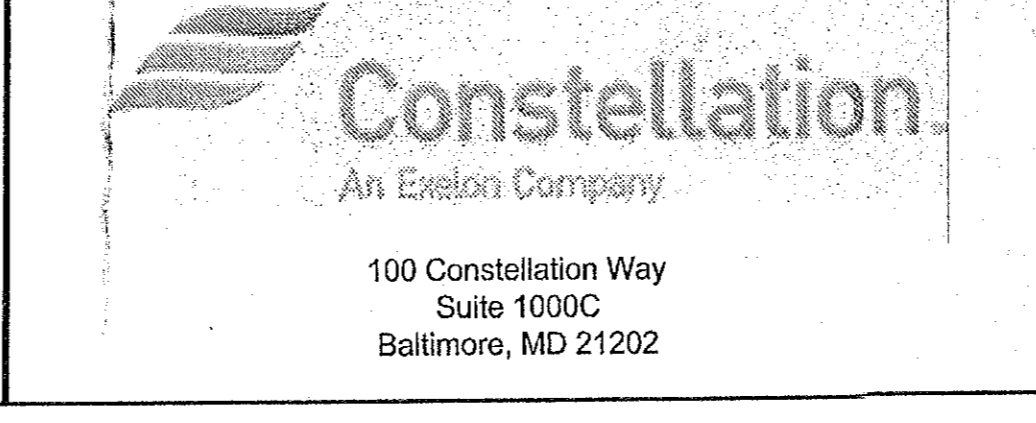

PROJECT TITLE: **OWENS CORNING PV PROJECT 2.0MW (AC) SITE PLAN**

DRAWING TITLE: **SITE PLAN 2**

DESIGNED BY:	RF	CEP&S PROJECT NO.:	112228
DRAWN BY:	RF	DRAWING NO.:	SP-2
CHECKED BY:	---	DATE:	03/28/2013

**TOWN OF BETHLEHEM PLANNING BOARD APPROVAL**

Town of Bethlehem Planning Board  
 By direction of the Chairman  
 these plans are hereby Approved.  
 See first sheet for date & signature.

