

REVISIONS		
NO.	DATE	DESCRIPTION
1	9/27/91	REV. PER TOWN ENG. DEPT.
2	10/24/91	REV. PER TOWN ENG. DEPT.
3	11/5/91	REV. PER TOWN ENG. DEPT.
4	6/8/92	STREET NO. - NAMES
5	9/23/92	PIPE BETWEEN IS 22 AND IS 23 REVISED

**ELLSWORTH AVENUE**

Lands of The Delaware and Hudson Railway Company

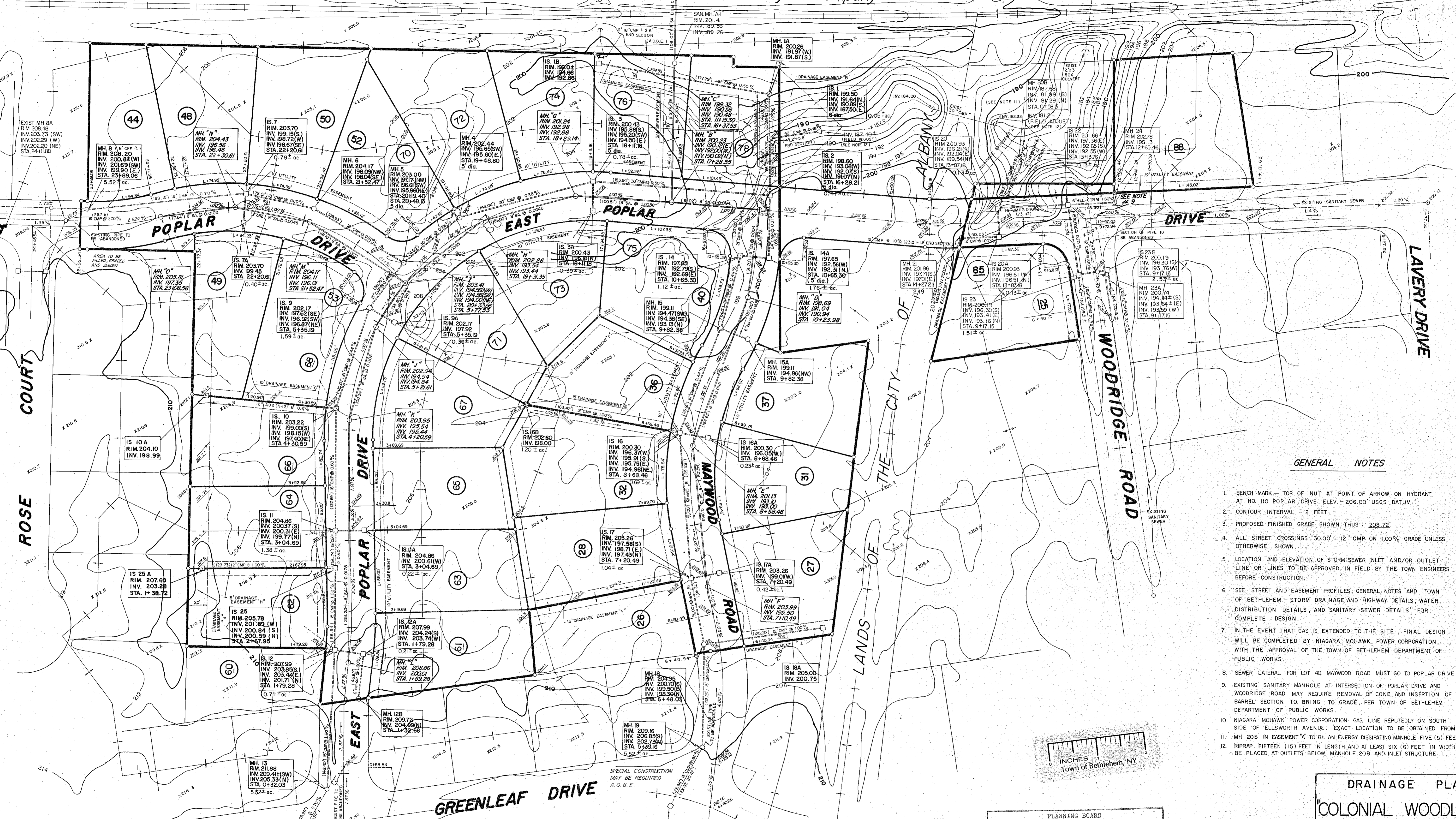

**GENERAL NOTES**

- BENCH MARK - TOP OF NUT AT POINT OF ARROW ON HYDRANT AT NO. 110 POPLAR DRIVE. ELEV. - 206.00' USGS DATUM.
- CONTOUR INTERVAL - 2 FEET
- PROPOSED FINISHED GRADE SHOWN THUS: 209.72'
- ALL STREET CROSSINGS 30.00' - 12" CMP ON 1.00% GRADE UNLESS OTHERWISE SHOWN.
- LOCATION AND ELEVATION OF STORM SEWER INLET AND/OR OUTLET LINE OR LINES TO BE APPROVED IN FIELD BY THE TOWN ENGINEERS BEFORE CONSTRUCTION.
- SEE STREET AND EASEMENT PROFILES, GENERAL NOTES AND "TOWN OF BETHELEM - STORM DRAINAGE AND HIGHWAY DETAILS, WATER DISTRIBUTION DETAILS, AND SANITARY SEWER DETAILS" FOR COMPLETE DESIGN.
- IN THE EVENT THAT GAS IS EXTENDED TO THE SITE, FINAL DESIGN WILL BE COMPLETED BY NIAGARA MOHAWK POWER CORPORATION, WITH THE APPROVAL OF THE TOWN OF BETHELEM DEPARTMENT OF PUBLIC WORKS.
- SEWER LATERAL FOR LOT 40 MAYWOOD ROAD MUST GO TO POPLAR DRIVE.
- EXISTING SANITARY MANHOLE AT INTERSECTION OF POPLAR DRIVE AND WOODRIDGE ROAD MAY REQUIRE REMOVAL OF CONE AND INSERTION OF BARREL SECTION TO BRING TO GRADE, PER TOWN OF BETHELEM DEPARTMENT OF PUBLIC WORKS.
- NIAGARA MOHAWK POWER CORPORATION GAS LINE REPUTEDLY ON SOUTH SIDE OF ELLSWORTH AVENUE. EXACT LOCATION TO BE OBTAINED FROM POWER COMPANY.
- MH 20B IN EASEMENT "A" TO BE AN ENERGY DISSIPATING MANHOLE FIVE (5) FEET IN DIAMETER.
- RIPRAP FIFTEEN (15) FEET IN LENGTH AND AT LEAST SIX (6) FEET IN WIDTH MUST BE PLACED AT OUTLETS BELOW MANHOLE 20B AND INLET STRUCTURE 1.

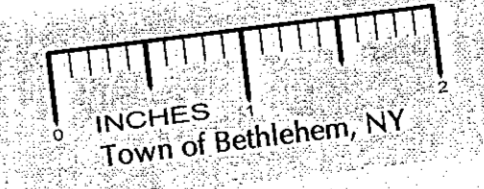

PLANNING BOARD  
TOWN OF BETHELEM  
ALBANY COUNTY, NEW YORK

**FINAL PLAT APPROVAL**

Then signed by the duly authorized officer of the Planning Board, this endorsement constitutes final approval of this Plat.

Signed: *Walter C. Fran*  
Title: CHAIRMAN

Date: MAR - 5 1993

See also Certificate of Approval of Final Plat No. 143-31-F

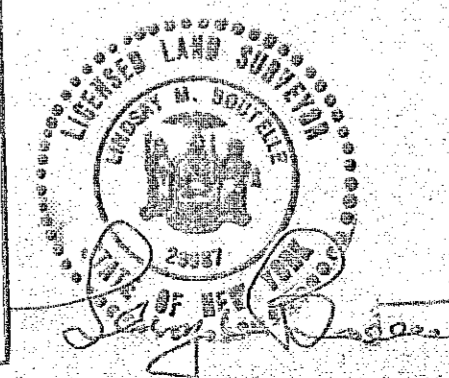

**DRAINAGE PLAN**

**"COLONIAL WOODLANDS"**

SECTION NO. 1  
PROPERTY OF  
**KARL A. PAULSEN AND SWIFT DEVELOPMENT CORPORATION**

TOWN: BETHELEM	COUNTY: ALBANY
STATE: NEW YORK	DATE: MAY 15, 1991
SCALE: 1" = 50'	REVISION NO. 5

MAP PREPARED BY  
**EDWARD W. BOUTELLE & SON**  
CIVIL ENGINEERS & SURVEYORS  
DELMAR, NEW YORK