

GENERAL SITE STATISTICS

1. PROPOSED FINISH FLOOR GARAGE ELEVATIONS ARE APPROXIMATE. ACTUAL FINISHED FLOOR ELEVATIONS WILL BE DETERMINED BY WHERE THE GARAGE IS LOCATED ON THE LOT. FINISHED FLOOR GARAGE ELEVATIONS SHALL BE A MIN. OF 18" ABOVE THE ELEVATION OF THE CENTERLINE OF THE ROAD PAVEMENT.

UNAUTHORIZED ALTERATIONS OR ADDITIONS TO THIS DOCUMENT IS A VIOLATION OF SECTION 7209 SUBDIVISION 2 OF THE NEW YORK STATE EDUCATION LAW

REVISIONS

DATE	BY	DESCRIPTION	SYMBOL
11/13/96	BKM	REVISED TOPO ON ADJACENT LOTS, ADD RIM AND INV. ELEVATIONS FOR ALL STORM STRUCTURES.	
2/7/97	C.H.	TITLE REVISED	

**EDWARD W. BOUTELL AND SON**  
 CIVIL ENGINEERS AND SURVEYORS  
 423 KENWOOD AVENUE  
 DELMAR, NEW YORK  
 TEL. (516) 439-9981 FAX. (516) 439-9982  
 A DIVISION OF J. KENNETH FRASER AND ASSOCIATES, P.E., L.S., L.A., P.C.

FINAL PLAN  
 "COLONIAL WOODLANDS"  
 SECTION NO. 2

PROPERTY OF  
 COLONIAL WOODLANDS

TOWN OF BETHLEHEM COUNTY OF ALBANY  
 STATE OF NEW YORK

SCALE: 1" = 30'

PLANNING BOARD  
 TOWN OF BETHLEHEM  
 ALBANY COUNTY, NEW YORK  
**FINAL PLAT APPROVAL**  
 WHEN SIGNED BY THE DULY AUTHORIZED OFFICER OF THE PLANNING BOARD, THIS ENDORSEMENT CONSTITUTES FINAL APPROVAL OF THIS PLAT.

SIGNED: *[Signature]*  
 TITLE: CHAIRMAN  
 DATE: MAR 13 1997

PROJ. SURVEYOR: CHJ  
 DRAWN BY: BKM  
 ASSEMBLED BY: BKM  
 CHECKED BY: CHJ

PROJECT NO.:  
 CAD FILE NAME:

SHEET TITLE:  
**GRADING PLAN**

DATE: AUG 16, 1996 SHEET 4 OF 4

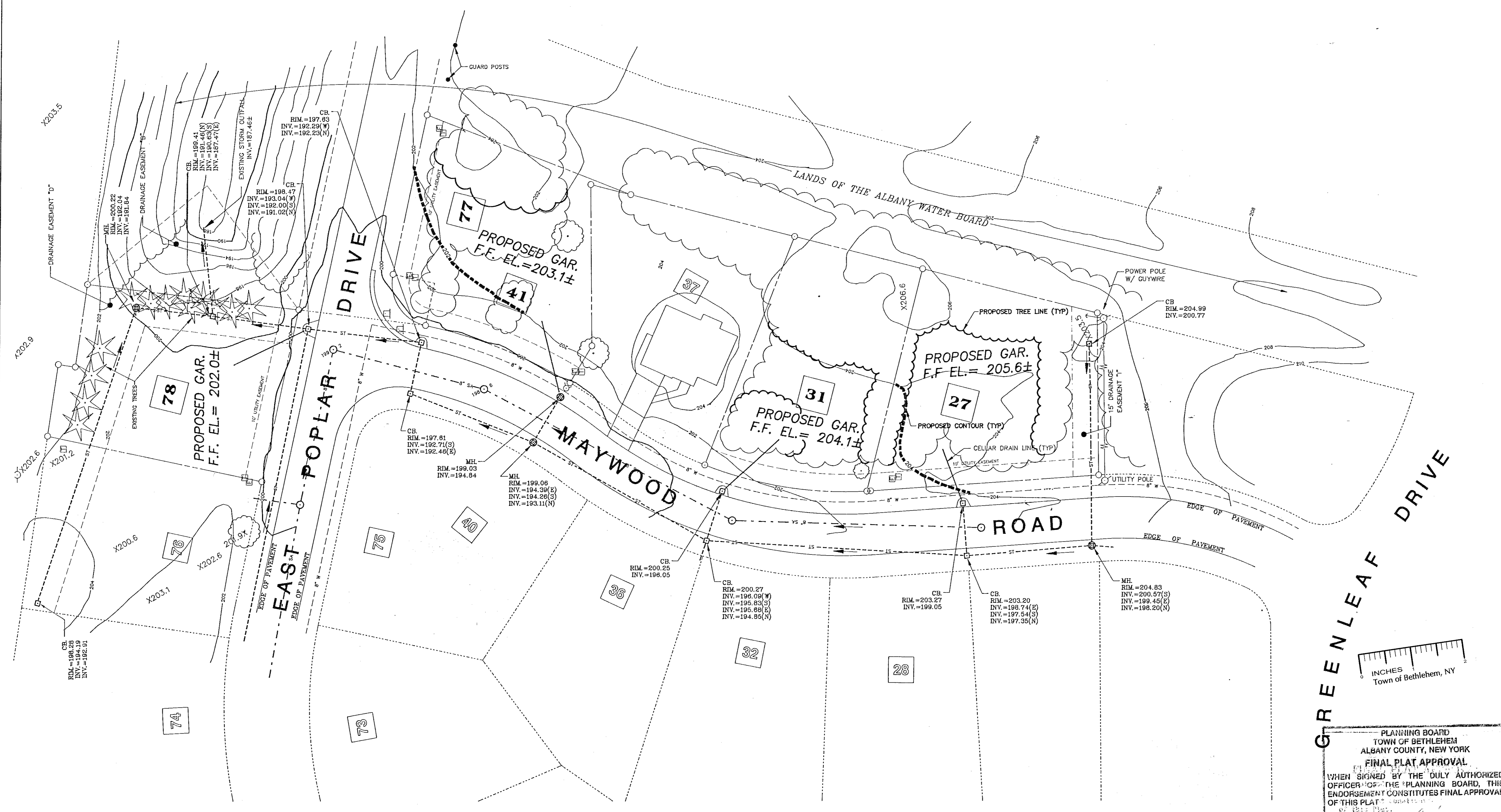

PLAN  
 SCALE: 1" = 30'

PLANNING BOARD  
 TOWN OF BETHLEHEM  
 ALBANY COUNTY, NEW YORK  
**FINAL PLAT APPROVAL**  
 WHEN SIGNED BY THE DULY AUTHORIZED OFFICER OF THE PLANNING BOARD, THIS ENDORSEMENT CONSTITUTES FINAL APPROVAL OF THIS PLAT.

SIGNED: *[Signature]*  
 TITLE: CHAIRMAN  
 DATE: MAR 13 1997

SEE ALSO CERTIFICATE OF APPROVAL  
 OF FINAL PLAT NO. 143-S2-F

