

TRINITY MANOR SUBDIVISION - PHASE IV (AND #8 & #14 ANNA COURT)

STORMWATER COLLECTION & TREATMENT SYSTEM UPGRADE

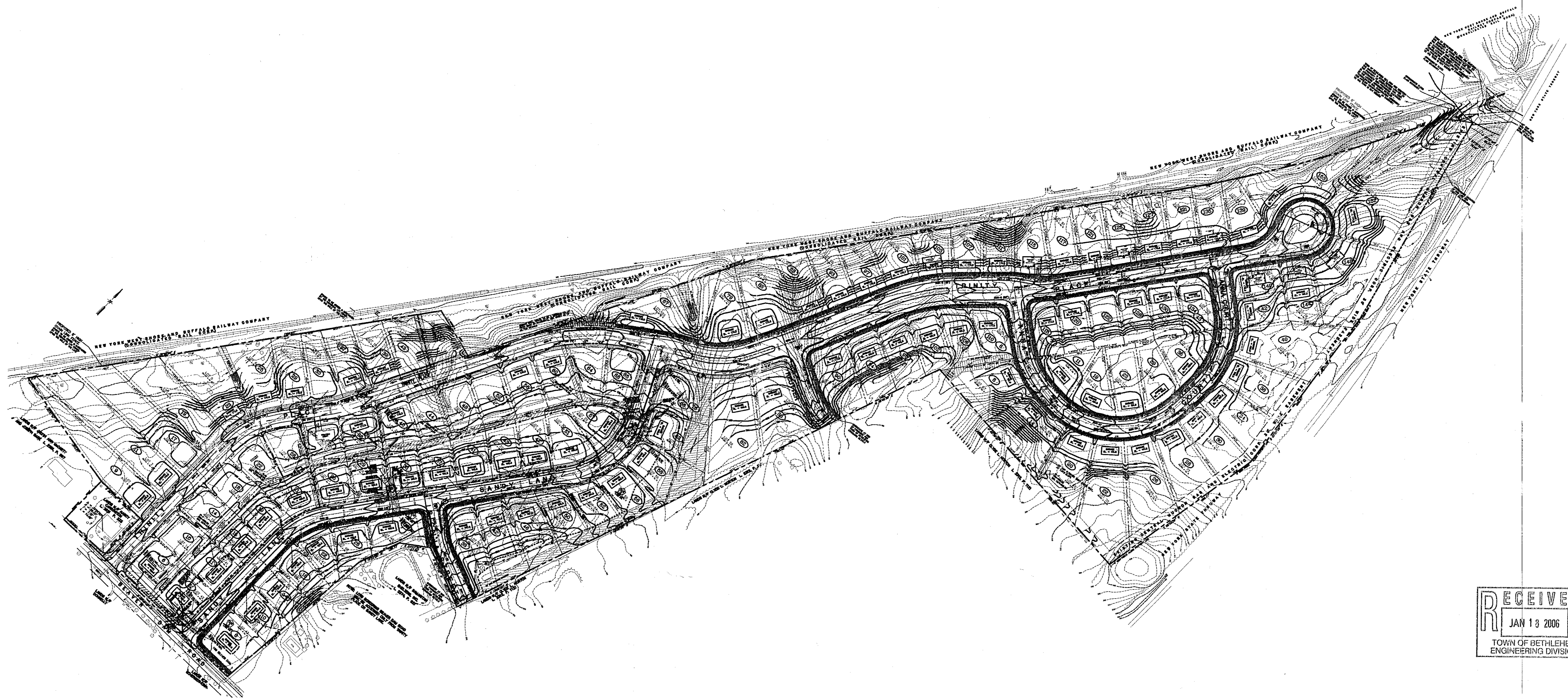

RECEIVED
 JAN 13 2006
 TOWN OF BETHLEHEM
 ENGINEERING DIVISION

	COVER SHEET
1	CONSTRUCTION PHASING PLAN
2	PHASE IV SITE PLAN - A
3	PHASE IV SITE PLAN - B
4	CDS PLANS AND PROFILES
5	CDS WATERSHED PLAN
6	CDS #1 DETAILS
6A	CDS #2 DETAILS
7	CDS #3 DETAILS
8	SOIL EROSION & SEDIMENT CONTROL PLAN - A
9	SOIL EROSION & SEDIMENT CONTROL PLAN - B
10	SOIL EROSION DETAILS
#	SHEET TITLE
	SHEET INDEX

ENGINEER:
INGALLS & ASSOCIATES, LLP
 2603 GUILDERLAND AVENUE
 SCHENECTADY, NEW YORK 12306



DEVELOPER:
ROSEWOOD HOME BUILDERS, INC.
 1202 TROY SCHENECTADY ROAD BLDG. 3
 LATHAM, NY 12110

DATE: SEPTEMBER 8, 2005
 REV: JANUARY 12, 2006

