

**EROSION CONTROL LEGEND:**

- SLOPE SETBACK LINE
- PROPOSED WORK LIMITS (CLEARING AND GRADING LIMIT LINE)
- EXISTING CONTOUR LINE
- PROPOSED 10 FT CONTOUR
- PROPOSED 2 FT CONTOUR
- PROPOSED SPOT GRADE
- DRAINAGE SWALE
- PROPOSED ORANGE CONSTRUCTION FENCE
- EROSION CONTROL BARRIER - SILT FENCE
- CHECK DAM WITH DITCH FLOW DIRECTION
- HAY OR STRAW BALE DIKE
- OUT OF PAVEMENT CATCH BASIN INLET FILTER
- IN-PAVEMENT CATCH BASIN INLET FILTER
- TEMPORARY TOPSOIL STOCKPILE
- STABILIZED CONSTRUCTION ENTRANCE
- PROPOSED RIPRAP
- EROSION CONTROL BLANKET
- PROPOSED GRAVEL ACCESS DRIVE
- FEDERAL WETLAND AREAS TO REMAIN

**EROSION AND SEDIMENT CONTROL MEASURES**

THE SOIL EROSION AND SEDIMENT CONTROL MEASURES OUTLINED HEREIN ARE CONSIDERED TO BE AN INTEGRAL PART OF THE STORMWATER POLLUTION PREVENTION PLAN.

**TEMPORARY EROSION AND SEDIMENT CONTROL MEASURES**

- GENERAL MEASURES:**
- DAMAGE TO SURFACE WATERS RESULTING FROM EROSION AND SEDIMENTATION SHALL BE MINIMIZED BY STABILIZING DISTURBED AREAS AND BY REMOVING SEDIMENT FROM CONSTRUCTION SITE DISCHARGES.
  - AS MUCH AS IS PRACTICAL, EXISTING VEGETATION SHALL BE PRESERVED. FOLLOWING THE COMPLETION OF CONSTRUCTION ACTIVITIES IN ANY PORTION OF THE SITE, PERMANENT VEGETATION SHALL BE ESTABLISHED ON ALL EXPOSED SOILS.
  - SITE PREPARATION ACTIVITIES SHALL BE PLANNED TO MINIMIZE THE SCOPE AND DURATION OF SOIL DISRUPTION.
  - PERMANENT TRAFFIC CORRIDORS SHALL BE ESTABLISHED AND "ROUTES OF CONVENIENCE" SHALL BE AVOIDED. STABILIZED CONSTRUCTION ENTRANCES SHALL BE INSTALLED AT ALL POINTS OF ENTRY ONTO THE PROJECT SITE.
  - CONSTRUCTION TRAFFIC SHALL NOT CROSS STREAMS OR DITCHES EXCEPT AT SUITABLE CROSSING FACILITIES, AND SHALL NOT OPERATE UNNECESSARILY WITHIN WATERWAYS OR DRAINAGE DITCHES.

**PARTICULAR MEASURES:**

- STABILIZED CONSTRUCTION ENTRANCE:**
- THE STABILIZED CONSTRUCTION ENTRANCE, UTILIZED DURING CONSTRUCTION, SHALL BE MAINTAINED IN A CONDITION THAT SHALL PREVENT TRACKING OR FLOWING OF SEDIMENT ONTO PUBLIC RIGHTS-OF-WAY. THIS MAY REQUIRE PERIODIC TOP DRESSING WITH ADDITIONAL STONE AS CONDITIONS DEMAND AND REPAIR AND/OR CLEANOUT OF ANY MEASURES USED TO TRAP SEDIMENT. ALL SEDIMENT SPILLED, DROPPED, WASHED, OR TRACKED ONTO PUBLIC RIGHTS-OF-WAY MUST BE REMOVED IMMEDIATELY.
  - WHEELS SHALL BE CLEANED TO REMOVE SEDIMENT PRIOR TO ENTRANCE ONTO PUBLIC RIGHTS-OF-WAY. WHEN WASHING IS REQUIRED, IT SHALL BE DONE ON AN AREA STABILIZED WITH STONE AND WHICH DRAINS INTO AN APPROVED SEDIMENT TRAPPING DEVICE.
  - PERIODIC INSPECTIONS AND NEEDED MAINTENANCE SHALL BE PROVIDED AFTER EACH RAIN.
  - STORM DRAIN SEDIMENT FILTER: PRIOR TO THE COMMENCEMENT OF CONSTRUCTION, STORM DRAIN INLET FILTERS SHALL BE CONSTRUCTED AT EXISTING STORM DRAINS AS REQUIRED. THEY SHALL BE MAINTAINED IN GOOD CONDITION UNTIL FINAL VEGETATIVE COVER IS WELL ESTABLISHED ON ALL DISTURBED AREAS UPSTREAM OF THE INLET.
  - IMMEDIATELY FOLLOWING COMPLETION OF ANY AND ALL OF THE PROPOSED STORM DRAIN INLETS, STORM DRAIN INLET FILTERS SHALL BE CONSTRUCTED. THESE SHALL FUNCTION TO PREVENT SEDIMENT ENTRANCE INTO THE STORM DRAINS. THEY SHALL BE MAINTAINED IN GOOD CONDITION UNTIL FINAL VEGETATIVE COVER IS WELL ESTABLISHED ON ALL DISTURBED AREAS UPSTREAM OF THE INLET.
  - DRAINAGE DITCH SEDIMENT FILTERS: UNTIL SUCH TIME AS FINAL SITE STABILIZATION IS COMPLETED, DITCHES SHALL RECEIVE TREATMENT WITH STONE CHECK DAMS SO AS TO EFFECTIVELY TRAP SEDIMENT AND MINIMIZE ITS RELEASE OFF-SITE. STONE CHECK DAMS SHALL BE CONSTRUCTED WITHIN EACH DITCH BEGINNING AT ITS DOWNSTREAM TERMINUS AND SHOULD BE PLACED AT INTERVALS OF LESS THAN 100 FEET.
  - SILT FENCES: SILT FENCES SHALL BE CONSTRUCTED AROUND ALL STOCKPILES OF FILL, TOPSOIL, AND EXCAVATED OVERBORDEN THAT ARE TO REMAIN EXPOSED FOR PERIODS LESS THAN 30 DAYS. SILT FENCES SHALL BE ANCHORED AND MAINTAINED IN GOOD CONDITION UNTIL SUCH TIME AS S40 STOCKPILES ARE REMOVED AND STOCKPILING AREAS ARE BROUGHT TO FINAL GRADE AND PERMANENTLY STABILIZED.
  - TOPSOIL AND FILL THAT IS TO REMAIN STOCKPILED ON-SITE FOR PERIODS GREATER THAN 30 DAYS SHALL BE STABILIZED BY SEEDING. PRIOR TO THE SEEDING OPERATION, THE STOCKPILED MATERIAL SHALL BE GRADED AS NEEDED AND FEASIBLE TO PERMIT THE USE OF CONVENTIONAL EQUIPMENT FOR SEEDING PREPARATION, SEEDING, MULCH APPLICATION, AND MULCH ANCHORING.
  - IN NO CASE SHALL ERODIBLE MATERIALS BE STOCKPILED WITHIN 25 FEET OF ANY DITCH, STREAM, OR OTHER SURFACE WATER BODY.

**PERMANENT EROSION AND SEDIMENT CONTROL MEASURES:**

- PERMANENT VEGETATIVE COVER: IMMEDIATELY FOLLOWING THE COMPLETION OF CONSTRUCTION ACTIVITY IN ANY PORTION OF THE SITE, PERMANENT VEGETATION SHALL BE ESTABLISHED ON ALL EXPOSED SOILS. ALL DISTURBED AREAS SHALL BE SEED AND MULCH AS SOON AS PRACTICAL, FOLLOWING DISTURBANCE TO STABILIZE BARE SOIL AND PROMOTE THE PROMPT RE-ESTABLISHMENT OF VEGETATION:
  - A. AN ADEQUATE SEEDBED SHALL BE PREPARED BY SCARIFYING COMPACTED SOIL AND REMOVING SURFACE DEBRIS AND OBSTACLES.
  - B. LIME SHALL BE APPLIED SUFFICIENTLY TO ATTAIN A SOIL ACIDITY pH OF 6.0 TO 7.0.
  - C. FERTILIZER (5-10-10 MIXTURE OR EQUIVALENT) SHALL BE APPLIED PER SOIL TEST RESULTS OR AT A RATE OF 600 LBS. PER ACRE.
  - D. DISTURBED AREAS WHICH WILL REMAIN TEMPORARILY FALLOW FOR PERIODS GREATER THAN 14 DAYS SHALL BE SEED AT THE FOLLOWING RATE TO PRODUCE TEMPORARY GROUND COVER: 30 LBS. REGRESS (ANNUAL OR PERENNIAL) PER ACRE. DURING THE WINTER, USE 100 LBS. CERTIFIED "ARBOREAL" WINTER RYE (CEREAL RYE) PER ACRE.
  - E. PERMANENT SEEDING SHALL BE APPLIED ON 4" MIN TOPSOIL AT THE FOLLOWING RATE FOR ROUGH OR OCCASIONAL MOWING AREAS:
    - 8 LBS EMPIRE BIRDS FOOT TREFLOE OR COMMON WHITE CLOVER PER ACRE
    - 20 LBS TALL FESCUE PER ACRE ELIUS
    - 2 LBS RED TOP OR 5 LBS RYE GRASS (PERENNIAL) PER ACRE
  - F. ALL SEEDING SHALL BE PERFORMED USING THE BROADCAST METHOD OR HYDRO SEEDING, UNLESS OTHERWISE APPROVED.
  - G. ALL DISTURBED AREAS SHALL BE STABILIZED SUBSEQUENT TO SEEDING BY APPLYING 2 TONS OF STRAW MULCH PER ACRE. STRAW MULCH SHALL BE ANCHORED BY APPLYING 750 LBS OF WOOD FIBER MULCH PER ACRE WITH A HYDRO SEEDER, OR TUCKING THE MULCH WITH SHOOTH BISSOR OR OTHER MULCH ANCHORING TOOLS TO A DEPTH OF 3". MULCH ANCHORING TOOLS SHALL BE PULLED ACROSS SLOPES ALONG TOPOGRAPHIC CONTOURS.
- ALL UNNECESSARY REMOVAL OF HEALTHY TREES SHALL BE AVOIDED. MATERIALS SHALL NOT BE STORED NOR MACHINERY OPERATED WITHIN THE DRIP-LINE OF THE TREES TO REMAIN.
- ALL SLOPES OF 2:1 OR STEEPER ARE TO BE STABILIZED WITH STONE RIP RAP AND SOIL STABILIZATION FABRIC WHEN APPLICABLE.

**MAINTENANCE OF EROSION AND SEDIMENT CONTROL MEASURES:**

- THE DEVELOPER/CONTRACTOR OR HIS BUILDER SHALL ON A DAILY BASIS INSPECT AND MAINTAIN THE INTEGRITY AND FUNCTION OF ALL TEMPORARY EROSION CONTROL MEASURES THROUGHOUT THE DURATION OF THE DEVELOPMENT PROCESS. THE DEVELOPER SHALL HAVE A QUALIFIED PROFESSIONAL INSPECT ALL EROSION AND SEDIMENT CONTROL MEASURES AT LEAST EVERY 7 CALENDAR DAYS AND WITHIN 24 HOURS OF THE END OF A STORM EVENT OF 0.1 INCHES OR GREATER. A LOG OF ALL SITE INSPECTIONS SHALL BE MAINTAINED ON SITE AND MADE AVAILABLE FOR REVIEW BY THE PERMITTING AUTHORITY.
- TO ASSURE PROPER FUNCTION, SILTATION BARRIERS SHALL BE MAINTAINED IN GOOD CONDITION AND REINFORCED, EXTENDED, REPAIRED, OR REPLACED AS NECESSARY. WASHOUTS SHALL BE IMMEDIATELY REPAIRED, RE-SEED, AND PROTECTED FROM FURTHER EROSION.
- ALL ACCUMULATED SEDIMENT SHALL BE REMOVED AND CONTAINED IN APPROPRIATE SPOIL AREAS.
- WATER SHALL BE APPLIED TO NEWLY SEEDD AREAS AS NEEDED UNTIL GRASS COVER IS WELL ESTABLISHED. WATER SHALL BE APPLIED TO EXPOSED SOILS, AS NECESSARY, TO EFFECTIVELY CONTROL WIND EROSION OF THE PROJECT SITE AS DESIGNED.
- SEDIMENT SHALL BE REMOVED FROM BEHIND THE SEDIMENT FENCE WHEN IT BECOMES ABOUT 0.5 FT DEEP AT THE FENCE. THE SEDIMENT FENCE SHALL BE REPAIRED AS NECESSARY TO MAINTAIN BARRIER.
- ALL SEEDD AREAS SHALL BE FERTILIZED, RESEEDD AS NECESSARY, AND MULCHED ACCORDING TO SPECIFICATIONS IN THE VEGETATIVE PLAN TO MAINTAIN A VIGOROUS, DENSE VEGETATIVE COVER.

MATCH LINE - SEE SHEET SS.1 & SS.2

MATCH LINE - SEE SHEET SS.2

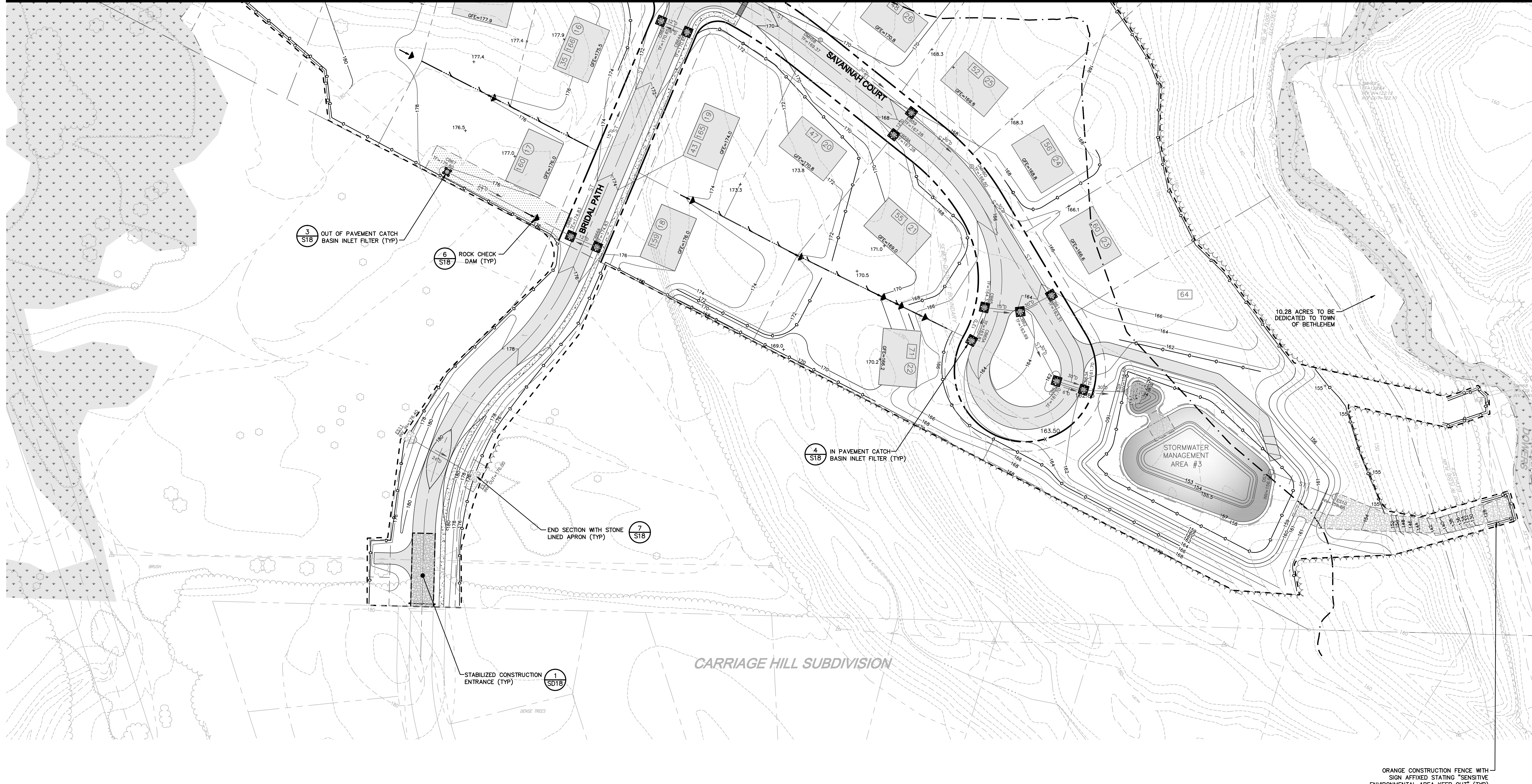

**APPLICANT:**  
 ALEXANDRE HOMES  
 1900 WESTERN AVENUE  
 ALBANY, NY 12203  
 PH: (518) 456-1100  
 FAX: (518) 456-1999



ALL RIGHTS RESERVED. COPY OR REPRODUCTION OF THIS PLAN OR ANY PORTION THEREOF IS PROHIBITED WITHOUT THE WRITTEN PERMISSION OF THE DESIGN ENGINEER, SURVEYOR, OR ARCHITECT. ALTERATION OF THIS DRAWING, EXCEPT BY A LICENSED P.E. IS ILLEGAL. ANY ALTERATION BY A P.E. MUST BE INDICATED AND BEAR HIS SEAL, SIGNATURE, AND DATE OF ALTERATION.

**THE CHAZEN COMPANIES**  
 Engineers/Surveyors  
 Planners  
 Environmental Scientists

**CHAZEN ENGINEERING & LAND SURVEYING CO., P.C.**

Dutchess County Office: 21 Fox Street, Poughkeepsie, New York 12601, Phone: (845) 454-3980  
 Capital District Office: 547 River Street, Troy, New York 12180, Phone: (518) 273-0005  
 Orange County Office: 356 Main Street, Newburgh, New York 12550, Phone: (845) 567-1133  
 North Country Office: 100 Glen Street, Oneida, New York 13621, Phone: (315) 812-0515

REV.	DATE	DESCRIPTION
8	2/19/09	REVISED GRADING
7	6/13/08	REVISED PER TOWN 5/13/08 COMMENTS
6	02/26/08	GENERAL REVISIONS PER TOWN AND ADCC COMMENTS
5	9/27/07	REV PER TOWN 5/23/07 COMMENTS
4	2/20/07	REVISED BASIN LOCATIONS
3	9/15/06	REVISED PER TOWN 7/12/06 COMMENTS
2	12/27/05	GENERAL REVISIONS
1	3/4/05	REVISED PER TOWN COMMENTS
rev.	DATE	DESCRIPTION

**ELM AVENUE EAST RESIDENTIAL DEVELOPMENT**

**EROSION AND SEDIMENT CONTROL PLAN**

TOWN OF BETHLEHEM, ALBANY COUNTY, NEW YORK

drawn: CJB  
 checked: JML  
 date: 12/19/03  
 scale: 1"=50'  
 project no.: 30337.00  
 sheet: **SS.3**