

### LEGEND

- 354 --- CONTOUR
- WATERLINE
- SANITARY SEWER
- STORM SEWER
- LOT LINE
- R.O.W. LINE
- HYDRANT AND VALVE
- HYDRANT
- WATER VALVE
- SANITARY MANHOLE
- CATCH BASIN
- CATCH BASIN
- STREET NUMBER
- LOT NUMBER
- PROPERTY CORNER TO BE SET
- LIMIT OF CLEARING & GRADING
- TEST PIT LOCATION
- AREAS OF SLOPES > 20%
- WETLAND AREAS
- SILT FENCE

### GRADING NOTES:

- CONTRACTOR MUST PROTECT ALL SURFACE WATERS FROM SILTATION DURING CONSTRUCTION WITH APPROPRIATE MEASURES INCLUDING, BUT NOT LIMITED TO, PLACING STRAW BALES AND SILTATION FENCING AROUND WORK. AS A MINIMUM, STRAW BALES AND SILTATION FENCING SHALL BE PLACED AS SHOWN ON THE EROSION CONTROL PLAN AND IN ALL DRAINAGE SWALES AT INTERVALS REQUIRED TO CONTROL SILTATION UNTIL RIP-RAP IS INSTALLED. AFTER RIP-RAP IS INSTALLED, PROTECT RIP-RAP FROM SILTATION.
- THE CLEARING AND GRADING LIMIT LINE SHALL BE MARKED IN THE FIELD AND SILT FENCE INSTALLED PRIOR TO THE COMMENCEMENT OF CLEARING AND GRADING OPERATIONS.

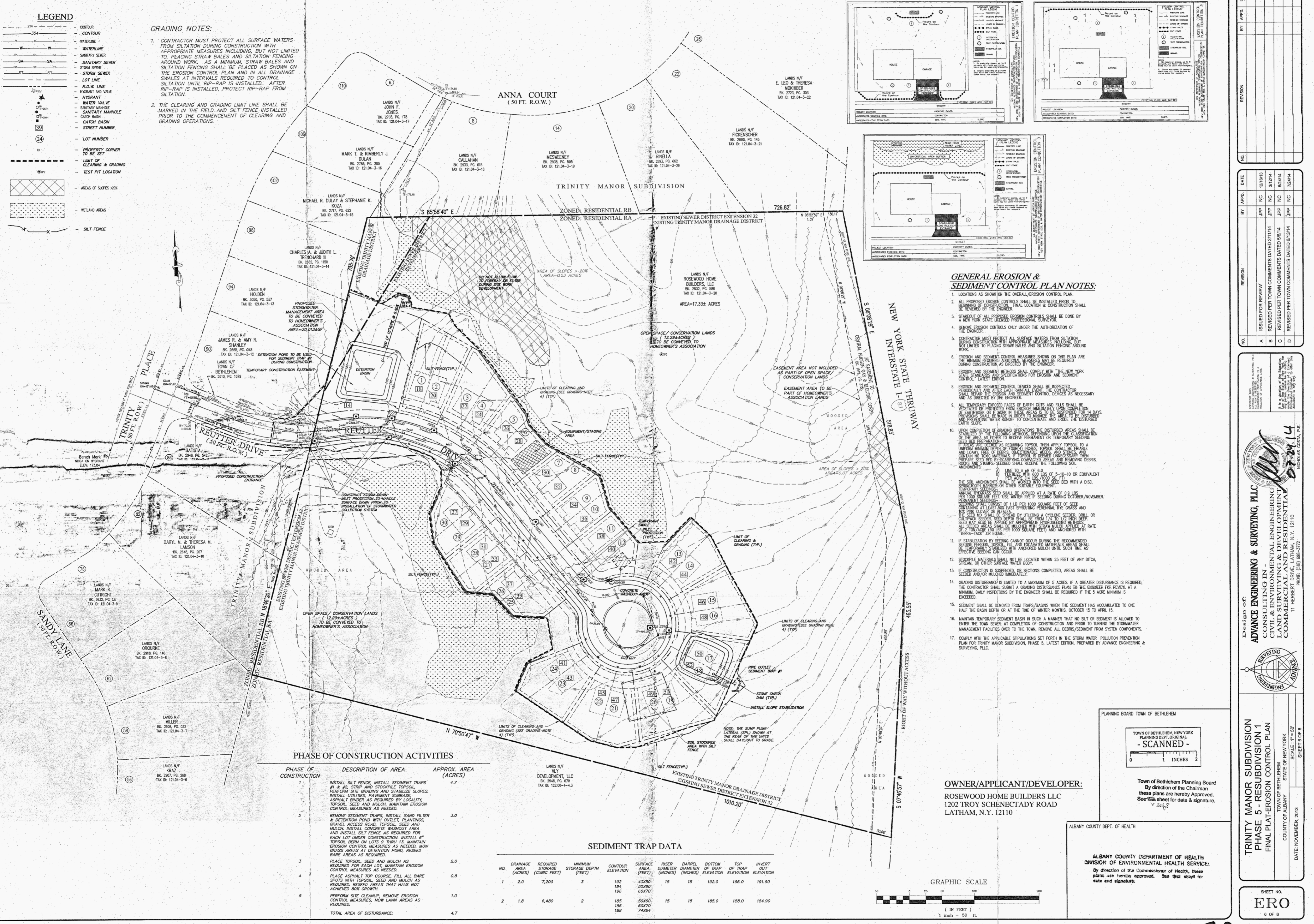

### GENERAL EROSION & SEDIMENT CONTROL PLAN NOTES:

- LOCATIONS AS SHOWN ON THE OVERALL/EROSION CONTROL PLAN.
- ALL PROPOSED EROSION CONTROLS SHALL BE INSTALLED PRIOR TO THE COMMENCEMENT OF CONSTRUCTION. FINAL LOCATION & CONSTRUCTION SHALL BE REVIEWED BY THE ENGINEER.
- STAKEOUT OF ALL PROPOSED EROSION CONTROLS SHALL BE DONE BY A NEW YORK STATE LICENSED SURVEYOR. THE ENGINEER SHALL BE NOTIFIED OF ANY CHANGES TO THE STAKEOUT.
- REMOVE EROSION CONTROLS ONLY UNDER THE AUTHORIZATION OF THE ENGINEER.
- CONTRACTOR MUST PROTECT ALL SURFACE WATERS FROM SILTATION DURING CONSTRUCTION WITH APPROPRIATE MEASURES INCLUDING, BUT NOT LIMITED TO, PLACING STRAW BALES AND SILTATION FENCING AROUND WORK.
- EROSION AND SEDIMENT MEASURES SHOWN ON THIS PLAN ARE THE MINIMUM REQUIRED. ADDITIONAL MEASURES MAY BE REQUIRED DURING CONSTRUCTION AS DIRECTED BY THE ENGINEER.
- EROSION AND SEDIMENT MEASURES SHALL COMPLY WITH THE NEW YORK STATE STANDARDS AND SPECIFICATIONS FOR EROSION AND SEDIMENT CONTROL LATEST EDITION.
- EROSION AND SEDIMENT CONTROL DEVICES SHALL BE INSPECTED PERIODICALLY AND AFTER EACH RAINFALL EVENT. THE CONTRACTOR SHALL MAINTAIN EROSION AND SEDIMENT CONTROL DEVICES AS NECESSARY AND AS DIRECTED BY THE ENGINEER.
- ALL TEMPORARY EXPOSED FACES OF EARTH CUTS AND FILLS SHALL BE PROTECTED OR PROTECTED FROM EROSION IMMEDIATELY UPON COMPLETION OF EARTHWORK OR WORK IN THESE AREAS IS TO BE SUSPENDED FOR 14 DAYS. EROSION AND SEDIMENT MEASURES SHALL BE MAINTAINED THROUGHOUT AND PREVENTING WATER RUNOFF TO CONCENTRATE AND ERODE THE DISTURBED EARTH SURFACE.
- UPON COMPLETION OF GRADING OPERATIONS THE DISTURBED AREAS SHALL BE STABILIZED BY THE FOLLOWING METHODS, DEPENDING UPON THE CLASSIFICATION OF THE AREA AS TO WHETHER TO RECEIVE PERMANENT OR TEMPORARY SEEDING:
  - PERMANENT SEEDING: SEED SHALL BE APPLIED AT A RATE OF 0.8 LBS PER 1000 SQUARE FEET OF SEEDING DURING OCTOBER/NOVEMBER.
  - TEMPORARY SEEDING: SEED SHALL BE APPLIED AT A RATE OF 1.0 LBS PER 1000 SQUARE FEET OF SEED DURING OCTOBER/NOVEMBER.
  - SEED SHALL BE APPLIED TO A UNIFORM MINIMUM DEPTH OF FOUR (4) INCHES. TOPSOIL SHALL BE FRAGILE AND LOAMY. FREE OF STONES OR ROCKS, WEEDS, AND STUMPS. AND CONTAIN NO TOXIC MATERIALS. IF TOPSOIL IS DEEMED UNNECESSARY THEN PERMANENT SEED SHALL BE APPLIED TO THE ENTIRE AREA AT A RATE OF 2.0 TON/ACRE (50 LBS PER 1000 SQUARE FEET) AND ANCHORED WITH STRAW-TACK OR BRUSH.
- IF STABILIZATION BY SEEDING CANNOT OCCUR DURING THE RECOMMENDED SEEDING PERIODS, TOPSOIL, FILL AND EXCAVATED MATERIALS AREAS SHALL BE TEMPORARILY STABILIZED WITH ANCHORED MULCH UNTIL SUCH TIME AS EFFECTIVE SEEDING CAN OCCUR.
- STOCKPILE MATERIALS SHALL NOT BE LOCATED WITHIN 25 FEET OF ANY DITCH, STREAM, OR OTHER SURFACE WATER BODY.
- IF CONSTRUCTION IS SUSPENDED FOR SECTIONS COMPLETED, AREAS SHALL BE SEEDING AND/OR MULCHED IMMEDIATELY.
- GRADING DISTURBANCE IS LIMITED TO A MAXIMUM OF 5 ACRES. IF A GREATER DISTURBANCE IS REQUIRED, THE CONTRACTOR SHALL SUBMIT A GRADING DISTURBANCE PLAN TO THE ENGINEER FOR REVIEW AT A MINIMUM DAILY INSPECTIONS BY THE ENGINEER SHALL BE REQUIRED IF THE 5 ACRE MINIMUM IS EXCEEDED.
- SEDIMENT SHALL BE REMOVED FROM TRAPS/BASINS WHEN THE SEDIMENT HAS ACCUMULATED TO ONE HALF THE BASIN DEPTH OR AT THE TIME OF WINTER MONTHS, OCTOBER 15 TO APRIL 15.
- MAINTAIN TEMPORARY SEDIMENT BASIN IN SUCH A MANNER THAT NO SILT OR SEDIMENT IS ALLOWED TO ENTER THE TOWN SEWER AT COMPLETION OF CONSTRUCTION AND PRIOR TO TURNING THE STORMWATER MANAGEMENT FACILITIES OVER TO THE TOWN. REMOVE ALL DEBRIS/SEDIMENT FROM SYSTEM COMPONENTS.
- COMPLY WITH THE APPLICABLE STIPULATIONS SET FORTH IN THE STORM WATER POLLUTION PREVENTION PLAN FOR TRINITY MANOR SUBDIVISION, PHASE 5, LATEST EDITION, PREPARED BY ADVANCE ENGINEERING & SURVEYING, PLLC.

### PHASE OF CONSTRUCTION ACTIVITIES

PHASE OF CONSTRUCTION	DESCRIPTION OF AREA	APPROX. AREA (ACRES)
1	INSTALL SILT FENCE, INSTALL SEDIMENT TRAPS #1 & #2, STRIP AND STOCKPILE TOPSOIL, PERFORM SITE GRADING AND STABILIZE SLOPES. INSTALL UTILITIES, PAVEMENT SURBASE, ASPHALT BINDER AS REQUIRED BY LOCALITY, TOPSOIL, SEED AND MULCH. MAINTAIN EROSION CONTROL MEASURES AS NEEDED.	4.7
2	REMOVE SEDIMENT TRAPS, INSTALL SAND FILTER & DETENTION POND WITH OUTLET, PLANTINGS, GRAVEL ACCESS ROAD, TOPSOIL, SEED AND MULCH. INSTALL CONCRETE WASHOUT AREA AND INSTALL SILT FENCE AS REQUIRED FOR EACH LOT UNDER CONSTRUCTION. INSTALL 6" TOPSOIL BERM ON LOTS 9 THRU 13. MAINTAIN EROSION CONTROL MEASURES AS NEEDED. MOW GRASS AREAS AT DETENTION POND, RESEED BARE AREAS AS REQUIRED.	3.0
3	PLACE TOPSOIL, SEED AND MULCH AS REQUIRED FOR EACH LOT, MAINTAIN EROSION CONTROL MEASURES AS NEEDED.	2.0
4	PLACE ASPHALT TOP COURSE, FILL ALL BARE SPOTS WITH TOPSOIL, SEED AND MULCH AS REQUIRED. RESEED AREAS THAT HAVE NOT ACHIEVED BOM GROWTH.	0.8
5	PERFORM SITE CLEANUP, REMOVE EROSION CONTROL MEASURES, MOW LAWN AREAS AS REQUIRED.	1.0
	TOTAL AREA OF DISTURBANCE:	4.7

### SEDIMENT TRAP DATA

NO.	DRAINAGE AREA (ACRES)	REQUIRED STORAGE (CUBIC FEET)	MINIMUM STORAGE DEPTH (FEET)	CONTOUR ELEVATION	SURFACE AREA (FEET)	RISER DIAMETER (INCHES)	BARREL DIAMETER (INCHES)	BOTTOM DIAMETER (INCHES)	TOP OF TRAP ELEVATION	INVERT OF TRAP ELEVATION
1	2.0	7,200	3	192	40X90	15	15	192.0	196.0	191.90
2	1.8	6,480	2	185	50X80	15	15	185.0	188.0	184.90

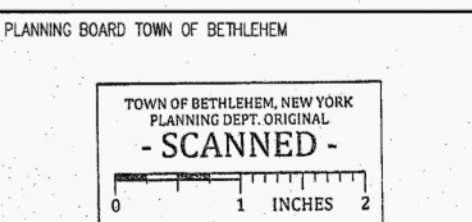
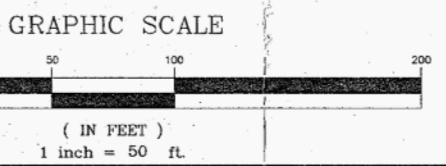

Town of Bethlehem Planning Board  
By direction of the Chairman  
these plans are hereby approved.  
See sheet for date & signature.

ALBANY COUNTY DEPT. OF HEALTH  
DIVISION OF ENVIRONMENTAL HEALTH SERVICE  
By direction of the Commissioner of Health, these plans are hereby approved. See sheet for date and signature.

DATE: \_\_\_\_\_ BY: \_\_\_\_\_

REVISION: \_\_\_\_\_

NO. \_\_\_\_\_

DATE: 12/18/13

BY: JPP NC

REVISION: A ISSUED FOR REVIEW

DATE: 3/19/14

BY: JPP NC

REVISION: B REVISED PER TOWN COMMENTS DATED 2/11/14

DATE: 5/24/14

BY: JPP NC

REVISION: C REVISED PER TOWN COMMENTS DATED 5/14/14

DATE: 7/24/14

BY: JPP NC

REVISION: D REVISED PER TOWN COMMENTS DATED 6/13/14

DATE: 8/21/14

BY: JPP NC

REVISION: E REVISED PER TOWN COMMENTS DATED 8/13/14

DATE: 8/21/14

BY: JPP NC

REVISION: F REVISED PER TOWN COMMENTS DATED 8/13/14

DATE: 8/21/14

BY: JPP NC

REVISION: G REVISED PER TOWN COMMENTS DATED 8/13/14

DATE: 8/21/14

BY: JPP NC

REVISION: H REVISED PER TOWN COMMENTS DATED 8/13/14

DATE: 8/21/14

BY: JPP NC

REVISION: I REVISED PER TOWN COMMENTS DATED 8/13/14

DATE: 8/21/14

BY: JPP NC

REVISION: J REVISED PER TOWN COMMENTS DATED 8/13/14

DATE: 8/21/14

BY: JPP NC

REVISION: K REVISED PER TOWN COMMENTS DATED 8/13/14

DATE: 8/21/14

BY: JPP NC

REVISION: L REVISED PER TOWN COMMENTS DATED 8/13/14

DATE: 8/21/14

BY: JPP NC

REVISION: M REVISED PER TOWN COMMENTS DATED 8/13/14

DATE: 8/21/14

BY: JPP NC

REVISION: N REVISED PER TOWN COMMENTS DATED 8/13/14

DATE: 8/21/14

BY: JPP NC

REVISION: O REVISED PER TOWN COMMENTS DATED 8/13/14

DATE: 8/21/14

BY: JPP NC

REVISION: P REVISED PER TOWN COMMENTS DATED 8/13/14

DATE: 8/21/14

BY: JPP NC

REVISION: Q REVISED PER TOWN COMMENTS DATED 8/13/14

DATE: 8/21/14

BY: JPP NC

REVISION: R REVISED PER TOWN COMMENTS DATED 8/13/14

DATE: 8/21/14

BY: JPP NC

REVISION: S REVISED PER TOWN COMMENTS DATED 8/13/14

DATE: 8/21/14

BY: JPP NC

REVISION: T REVISED PER TOWN COMMENTS DATED 8/13/14

DATE: 8/21/14

BY: JPP NC

REVISION: U REVISED PER TOWN COMMENTS DATED 8/13/14

DATE: 8/21/14

BY: JPP NC

REVISION: V REVISED PER TOWN COMMENTS DATED 8/13/14

DATE: 8/21/14

BY: JPP NC

REVISION: W REVISED PER TOWN COMMENTS DATED 8/13/14

DATE: 8/21/14

BY: JPP NC

REVISION: X REVISED PER TOWN COMMENTS DATED 8/13/14

DATE: 8/21/14

BY: JPP NC

REVISION: Y REVISED PER TOWN COMMENTS DATED 8/13/14

DATE: 8/21/14

BY: JPP NC

REVISION: Z REVISED PER TOWN COMMENTS DATED 8/13/14

DATE: 8/21/14

BY: JPP NC

REVISION: AA REVISED PER TOWN COMMENTS DATED 8/13/14

DATE: 8/21/14

BY: JPP NC

REVISION: AB REVISED PER TOWN COMMENTS DATED 8/13/14

DATE: 8/21/14

BY: JPP NC

REVISION: AC REVISED PER TOWN COMMENTS DATED 8/13/14

DATE: 8/21/14

BY: JPP NC

REVISION: AD REVISED PER TOWN COMMENTS DATED 8/13/14

DATE: 8/21/14

BY: JPP NC

REVISION: AE REVISED PER TOWN COMMENTS DATED 8/13/14

DATE: 8/21/14

BY: JPP NC

REVISION: AF REVISED PER TOWN COMMENTS DATED 8/13/14

DATE: 8/21/14

BY: JPP NC

REVISION: AG REVISED PER TOWN COMMENTS DATED 8/13/14

DATE: 8/21/14

BY: JPP NC

REVISION: AH REVISED PER TOWN COMMENTS DATED 8/13/14

DATE: 8/21/14

BY: JPP NC

REVISION: AI REVISED PER TOWN COMMENTS DATED 8/13/14

DATE: 8/21/14

BY: JPP NC

REVISION: AJ REVISED PER TOWN COMMENTS DATED 8/13/14

DATE: 8/21/14

BY: JPP NC

REVISION: AK REVISED PER TOWN COMMENTS DATED 8/13/14

DATE: 8/21/14

BY: JPP NC

REVISION: AL REVISED PER TOWN COMMENTS DATED 8/13/14

DATE: 8/21/14

BY: JPP NC

REVISION: AM REVISED PER TOWN COMMENTS DATED 8/13/14

DATE: 8/21/14

BY: JPP NC

REVISION: AN REVISED PER TOWN COMMENTS DATED 8/13/14

DATE: 8/21/14

BY: JPP NC

REVISION: AO REVISED PER TOWN COMMENTS DATED 8/13/14

DATE: 8/21/14

BY: JPP NC

REVISION: AP REVISED PER TOWN COMMENTS DATED 8/13/14

DATE: 8/21/14

BY: JPP NC

REVISION: AQ REVISED PER TOWN COMMENTS DATED 8/13/14

DATE: 8/21/14

BY: JPP NC

REVISION: AR REVISED PER TOWN COMMENTS DATED 8/13/14

DATE: 8/21/14

BY: JPP NC

REVISION: AS REVISED PER TOWN COMMENTS DATED 8/13/14

DATE: 8/21/14

BY: JPP NC

REVISION: AT REVISED PER TOWN COMMENTS DATED 8/13/14

DATE: 8/21/14

BY: JPP NC

REVISION: AU REVISED PER TOWN COMMENTS DATED 8/13/14

DATE: 8/21/14

BY: JPP NC

REVISION: AV REVISED PER TOWN COMMENTS DATED 8/13/14

DATE: 8/21/14

BY: JPP NC

REVISION: AW REVISED PER TOWN COMMENTS DATED 8/13/14

DATE: 8/21/14

BY: JPP NC

REVISION: AX REVISED PER TOWN COMMENTS DATED 8/13/14

DATE: 8/21/14

BY: JPP NC

REVISION: AY REVISED PER TOWN COMMENTS DATED 8/13/14

DATE: 8/21/14

BY: JPP NC

REVISION: AZ REVISED PER TOWN COMMENTS DATED 8/13/14

DATE: 8/21/14

BY: JPP NC

REVISION: BA REVISED PER TOWN COMMENTS DATED 8/13/14

DATE: 8/21/14

BY: JPP NC

REVISION: BB REVISED PER TOWN COMMENTS DATED 8/13/14

DATE: 8/21/14

BY: JPP NC

REVISION: BC REVISED PER TOWN COMMENTS DATED 8/13/14

DATE: 8/21/14

BY: JPP NC

REVISION: BD REVISED PER TOWN COMMENTS DATED 8/13/14

DATE: 8/21/14

BY: JPP NC

REVISION: BE REVISED PER TOWN COMMENTS DATED 8/13/14

DATE: 8/21/14

BY: JPP NC

REVISION: BF REVISED PER TOWN COMMENTS DATED 8/13/14

DATE: 8/21/14

BY: JPP NC

REVISION: BG REVISED PER TOWN COMMENTS DATED 8/13/14

DATE: 8/21/14

BY: JPP NC

REVISION: BH REVISED PER TOWN COMMENTS DATED 8/13/14

DATE: 8/21/14

BY: JPP NC

REVISION: BI REVISED PER TOWN COMMENTS DATED 8/13/14

DATE: 8/21/14

BY: JPP NC

REVISION: BJ REVISED PER TOWN COMMENTS DATED 8/13/14

DATE: 8/21/14

BY: JPP NC

REVISION: BK REVISED PER TOWN COMMENTS DATED 8/13/14

DATE: 8/21/14

BY: JPP NC

REVISION: BL REVISED PER TOWN COMMENTS DATED 8/13/14

DATE: 8/21/14

BY: JPP NC

REVISION: BM REVISED PER TOWN COMMENTS DATED 8/13/14

DATE: 8/21/14

BY: JPP NC

REVISION: BN REVISED PER TOWN COMMENTS DATED 8/13/14

DATE: 8/21/14

BY: JPP NC

REVISION: BO REVISED PER TOWN COMMENTS DATED 8/13/14

DATE: 8/21/14

BY: JPP NC

REVISION: BP REVISED PER TOWN COMMENTS DATED 8/13/14

DATE: 8/21/14

BY: JPP NC

REVISION: BQ REVISED PER TOWN COMMENTS DATED 8/13/14

DATE: 8/21/14

BY: JPP NC

REVISION: BR REVISED PER TOWN COMMENTS DATED 8/13/14

DATE: 8/21/14

BY: JPP NC

REVISION: BS REVISED PER TOWN COMMENTS DATED 8/13/14

DATE: 8/21/14

BY: JPP NC

REVISION: BT REVISED PER TOWN COMMENTS DATED 8/13/14

DATE: 8/21/14

BY: JPP NC

REVISION: BU REVISED PER TOWN COMMENTS DATED 8/13/14

DATE: 8/21/14

BY: JPP NC

REVISION: BV REVISED PER TOWN COMMENTS DATED 8/13/14

DATE: 8/21/14

BY: JPP NC

REVISION: BW REVISED PER TOWN COMMENTS DATED 8/13/14

DATE: 8/21/14

BY: JPP NC

REVISION: BX REVISED PER TOWN COMMENTS DATED 8/13/14

DATE: 8/21/14

BY: JPP NC

REVISION: BY REVISED PER TOWN COMMENTS DATED 8/13/14

DATE: 8/21/14

BY: JPP NC

REVISION: BZ REVISED PER TOWN COMMENTS DATED 8/13/14

DATE: 8/21/14

BY: JPP NC

REVISION: CA REVISED PER TOWN COMMENTS DATED 8/13/14

DATE: 8/21/14

BY: JPP NC

REVISION: CB REVISED PER TOWN COMMENTS DATED 8/13/14

DATE: 8/21/14

BY: JPP NC

REVISION: CC REVISED PER TOWN COMMENTS DATED 8/13/14

DATE: 8/21/14

BY: JPP NC

REVISION: CD REVISED PER TOWN COMMENTS DATED 8/13/14

DATE: 8/21/14

BY: JPP NC

REVISION: CE REVISED PER TOWN COMMENTS DATED 8/13/14

DATE: 8/21/14

BY: JPP NC

REVISION: CF REVISED PER TOWN COMMENTS DATED 8/13/14

DATE: 8/21/14

BY: JPP NC

REVISION: CG REVISED PER TOWN COMMENTS DATED 8/13/14

DATE: 8/21/14

BY: JPP NC

REVISION: CH REVISED PER TOWN COMMENTS DATED 8/13/14

DATE: 8/21/14

BY: JPP NC

REVISION: CI REVISED PER TOWN COMMENTS DATED 8/13/14

DATE: 8/21/14

BY: JPP NC

REVISION: CJ REVISED PER TOWN COMMENTS DATED 8/13/14

DATE: 8/21/14

BY: JPP NC

REVISION: CK REVISED PER TOWN COMMENTS DATED 8/13/14

DATE: 8/21/14

BY: JPP NC

REVISION: CL REVISED PER TOWN COMMENTS DATED 8/13/14

DATE: 8/21/14

BY: JPP NC

REVISION: CM REVISED PER TOWN COMMENTS DATED 8/13/14

DATE: 8/21/14

BY: JPP NC

REVISION: CN REVISED PER TOWN COMMENTS DATED 8/13/14

DATE: 8/21/14

BY: JPP NC

REVISION: CO REVISED PER TOWN COMMENTS DATED 8/13/14

DATE: 8/21/14

BY: JPP NC

REVISION: CP REVISED PER TOWN COMMENTS DATED 8/13/14

DATE: 8/21/14

BY: JPP NC

REVISION: CQ REVISED PER TOWN COMMENTS DATED 8/13/14

DATE: 8/21/14

BY: JPP NC

REVISION: CR REVISED PER TOWN COMMENTS DATED 8/13/14

DATE: 8/21/14

BY: JPP NC

REVISION: CS REVISED PER TOWN COMMENTS DATED 8/13/14

DATE: 8/21/14

BY: JPP NC

REVISION: CT REVISED PER TOWN COMMENTS DATED 8/13/14

DATE: 8/21/14

BY: JPP NC

REVISION: CU REVISED PER TOWN COMMENTS DATED 8/13/14

DATE: 8/21/14

BY: JPP NC

REVISION: CV REVISED PER TOWN COMMENTS DATED 8/13/14

DATE: 8/21/14

BY: JPP NC

REVISION: CW REVISED PER TOWN COMMENTS DATED 8/13/14

DATE: 8/21/14

BY: JPP NC

REVISION: CX REVISED PER TOWN COMMENTS DATED 8/13/14

DATE: 8/21/14

BY: JPP NC

REVISION: CY REVISED PER TOWN COMMENTS DATED 8/13/14

DATE: 8/21/14

BY: JPP NC

REVISION: CZ REVISED PER TOWN COMMENTS DATED 8/13/14

DATE: 8/21/14

BY: JPP NC

REVISION: DA REVISED PER TOWN COMMENTS DATED 8/13/14

DATE: 8/21/14

BY: JPP NC

REVISION: DB REVISED PER TOWN COMMENTS DATED 8/13/14

DATE: 8/21/14

BY: JPP NC

REVISION: DC REVISED PER TOWN COMMENTS DATED 8/13/14

DATE: 8/21/14

BY: JPP NC

REVISION: DD REVISED PER TOWN COMMENTS DATED 8/13/14

DATE: 8/21/14

BY: JPP NC

REVISION: DE REVISED PER TOWN COMMENTS DATED 8/13/14

DATE: 8/21/14

BY: JPP NC

REVISION: DF REVISED PER TOWN COMMENTS DATED 8/13/14

DATE: 8/21/14

BY: JPP NC

REVISION: DG REVISED PER TOWN COMMENTS DATED 8/13/14

DATE: 8/21/14

BY: JPP NC

REVISION: DH REVISED PER TOWN COMMENTS DATED 8/13/14

DATE: 8/21/14

BY: JPP NC

REVISION: DI REVISED PER TOWN COMMENTS DATED 8/13/14

DATE: 8/21/14

BY: JPP NC

REVISION: DJ REVISED PER TOWN COMMENTS DATED 8/13/14

DATE: 8/21/14

BY: JPP NC

REVISION: DK REVISED PER TOWN COMMENTS DATED 8/13/14

DATE: 8/21/14

BY: JPP NC

REVISION: DL REVISED PER TOWN COMMENTS DATED 8/13/14

DATE: 8/21/14

BY: JPP NC

REVISION: DM REVISED PER TOWN COMMENTS DATED 8/13/14

DATE: 8/21/14

BY: JPP NC

REVISION: DN REVISED PER TOWN COMMENTS DATED 8/13/14

DATE: 8/21/14

BY: JPP NC

REVISION: DO REVISED PER TOWN COMMENTS DATED 8/13/14

DATE: 8/21/14

BY: JPP NC

REVISION: DP REVISED PER TOWN COMMENTS DATED 8/13/14

DATE: 8/21/14

BY: JPP NC

REVISION: DQ REVISED PER TOWN COMMENTS DATED 8/13/14

DATE: 8/21/14

BY: JPP NC

REVISION: DR REVISED PER TOWN COMMENTS DATED 8/13/14

DATE: 8/21/14

BY: JPP NC

REVISION: DS REVISED PER TOWN COMMENTS DATED 8/13/14

DATE: 8/21/14

BY: JPP NC

REVISION: DT REVISED PER TOWN COMMENTS DATED 8/13/14

DATE: 8/21/14

BY: JPP NC

REVISION: DU REVISED PER TOWN COMMENTS DATED 8/13/14

DATE: 8/21/14

BY: JPP NC

REVISION: DV REVISED PER TOWN COMMENTS DATED 8/13/14

DATE: 8/21/14

BY: JPP NC

REVISION: DW REVISED PER TOWN COMMENTS DATED 8/13/14

DATE: 8/21/14

BY: JPP NC

REVISION: DX REVISED PER TOWN COMMENTS DATED 8/13/14

DATE: 8/21/14

BY: JPP NC

REVISION: DY REVISED PER TOWN COMMENTS DATED 8/13/14

DATE: 8/21/14

BY: JPP NC

REVISION: DZ REVISED PER TOWN COMMENTS DATED 8/13/14

DATE: 8/21/14

BY: JPP NC

REVISION: EA REVISED PER TOWN COMMENTS DATED 8/13/14

DATE: 8/21/14

BY: JPP NC

REVISION: EB REVISED PER TOWN COMMENTS DATED 8/13/14

DATE: 8/21/14

BY: JPP NC

REVISION: EC REVISED PER TOWN COMMENTS DATED 8/13/14

DATE: 8/21/14

BY: JPP NC

REVISION: ED REVISED PER TOWN COMMENTS DATED 8/13/14

DATE: 8/21/14

BY: JPP NC

REVISION: EE REVISED PER TOWN COMMENTS DATED 8/13/14

DATE: 8/21/14

BY: JPP NC

REVISION: EF REVISED PER TOWN COMMENTS DATED 8/13/14

DATE: 8/21/14

BY: JPP NC

REVISION: EG REVISED PER TOWN COMMENTS DATED 8/13/14

DATE: 8/21/14

BY: JPP NC

REVISION: EH REVISED PER TOWN COMMENTS DATED 8/13/14

DATE: 8/21/14

BY: JPP NC

REVISION: EI REVISED PER TOWN COMMENTS DATED 8/13/14

DATE: 8/21/14

BY: JPP NC

REVISION: EJ REVISED PER TOWN COMMENTS DATED 8/13/14

DATE: 8/21/14

BY: JPP NC

REVISION: EK REVISED PER TOWN COMMENTS DATED 8/13/14

DATE: 8/21/14

BY: JPP NC

REVISION: EL REVISED PER TOWN COMMENTS DATED 8/13/14

DATE: 8/21/14

BY: JPP NC

REVISION: EM REVISED PER TOWN COMMENTS DATED 8/13/14

DATE: 8/21/14

BY: JPP NC

REVISION: EN REVISED PER TOWN COMMENTS DATED 8/13/14

DATE: 8/21/14

BY: JPP NC

REVISION: EO REVISED PER TOWN COMMENTS DATED 8/13/14

DATE: 8/21/14

BY: JPP NC

REVISION: EP REVISED PER TOWN COMMENTS DATED 8/13/14

DATE: 8/21/14

BY: JPP NC

REVISION: EQ REVISED PER TOWN COMMENTS DATED 8/13/14

DATE: 8/21/14

BY: JPP NC

REVISION: ER REVISED PER TOWN COMMENTS DATED 8/13/14

DATE: 8/21/14

BY: JPP NC

REVISION: ES REVISED PER TOWN COMMENTS DATED 8/13/14

DATE: 8/21/14

BY: JPP NC

REVISION: ET REVISED PER TOWN COMMENTS DATED 8/13/14

DATE: 8/21/14

BY: JPP NC

REVISION: EU REVISED PER TOWN COMMENTS DATED 8/13/14

DATE: 8/21/14

BY: JPP NC

REVISION: EV REVISED PER TOWN COMMENTS DATED 8/13/14

DATE: 8/21/14

BY: JPP NC

REVISION: EW REVISED PER TOWN COMMENTS DATED 8/13/14

DATE: 8/21/14

BY: JPP NC

REVISION: EX REVISED PER TOWN COMMENTS DATED 8/13/14

DATE: 8/21/14

BY: JPP NC

REVISION: EY REVISED PER TOWN COMMENTS DATED 8/13/14

DATE: 8/21/14

BY: JPP NC

REVISION: EZ REVISED PER TOWN COMMENTS DATED 8/13/14

DATE: 8/21/14

BY: JPP NC

REVISION: FA REVISED PER TOWN COMMENTS DATED 8/13/14

DATE: 8/21/14

BY: JPP NC

REVISION: FB REVISED PER TOWN COMMENTS DATED 8/13/14

DATE: 8/21/14

BY: JPP NC

REVISION: FC REVISED PER TOWN COMMENTS DATED 8/13/14

DATE: 8/21/14

BY: JPP NC

REVISION: FD REVISED PER TOWN COMMENTS DATED 8/13/14

DATE: 8/21/14

BY: JPP NC

REVISION: FE REVISED PER TOWN COMMENTS DATED 8/13/14

DATE: 8/21/14

BY: JPP NC

REVISION: FF REVISED PER TOWN COMMENTS DATED 8/13/14

DATE: 8/21/14

BY: JPP NC

REVISION: FG REVISED PER TOWN COMMENTS DATED 8/13/14

DATE: 8/21/14

BY: JPP NC

REVISION: FH REVISED PER TOWN COMMENTS DATED 8/13/14

DATE: 8/21/14

BY: JPP NC

REVISION: FI REVISED PER TOWN COMMENTS DATED 8/13/14

DATE: 8/21/14

BY: JPP NC

REVISION: FJ REVISED PER TOWN COMMENTS DATED 8/13/14

DATE: 8/21/14

BY: JPP NC

REVISION: FK REVISED PER TOWN COMMENTS DATED 8/13/14

DATE: 8/21/14

BY: JPP NC

REVISION: FL REVISED PER TOWN COMMENTS DATED 8/13/14

DATE: 8/21/14

BY: JPP NC

REVISION: FM REVISED PER TOWN COMMENTS DATED 8/13/14

DATE: 8/21/14

BY: JPP NC

REVISION: