

**GENERAL NOTES**

1. A LANDSCAPE/ BUFFER PLAN FOR SCREENING OF DISTURBED AREAS SHALL BE SUBMITTED TO THE PLANNING BOARD FOR REVIEW AND APPROVAL. THE PORTION OF HORSESHOE DRIVE LOCATED IN PHASE III.
2. THE PHASING PLAN LIMITS SHOWN ON THE PLANS ARE NOT INTENDED TO DEPICT OR REFLECT INTERIM AREAS OF ALLOWABLE DISTURBANCE OF THE SUBSIDIARY PERMIT FOR THIS PROJECT. OWNER AND CONTRACTOR SHALL FURTHER "PHASE" THE LANDS TO BE DISTURBED TO A LIMIT OF 5 ACRES OR OBTAIN WRITTEN PERMISSION FROM NYSDEC TO DISTURB LARGER AREAS. STABILIZE DISTURBED AREAS PER NYSDEC STORMWATER PERMIT NO. 99-02-01.

UNAUTHORIZED ALTERATIONS OR ADDITIONS TO THIS DOCUMENT ARE A VIOLATION OF NEW YORK STATE EDUCATION LAW 2 OF THE TOWN OF BETHLEHEM, NY.

**REVISIONS**

DATE	BY	DESCRIPTION	SYMBOL
6/99	CHJ	FINAL PLAN REVISIONS	▲
10/99	CHJ	FINAL PLAN REVISIONS	▲
5/00	CHJ	FINAL PLAN REVISIONS	▲
12/00	CHJ	FINAL PLAN REVISIONS	▲
7/01	CHJ	FINAL PLAN REVISIONS	▲
10/04	CHJ	FINAL PLAN REVISIONS	▲
1/06	CHJ	MISCELLANEOUS REVISIONS	▲
3/06	CHJ	MISCELLANEOUS REVISIONS	▲

**EDWARD W. BOUTELLE AND SON**  
 CIVIL ENGINEERS AND SURVEYORS  
 423 KENWOOD AVENUE  
 DELMAR, NEW YORK  
 TEL (516) 439-9881 FAX (516) 439-9882  
 A DIVISION OF J. KENNETH FRASER AND ASSOCIATES, P.C.

**FINAL PLAN AMENDED**  
**CARRIAGE HILL SUBDIVISION**  
 MAP OF LANDS OF  
**CHARLEW CONSTRUCTION CORP.**

SEP 15 2006  
 TOWN OF BETHLEHEM COUNTY OF ALBANY  
 STATE OF NEW YORK

SCALE: 1"=100'

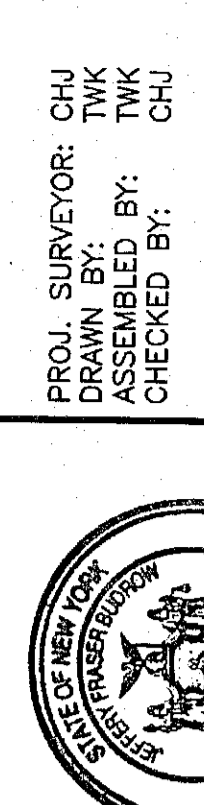

PROJ. SURVEYOR: CHJ  
 DRAWN BY: CHJ  
 CHECKED BY: CHJ  
 PROJECT NO.: 99-020  
 CAD FILE NAME: 4103-009

SHEET TITLE: PHASING PLAN  
 DATE: JUNE 1999  
 SHEET 9 OF 31

**PHASE I:**  
 SHALL INCLUDE PLACEMENT OF CURBS AND UTILITIES FOR DRIVE AND BOULEVARD CROSSINGS. FINAL IMPROVEMENTS SHALL BE COMPLETED DURING PHASE II



**PHASE I:**  
 SHALL INCLUDE WATER MAIN EXTENSION ALONG JERICO ROAD AND ELM AVENUE EAST

JERICO ROAD IMPROVEMENTS SHALL BE MADE DURING PHASE III

HORSESHOE DRIVE IS TO BE USED AS A CONSTRUCTION ROAD DURING PHASE II CONSTRUCTION

JERICO ROAD IMPROVEMENTS SHALL BE MADE DURING PHASE III

PLANNING BOARD  
 TOWN OF BETHLEHEM  
 ALBANY COUNTY, NEW YORK  
 FINAL PLAN APPROVAL  
 WHEN SIGNED BY THE PLANNING BOARD MEMBER OF THE PLANNING BOARD OF THE TOWN OF BETHLEHEM, NY, THIS CONSTITUTES FINAL APPROVAL OF THE PLAN.  
 SIGNED: *Carla D. Mathews*  
 TITLE: *Chairperson*  
 DATE: *10-17-06*  
 SEE ALSO CERTIFICATE OF APPROVAL OF FINAL PLATING: *10-17-06*

