

**DETAIL**  
**STORM MANHOLE 1A**  
**W/ENERGY DISSIPATING WALL**  
 N.T.S.  
 AS DESIGNED AND ORDERED BY DEPT. OF  
 PUBLIC WORKS, TOWN OF BETHLEHEM.

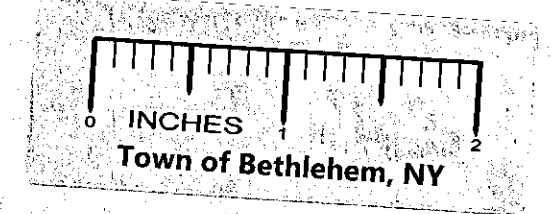

**NOTE :**  
 PRIOR TO ANY EXCAVATION WITHIN EASEMENT OF TENNESSEE GAS TRANS. CO.,  
 CONTRACTOR SHALL NOTIFY WALL ARCES, R.O.W. SUPERVISOR, 1 (800) 343-0588  
 OR (413) 786 - 2783  
 STORM SEWER PIPE MATERIAL: CORRUGATED METAL PIPE, FULLY COATED  
 WITH PAVED INVERT, 16 GAUGE.

- LEGEND**
- EXISTING CONTOURS  
 - - - PROPOSED CONTOURS
- EXISTING FEATURES**
- EX 8" S --- SANITARY SEWER & MANHOLE
  - EX 12" W --- WATER MAIN & HYDRANT
  - EX 12" D --- STORM SEWER & CATCH BASIN
- PROPOSED FEATURES**
- 8" S --- SANITARY SEWER & MANHOLE
  - 12" W --- WATER MAIN & HYDRANT
  - 12" D --- STORM SEWER & CATCH BASIN
  - END SECTION AND STORM MANHOLE  
 IN STORM SEWER

- NOTES**
- 1- Storm sewers, water mains, and underground utilities are shown in their relative position and for information only. Their exact location shall be checked at the site before construction begins.
  - 2- Contractor shall restore lawns, driveways, walks, walls, curbs, fences, etc. to a condition at least as good as they were before being disturbed.
  - 3- Box all trees and house all shrubs and hedges before placing earth against or near them. Shrubs and hedges which must be removed during construction shall be treated in and replanted in as good a condition as they were before their removal. Any damaged trees, shrubs, and/or hedges shall be replaced at the contractor's expense.
  - 4- Posts, mailboxes, etc. shall be protected, or removed and replaced exactly as they were before being disturbed. Damaged items shall be replaced at the contractor's expense.
  - 5- No work, storage, or trespass shall be permitted beyond the boundaries of the easement as shown and staked.
  - 6- Sewer mains in relation to water mains where possible, sewers shall be laid at least 10 (ten) feet horizontally from any existing or proposed water main. Vertical separation shall be maintained to provide 18 (eighteen) inches between top of sewer and the invert of the water main or utility crossing. When impossible to obtain the proper vertical separation, cast iron pipe shall be used 10 (ten) feet on each side of the water main being crossed.

UNAUTHORIZED ALTERATION OR ADDITION TO  
 THIS DOCUMENT IS A VIOLATION OF SECTION  
 7209 SUBDIVISION 2 OF THE NEW YORK STATE  
 EDUCATION LAW.

ALBANY COUNTY DEPARTMENT OF HEALTH  
 DIVISION OF ENVIRONMENTAL HEALTH SERVICES  
 By direction of the Commissioner of Health, these  
 plans are hereby approved. See first sheet for  
 date and signature.

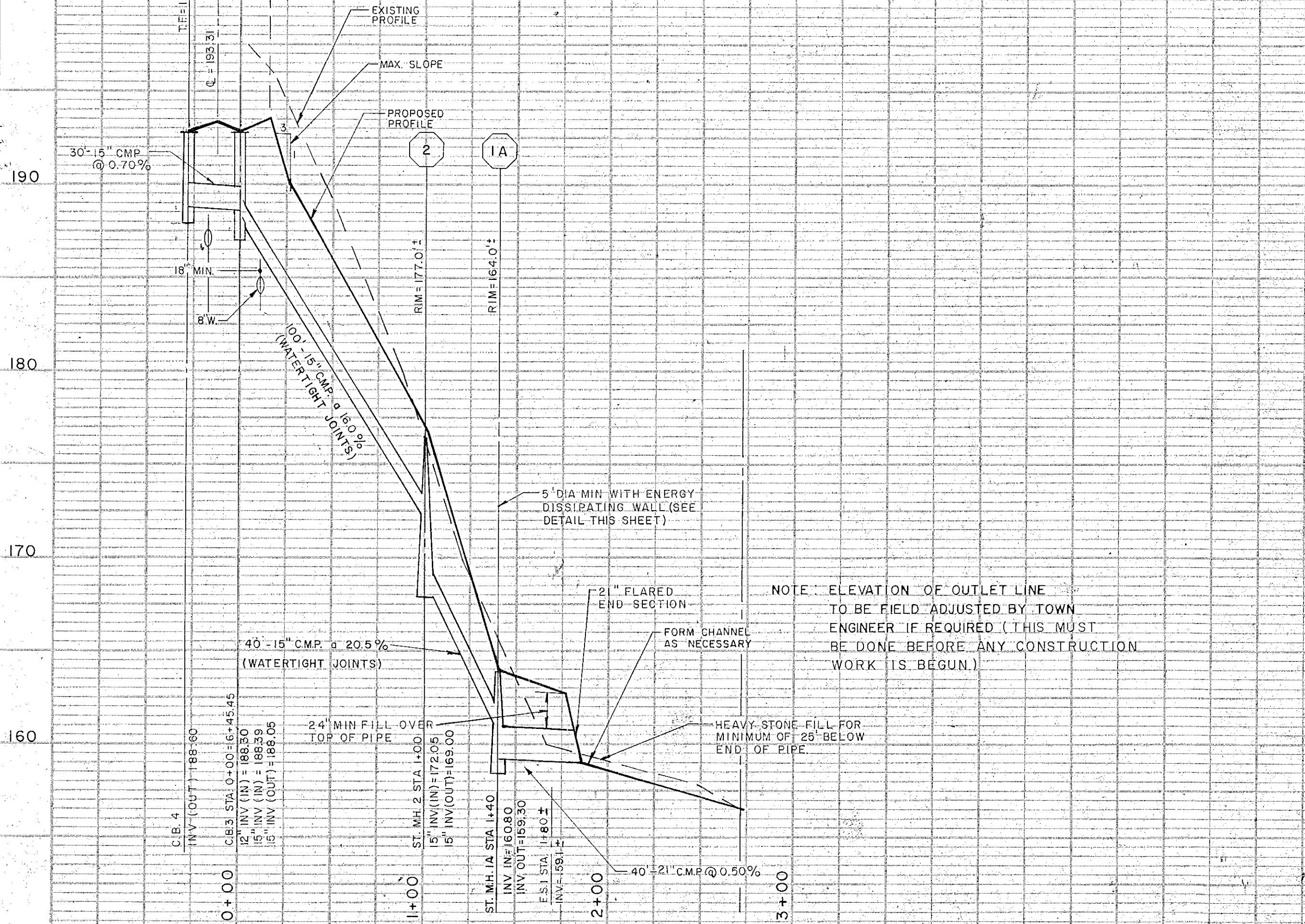

NOTE: ELEVATION OF OUTLET LINE  
 TO BE FIELD ADJUSTED BY TOWN  
 ENGINEER IF REQUIRED (THIS MUST  
 BE DONE BEFORE ANY CONSTRUCTION  
 WORK IS BEGUN.)

**C.T. MALE ASSOCIATES, P.C.**  
 50 Century Hill Drive, Latham, NY 12110

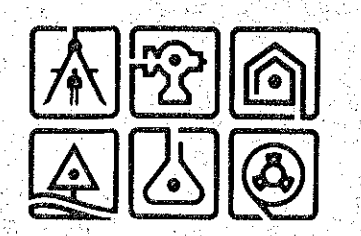

DATE	RECORD OF WORK	Drawn	Check	Appr.	DATE	RECORD OF WORK	Drawn	Check	Appr.
4/15/86	REVISIONS PER TOWN REVIEW COMMENTS DATED 3/31/86	LJP	JEF	PKM					
5/20/86	REVISIONS PER TOWN REVIEW COMMENTS DATED 4/29/86	BGS							

DRAWN BY M.J.G.  
 TOWN OF BETHLEHEM  
 COUNTY OF ALBANY  
 DATE: JUNE 18, 1985  
 SCALES: HOR. 1 inch = 50 feet; VERT. 1 inch = 5 feet

CHECKED BY JEF  
 APPROVED BY PAUL K. MALE  
 LICENSE NO. PE 57,084

**PLAN AND PROFILE**  
**UNIVERSITY STREET**  
**SKYCREST SECTION NO. 1-A**  
 PLANNED RESIDENCE DISTRICT NO. P.R.D.3

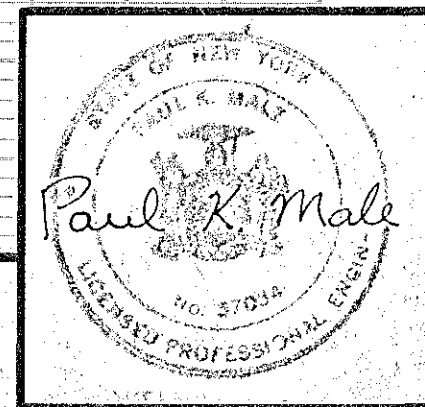

DWG NO. 85-247R  
 Sheet 4 of 4

BRUNING 44-32 89783

PROJECT NO. 83.164

JUN 11 1986