

Note: Work between points A & B may be deferred until Spring '65. Joseph Onofri

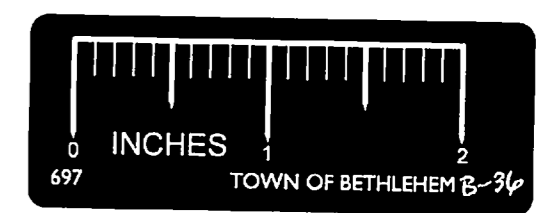
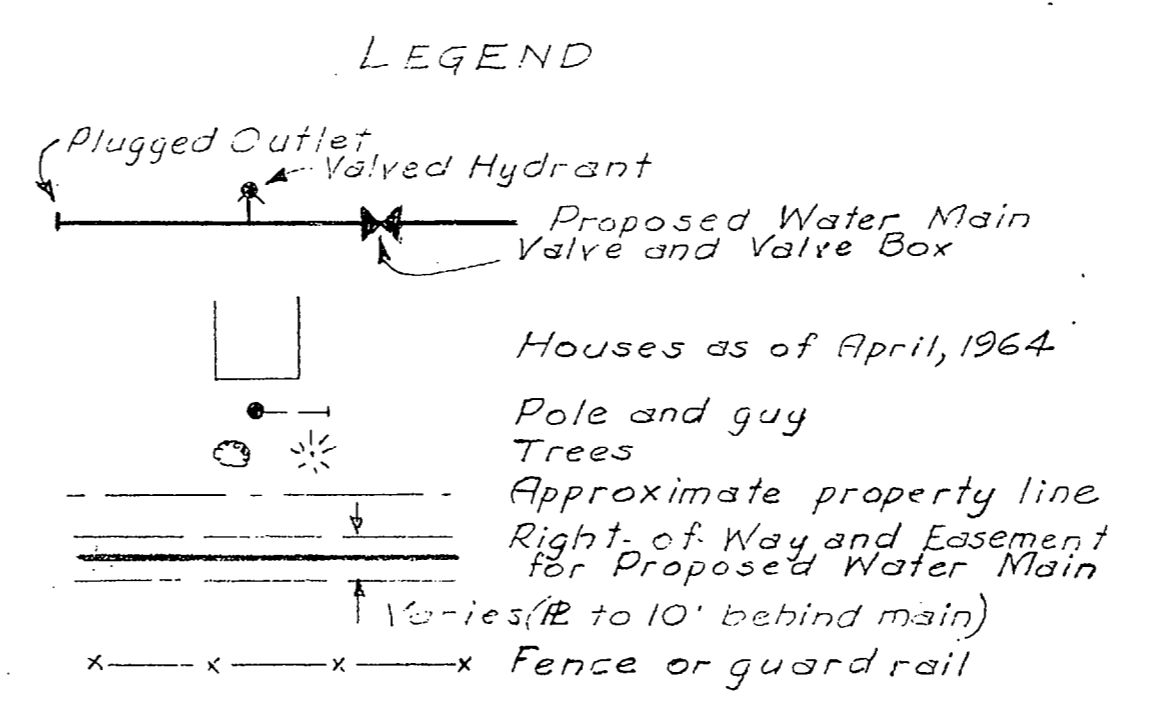

SELKIRK EXTENSION WATER DISTRICT NO. 1
 TOWN OF BETHLEHEM
 ALBANY COUNTY NEW YORK
 SCALE: 1"=100' JUNE, 1964
 J. KENNETH FRASER & ASSOC.
 CONSULTING ENGINEERS RENSSELAER, N.Y.

Drawn by: K.N.S. & W.T.B.
 Traced by: E.W.O. & W.T.B.
 Checked by: J.K.F.

Revised 7/13/64 - Main relocated at McMillan, Zeller, Snyder Canali, & Luce