

REVISIONS		
ISSUE	DESCRIPTION	DRAFTING/APPD/ENG/APPD RELEASE NUMBER
① 12/3/84	NOTE TO REMOVE 40" MAPLE @ END OF RD, REVISED GRADES & END OF RD, ADDED SECTION.	
② 12/13/84	CHANGED GRADES @ END OF TURN AROUND ADDED NOTE ON GRADE TO WALL REVISED SECTIONS	

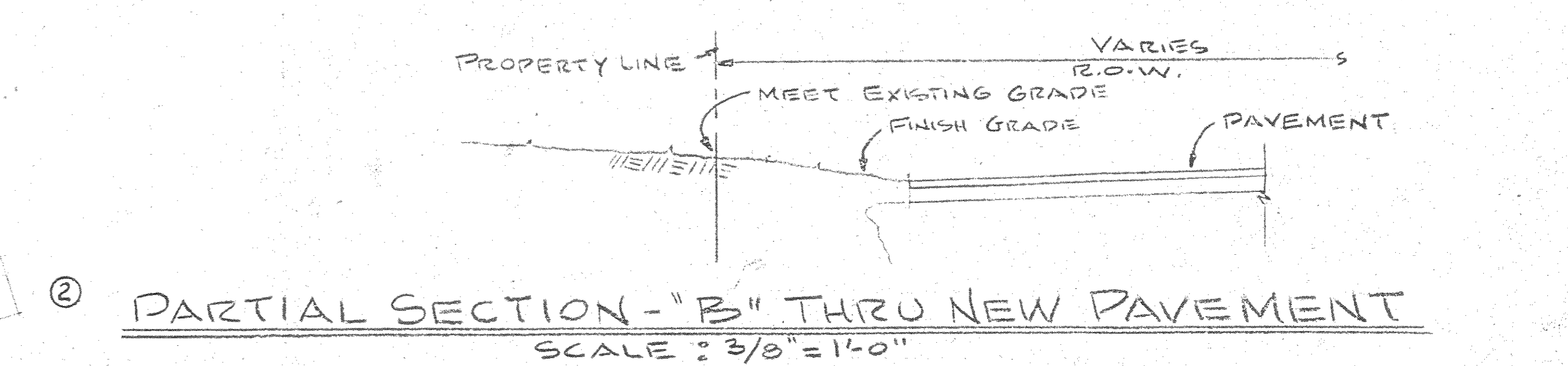

- NOTES:**
- 1) BENCH MARK ASSUMED ELEV. = 102.50' B NAILS IN POLE N.Y.T. - 11/NM - 13 1/2 ACTUAL ELEV. TOWN OF BETHLEHEM DATUM = 101.57'
 - 2) TOPO & UTILITIES INFORMATION FROM DRAWINGS OF EDWARD W. BOUTELLE & SON, CIVIL ENGINEERS & SURVEYORS DELMAR, N.Y.
 - 3) B-1: INDICATES SOIL BORING LOCATIONS. FOR BORING LOG SEE SPECS.
 - 4) [Symbol] = INDICATES GRAVEL SURFACE.
 - 5) [Symbol] = INDICATES NEW PAVING.
 - 6) NEW WATER MAIN & HYDRANT ARE SHOWN IN APPROXIMATE LOCATION. ACTUAL LOCATION TO BE DETERMINED BY WATER DEPT.
- APPROVED BY THIS DOCUMENT, BY OTHER THAN AN AUTHORIZED LICENSED PROFESSIONAL ENGINEER IS ILLEGAL AND A VIOLATION OF SECTION 720 OF THE NEW YORK STATE EDUCATION LAW.

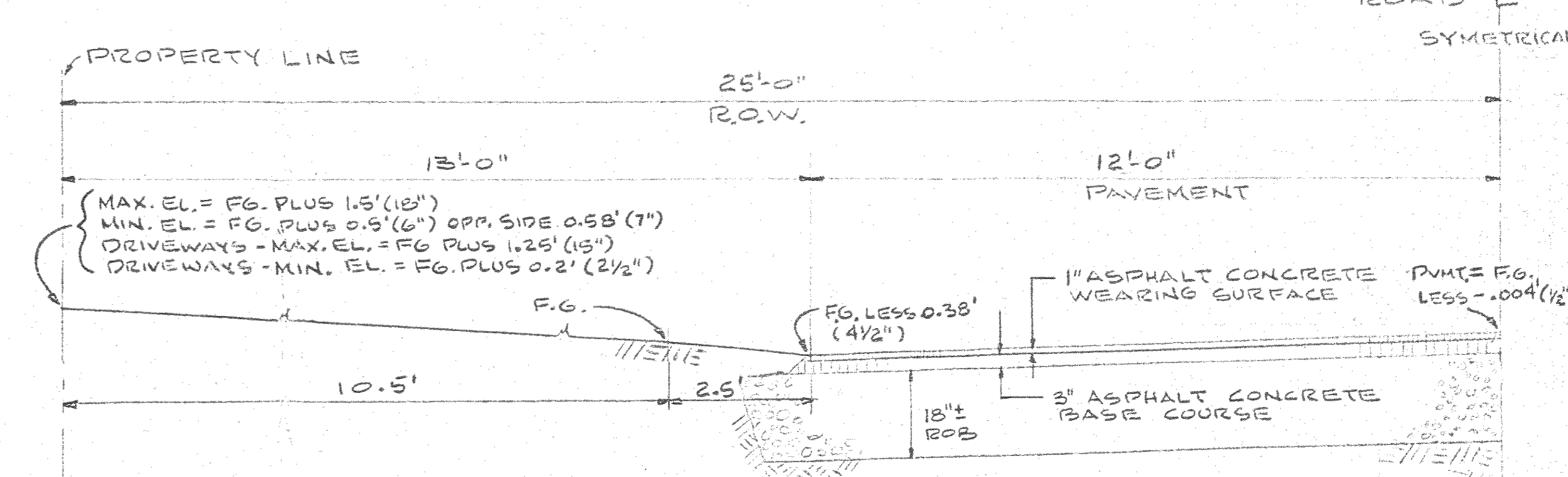
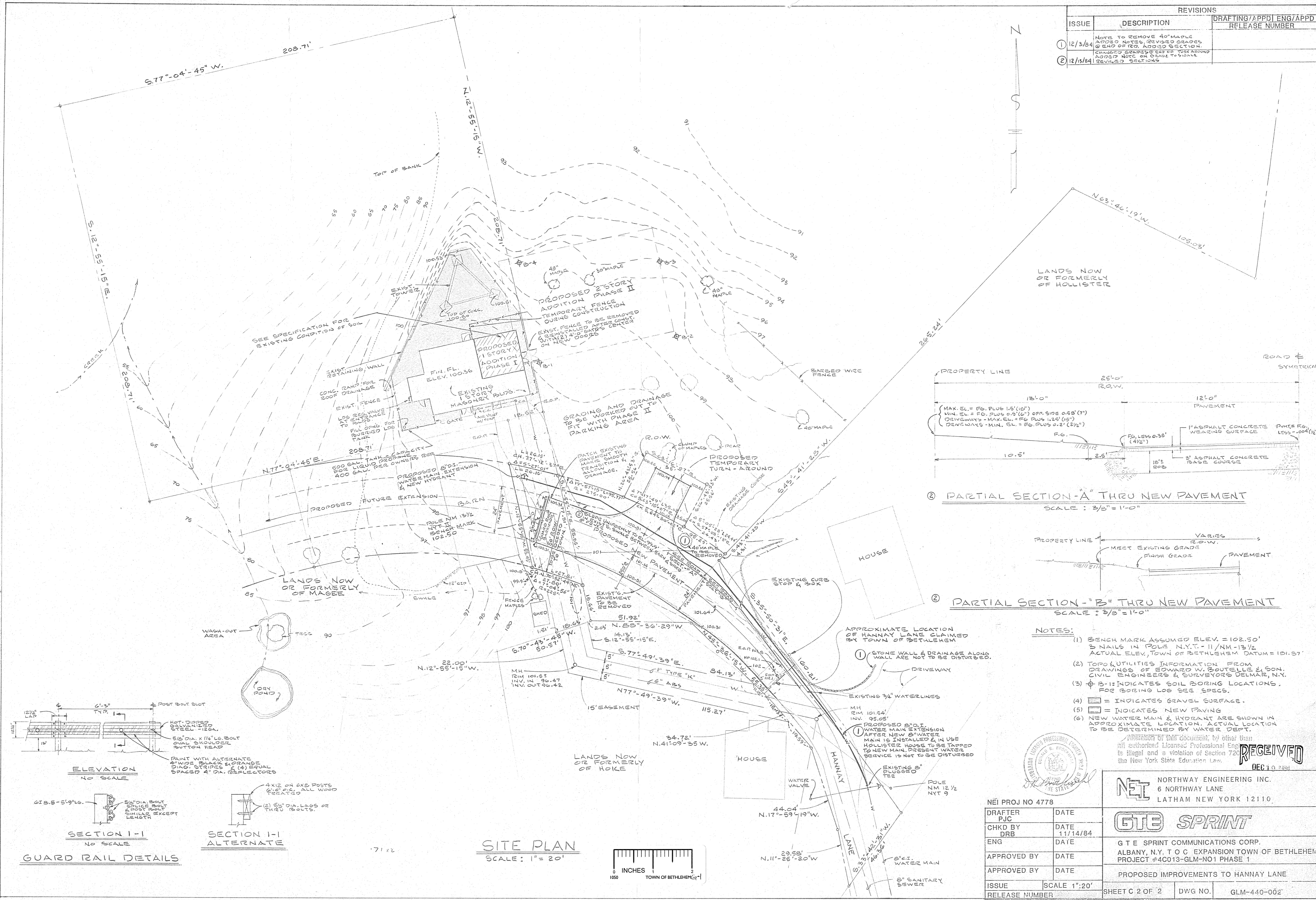
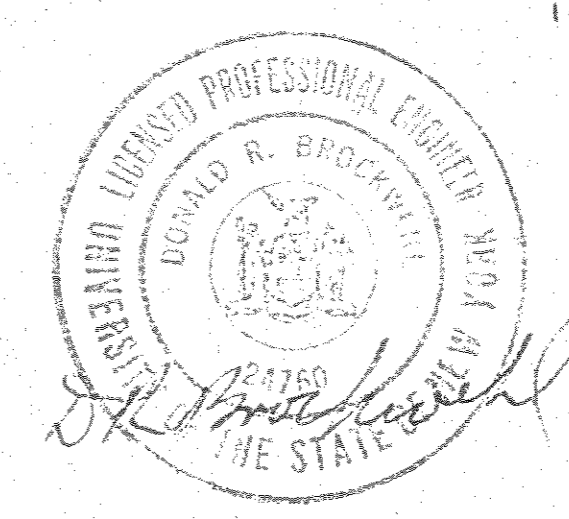

NET NORTHWAY ENGINEERING INC.
 6 NORTHWAY LANE
 LATHAM NEW YORK 12110.

NEI PROJ NO 4778	
DRAFTER PJC	DATE
CHKD BY DRB	DATE 11/14/84
ENG	DATE
APPROVED BY	DATE
APPROVED BY	DATE
ISSUE	SCALE 1" = 20'
RELEASE NUMBER	SHEET C 2 OF 2

GTE SPRINT
 GTE SPRINT COMMUNICATIONS CORP.
 ALBANY, N.Y. T O C EXPANSION TOWN OF BETHLEHEM
 PROJECT #4C013-GLM-NO1 PHASE 1

PROPOSED IMPROVEMENTS TO HANNAY LANE

DWG NO. GLM-440-002

