

PROFILE OF COLUMBINE DRIVE

SCALE: HORIZ. 1"=50'  
VERT. 1"=5'

NOTES  
GRADE OF GRAVITY SEWERS ARE CALCULATED BY THE FOLLOWING CRITERIA:  
1. LENGTH OF PIPE RUN IS FROM CENTERLINE OF RESPECTIVE MANHOLES.  
2. PERCENT GRADE IS CALCULATED FROM CENTERLINE TO CENTERLINE OF RESPECTIVE MANHOLES.

ALL CONSTRUCTION DISTURBANCES ON STATE OR PRIVATE LAND TO BE RESTORED BY CONTRACTOR

UNAUTHORIZED ALTERATIONS OR ADDITIONS TO THIS DOCUMENT IS A VIOLATION OF SECTION 7209 SUBDIVISION 2 OF THE NEW YORK STATE EDUCATION LAW

REVISIONS			
DATE	BY	DESCRIPTION	SYMBOL
8/87	TM	CHANGED INVERTS AND DEPTH OF MH 9.	△
11/87	JB	ADDED NOTE REGARDING GRADE OF GRAVITY SEWERS.	△
12/89	JB	UTILITIES EDITED PER FINAL GRADING	
3/12/90	JB	FINAL REVISIONS	XXXX
4/19/90	JB	DOH EDITS	XXXX
2-11-93	JB	Revisions per Town of Bethlehem Engineering Department review	

NOTE: SEWER LINES ARE TO BE INSTALLED UNDER THE SUPERVISION OF A NEW YORK STATE LICENSED PROFESSIONAL ENGINEER. ENGINEER SHALL SUBMIT A CERTIFICATE STATING THAT THE CONSTRUCTED FACILITIES HAVE BEEN CONSTRUCTED IN ACCORDANCE WITH THE APPROVED PLANS. CERTIFICATION MUST BE RECEIVED BY THE ALBANY COUNTY HEALTH DEPARTMENT WITHIN SIXTY (60) DAYS FROM THE COMPLETION OF CONSTRUCTION.  
NOTE: WATER QUALITY-TYPE PIPE MATERIAL (D.I.P. OR PVC SDR 26) MUST BE UTILIZED FOR SANITARY AND STORM SEWERS IN AREAS WHERE A TEN FOOT HORIZONTAL OR 18" VERTICAL SEPARATION DISTANCE FROM WATER MAINS CANNOT BE MAINTAINED.  
NOTE: ALL WATER MAINS ARE TO BE INSTALLED, DISINFECTED, AND TESTED IN ACCORDANCE WITH AWWA STANDARD C601 OR OTHER METHOD ACCEPTABLE TO THE ALBANY COUNTY HEALTH DEPARTMENT.

J. KENNETH FRASER AND ASSOCIATES, P.C.  
CONSULTING ENGINEERS  
RENSSELAER, NEW YORK

LANDS FORMERLY OF  
**R & R ASSOCIATES**  
NOW  
THE MEADOWS AT BETHLEHEM, A NEW YORK PARTNERSHIP AND YORK LAND DEVELOPMENT CORPORATION  
**THE MEADOWS SUBDIVISION**

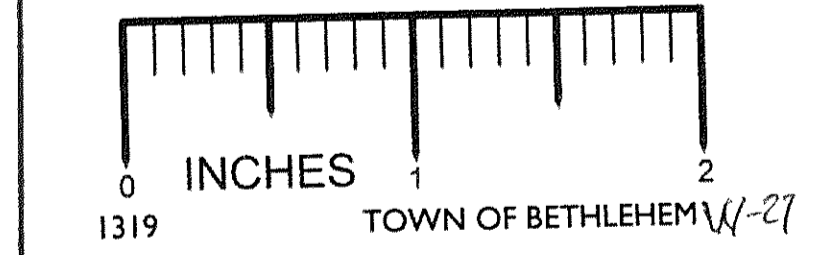

TOWN OF BETHLEHEM  
**RECEIVED**  
FEB 12 1993

SCALE: AS NOTED

PROJ. ENG'R: JFB  
DRAWN BY: HLW  
ASSEMBLED BY: EJS  
CHECKED BY: JKF

SHEET TITLE:  
**PROFILE-COLUMBINE DRIVE**

DATE: JANUARY 1987 SHEET 13 OF 26

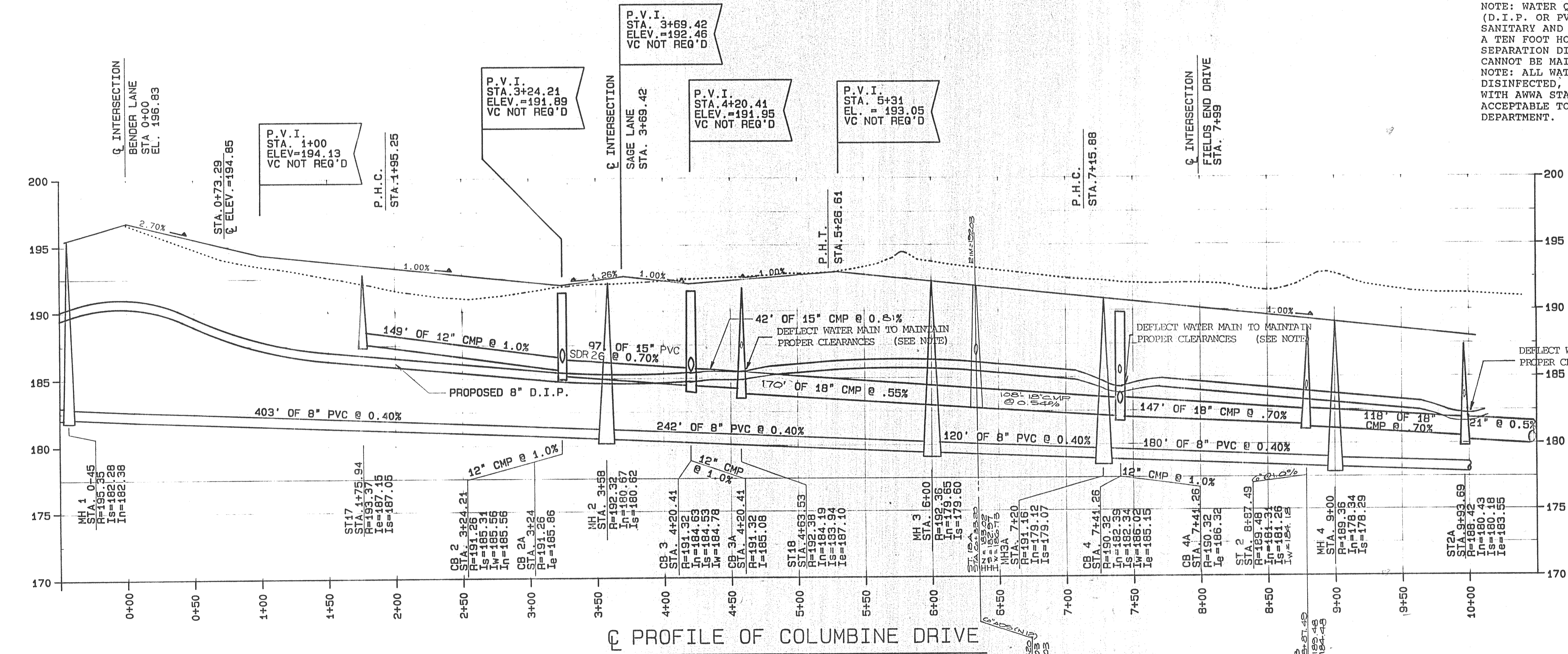

PROFILE OF COLUMBINE DRIVE

SCALE: HORIZ. 1"=50'  
VERT. 1"=5'