

DESIGN SUPERVISOR W. ECKER
 JOB MANAGER T. OTTINI
 DESIGNED BY T. OTTINI
 CHECKED BY M. HURTT
 ESTIMATED BY M. MOKEY
 DRAFTED BY M. MOKEY
 CHECKED BY K. RAPELLO
 M. HURTT
 CHECKED BY

FED ROAD REG. NO.	STATE	CONTRACT NO.	SHEET NO.	TOTAL SHEETS
1	N.Y.	D260243	302	378
P.I.N. 1125.24		B.I.N. 1-06029-0; 1-07884-0		
ALBANY COUNTY				
S.H. NO. 2006-1, SLINGERLANDS BYPASS - PART 3				
F.A.S.H. NO 64- 13, SLINGERLANDS BYPASS - PART 2, (MAHER ROAD TO ALBANY CITY LINE)				
S.H. NO. 5237, SLINGERLANDS-ALBANY				
N.Y.S. ROUTE 140 TO THE ALBANY CITY LINE				

NOTES:

- ALL WATERLINE SHUTDOWNS SHALL BE COORDINATED WITH THE TOWN OF BETHLEHEM WATER DEPARTMENT. THE CONTRACTOR SHALL PROVIDE A MINIMUM 48 HOUR NOTICE TO THE TOWN PRIOR TO TIE-INS AND SHUTDOWNS. CONTACT NUMBER IS 439-2414. TWO WEEKS NOTICE MUST BE GIVEN TO THE LOCAL FIRE COMPANY PRIOR TO ANY SHUTDOWN.
 - WHERE THE EXISTING WATERLINE IS SPECIFIED TO BE ABANDONED, THE WATERLINE SHALL BE PUMPED FREE OF WATER AND EACH OPEN END SHALL BE PLUGGED WITH A MINIMUM OF 600mm OF CLASS A CONCRETE AND FILLED WITH ITEM 204.01 - CONTROLLED LOW STRENGTH MATERIAL. THE COST OF THE CLASS A CONCRETE SHALL BE INCLUDED IN THE PRICE BID FOR THE VARIOUS WATERLINE ITEMS.
 - CONTRACTOR SHALL UNDEARTH AND VERIFY ELEVATIONS OF OTHER EXISTING UTILITIES (SEWER LINES, CULVERTS, ETC.) TO ENSURE ADEQUATE CLEARANCE FOR THE WATER LINE. CONTRACTOR SHALL NOTIFY THE ENGINEER (IN WRITING) OF CONFLICTING ELEVATIONS WITH SUFFICIENT NOTICE TO ALLOW THE ENGINEER ADEQUATE TIME TO REVISE GRADES WITHOUT NECESSITATING REMOVAL AND RECONSTRUCTION OF WORK ALREADY COMPLETED BY THE CONTRACTOR.
 - NO RESPONSIBILITY IS ASSUMED FOR THE POSSIBLE EXISTENCE OF SUBSURFACE UTILITIES NOT SHOWN HEREIN. NO WARRANTY IS MADE AS TO THE ACCURACY OF ANY UTILITY LINES SHOWN HEREIN. IT IS THE CONTRACTOR'S RESPONSIBILITY TO DETERMINE THE EXACT LOCATIONS OF EXISTING UTILITIES. TEST PITS FOR DETERMINING EXISTING UTILITY LOCATIONS AND DEPTHS SHALL BE PAID UNDER ITEM 206.05.
 - UPON COMPLETION OF ALL WATER SUPPLY RELATED CONSTRUCTION, ALL MAINS, VALVES, HYDRANTS AND OTHER APPURTENANCES BUILT UNDER THIS CONTRACT SHALL BE DISINFECTED, FLUSHED AND TESTED FOR BACTERIOLOGICAL QUALITY IN ACCORDANCE WITH AWWA C-651, EXCEPT THAT TABLETS SHALL NOT BE USED FOR CHLORINATION.
 - REFER TO NYS DOT STANDARD SHEETS M663-1 TO M663-7 FOR ADDITIONAL WATERMAIN DETAILS.
 - ALL NEW DUCTILE IRON PIPE AND FITTINGS FOR WATERLINE SHALL BE ENCASED IN WRAP, ITEMS 663.2312 & 663.2316 FOR 12 NPS AND 16 NPS RESPECTIVELY.
 - ALL BOLTS FOR WATERMAIN RELATED VALVES AND FITTINGS SHALL BE LOW CARBON STEEL, (BLUE BOLTS).
 - RE-ESTABLISHMENT OF EXISTING WATERLINE SERVICE (RESIDENTIAL) SHALL BE PAID UNDER ITEMS 663.06XX AND 663.25XX. FOR ESTIMATING PURPOSES IT IS ASSUMED:

663.0603	40 M
663.0604	5 M
663.2503	2 EA
663.2504	1 EA
- LOCATIONS SHALL BE DETERMINED IN THE FIELD BY THE CONTRACTOR AND VERIFIED BY THE E.I.C. IN CONSULTATION WITH THE TOWN.

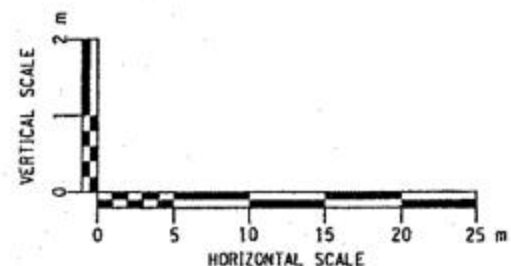
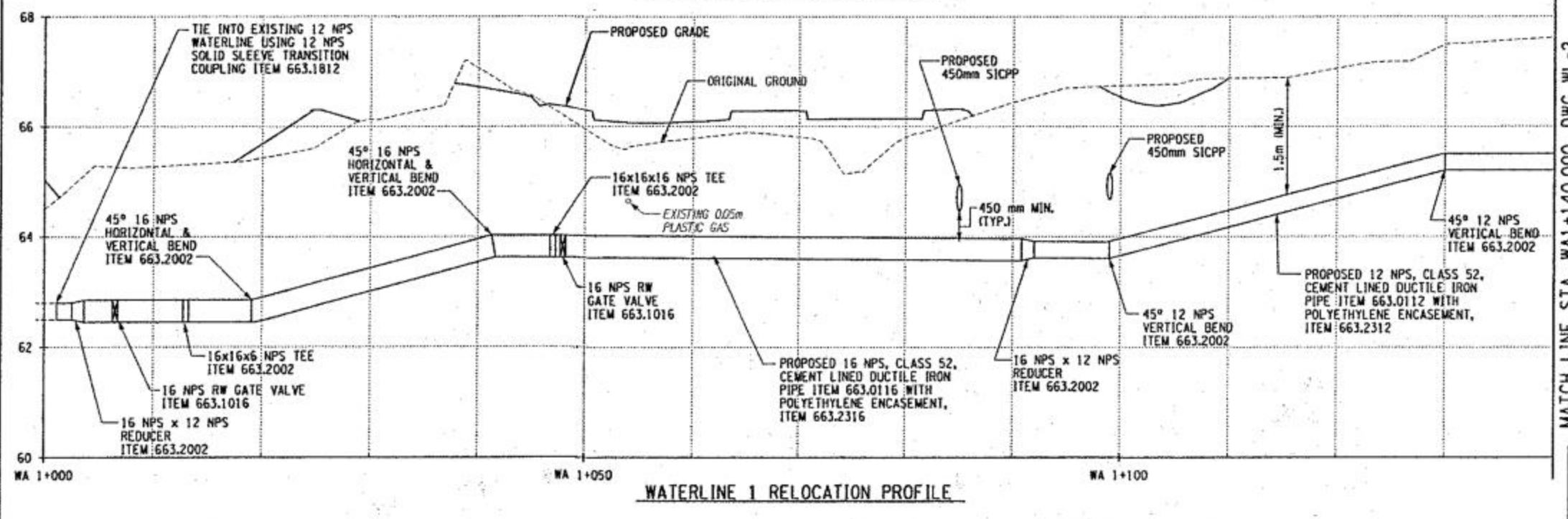
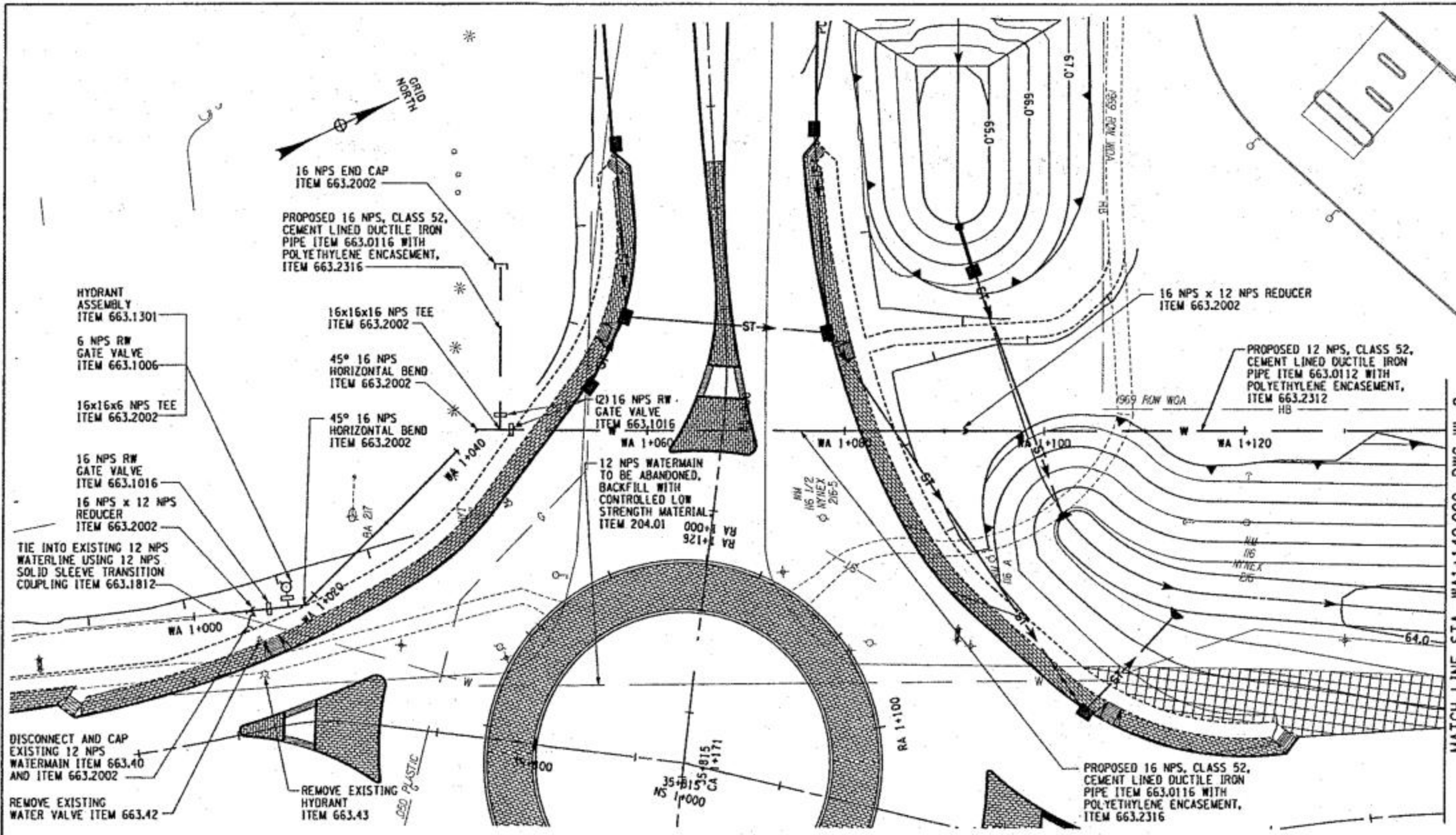

AS BUILT REVISIONS

SIGNATURE _____ DATE _____

WATERLINE DETAILS

STATE OF NEW YORK
DEPARTMENT OF TRANSPORTATION

DOCUMENT NAME	REGION	DATE	DRAWING NO.
112519A_JTL.DGN	1	04/06	WL-1

MATCH LINE STA. WA1+140.000, DWG WL-2

MATCH LINE STA. WA1+140.000, DWG WL-2

