

**Driveway Profile**  
SCALE: 1" = 20' H  
1" = 20' V

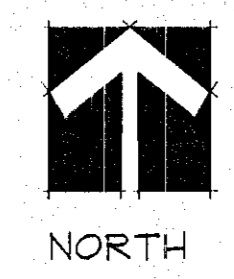

BLUE CROSS  
BLUE SHIELD

PIH 493  
Rim = 142.00  
Inv. In = 139.92  
Inv. Out = 134.10

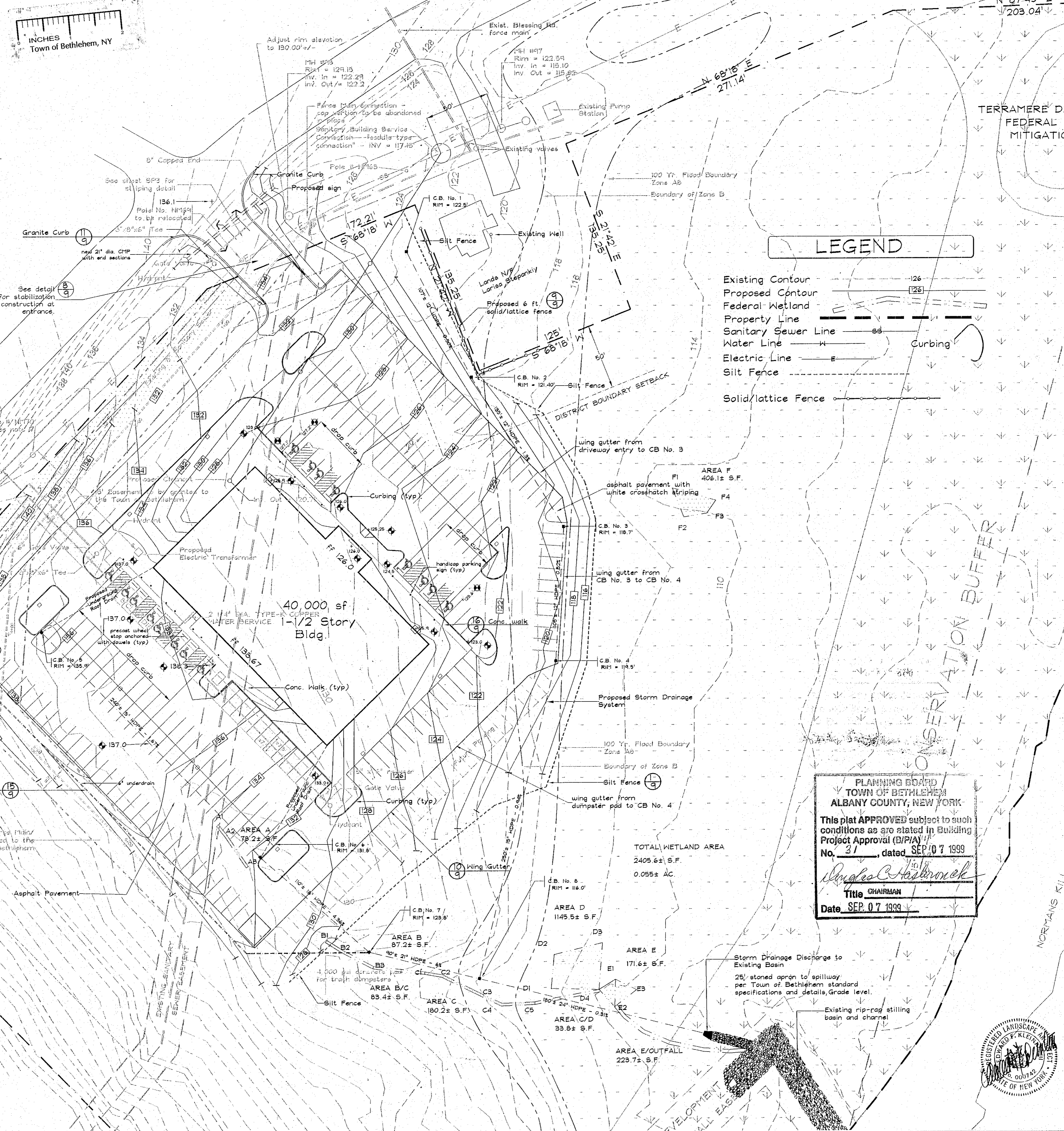
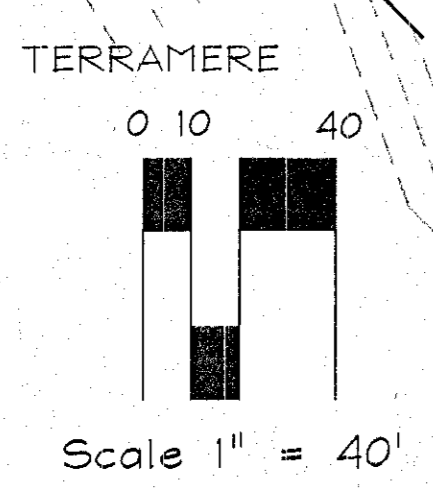
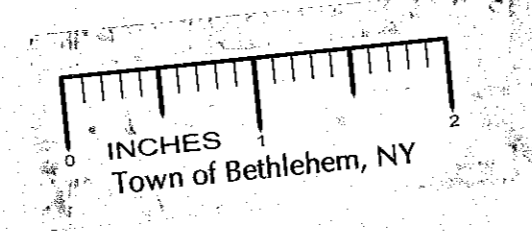

**LEGEND**

- Existing Contour
- Proposed Contour
- Federal Wetland
- Property Line
- Sanitary Sewer Line
- Water Line
- Electric Line
- Silt Fence
- Solid/lattice Fence
- Curbing

PLANNING BOARD  
TOWN OF BETHLEHEM  
ALBANY COUNTY, NEW YORK  
This plat APPROVED subject to such conditions as are stated in Building Project Approval (B/P/A) No. 31 dated SEP 07 1999  
*Douglas C. Hasbrouck*  
Title CHAIRMAN  
Date SEP 07 1999

TOTAL WETLAND AREA  
2405.6± S.F.  
0.055± AC.

Storm Drainage Discharge to Existing Basin  
25' stoned apron to spillway per Town of Bethlehem standard specifications and details, Grade level.  
Existing rip-rap stilling basin and channel

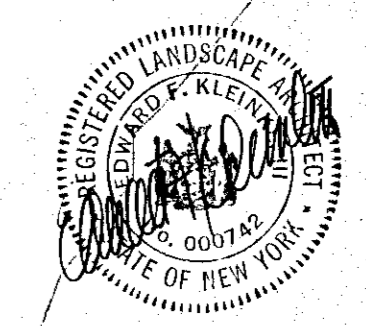

**General Notes**

- All utilities to be installed in accordance with Town Standard details and Specifications. Prior to construction, the contractor shall obtain these materials for use on the job.
- All elevations shown are on USGS elevation base.
- All grading to be 3:1 (horizontal:vertical) maximum slope.
- Prior to any work in the State right-of-way, a highway work permit from the New York State Department of Transportation is required.
- Prior to any work on sanitary sewer and water, the contractor shall obtain the necessary permits from the Town Department of Public Works.
- Dumpster pad shall be 6" thick, 4,000 psi concrete. Subbase shall be 8" thick r.o.b., 2" thick crusher run.
- Contractor must protect all surface waters from siltation during construction with appropriate measures including, but not limited to placing hay bales and siltation fencing around work. As a minimum, hay bales and siltation fencing shall be placed as shown on the plan and in all drainage swales at intervals required to control siltation.
- The contractor shall be responsible for keeping existing public highways and adjacent lands free of debris, soil and other matter which may accumulate due to construction related to the site.
- On-site material used for fill shall be placed in lifts not exceeding 9 inches loose thickness and compacted to a minimum of 90 percent Modified Proctor, ASTM D-1557.

6	Town Staff/Health Department	8/23/99
5	Town Staff Review	8/10/99
4	Town Staff Review	8/3/99
3	Town Staff Review	7/26/99
2	Planning Board Review	7/7/99
1	Building Project Submission	6/28/99
No.	Revision/Issue	Date

Design Professionals  
**Kleinke Associates**  
Landscape Architects  
Delmar, New York  
**David Sanders PC**  
Engineers  
East Greenbush, NY

Project Sponsor  
**FIRST COLUMBIA**  
Strategic Healthcare Provider

Building Project  
**Site Plan**  
Grading  
© Kleinke Associates 1999

Project #	0315/99	Sheet	
Date	June 1999		<b>SP2</b>
Scale	1" = 40'		