

- LEGEND
- HPS HANDICAP PARKING SIGN
 - ★ LIGHT POLE
 - TREE DECIDUOUS - NUMBER IS DIAMETER
 - TREE CONIFEROUS - NUMBER IS DIAMETER
 - FFE FINISHED FLOOR ELEVATION
 - HYDRANT
 - ⊙ SANITARY MANHOLE
 - ⊙ CB STORM CATCH BASIN
 - ⊙ WATER VALVE
 - ⊙ C.I.R.F. CAPPED IRON ROD FOUND
 - ⊙ I.R.F. IRON ROD FOUND
 - EXISTING CONTOUR

PARKING TABLE

REQUIRED PARKING = 1.1 SPACES PER DWELLING UNIT
 1.1 SPACES X 179 D.U. = 197 SPACES
 TOTAL PARKING REQUIRED =

EXISTING PARKING NORTH LOT - 82 SPACES
 EXISTING PARKING WEST LOT 1 - 53 SPACES
 EXISTING PARKING WEST LOT 2 - 34 SPACES
 EXISTING PARKING SOUTH LOT - 48 SPACES
 EXISTING PARKING GARAGE - 20 SPACES

PROPOSED PARKING NORTH LOT - 39 SPACES
 PROPOSED PARKING WEST LOT 1 - 48 SPACES
 PROPOSED PARKING WEST LOT 2 - 34 SPACES
 PROPOSED PARKING SOUTH LOT - 81 SPACES
 PROPOSED PARKING GARAGE - 20 SPACES

EXISTING PARKING FOR ILU FACILITY - 237 SPACES
 PROPOSED PARKING - 221 SPACES
 PROPOSED PARKING RATIO - 1.23 SPACES PER DWELLING UNIT

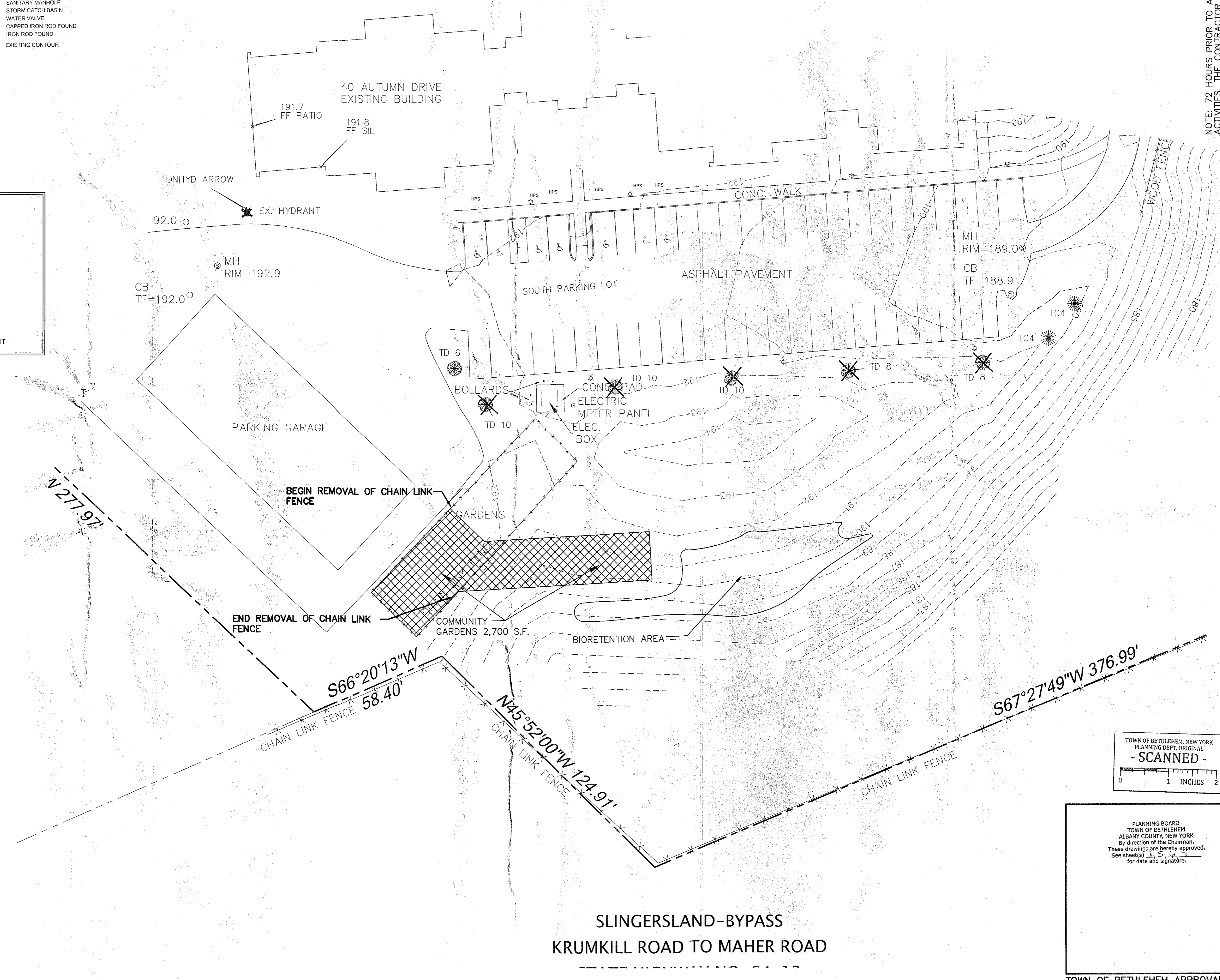

GENERAL NOTES

1. IT IS THE INTENT OF THESE PLANS TO BE IN STRICT CONFORMANCE WITH ALL TOWN OF TOWN OF BETHLEHEM COUNTY OF ALBANY, STATE OF NEW YORK, AND APPLICABLE FEDERAL RULES REGULATIONS, AND LAWS. IF CONFLICTS ARE NOTED BETWEEN THE ABOVE, AND THESE PLANS, IT SHALL BE BROUGHT TO THE ATTENTION OF THE DESIGN ENGINEER AND THE TOWN ENGINEER.
2. PRIOR TO CONSTRUCTION, THE CONTRACTOR SHALL VERIFY ALL DIMENSIONS, GRADES, ELEVATIONS, AND MATERIALS GIVEN ON THE PLANS.
3. IT SHALL BE THE CONTRACTORS RESPONSIBILITY TO REPAIR ANY DAMAGE DONE OUTSIDE OF THE PROJECT AREA OR LIMITS OF CLEARING.
4. EXCESS BUILDING MATERIAL AND CLEARING DEBRIS SHALL BE DISPOSED OF OFF SITE.
5. UNDERGROUND UTILITIES IF SHOWN HEREON ARE BASED ON VISIBLE PHYSICAL EVIDENCE. THEY SHOULD BE CONSIDERED SCHEMATIC ONLY AND ARE SHOWN TO DEPICT GENERAL UTILITY CONNECTIONS RATHER THAN EXACT UNDERGROUND LOCATIONS.
6. SURVEY BASE MAPPING HAS BEEN PROVIDED BY OTHERS. BRETT L. STEENBURGH, P.E., LLC MAKES NO CERTIFICATION AS TO THE ACCURACY AND COMPLETENESS OF SAID MAPPING.
7. CONFLICTS SHOWN ON PLANS OR BETWEEN THE PLANS AND SPECIFICATIONS SHALL BE BROUGHT TO THE ATTENTION OF THE OWNER, OWNER REPRESENTATIVE AND ENGINEER.
8. THE PARCEL PROPOSED FOR DEVELOPMENT LIES ENTIRELY WITHIN THE TOWN OF BETHLEHEM PLANNED DEVELOPMENT DISTRICT (PRD NO. 12).
9. THE PARCEL PROPOSED FOR DEVELOPMENT LIES ENTIRELY WITHIN THE TOWN OF BETHLEHEM SEWER AND WATER DISTRICTS.
10. THE PARCEL PROPOSED FOR DEVELOPMENT LIES ENTIRELY WITHIN THE NORTH BETHLEHEM FIRE DISTRICT.
11. THE PARCEL PROPOSED FOR DEVELOPMENT LIES ENTIRELY WITHIN THE GUILDERLAND CENTRAL SCHOOL DISTRICT.
12. TRASH WILL BE TEMPORARILY STORED IN THE SCREENED MAINTENANCE AREA BEFORE REMOVAL TO THE EXISTING MAINTENANCE BUILDING COMPACTOR.

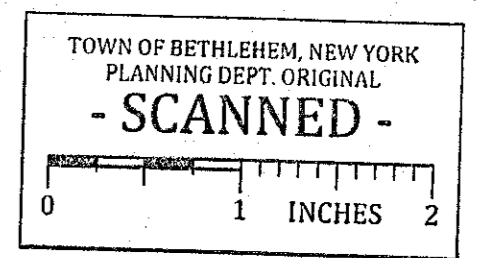

PLANNING BOARD
 TOWN OF BETHLEHEM
 ALBANY COUNTY, NEW YORK
 By direction of the Chairman,
 These drawings are hereby approved.
 See sheet(s) 1, 2, 3, 4, 5
 for date and signature.

TOWN OF BETHLEHEM APPROVAL

NOTE: 72 HOURS PRIOR TO ANY CONSTRUCTION ACTIVITIES, THE CONTRACTOR SHALL CONTACT THE DIG SAFELY NEW YORK TO LOCATE ALL UNDERGROUND UTILITIES. 1-800-962-7962

NO.	DATE	REVISIONS
2	10-1-14	REVISED AS PER TOWN ENGINEERING COMMENTS
1		REVISED AS PER TOWN AND THE COMMENTS

Scaling of these drawings shall be done only by the user. The user shall verify all dimensions and electronic data only for layout and construction.

Unauthorized alterations or additions to this document is a violation of Sec. 7209 Sub. 2 of the NYS Education Law. Copyright 2014 Brett L. Steenburgh, P.E. PLLC. All rights reserved. No use or reproduction without the express written consent of Brett L. Steenburgh, P.E., PLLC.

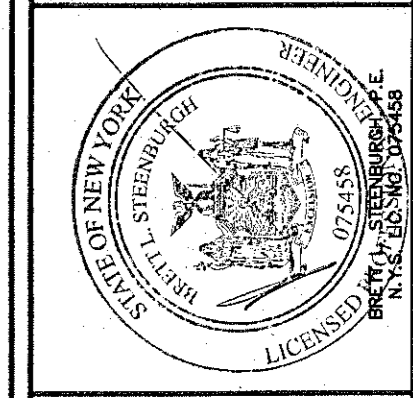

BRETT L. STEENBURGH, P.E. PLLC

2832 ROSENDALE ROAD
 NISKAYUNA, NY 12309
 PHONE - (518) 865-0875
 FAX - (518) 280-8520
 bsteenb@ny.cayarr.com

CIVIL ENVIRONMENTAL STRUCTURAL ENGINEERING

DEMOLITION AND REMOVAL PLAN 3

BEVERWYCK ILU ADDITION

TOWN OF BETHLEHEM, STATE OF NEW YORK

COUNTY OF ALBANY

BRN BY: BLS

CADD FILE: DF-RECOVER

DATE: MAY 12, 2014

SCALE: 1" = 20'

SHEET 4 OF 18