

**ERDMAN
ANTHONY**

11 CENTURY HILL DRIVE, SUITE 105
Latham, NY 12110
Telephone (518)783-1205
Facsimile (518)783-0374
www.erdmananthony.com



DATE _____ DATE _____

NOTE: UNAUTHORIZED ALTERATION OR ADDITION TO THIS
DRAWING IS A VIOLATION OF THE NEW YORK STATE
EDUCATION LAW ARTICLE 145, SECTION 7209.

REVISIONS

NO.	DESCRIPTION	BY	DATE
1	ADDED SHEET	RLD	3/12/13
2	REVISED PER TOWN	RLD	5/16/13

ALL RIGHTS RESERVED: No part of this document may be
reproduced, stored in a retrieval system, or transmitted, in
any form or by any means electronic, mechanical, photocopying,
recording, or otherwise without the prior written authorization of
ERDMAN ANTHONY.

COPYRIGHT
©2013 Erdman Anthony

CLIENT:

**BENDERSON
DEVELOPMENT
COMPANY, LLC**

PROJECT NAME:

**GLENMONT PLAZA -
380 FEURA BUSH
ROAD PROPOSED
PAD SITE**

DRAWING TITLE:

**DISTURBANCE
PLAN**

SCALE: 1"=40'	DATE: FEB. 2013
DES. BY: RLD	DR. BY: MFJ
CK'D BY: RLD	EA PROJECT NO. 1700C.55
SHEET NO. 4 OF 13	DRAWING NO. C3.1

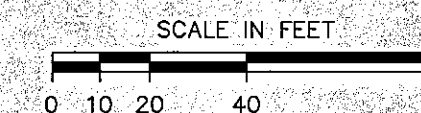
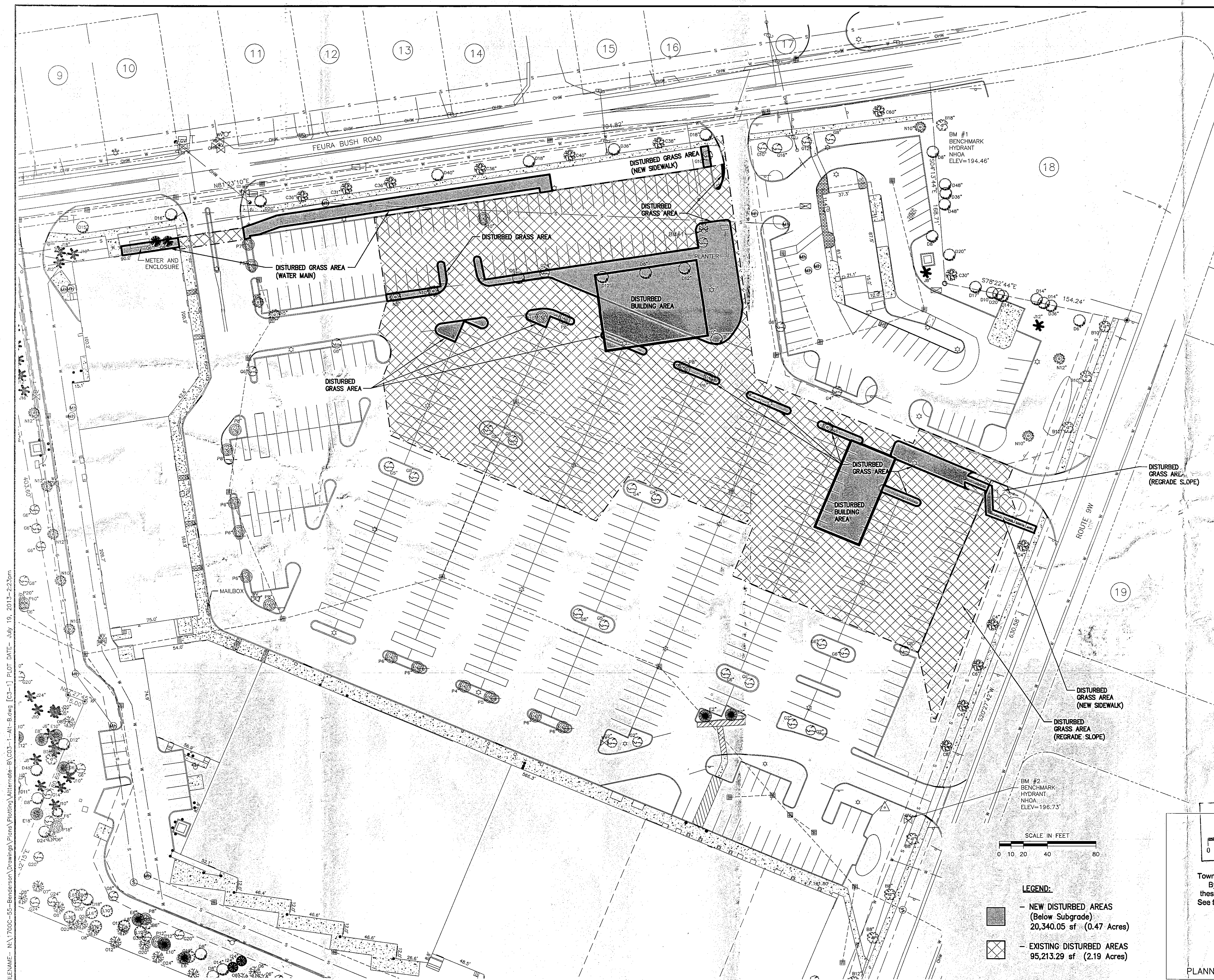

LEGEND:

- NEW DISTURBED AREAS
(Below Subgrade)
20,340.05 sf (0.47 Acres)
- EXISTING DISTURBED AREAS
95,213.29 sf (2.19 Acres)

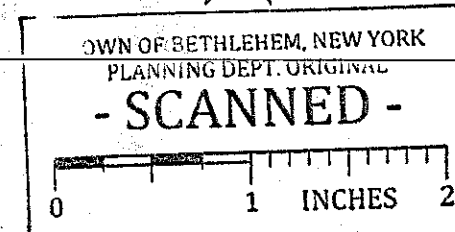

Town of Bethlehem Planning Board
By direction of the Chairman
these plans are hereby Approved.
See first sheet for date & signature.

PLANNING BOARD APPROVAL

FILENAME: N:\1700C-55-Benderson\Drawings\Plans\Plotting\Alterations-B\1700C-55-Alt-B.dwg [C3-1] PLOT DATE: July 19, 2013-2:23pm