

MAINTENANCE

1. SEDIMENT SHALL BE REMOVED FROM SEDIMENT TRAPS WHENEVER THEIR CAPACITY HAS BEEN REDUCED BY 50%.
2. ALL EROSION AND SEDIMENT CONTROL DEVICES SHALL BE INSPECTED WITHIN 24 HOURS OF A STORM EVENT BY THE SITE CONTRACTOR AND REPAIRED AND/OR MODIFIED AS REQUIRED TO BE GOOD WORKABLE CONDITION.
3. THE CONTRACTOR SHALL CONDUCT AN INSPECTION OF THE SITE ON A DAILY BASIS TO COLLECT LITTER AND CONSTRUCTION DEBRIS AND DISPOSE OF LEGALLY.
4. ANY STOCKPILES OF FILL, TOPSOIL, EXCAVATED MATERIAL SHALL BE COVERED OR CONTAINED BY SEDIMENT CONTROL FENCE TO PREVENT EROSION.

GENERAL E & SC NOTES:

1. NO MATERIAL AND/OR EQUIPMENT SHALL BE STOCKPILED OR STORED IN THE LOCATION OF THE SEPTIC FIELDS.
2. IT IS ASSUMED THAT DUE TO THE HIGH PERMIABILITY OF THE ON SITE SOILS NO SEDIMENT BASINS SHALL BE REQUIRED; HOWEVER, IF SEDIMENT BASINS ARE ARE DEEMED NECESSARY DURING CONSTRUCTION, THEY SHALL BE CONSTRUCTED IN ACCORDANCE WITH THE NYS GUIDELINES FOR EROSION AND SEDIMENT CONTROL.

S.W.P.P.P. REQUIREMENTS

1. THE CONTRACTOR UNDERTAKING SITE CONSTRUCTION OF THIS PROJECT MUST SIGN THE CERTIFICATION IN THE SWPPP AND BE FAMILIAR WITH ALL REQUIREMENTS OF THE SWPPP AND REQUIREMENTS OF THE NYS DEC SPDES GENERAL PERMIT FOR STORMWATER DISCHARGES FROM CONSTRUCTION ACTIVITY - PERMIT No.-GP-0-15-002.
2. THE CONTRACTOR MUST IS RESPONSIBLE TO COMPLY WITH THE TERMS OF THE NYS DEC SPDES GENERAL PERMIT FOR STORMWATER DISCHARGES FROM CONSTRUCTION ACTIVITY - PERMIT No. GP-0-15-002. COPIES OF THE GENERAL PERMIT ARE AVAILABLE BY CALLING DEC (518) 402-8109 AND ON LINE. ADDITIONALLY, THE CONTRACTOR SHALL COMPLY WITH ALL TOWN OF BETHLEHEM MS4 REGULATIONS.
3. A NOTICE OF INTENT (NOI) MUST BE SUBMITTED TO DEC PRIOR TO INITIATING WORK.
4. THE SWPPP INCLUDES INFORMATION ON ALL DRAWINGS AND THE STORMWATER POLLUTION PREVENTION PLAN
5. PRIOR TO COMMENCEMENT OF CONSTRUCTION, THE CONTRACTOR SHALL HAVE THE ENGINEER CONDUCT AN ASSESSMENT OF THE SITE AND CERTIFY IN AN INSPECTION REPORT THAT THE APPROPRIATE EROSION AND SEDIMENT CONTROLS HAVE BEEN ADEQUATELY INSTALLED. FOLLOWING COMMENCEMENT OF CONSTRUCTION, THE ENGINEER SHALL MAKE SITE INSPECTIONS EVERY 7 DAYS. AS REQUIRED BY THE GP-0-15-002.
6. THE CONTRACTOR SHALL MAINTAIN A RECORD OF ALL INSPECTION REPORTS IN A SITE LOG BOOK, MAINTAINED ON SITE AND AVAILABLE TO THE PERMITTING AUTHORITY UPON REQUEST.
7. AT COMPLETION OF CONSTRUCTION, THE CONTRACTOR SHALL PERFORM A FINAL INSPECTION TO CERTIFY THAT THE SITE HAS UNDERGONE FINAL STABILIZATION AND THAT ALL TEMPORARY EROSION AND SEDIMENTATION CONTROLS HAVE BEEN REMOVED. UPON CERTIFICATION OF COMPLETION A NOTICE OF TERMINATION (NOT) SHALL BE SUBMITTED TO NYS DEC.
8. ALL SLOPES STEEPER THAN A 1V:4H SHALL BE STABILIZED WITH SEED, FERTILIZER AND A ROLLED EROSION CONTROL BLANKET.
9. ALL SLOPES LESS THAN A 1V:4H SHALL BE STABILIZED WITH SEED, FERTILIZER AND MULCH
10. ALL SEED, MULCH AND FERTILIZER APPLICATION RATES SHALL BE IN ACCORDANCE WITH THE NEW YORK STATE STANDARDS AND SPECIFICATIONS FOR EROSION AND SEDIMENT CONTROL "THE BLUE BOOK".
11. ALL WORK PERFORMED ON THE SITE SHALL BE IN ACCORDANCE WITH THE NEW YORK STATE STANDARDS AND SPECIFICATIONS FOR EROSION AND SEDIMENT CONTROL "THE BLUE BOOK".
12. ALL WORK PERFORMED IN ACCORDANCE WITH THE SWPPP.
13. PROJECT CONSTRUCTION SHALL BE PHASED SUCH THAT SOIL DISTURBANCE SHALL NOT EXCEED FIVE (5.0) ACRES AT A TIME.
14. THE OWNER AND APPLICANT ACKNOWLEDGE THAT THE PROPOSED PRIVATELY OWNED AND MAINTAINED STORM SEWER SYSTEM WAS DESIGNED BY THEIR ENGINEER TO CONVEY THE 10 YEAR STORM EVENT AND PERIODIC PONDING OF STORMWATER WILL OCCASIONALLY OCCUR ON THE SITE. THE TOWN OF BETHLEHEM AND TOWN DESIGNATED ENGINEER SHALL BE HELD HARMLESS FOR THIS DESIGN OR CONDITION.

LEGEND

--- PROPOSED SILT FENCE

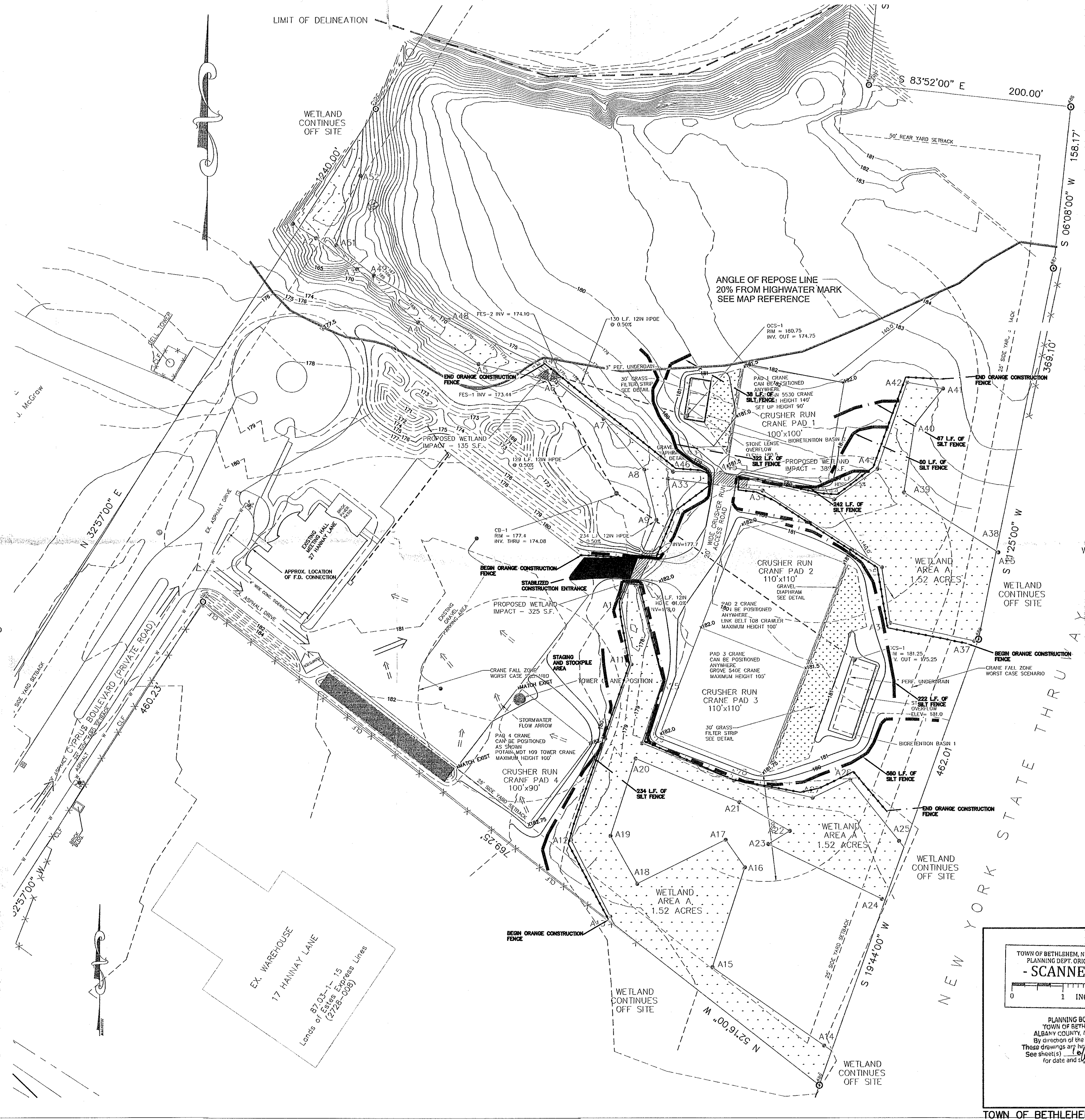

NOTE: 72 HOURS PRIOR TO ANY CONSTRUCTION ACTIVITIES, THE CONTRACTOR SHALL CONTACT THE DIG SAFELY NEW YORK TO LOCATE ALL UNDERGROUND UTILITIES. 1-800-962-7962

Scale of this drawing shall be that only for new and revised dimensions and use dimensions only for layout and construction. Unpublished alterations or additions to this document is a violation of Sec. 7209 Sub. 2 of the NYS Education Law. Copyright 2014 Brett L. Steenburgh, P.E. All rights reserved. No part of this document may be reproduced without the written consent of Brett L. Steenburgh, P.E., P.L.C.

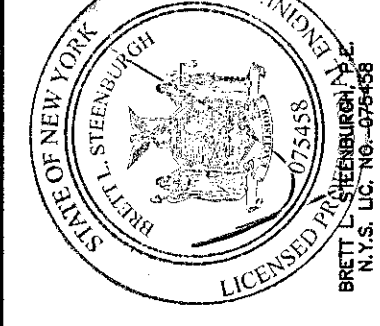

BRETT L. STEENBURGH, P.E. P.L.C.  
2832 ROSENDALE ROAD  
NISKAYUNA, NY 12309  
PHONE (518) 368-0675  
bsteenb@bsteenb.com  
CIVIL ENVIRONMENTAL STRUCTURAL  
ENGINEERING

E + SC PLAN - CRANE TRAINING CENTER  
INTERNATIONAL UNION OF OPERATING ENGINEERS  
27 HANNAY LANE  
TOWN OF BETHLEHEM  
COUNTY OF ALBANY  
STATE OF NEW YORK  
CHECKED BY: BLS  
JOB NO.  
DATE: AUGUST 7, 2016  
SCALE: 1" = 50'  
SHEET 2 OF 4

TOWN OF BETHLEHEM, NEW YORK  
PLANNING DEPT. ORIGINAL  
- SCANNED -  
0 1 2 INCHES  
PLANNING BOARD  
TOWN OF BETHLEHEM  
ALBANY COUNTY, NEW YORK  
By direction of the Chairman.  
These drawings are hereby approved.  
See sheet(s) 1-66-2 for date and signature.

TOWN OF BETHLEHEM APPROVAL