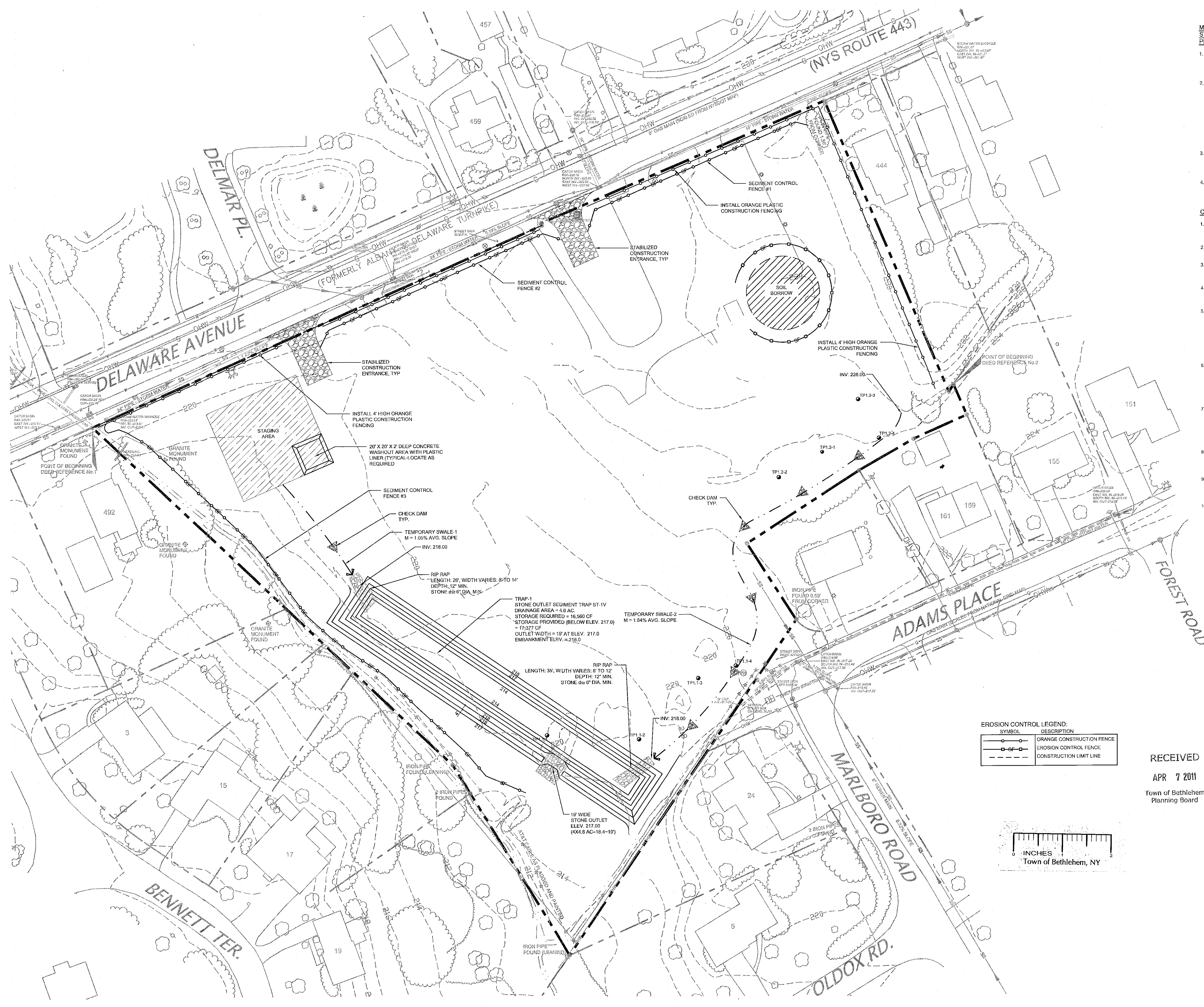

FIG. 11. MESSING BUILDERS DELMAR'S PRELIMINARY SITE PLAN, EROSION CONTROL PLAN, SEDIMENT & EROSION PLAN, PLANS, 3/21/2011 11:47:17 AM. PLATUSE: 4/2/2011 12:08:57 PM. User: Ted Rowland



**MAINTENANCE OF THE STORMWATER STORAGE SYSTEM AND WATER QUALITY PRACTICES:**

1. DETENTION SYSTEM INLETS AND OUTLETS ARE TO BE INSPECTED ANNUALLY AND CLEANED APPROPRIATELY TO PREVENT CLOGGING AND MAINTAIN THE EFFICIENCY OF THE STRUCTURE.
2. THE UNDERGROUND STORAGE SYSTEM (CULTEC) SHALL BE DESIGNED WITH AN OBSERVATION PORT TO MONITOR WATER LEVELS AND PROVIDE VISUAL INSPECTIONS. CULTEC RECOMMENDS THAT THE DETENTION SYSTEM PRETREATMENT STRUCTURES (CDS UNITS) BE INSPECTED EVERY 3 MONTHS FOR ANY DEBRIS THAT MAY RESTRICT FLOW RATES. THE CHAMBER WILL NOT REQUIRE ANY ROUTINE MAINTENANCE SINCE PRETREATMENT IS PROVIDED BY THE CDS UNITS. HOWEVER, THE CHAMBER BED SHOULD BE INSPECTED ANNUALLY AT THE INLET AND OUTLET AREAS TO REMOVE ANY RESTRICTIVE MATERIALS.
3. CONTROL STRUCTURES (CS-1.1 AND CS-1.2) SHOULD BE INSPECTED EVERY TWO TO THREE MONTHS FOR ANY OBSTRUCTIONS THAT COULD RESTRICT OUTLET FLOW RATES.
4. THE OWNER WILL BE REQUIRED TO EXECUTE A MAINTENANCE AGREEMENT WITH THE TOWN OF BETHLEHEM, WHICH IS A N/A.

**CONSTRUCTION SEQUENCING NOTES:**

1. STAKE OUT ALL NEW WORK IN THE FIELD, AND INSTALL ORANGE PLASTIC CONSTRUCTION FENCING WHERE INDICATED ON THE PLANS.
2. INSTALL TREE PROTECTION FENCING AND IDENTIFY LIMITS OF CLEARING IN THE FIELD WITH MARKING TAPE.
3. INSTALL ALL SEDIMENT CONTROL FENCING WHERE INDICATED ON THE PLAN DRAWINGS AND PROVIDE INLET PROTECTION AROUND ANY EXISTING DRAIN INLETS.
4. CONSTRUCT STABILIZED CONSTRUCTION ENTRANCES AT THE ENTRANCES TO THE SITE FROM DELAWARE AVENUE IN ACCORDANCE WITH THE PLAN DRAWINGS.
5. CONSTRUCT SEDIMENT TRAP-1 THEN TEMPORARY SWALE-1 AND TEMPORARY SWALE-2. STABILIZE THE DISTURBED SOILS WITH SEED, MULCH AND FABRIC AS NECESSARY. SEDIMENT TRAP-1, TEMPORARY SWALE-1 AND TEMPORARY SWALE-2 SHALL REMAIN UNTIL ALL DISTURBED AREAS (WITHIN EACH PRACTICE'S CONTROLLING AREA) HAVE BEEN PERMANENTLY STABILIZED. SEDIMENT TRAP-1 MAY BE REDUCED IN SIZE AS THE DISTURBED AREA IS PERMANENTLY STABILIZED. REQUIRED SURFACE IS 3.00 C/AC. OF DISTURBED AREA.
6. STORM DRAIN INLET PROTECTION MUST BE CONSTRUCTED AROUND EACH NEW INLET AS THEY ARE CONSTRUCTED. THE CONSTRUCTION DETAILS CALL FOR FILTER FABRIC INLET PROTECTION. HOWEVER, ALTERNATE METHODS CAN BE SUBMITTED TO THE OWNER'S REPRESENTATIVE FOR REVIEW AND APPROVAL IF THEY ARE MORE APPROPRIATE FOR THE SPECIFIC INLET CONDITION.
7. DISTURBED AREAS SHALL BE STABILIZED AS SOON AS POSSIBLE AFTER CONSTRUCTION HAS BEEN COMPLETED IN THE AREA, BUT IN NO CASE MORE THAN 14 DAYS AFTER THE CONSTRUCTION ACTIVITY IN THAT PORTION OF THE SITE HAS TEMPORARILY OR PERMANENTLY CEASED. STABILIZE AREAS WITH SEED AND MULCH, EROSION CONTROL, FABRIC OR RIPRAP AS PER THE PLAN DRAWINGS (OR AS BECOMES NECESSARY).
8. DUST CONTROL MEASURES SHALL BE EMPLOYED THROUGHOUT THE CONSTRUCTION AND THE FREQUENCY OF APPLICATION AND/OR THE APPLICATION RATE MAY NEED TO BE INCREASED IF THE PROBLEM PERSISTS OR INTENSIFIES.
9. CONCENTRATED FLOW MUST NOT BE ALLOWED TO LEAVE THE SITE WITHOUT TREATMENT. ANY SHEET FLOW THAT LEAVES THE SITE MUST FIRST PASS THROUGH SEDIMENT CONTROL FENCING.
10. AFTER ALL DISTURBED AREAS HAVE BEEN STABILIZED THE NEWLY INSTALLED STORM SEWER PIPING MUST BE FLUSHED AND INSPECTED. THE TEMPORARY EROSION AND SEDIMENT CONTROL MEASURES ALSO NEED TO BE REMOVED.

**LEGEND:**

- EXISTING WATER LINE
- EXISTING SANITARY LINE
- EXISTING GAS LINE
- EXISTING OVERHEAD UTILITY LINE
- EXISTING CONTOUR
- PROPERTY LINE
- PROPERTY CORNER
- PROPERTY CORNER FOUND
- EXISTING SIGNAGE
- EXISTING UTILITY POLE
- EXISTING UNIVERSAL MANHOLE
- EXISTING SANITARY MANHOLE
- EXISTING CATCH BASIN
- EXISTING HYDRANT
- EXISTING AT&T CABLE MARKER
- EXISTING AT&T CABLE AS FLAGGED
- EXISTING WATER VALVE
- EXISTING VERIZON MANHOLE
- EXISTING AT&T CABLE MARKER
- EXISTING CORRUGATED METAL PIPE
- EXISTING ROCK / BOULDER
- EXISTING PLANTER
- EXISTING WETLAND FLAG
- EXISTING TREES
- EXISTING TREE LINE
- TEST PIT

**EROSION CONTROL LEGEND:**

SYMBOL	DESCRIPTION
[Orange line with dots]	ORANGE CONSTRUCTION FENCE
[Orange line with cross-hatch]	EROSION CONTROL FENCE
[Dashed line]	CONSTRUCTION LIMIT LINE

RECEIVED  
APR 7 2011  
Town of Bethlehem  
Planning Board

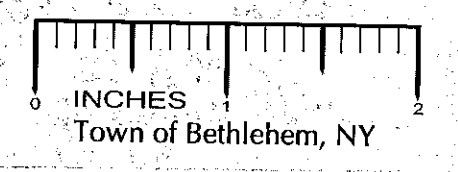

**TOWN OF BETHLEHEM APPROVAL**

PLANNING BOARD  
TOWN OF BETHLEHEM  
ALBANY COUNTY, NEW YORK

This Site Plan Approved

*George J. Finer*  
Title: Chairman

Date: 4/13/2011 SP153A2

**infinity engineering**  
11 Herbert Drive  
Latham, New York 12110  
(518) 690-0790

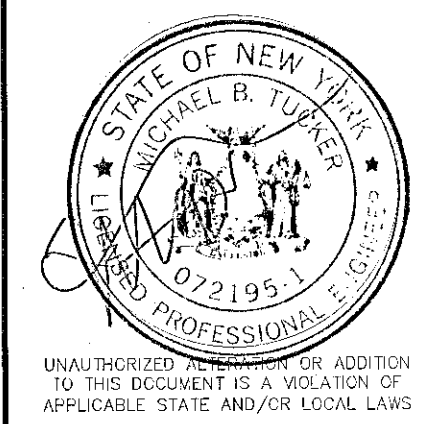

No.	Submittal / Revision	App'd	Date
4	TOWN COMMENTS	MBT	3/11
3	TOWN COMMENTS	MBT	1/11
2	TOWN COMMENTS	MBT	12/10
1	TOWN COMMENTS	MBT	12/10

Drawn: MJB Date: 10/10  
Designed: MBT Date: 10/10  
Checked: MBT Date: 10/10

Project Number  
182-122

Project Title

**The Gables at Delmar**

Delaware Avenue  
Delmar, NY 12054

Prepared For

**Keystone Builders Inc.**

Drawing Title  
**Sediment & Erosion Plan**

Drawing Scale:  
1" = 40'  
Date:  
3/18/2011

Issued For

**SITE PLAN APPROVAL**

Drawing Number

**C-13**