

VAN DYKE SPINNEY at DELMAR

TOWN OF BETHLEHEM
ALBANY COUNTY, NEW YORK

PHASE I

GENERAL DRAWING NOTES

1. ALL TRAFFIC SIGNAGE FOR THE PROPOSED DEVELOPMENT SHALL CONFORM TO THE NEW YORK STATE MANUAL FOR UNIFORM TRAFFIC CONTROL DEVICES (MUTCD).
2. SINGLE FAMILY RESIDENCE AND DRIVEWAY LOCATIONS SHOWN ON ALL SUBSEQUENT DRAWINGS ARE APPROXIMATE.
3. ALL EROSION CONTROL MEASURES SHALL BE INSTALLED AND MAINTAINED IN ACCORDANCE WITH THE NEW YORK STANDARDS AND SPECIFICATIONS FOR EROSION AND SEDIMENT CONTROL AND THE PROJECT STORMWATER POLLUTION PREVENTION PLAN (SWPPP).
4. ALL DISTURBED AREAS TO RECEIVE TOPSOIL, SEED, FERTILIZER AND MULCH TO ESTABLISH A PERMANENT STAND OF GRASS.
5. ALL SANITARY SEWER MANHOLES LOCATED IN GRASSED AREAS SHALL HAVE RIM ELEVATIONS SET APPROXIMATELY 6" ABOVE FINISH GRADE TO PREVENT INFILTRATION.
6. ALL HOMES WILL HAVE A SEWER CHECK VALVE INSTALLED WITHIN THE DWELLING.
7. ALL STORM DRAIN LATERALS SHALL HAVE A CHECK VALVE INSTALLED IN THE CATCH BASIN THAT THE STORM DRAIN LATERAL CONNECTS TO.
8. UPON ISSUANCE OF A BUILDING PERMIT, A TEMPORARY SIGN WITH 4" BLOCK LETTERS IS TO BE ERRECTED AT THE SITE DISPLAYING THE HOUSE NUMBER. ONCE THE STRUCTURE IS COMPLETED, THE ADDRESS NUMBER IS TO BE DISPLAYED EITHER ON THE HOUSE OR MAILBOX WITH 4" LETTERS. IT WILL BE THE BUILDERS INSPECTOR'S RESPONSIBILITY TO INSURE THAT THE PROPER ADDRESS NUMBERS ARE DISPLAYED BEFORE A C.O. IS ISSUED.
9. THE OWNER IS RESPONSIBLE FOR COORDINATING WITH NATIONAL GRID FOR ENERGY SERVICES.

GENERAL CONSTRUCTION NOTES

1. SIZE AND LOCATION OF UNDERGROUND UTILITIES ARE SUBJECT TO VERIFICATION BY THE CONTRACTOR BEFORE CONSTRUCTION BEGINS.
2. PRIOR TO START OF CONSTRUCTION, THE CONTRACTOR SHALL NOTIFY THE U.F.P.O. INC. (1-800-962-7982) FOR VERIFICATION OF THE LOCATION OF UNDERGROUND UTILITIES AT LEAST 48 HOURS PRIOR TO THE START OF EXCAVATION.
3. THE PLANS SHOW KNOWN SUBSURFACE STRUCTURES, ABOVE GROUND STRUCTURES AND/OR UTILITIES BELIEVED TO EXIST IN THE WORK AREA. THE EXACT LOCATION MAY VARY FROM THE LOCATIONS INDICATED. UNDERGROUND UTILITIES ARE SHOWN FROM FIELD LOCATIONS IF POSSIBLE. OTHERS ARE SHOWN FROM RECORD DATA. THEIR EXACT LOCATIONS MAY DIFFER FROM THAT AS SHOWN, AND OTHERS MAY EXIST.
4. THE CONTRACTOR SHALL TAKE ALL NECESSARY PRECAUTIONS TO PROTECT AND PRESERVE EXISTING UTILITIES.
5. ALL UTILITIES DAMAGED OR DISTURBED BY THE WORK OF THIS CONTRACT SHALL BE REPLACED IN KIND BY THE CONTRACTOR.
6. CONTRACTOR SHALL OBTAIN THE REQUIRED PERMITS FOR WORK WITHIN PUBLIC RIGHT OF WAY AS REQUIRED BY THE TOWN AND THE NYSOTD AND ALL PERMITS REQUIRED FOR UTILITY WORK ON-SITE FROM THE TOWN.
7. ALL PERMITS REQUIRED FOR WORK ON-SITE SHALL BE OBTAINED PRIOR TO COMMENCEMENT OF CONSTRUCTION.
8. THERE SHALL BE NO CHANGES ON THESE PLANS IN ADVANCE OF, OR CONSTRUCTION WITHOUT PRIOR APPROVAL OF THE DESIGN ENGINEER, THE OWNER AND THE MUNICIPALITY.
9. THE CONTRACTOR SHALL COMPLY WITH CONSTRUCTION INSPECTIONS REQUIREMENTS OF ALL AGENCIES, AND PHASE WORK ACCORDINGLY.
10. THE CONTRACTOR SHALL VERIFY ALL DIMENSIONS AND REPORT ANY DISCREPANCIES TO THE ENGINEER PRIOR TO THE START OF CONSTRUCTION.
11. FIELD ADJUSTMENT MUST BE REVIEWED BY A REPRESENTATIVE OF STANTEC ENGINEERING PRIOR TO INSTALLATION.
12. PROTECT NEWLY GRADED WORK AREAS FROM TRAFFIC AND EROSION AND KEEP THEM FREE FROM TRASH AND DEBRIS UNTIL PHYSICAL COMPLETION OF WORK IN ACCORDANCE WITH THE PROJECT STORMWATER POLLUTION PREVENTION PLAN.
13. CONTRACTORS OPERATIONS ON SITE WHICH SHALL INCLUDE BUT NOT BE LIMITED TO DUST CONTROL, MATERIAL HAULING, FIRE PROTECTION, EROSION CONTROL, ETC. SHALL BE CONDUCTED IN ACCORDANCE WITH TOWN OF BETHLEHEM REQUIREMENTS.
14. LOCATE EXISTING UNDERGROUND UTILITIES IN AREAS OF WORK; IF UTILITIES ARE TO REMAIN IN PLACE, PROVIDE ADEQUATE MEANS OF SUPPORT AND PROTECTION DURING EARTHWORK OPERATIONS.
15. ALL DRIVEWAY AND PARKING AREAS ARE TO BE ASPHALT PAVED SURFACES UNLESS OTHERWISE NOTED.
16. ALL CONSTRUCTION AND MATERIALS SHALL BE IN ACCORDANCE WITH THE TOWN OF BETHLEHEM REGULATIONS AND CONSTRUCTION STANDARDS.
17. THE STORMWATER BASINS, CONVEYANCE PIPING STRUCTURES WITHIN THE SITE SHALL BE PRIVATELY OWNED. MULTIPLE PATH USE PATH TO BE OWNED BY THE TOWN OF BETHLEHEM. THE OWNER SHALL BE RESPONSIBLE FOR ALL INSPECTIONS AND TESTING IN ACCORDANCE WITH THE TOWN OF BETHLEHEM.
18. THE CONTRACTOR SHALL COORDINATE MAINTENANCE AND PROTECTION OF TRAFFIC WITH THE TOWN OF BETHLEHEM. ALL MAINTENANCE AND PROTECTION OF TRAFFIC SHALL BE IN ACCORDANCE WITH NYSOTD AND THE MANUAL OF UNIFORM TRAFFIC CONTROL DEVICES (MUTCD).
19. ALL SANITARY SEWER AND STORM SEWERS FRAMES SHALL BE SET AT THE BINDER COURSE ELEVATION AND RAISED TO THE TOP COURSE ELEVATION AT THE TIME OF TOP COURSE PLACEMENT.
20. WATER MAINS AND APPURTENANCES SHALL BE DISINFECTED IN ACCORDANCE WITH AWWA STANDARDS FOR DISINFECTING WATER MAINS, C-651-92, WITH THE EXCEPTION OF SECTION 5.1, TABLET METHOD. FINAL FLUSHING OF THE HEAVILY CHLORINATED WATER GENERATED FROM WATER DISINFECTION PROCESS SHALL BE NEUTRALIZED AND DISPOSED OF IN ACCORDANCE WITH AWWA STANDARDS FOR DISINFECTING WATER MAINS, C-651-99.
21. WATER MAINS SHALL BE PRESSURE AND LEAKAGE TESTED IN ACCORDANCE WITH SECTION 4 OF THE AWWA C-600 LATEST EDITION.
22. ALL DISTURBANCE LIMITS AND SETBACKS SHALL BE STAKED OR FLAGGED IN THE FIELD PRIOR TO BEGINNING GRADING AND CLEARING ACTIVITIES.
23. CONTRACTOR TO VERIFY SIZE, TYPE AND DEPTH OF EXISTING WATER MAINS PRIOR TO CONNECTION AND VERIFY COMPATIBILITY OF TAPPING SLEEVE AND VALVES WITH THE DESIGN ENGINEER AND THE PRODUCT MANUFACTURER.
24. STREET LIGHTS SHALL BE SPECIFIED, OWNED, OPERATED AND MAINTAINED BY THE HOME OWNERS ASSOCIATION.
25. STREET NAME SIGNAGE SHALL BE DEVELOPMENT-THEMED AND OWNED AND MAINTAINED BY HOME OWNERS ASSOCIATION. TRAFFIC CONTROL SIGNAGE SHALL BE IN ACCORDANCE WITH M.U.T.C.D.
26. ROOF LEADERS SHALL BE CONNECTED TO THE STORMWATER SYSTEM. FOOTING DRAINS TO BE DAYLIGHTED TO THE GREATEST EXTENT POSSIBLE.

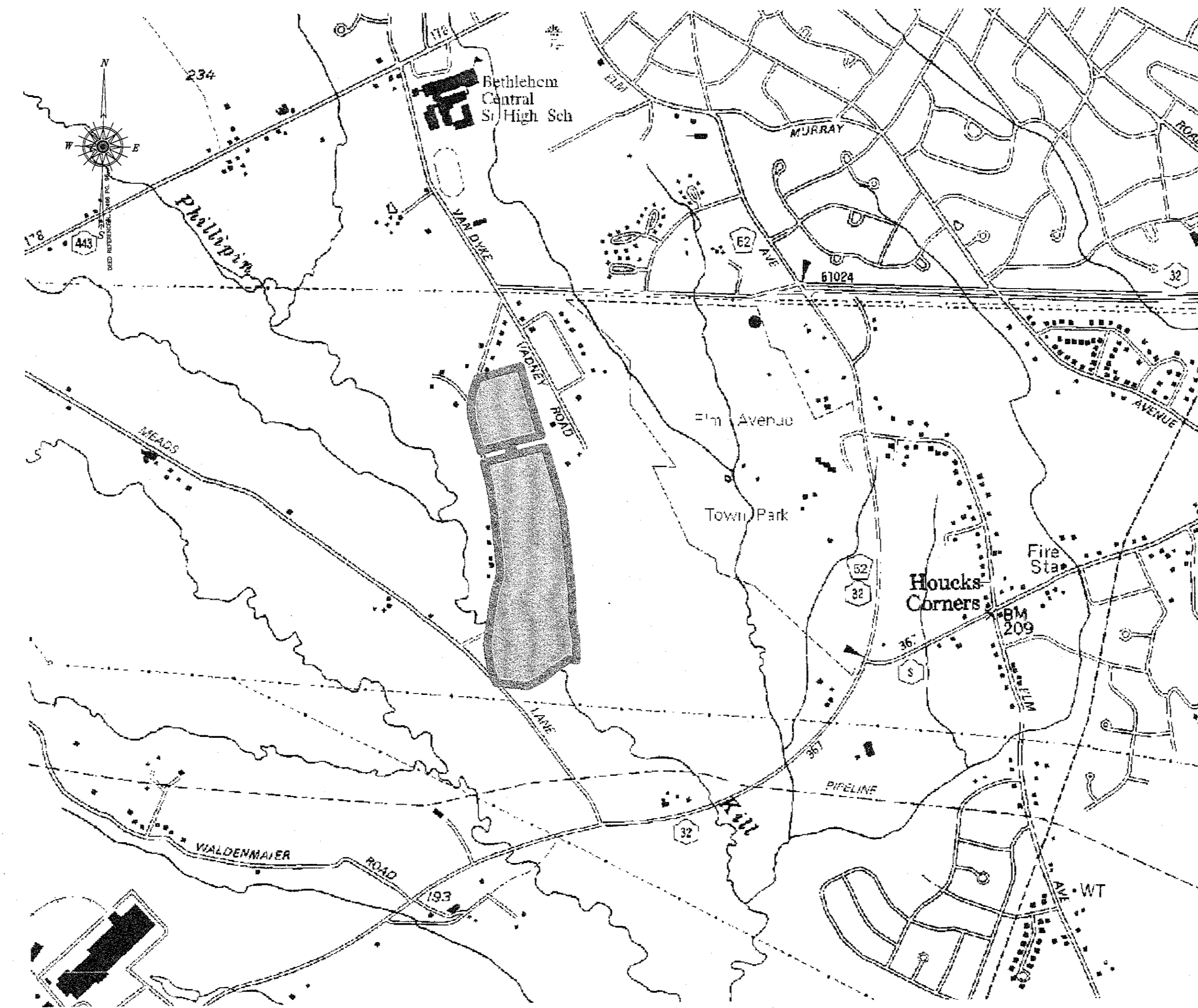

SITE LOCATION MAP
APPROX. SCALE: 1" = 1,000'

SHEET NUMBER	SHEET DESIGNATION	SHEET DESCRIPTION
1	CV-1	COVER SHEET
2	EX-1	EXISTING CONDITIONS PLAN
3	EX-2	EXISTING CONDITIONS PLAN
4	I-1	INDEX SHEET
5	LMG-1	LAYOUT, MATERIALS & GRADING PLAN
6	LMG-2	LAYOUT, MATERIALS & GRADING PLAN
7	PP-1	PLAN & PROFILE
8	OPP-1	CONSTRUCTION PHASING PLAN
9	EC-1	EROSION AND SEDIMENT CONTROL PLAN - PHASE 1
10	EC-2	EROSION AND SEDIMENT CONTROL PLAN - PHASE 2
11	EC-3	EROSION AND SEDIMENT CONTROL PLAN - PHASE 3
12	EC-4	EROSION AND SEDIMENT CONTROL PLAN - PHASE 4
13	EC-5	EROSION AND SEDIMENT CONTROL PLAN - PHASE 5
14	SWM-1	STORMWATER MANAGEMENT - BASIN K
15	SWM-2	STORMWATER MANAGEMENT - BASINS D, G, H, I, & J
16	SWM-3	STORMWATER MANAGEMENT - BASINS D, G, H, I, & J
17	SWM-4	STORMWATER MANAGEMENT - BASIN F
18	SWM-4	STORMWATER MANAGEMENT - BASINS A & B
19	DT-1	CONSTRUCTION DETAILS
20	DT-2	TEMP. EROSION AND SEDIMENT CONTROL DETAILS
21	DT-3	TEMP. EROSION AND SEDIMENT CONTROL DETAILS
22	DT-4	TOWN OF BETHLEHEM STANDARD DETAILS
23	DT-5	TOWN OF BETHLEHEM STANDARD DETAILS
24	DT-6	TOWN OF BETHLEHEM STANDARD DETAILS
25	DT-7	RESERVED
26	OS-1	CONCEPTUAL OFFSITE IMPROVEMENTS
27	OS-2	CONCEPTUAL OFFSITE IMPROVEMENTS

INDEX OF DRAWINGS - PHASE I

NEW YORK STATE DEPARTMENT OF ENVIRONMENTAL CONSERVATION	NEW YORK STATE DEPARTMENT OF HEALTH	TOWN OF BETHLEHEM PLANNING BOARD OWN OF BETHLEHEM ALBANY COUNTY, NEW YORK This Site Plan Approved. Title _____ Date _____	ALBANY COUNTY HEALTH DEPARTMENT
---	-------------------------------------	--	---------------------------------

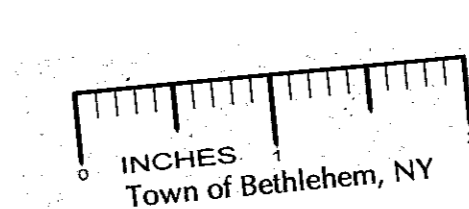

ALBANY COUNTY DEPARTMENT OF HEALTH
DIVISION OF ENVIRONMENTAL HEALTH SERVICE
By direction of the Commissioner of Health, these plans are hereby approved. See these plans for size and signature.

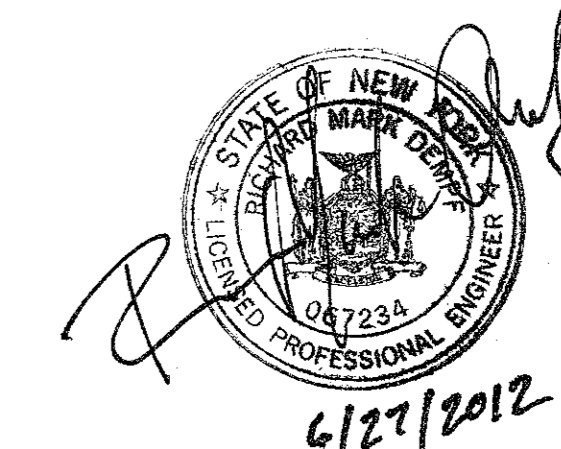

Stantec Consulting Services, Inc.
3 Columbia Circle, Suite 6
Albany, NY U.S.A. 12203
Tel: 518.452.4358 Fax: 518.452.9234

R. MARK DEMPFF
PROFESSIONAL ENGINEER
N.Y.S. LIC. NO. 067234

DATE