

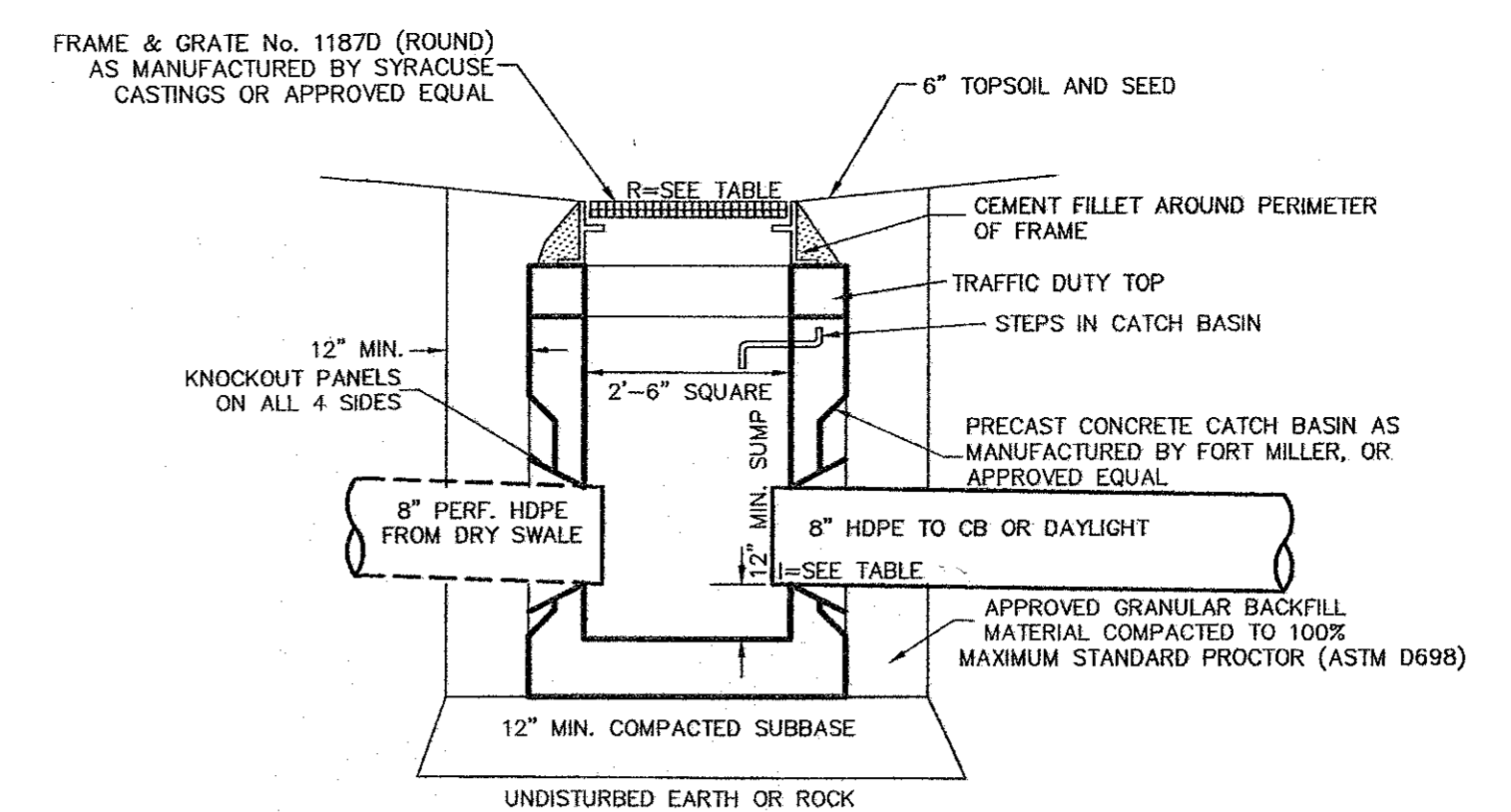

DRY SWALE PLAN (PRIVATELY OWNED)
SCALE: 1"=60'



DESCRIPTION (OCS#)	RIM	INVERT
1	203.5	200.0
2	216.0	213.0
3	200.0	198.0
4	200.0	198.0

ORIFICE CONTROL STRUCTURE (OCS) DETAIL
NOT TO SCALE

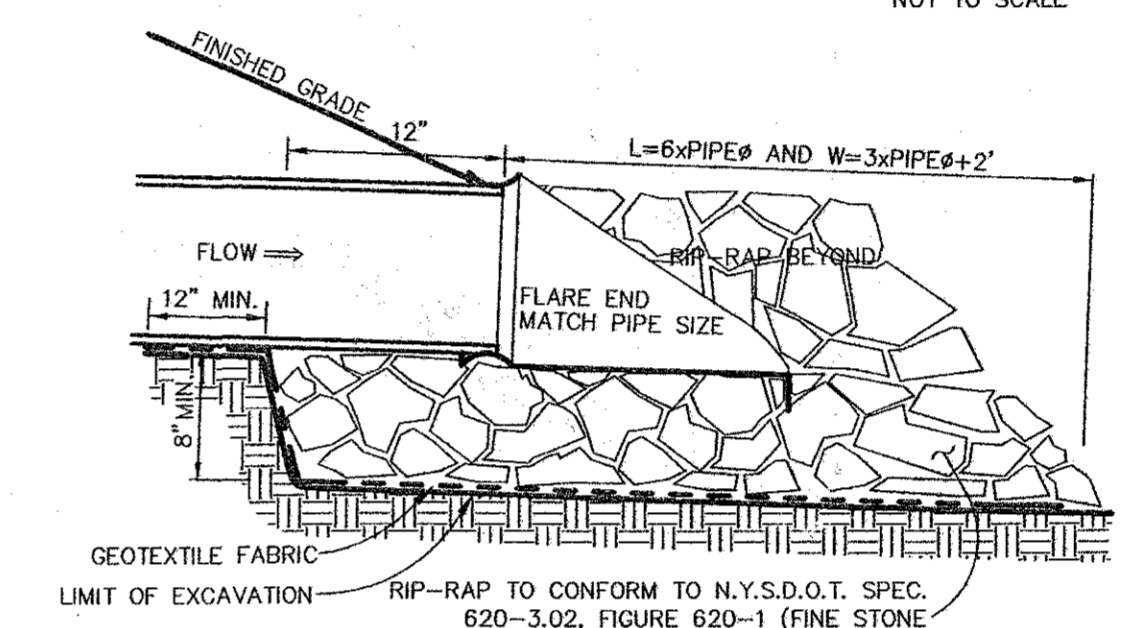

FLARE END SECTION DETAIL
NOT TO SCALE

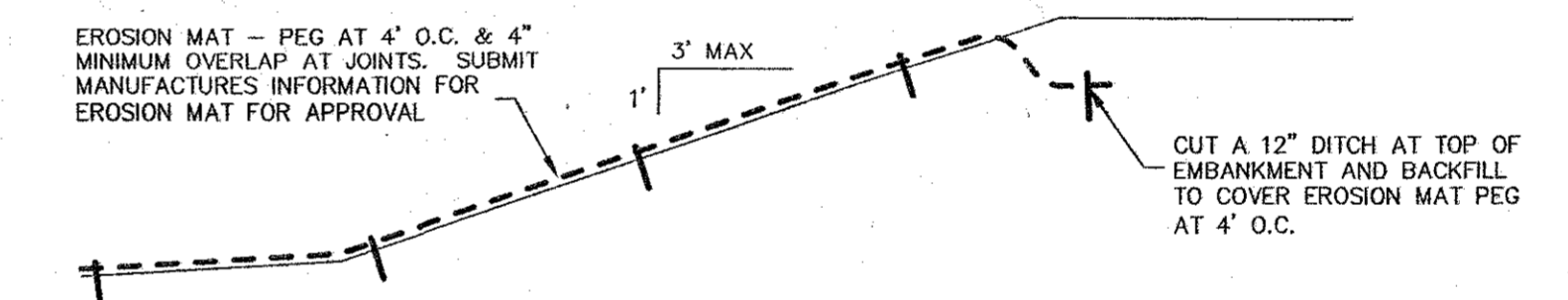

STABILIZED SLOPE DETAIL
NOT TO SCALE

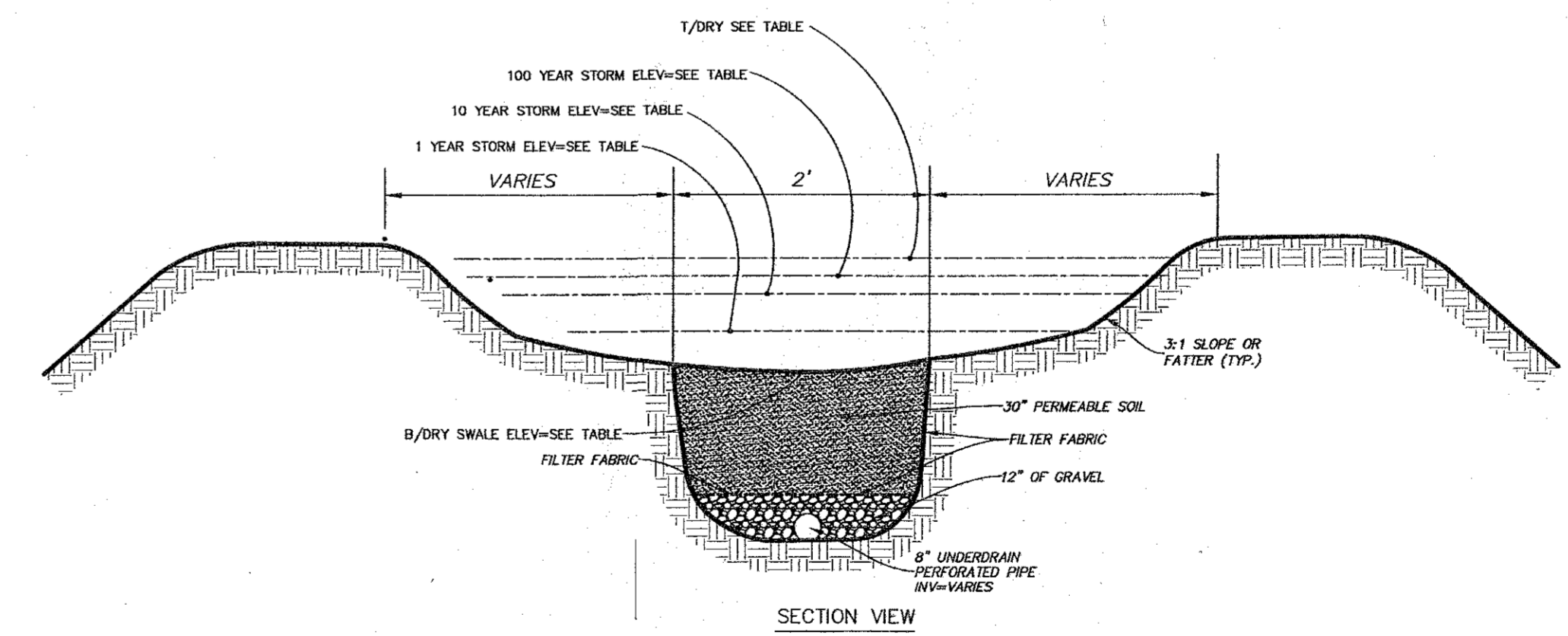

DRYSWALE #	BOTTOM	1 YR	10 YR	100 YR
1	203.5	203.98	204.66	204.93
2	216.0	216.08	216.24	216.38
3	203.5	203.66	203.98	204.28
4	200.0	200.16	201.10	201.63

DRY SWALE (DS) SECTION DETAIL
NOT TO SCALE

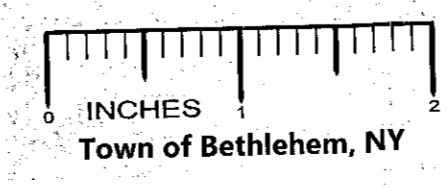

FOR MUNICIPAL APPROVAL ONLY-NOT INTENDED FOR CONSTRUCTION

HERSHBERG & HERSHBERG
Consulting Engineers and Land Surveyors
18 Locust Street
Albany, New York 12203

ALTERATION OF THIS DOCUMENT EXCEPT BY A LICENSED PROFESSIONAL ENGINEER OR LAND SURVEYOR, IS ILLEGAL.

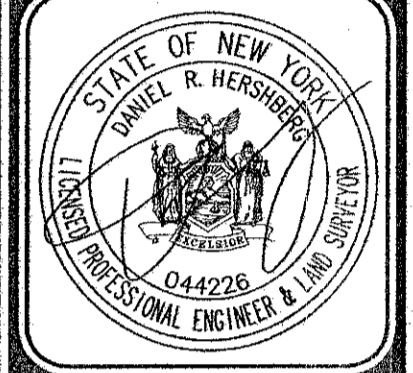

DATE	REVISIONS
11/15/13 <td>TOWN COMMENT LETTER #1</td>	TOWN COMMENT LETTER #1
11/28/13 <td>TOWN REVIEW COMMENTS</td>	TOWN REVIEW COMMENTS

PROPOSED STORMWATER POLLUTION PREVENTION PLAN
BLESSINGS CORNER
No. 572 RUSSELL ROAD
TOWN OF BETHELEM, ALBANY COUNTY, NEW YORK

APPLICANT: MARINI LAND 1, INC.
TOWN OF BETHELEM PLANNING BOARD APPROVAL

Town of Bethlehem Planning Board
By direction of the Chairman
these plans are hereby Approved.
See first sheet for date & signature.