

BREWER ENGINEERING ASSOCIATES, P.C.

WATER SERVICE CONNECTIONS:  
WATER SERVICE LATERALS ARE TO BE INSTALLED TO SERVE EACH LAND PARCEL HAVING FRONTAGE ON VAN DYKE ROAD (OCCUPIED OR VACANT) AT THE TIME OF INSTALLATION OF THE WATER MAIN TO BE INSTALLED ON VAN DYKE ROAD. THE LATERAL TO BE INSTALLED WILL RUN FROM THE WATER MAIN TO BE INSTALLED ON VAN DYKE ROAD TO THE LAND PARCELS PROPERTY LINE FRONT ON VAN DYKE ROAD. A CURB BOX WILL BE INSTALLED AT THE LAND PARCELS PROPERTY LINE AND WILL BE THE RESPONSIBILITY OF THE PROPERTY OWNER TO EXTEND THE WATER SERVICE LINE FROM THE CURB BOX.

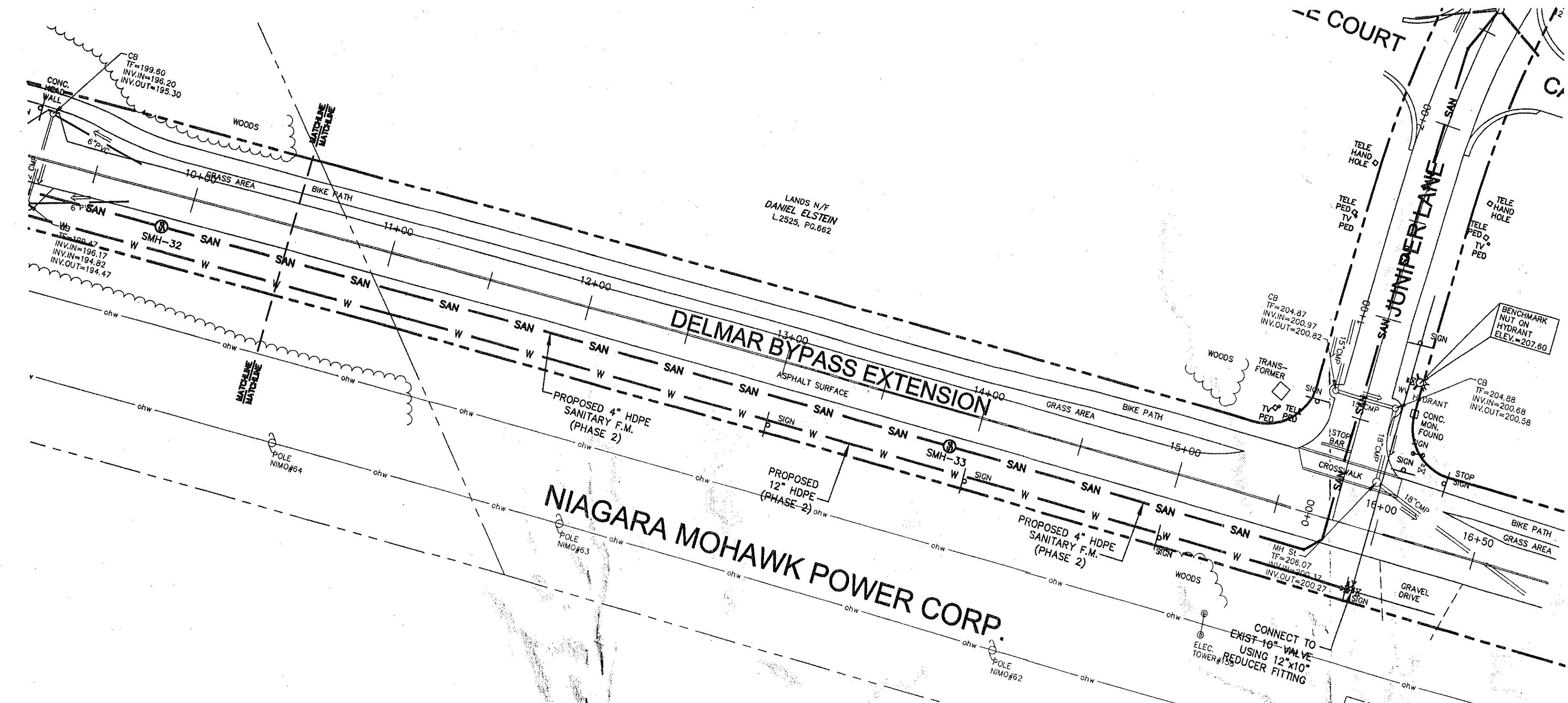

**PLAN OF DELMAR BYPASS  
(STA 10+00 THRU 16+50)**  
SCALE: (SCALE: 1"=40')

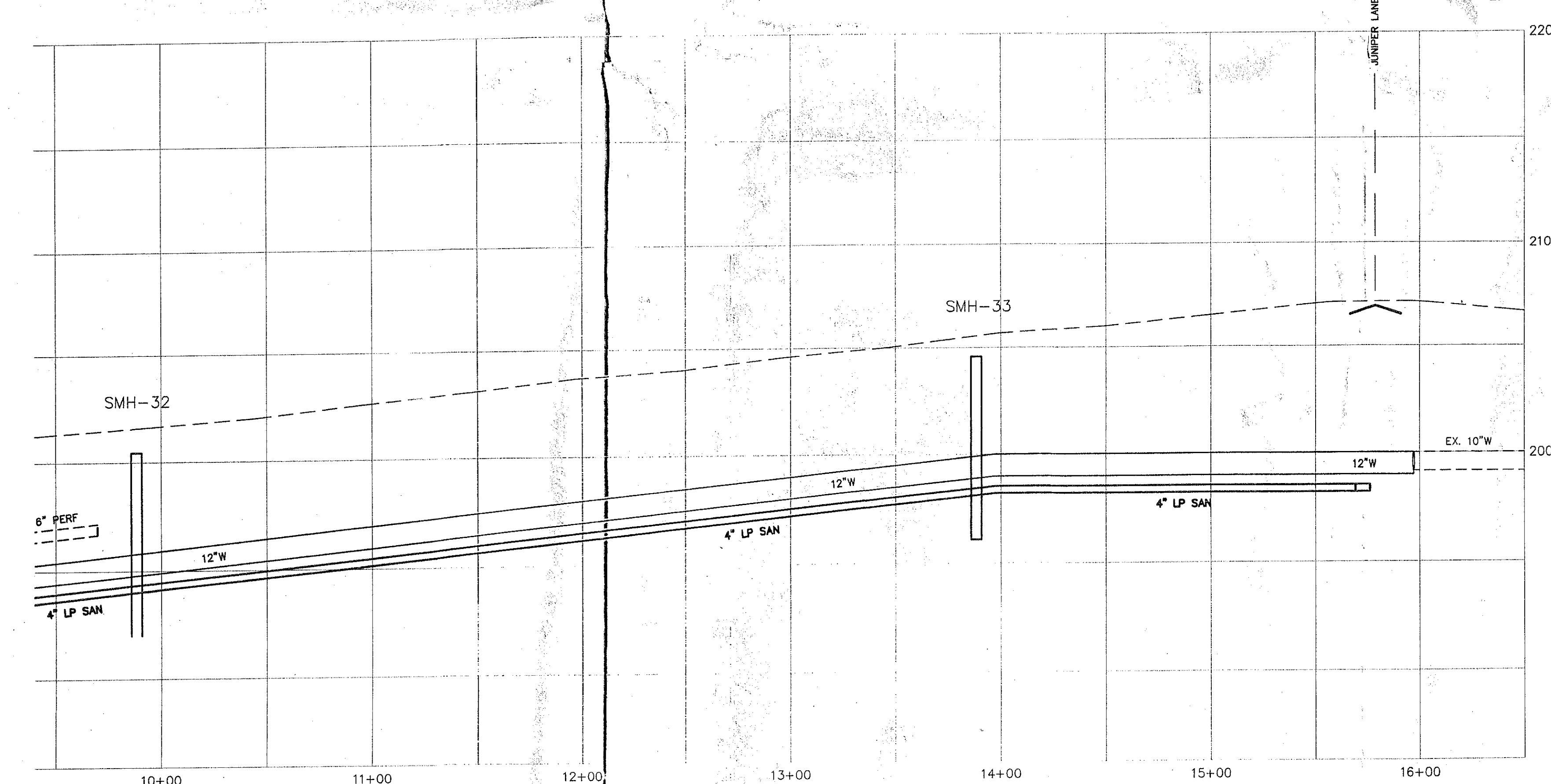

**PROFILE OF DELMAR BYPASS  
(STA 10+00 THRU 16+50)**  
SCALE: (HORIZ: 1"=40'; VERT: 1"=4')

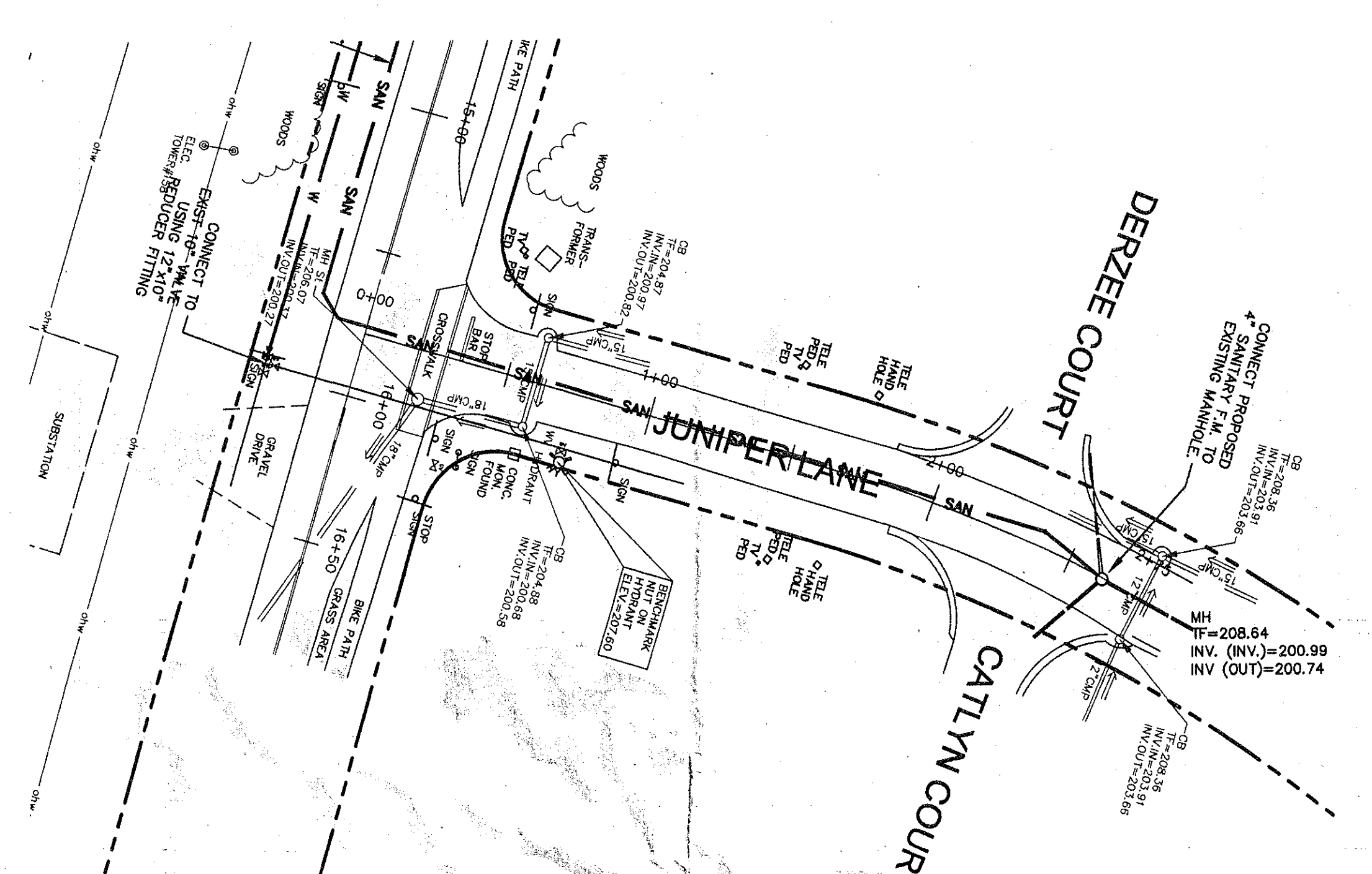
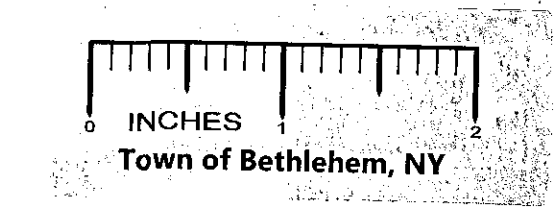

**PLAN OF JUNIPER LANE  
(STA 0+00 THRU 3+00)**  
SCALE: (SCALE: 1"=40')

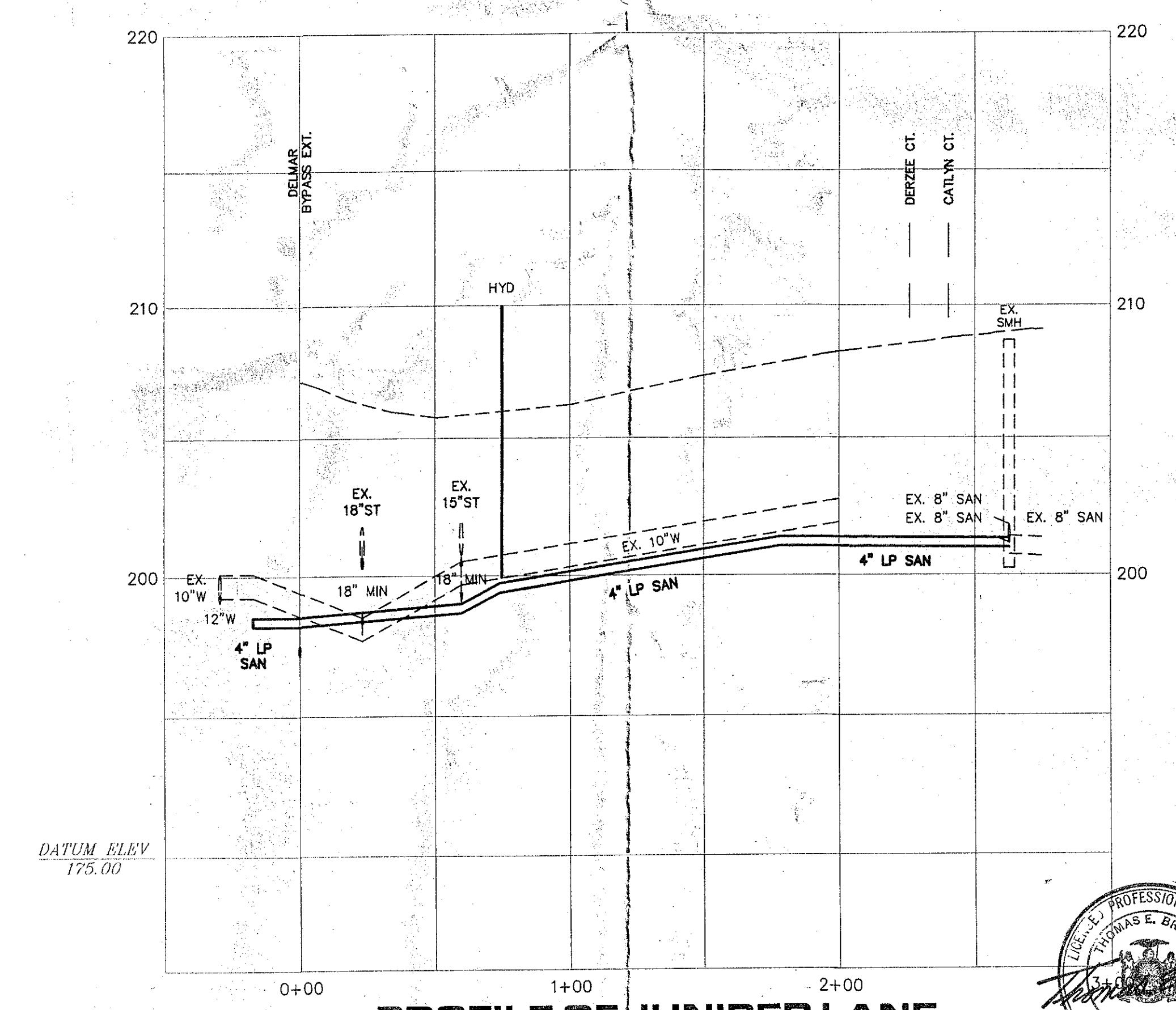

**PROFILE OF JUNIPER LANE  
(STA 0+00 THRU 3+00)**  
SCALE: (HORIZ: 1"=40'; VERT: 1"=4')



PLANNING BOARD  
TOWN OF BETHLEHEM  
ALBANY COUNTY, NEW YORK  
By direction of the Chairman,  
These drawings are hereby approved.  
See sheet(s) 23  
for date and signature.

ALBANY COUNTY HEALTH DEPARTMENT  
  
ALBANY COUNTY DEPARTMENT OF HEALTH  
DIVISION OF ENVIRONMENTAL HEALTH SERVICES  
By direction of the Commissioner of Health, these  
plans are hereby approved. See sheet 23 for  
date and signature.

TOWN OF BETHLEHEM

**BREWER ENGINEERING  
ASSOCIATES, P.C.**  
CONSULTING ENGINEERS • PLANNERS  
743 COLUMBIA TURNPIKE, EAST GREENBUSH, NEW YORK 12061  
PHONE: 518.477.5253 FAX: 518.477.5233

REVISION			
DATE	REVISION	DATE	REVISION
02/07/14	Checked by: TDS	02/15/14	Checked by: TDS
02/07/14	Drawn by: TDS	02/15/14	Drawn by: TDS
02/07/14	Designed by: TDS	02/15/14	Designed by: TDS
02/07/14	Connections	02/15/14	Connections

**VAN DYKE SPINNEY  
PHASE 2**  
TOWN OF BETHLEHEM COUNTY OF ALBANY  
STATE OF NEW YORK

DRAWING NUMBER:  
**7**  
**23**  
JOB NO: 11-03