

1. CONNECTION TO EXISTING UTILITIES AND INCOMING POWER AND TELEPHONE SERVICES IS FOR CONCEPT ONLY. THE CONTRACTOR SHALL COORDINATE THE ACTUAL LOCATION WITH THE ELECTRIC AND TELEPHONE UTILITIES AND CARRIER.
2. THE CONTRACTOR IS RESPONSIBLE FOR MAKING ARRANGEMENTS WITH THE ELECTRIC AND TELEPHONE UTILITIES TO ENSURE TO A TIMELY INSTALLATION OF THE INCOMING POWER AND TELEPHONE SERVICES. THE CARRIER WILL OBTAIN AN ELECTRIC SERVICE ORDER (ESO) FOR THIS SITE PRIOR TO THE CONTRACTOR INITIATING ANY WORK ON-SITE.
3. THE INCOMING ELECTRIC SERVICE SHALL BE INSPECTED BY THE AUTHORITY HAVING JURISDICTION AND A CERTIFICATE OF SUCH INSPECTION SHALL BE FURNISHED TO THE CARRIER WITH A COPY FORWARDED TO THAT UTILITY.
4. ANY UTILITY CHARGES ASSOCIATED WITH THIS SITE SHALL BE PAID BY THE CARRIER AND NO CHARGES, THEREFORE SHALL ACCRUE TO THE CONTRACTOR.
5. COORDINATE METER SOCKET REQUIREMENTS AND UTILITY METER ENCLOSURE WITH CARRIER. AND ELECTRIC UTILITY.
6. INCOMING ELECTRIC SERVICES SHALL BE IN CONFORMANCE WITH THE UTILITIES STANDARDS (LATEST EDITION).
7. INSTALL PULL ROPES IN ALL CONDUITS UNLESS NOTED OTHERWISE.
8. CONDUIT RUNS SHALL HAVE ONE 18"x18"x8" TRAFFIC RATED PULLBOX AFTER 270 DEGREES OF BEND.
9. CONDUIT RUNS SHALL HAVE A PULLBOX WITH A MAXIMUM SPACING OF 500 LINEAR FEET

1. COORDINATE EXACT LOCATION WITH UTILITY COMPANY. STUB UP POWER AND TELEPHONE CONDUITS AS DIRECTED BY UTILITY COMPANY. REFER TO EQUIPMENT SPECIFICATIONS FOR ELECTRICAL REQUIREMENTS.
2. 4" SCH 40 PVC POWER CONDUIT WITH PULLWIRE FROM PROPOSED EQUIPMENT AREA TO EXISTING POWER SOURCE. EXACT ROUTING TO BE COORDINATED WITH UTILITY COMPANY AND CONTRACTOR TO FIELD COORDINATE CONDUIT STUB-UP LOCATION. STUB-UP 6" ABOVE GRADE AT EXISTING POWER SOURCE & EQUIPMENT AREA.
3. 4" SCH 40 PVC TELCO CONDUITS WITH PULL STRINGS (25 PAIRS), CAT 5 RATED, ROUTED FROM PROPOSED EQUIPMENT AREA TO EXISTING TELCO SOURCE. EXACT ROUTING AND STUB-UP LOCATION TO BE FIELD COORDINATED WITH UTILITY COMPANY. STUB-UP 6" ABOVE GRADE AT TELCO DEMARC & EQUIPMENT AREA.
4. ALL TELCO CONDUITS SHALL USE LONG SWEEPS AT BENDS.
5. PROPOSED MESA SPAN CABINET. PROVIDED BY TELCO COMPANY
6. PROPOSED TRANSFORMER. CONFIRM SIZE AND RATING WITH UTILITY COMPANY PRIOR TO INSTALLING

AWG	AMERICAN WIRE GAUGE
BFG	BELOW FINISH GRADE
BTS	BARE TINNED STRANDED
C	CONDUIT
CAB	CABINET
DLO	DIESEL LOCOMOTIVE CABLE
DWG	DRAWING
EGR	EXTERIOR GROUND RING
EIGB	EXTERIOR ISOLATED GROUND BAR
G	GROUND
HALO	INTERIOR GROUND RING
MIGB	MAIN ISOLATED GROUND BAR
MGN	MULTI-GROUNDED NEUTRAL
MSC	MOBILE SWITCHING CENTER
MTSO	MOBILE TELEPHONE SWITCHING OFFICE
PVC	POLYVINYL CHLORIDE
RGS	RIGID GALVANIZED STEEL
SS	STAINLESS STEEL
SST	SELF SUPPORTING TOWER
TGR	TOWER GROUND RING
TYP.	TYPICAL

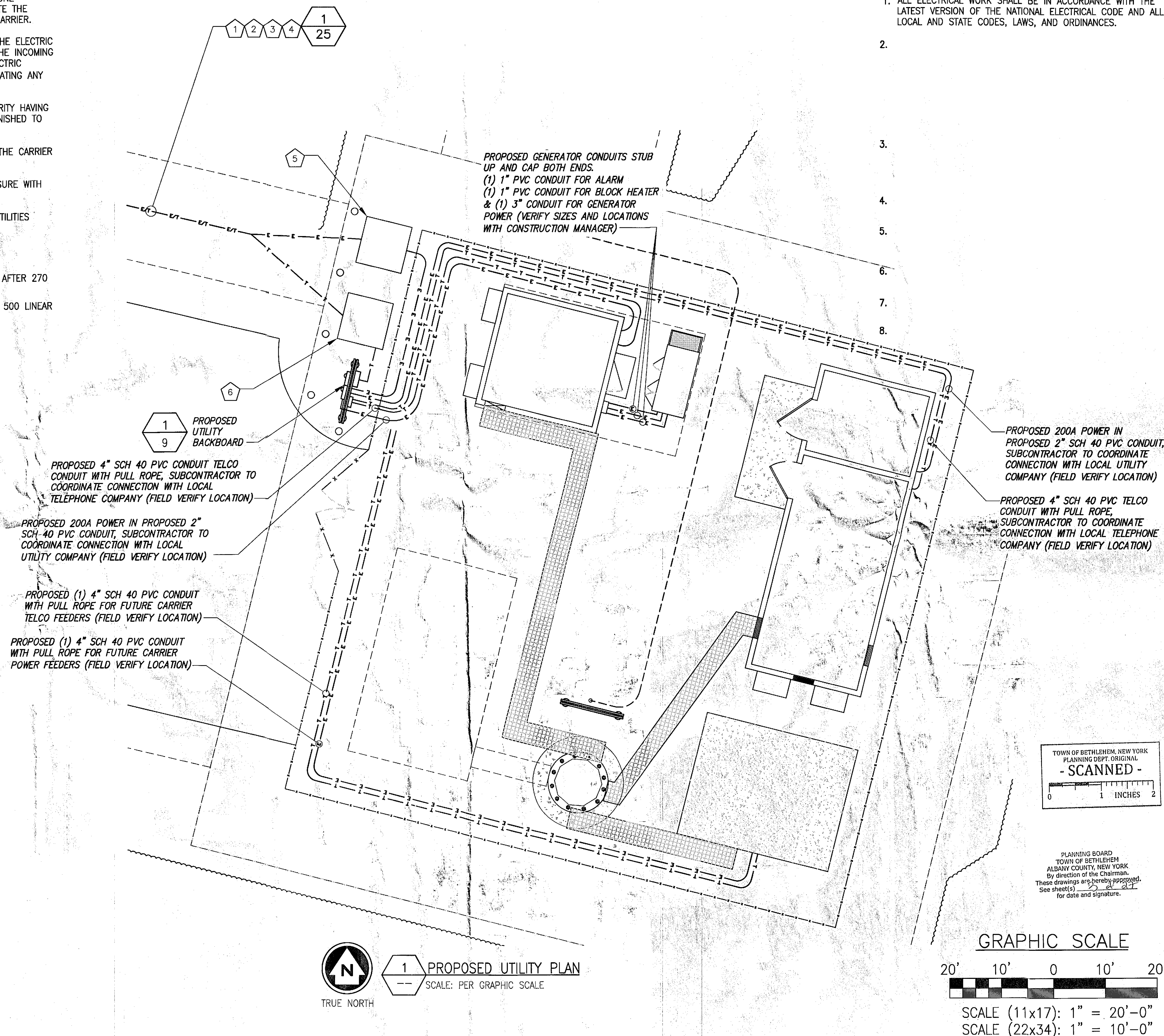

1. ALL ELECTRICAL WORK SHALL BE IN ACCORDANCE WITH THE LATEST VERSION OF THE NATIONAL ELECTRICAL CODE AND ALL LOCAL AND STATE CODES, LAWS, AND ORDINANCES.
- 2.

**INFINIGY**  **Design.  
Build.  
Deliver.**

1033 Watervliet Shaker Rd  
Albany, NY 12205  
Office # (518) 690-0790  
Fax # (518) 690-0793



1	REVISED PER COMMENTS	SKB	6/30/
0	ISSUED FOR BP	SKB	4/22/
No.	Submittal / Revision	App'd	Date

Drawn: SKB Date: 4/22/15  
Designed: AJD Date: 4/22/15  
Checked: AJD Date: 4/22/15

Project Number 168-117

Project Title

CELL TOWER

457 NYS ROUTE 85  
SLINGERLANDS, NY 12159

Prepared For

Phoenix Towers LLC

110 WASHINGTON AVE  
NORTH HAVEN, CT 0647  
C: 203-623-3287

Drawing Title

## UTILITY SITE PLAN

Drawing Scale:	
----------------	--

Date: 6/30/15

UNAUTHORIZED ALTERATION OR ADDITION  
TO THIS DOCUMENT IS A VIOLATION OF  
APPLICABLE STATE AND/OR LOCAL LAW

Sheet Number:

24 OF 27