

NOTE: SEWER LINES ARE TO BE INSTALLED UNDER THE SUPERVISION OF A NEW YORK STATE LICENSED PROFESSIONAL ENGINEER. ENGINEER SHALL SUBMIT A CERTIFICATE STATING THAT THE CONSTRUCTED FACILITIES HAVE BEEN CONSTRUCTED IN ACCORDANCE WITH THE APPROVED PLANS. CERTIFICATION MUST BE RECEIVED BY THE ALBANY COUNTY HEALTH DEPARTMENT WITHIN SIXTY (60) DAYS FROM THE COMPLETION OF CONSTRUCTION.

NOTE: WATER QUALITY-TYPE PIPE MATERIAL (D.I.P. OR PVC SDR 26) MUST BE UTILIZED FOR SANITARY AND STORM SEWERS IN AREAS WHERE A TEN FOOT HORIZONTAL OR 18" VERTICAL SEPARATION DISTANCE FROM WATER MAINS CANNOT BE MAINTAINED.

NOTE: ALL WATER MAINS ARE TO BE INSTALLED, DISINFECTED, AND TESTED IN ACCORDANCE WITH AWWA STANDARD C601 OR OTHER METHOD ACCEPTABLE TO THE ALBANY COUNTY HEALTH DEPARTMENT.

NOTES

ALL CONSTRUCTION DISTURBANCES ON STATE OR PRIVATE LAND TO BE RESTORED BY CONTRACTOR

GRADE OF GRAVITY SEWERS ARE CALCULATED BY THE FOLLOWING CRITERIA:

1. LENGTH OF PIPE RUN IS FROM CENTERLINE OF RESPECTIVE MANHOLES.
2. PERCENT GRADE IS CALCULATED FROM CENTERLINE TO CENTERLINE OF RESPECTIVE MANHOLES.

ALL CONSTRUCTION DISTURBANCES ON STATE OR PRIVATE LAND TO BE RESTORED BY CONTRACTOR

UNAUTHORIZED ALTERATIONS OR ADDITIONS TO THIS DOCUMENT IS A VIOLATION OF SECTION 1708 SUBDIVISION 2 OF THE NEW YORK STATE EDUCATION LAW

REVISIONS			
DATE	BY	DESCRIPTION	SYMBOL
12/89	JB	UTILITIES EDITED PER FINAL GRADING	
3/12/90	JB	FINAL REVISIONS	NONE
4/19/90	JB	DCH EDITS	NONE
2-11-93	JB	Revisions per Town of Bethlehem Engineering Department review	

J. KENNETH FRASER AND ASSOCIATES, P.C.
CONSULTING ENGINEERS
RENSSELAER, NEW YORK

LANDS FORMERLY OF
R & R ASSOCIATES
NOW
THE MEADOWS AT BETHLEHEM, A NEW YORK PARTNERSHIP AND YORK LAND DEVELOPMENT CORPORATION
THE MEADOWS SUBDIVISION

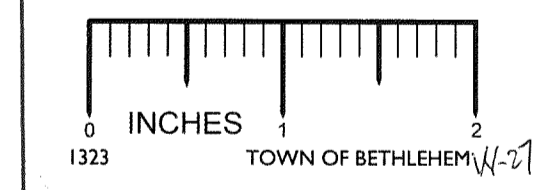

TOWN OF BETHLEHEM
NEW YORK
RECEIVED
FEB 12 1993

SCALE: AS NOTED

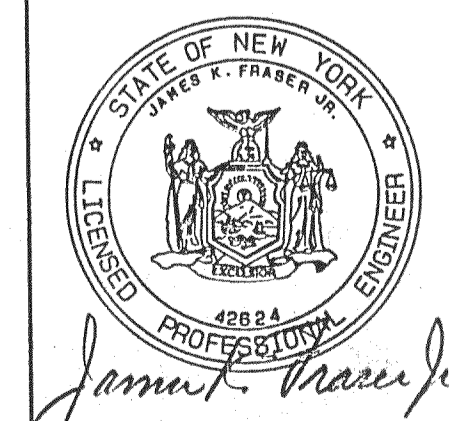

PROJ. ENG'R: JFB
DRAWN BY: HLW
ASSEMBLED BY: EJS
CHECKED BY: JKJ

REF. NO. 238645.019

SHEET TITLE: **PROFILES- STORM SEWER OUTFALLS**

DATE: JANUARY 1987 SHEET 19 OF 26

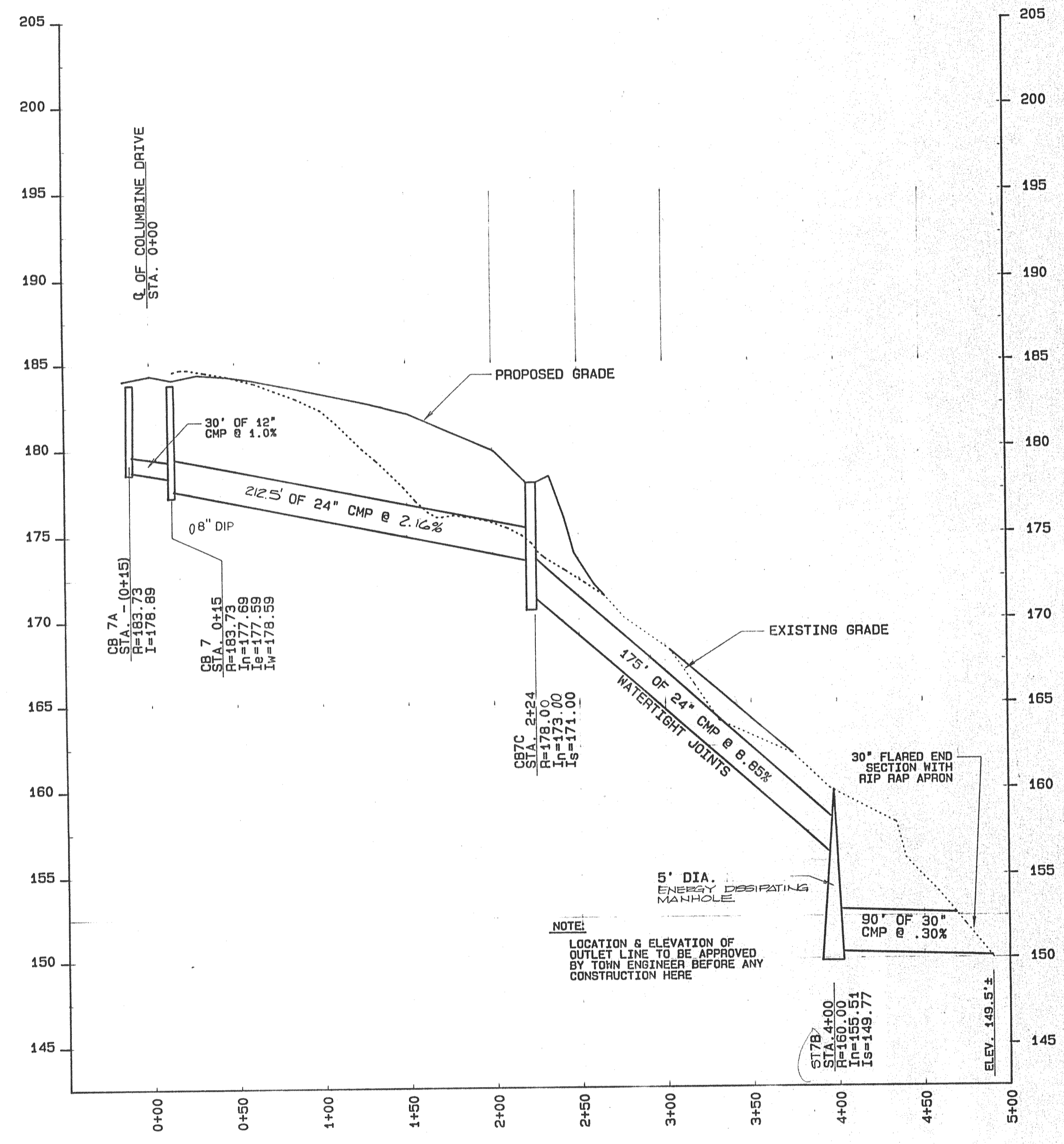

STORM SEWER OUTFALL
COLUMBINE DRIVE (STA. 14+00)

SCALE: HORIZ. 1" = 50'
VERT. 1" = 5'

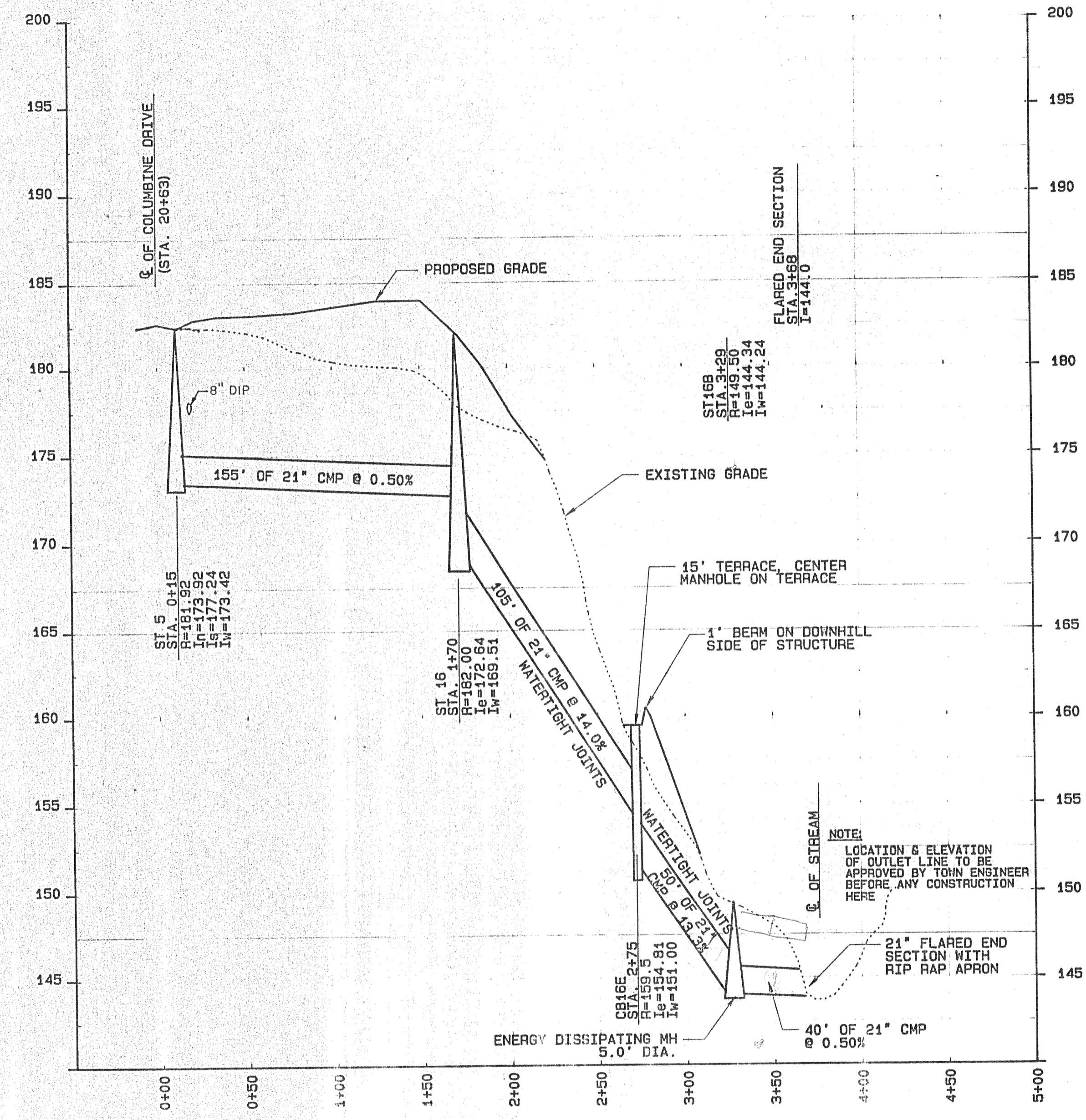

STORM SEWER OUTFALL
COLUMBINE DRIVE (STA. 20+69)

SCALE: HORIZ. 1" = 50'
VERT. 1" = 5'