

REVISIONS		
NO	DATE	DESCRIPTION
1	12-15-88	PER ENGINEERING DEPT.
2	2-11-89	PER TOWN OF BETHLEHEM ENGINEERING DEPT.

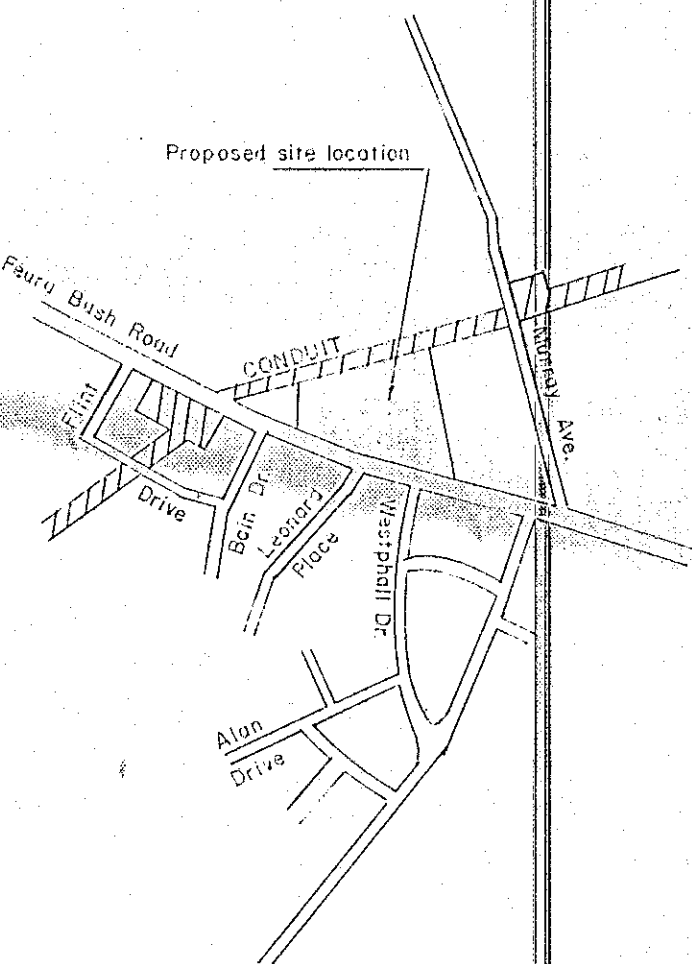

Vicinity Sketch

Scale 1" = 1,000'



General Notes

- 1) ALL LOW PRESSURE SEWER SERVICE CONNECTIONS TO PROPOSED FORCE MAIN TO MEET OR EXCEED ALL REGULATIONS SET BY NEW YORK STATE & ALBANY COUNTY HEALTH DEPARTMENTS AND THE TOWN OF BETHLEHEM.
- 2) ALL HIGHWAY EASEMENTS SHALL HAVE DETAILED PLANS APPROVED BY THE NEW YORK STATE DEPARTMENT OF TRANSPORTATION.
- 3) ALL LOW PRESSURE SEWER TO BE INSTALLED BELOW FROST LINE (30' BELOW EXISTING GRADE).
- 4) WHENEVER SEWERS MUST CROSS UNDER WATERMANS, THE SEWER SHALL BE LAID AT SUCH AN ELEVATION THAT THE TOP OF THE SEWER IS AT LEAST 18" BENEATH THE BOTTOM OF THE WATERMAIN. ONE FULL LENGTH OF WATERMAIN SHOULD BE CENTERED OVER THE SEWER SO THAT BOTH JOINTS WILL BE AS FAR FROM THE SEWER AS POSSIBLE.
- 5) PROPOSED FORCE MAIN DESIGN ON THE BASIS OF A COMPLETED SYSTEM.
- 6) LOT NUMBERS TO BE USED AS HOUSE OR STREET NUMBERS.
- 7) EXISTING GRADE SHOWN THIS, 1988 PROPOSED GRADE SHOWN THIS, 1988.
- 8) NO PRINCIPAL STRUCTURE SHALL BE PLACED WITHIN FIFTY FEET OF THE LANDS OF THE CITY OF ALBANY.
- 9) DRIVEWAY CURB CUTS TO BE SECURED BY OWNER AND/OR CONTRACTOR.
- 10) EACH WATER SERVICE IS TO HAVE A REMOTE METER PIT.
- 11) A LOCATOR WIRE SHALL BE INSTALLED WITH EACH PLASTIC DIRECT BURIAL MAIN TO INSURE BEING ABLE TO RELOCATE THE BURIED PIPING IN THE FUTURE. (Note: see town of Bethlehem engineering department for information on installation.)
- 12) INSTALLATION OF FORCE MAIN UNDER FEURA BUSH ROAD AND OVER TO AND INCLUDING CLEANOUT TO BE THE RESPONSIBILITY OF THE DEVELOPERS. ALSO THE INSERTION OF TEE AND CURB BOX FOR LOT NUMBER 745.

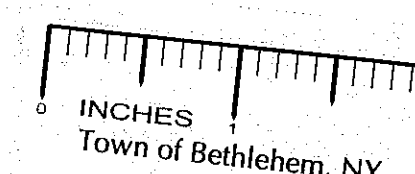

NOTE: MANHOLE FRAME AND COVER TO BE LETTERED:
"BETHLEHEM SEWER DISTRICT" (LEBANON FOUNDRY NO. 268-1)
(CAMPBELL FOUNDRY NO. 1009)

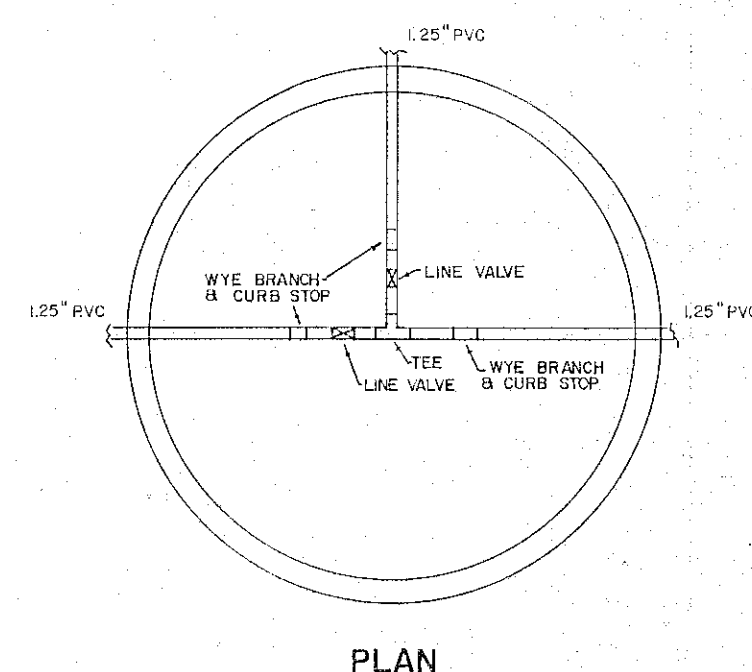
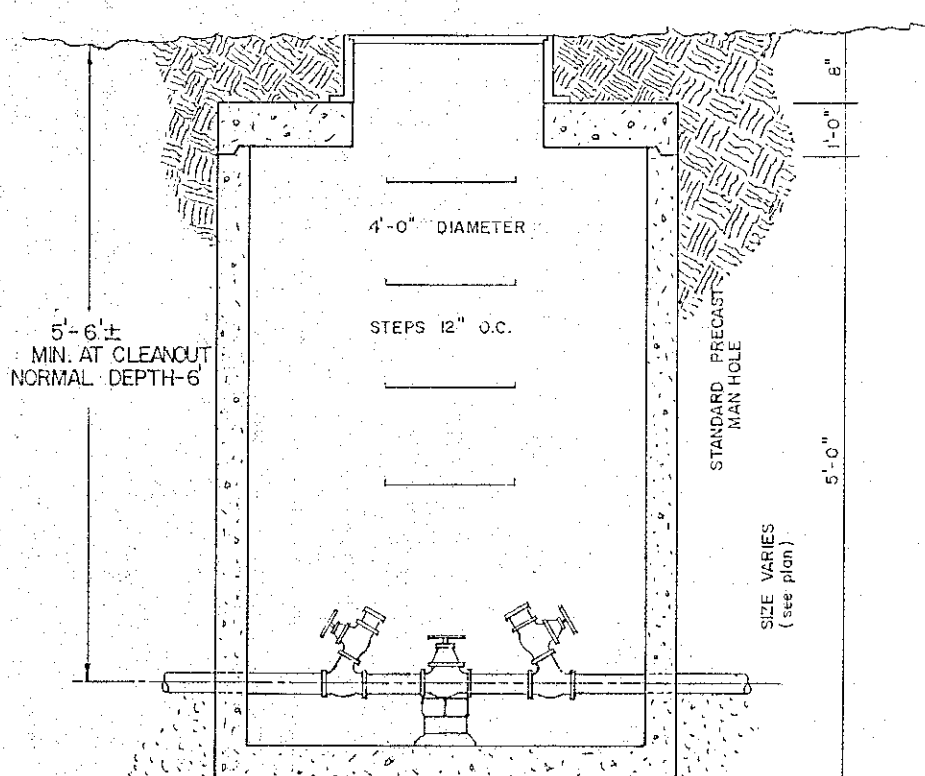

PLAN

PEA STONE UNDER
PIPE 2' FROM
MANHOLE
BRICK SUPPORT
AS REQUIRED
WYE BRANCH - SIZE Varies - 2" CURB STOP AND
TYPICAL LOW ADAPTERS AS REQUIRED FOR 8" &
10" LINE CLEANOUT. ELIMINATE WYE, CURB
VALVE AND REPLACE OTHER WYE WITH 45° ELBOW.
BRICK AND SUPPORT AS REQUIRED

CLEANOUT DETAIL TYPICAL

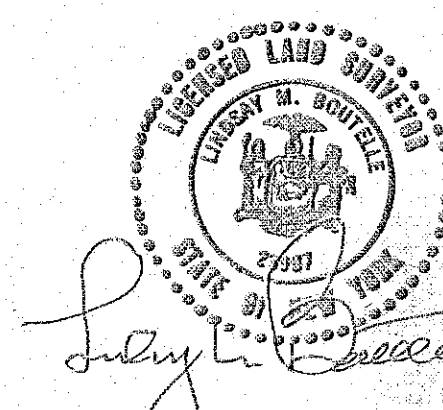

PLANNING BOARD APPROVAL
TOWN OF BETHLEHEM
ALBANY COUNTY, NEW YORK
FINAL PLAT APPROVAL
When signed by the duly authorized
officer of the Planning Board, this
endorsement constitutes final approval
of this Plat.
Signed *Kenneth B. Knicker*
Title CHAIRMAN
Date February 14, 1989
See also Certificate of Approval
of Final Plat No. 101-F

MAP OF PROPERTY OF TERRY L. TRUED & SUSAN H. BANE

TOWN OF BETHLEHEM ALBANY COUNTY
NEW YORK DATE FEB. 8, 1988
SCALE 1" = 50' REVISION NO. 2

SURVEY AND MAP BY
EDWARD W. BOUTELLE AND SON
CIVIL ENGINEERS
SURVEYORS
DELMAR
N. Y.