

- SUBDIVISION NOTES:**
1. Seepage pit for cellar drain to be installed.
 2. Albany County Health Department approval is required for the design of each on-site septic system on a lot-by-lot basis. The Town Building Department requires that approval prior to issuance of a building permit for each lot.
 3. Proposed subdivision is located in Light Industrial zone.
 4. Proposed subdivision is not located within a Town of Bethlehem Water District.
 5. Proposed subdivision is not located within a Town of Bethlehem Sewer District.
 6. Proposed subdivision is located in the Selkirk Fire District (FD 204).
 7. Proposed subdivision is located in the Bethlehem Central School District.
 8. Limits of lands to be conveyed to Town of Bethlehem for highway purposes. Parcel contains (0.168) acres of land, more or less.
 9. No proposed disturbance of the Delineated Federal Wetlands shown hereon.
 10. Prior to any work in the Town right-of-way, the contractor shall obtain a highway work permit from the Town Highway Department.
 11. Prior to any excavation, the contractor shall call UFPO two working days prior to the work to have underground utilities located in the field. Call 1-800-962-7962.
 12. Proposed lot to be served by private on-site well and septic system.
 13. Access to any building constructed on this lot will be per a driveway from Weisheit Road.
 14. Approximate location of possible future driveway (not to be constructed at this time). Permit will be required from Town Superintendent of Highways.

CERTIFICATION:
Survey shown is in accordance with the minimum standards of "CODE OF PRACTICE FOR LAND SURVEYS" as adopted by the New York State Association of Professional Land Surveyors.

NOTES:
1. Map prepared from an accurate field survey, maps & deeds of record.
2. Property lines shown hereon are as deeded, monumented & occupied.
3. All elevations shown are on USGS Elevation Base.

MAP REFERENCE:
"Map Showing Survey Of Portion Of Lands Of Doris Weisheit" dated December 28, 1993, by John R. Oddy, L.S. 49,230. (No record of map being filed in the Albany County Clerk's Office.)

LEGEND:
--- DENOTES PROPERTY LINE
--- DENOTES BUILDING RESTRICTION LINE PER TOWN ZONING
--- DENOTES LIMITS OF DELINEATED FEDERAL WETLAND
--- DENOTES CONTOUR LINES

- REVISIONS: JUNE 22, 1998**
1. Title
 2. Notes
 3. Final Dimensions of Lot and Area to be conveyed to Town
 4. Possible approximate location of a future driveway from Wemple Road shown
 5. Additional location of existing pavement in Wemple Road shown
 6. Existing well shown

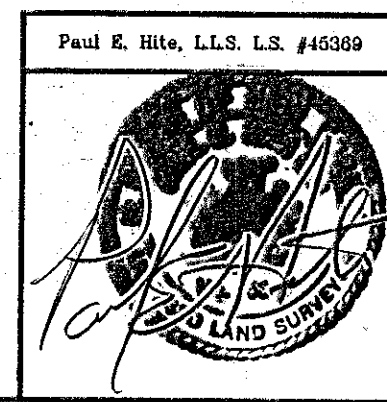

| | |
|-----------|------------------|
| COUNTY: | ALBANY |
| STATE: | NEW YORK |
| SCALE: | 1" = 50' |
| DATE: | FEBRUARY 2, 1998 |
| DRAWN BY: | JRW |
| MAP NO.: | M431 |

MAP PREPARED BY:
PAUL E. HITE
LICENSED LAND SURVEYOR
230 DELAWARE AVENUE
DELMAR, NEW YORK 12054
(518) 439-4989

TOWN OF BETHLEHEM PLANNING BOARD
TOWN OF BETHLEHEM
ALBANY COUNTY, NEW YORK
FINAL PLAT APPROVAL

WHEN SIGNED BY THE DULY AUTHORIZED OFFICER OF THE PLANNING BOARD, THIS ENDORSEMENT CONSTITUTES FINAL APPROVAL OF THIS PLAT

SIGNED: *Doris L. Weisheit*
TITLE: CHAIRMAN
DATE: JUL 07 1998

SEE ALSO CERTIFICATE OF APPROVAL OF FINAL PLAT NO. 198-F

MAP OF
PROPOSED (1) LOT SUBDIVISION
"LONGVIEW"
LANDS OF DORIS L. WEISHEIT
WEISHEIT ROAD & WEMPLE ROAD
TOWN OF BETHLEHEM