

WILLOW DRIVE - 50' ROW.
 # 135.00' S 09° 11' 40" E

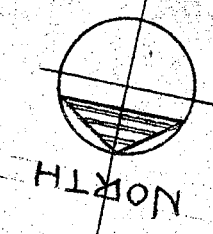
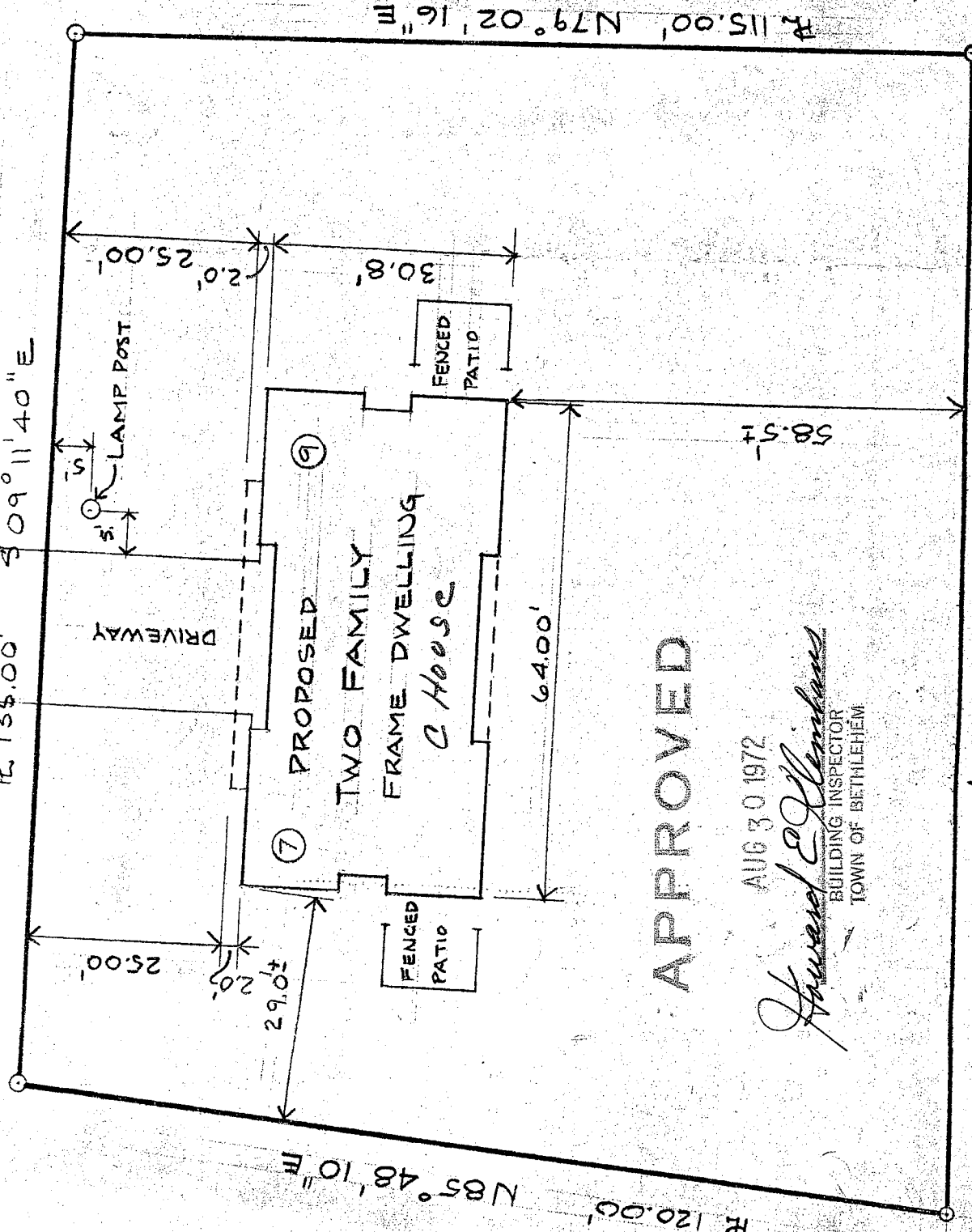

16,780#

APPROVED

AUG 30 1972

Howard E. Ellman
 BUILDING INSPECTOR
 TOWN OF BETHLEHEM

149.07' S 10° 57' 44" E

115.00' N 79° 02' 16" E

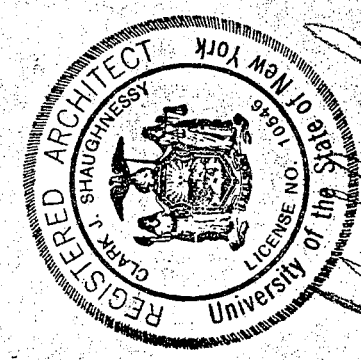

Clark J. Shaughnessy

TWO FAMILY FRAME DWELLING
 WOODGATE

PROPERTY LINE AND BASEMENT DATA
 TAKEN FROM MAP DATED AUG. 23, 1971
 AND DRAINAGE MAP DATED AUG. 23, 1971

AUGUST 23, 1972