

MURRAY

R = 1939.88'
Δ = 02°-25'-22"
L = 82.03'
Ch = 82.02'

13

PARCEL C
37 373 ± SQ. FT. ± 0.858 ± AC. 12

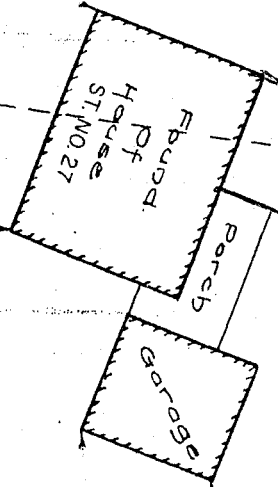

Old division line
Lyons Est. on east
Van Alden on west

PARTRIDGE

Total Length of Curve 205.83

R = 327.59'
Δ = 32°-29'-56"
L = 185.81'
Ch = 183.33'

R = 327.59'
Δ = 03°-30'-04"
L = 20.02'
Ch = 20.01'

11

PARCEL
21687 ± SQ. FT.

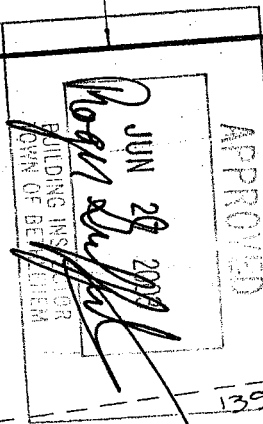

P

Δ = 36°-00'

