

MURRAY

R-1565.00  
 $\Delta 52^{\circ}36'25''$   
 L-71.21  
 CH-71.20

AVENUE

49.40

$89^{\circ}51'35''$

R-25.00  
 $\Delta 88^{\circ}11'54''$   
 L-38.48  
 CH-34.80  
 T-24.23'

9.91'

195'

R-275.00  
 $\Delta 39^{\circ}12'38''$   
 L-188.20

CHOP

184.65

LANDS OF KELLER

345.32'

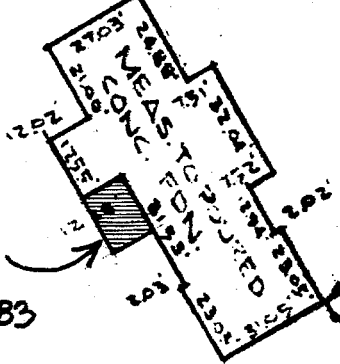

NEW 12'x16'±  
 ADDITION  
 PROPOSED 5-30-83

232.17

60'

$83^{\circ}00'09''$   
 $149^{\circ}48'35''$   
 37.95'

**APPROVED**

*Edward J. Remmel* 1983

BUILDING INSPECTOR  
 TOWN OF BETHLEHEM

LANDS OF  
 WELSH BUILDING CORPORATION

NOTE: SEE ATTACHED PLAN FOR CHOP

COUNTY	MAP OF PROPERTY OF KEVIN KLEIN DELMAR	SCALE
ALBANY		1" = 50'
STATE		DATE
NEW YORK		July 15, 1976
ORDER NO	EDWARD W BOUTELLE AND SON CIVIL ENGINEERS AND SURVEYORS DELMAR, NEW YORK	REVISION
76-60		AUG 11 1976 REV. LOCATED