

Lands of Micheal LaBate & Michelle N DePace, (2265/805)

Lands of Andrew J. & Mary L. Caplis (2284/528)

N-22°-23'-33"-W 66.49'

MR 3 (Sc)

PROPOSED

SPLIT RAIL FENCE

DRAINAGE

EASEMENT (MR 2)

SEE N.I.M.O. EASEMENT MAP G-3509E (1433/333)

AREA:  
9,284 ± S.F.  
0.21 ± Ac.

"Unauthorized alteration or addition to a survey map bearing a licensed land surveyor's seal is a violation of section 7209, subdivision 2, of the New York State Education Law."

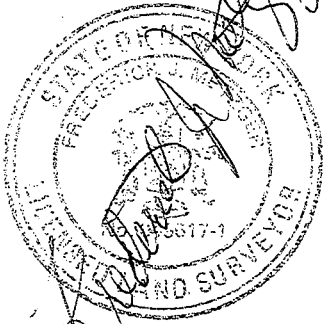

Lands of Richard L. & Ann S. Tubbs (1480/442)

S-61°-51'-44"-W

137.97'

Lands of Edward & Sally A. Rook (2349/777)

N-62°-20'-44"-E

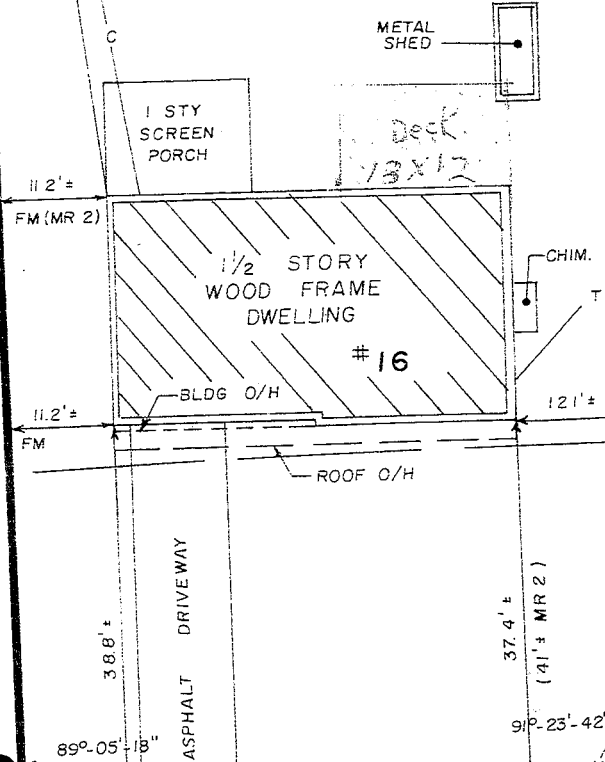

**LEGEND**

- E/T/C/ Ovid. Elec/Tel/Cable lines
- M.R. Map Reference
- D.R. Deed Reference
- F.M. Field Measured
- I.P.F. Iron Pipe Found
- Sc Scaled
- O.H. Overhang
- X X Fence
- P.P. Proposed
- 43 Tax Map Parcel No.

**APPROVED**

R=1335'

L=65'

314.29' TO SOUTHERLY LINE OF THE CROSSWAY (DR1)

MAY 02 1989

**GREENOCK ROAD**

50' WIDE

MAP REFERRED TO BY BUILDINGS INSPECTOR

1. "Map of Kenhook, Town of Bethlehem, by Edward W. Boutelle & Son, last revised Feb. 10, 1953, Filed Feb. 16, 1953 in Drawer 151, Map 3089.
2. "Map of Property of Frank & Augustine Williams - Elsmere", Last revised June 25, 1956, by Edward W. Boutelle & Son.

SURVEY CERTIFIED TO:

FRANK J & CYNTHIA J. BACHER  
PIONEER SAVINGS BANK, ITS SUCCESSORS AND ASSIGNS  
TITLE USA INSURANCE CORPORATION OF NEW YORK  
"Certifications in booklet hereon signify that this survey was prepared in accordance with the ex-