

DIAS

8
LANDS N/F
EDERICK W. & JANE D.
POSSELT

12
LANDS N/F
ORDON & CORNELIA D.
CHAMPAIGNE

15
LANDS N/F
IMES A. & SANDRA S. SMITH

LANDS N/F RONAL

LANDS N/F
ELIZABETH L. BRADT

AREA =
18,956.72 +/- Sq. Ft.

11

9

PENN

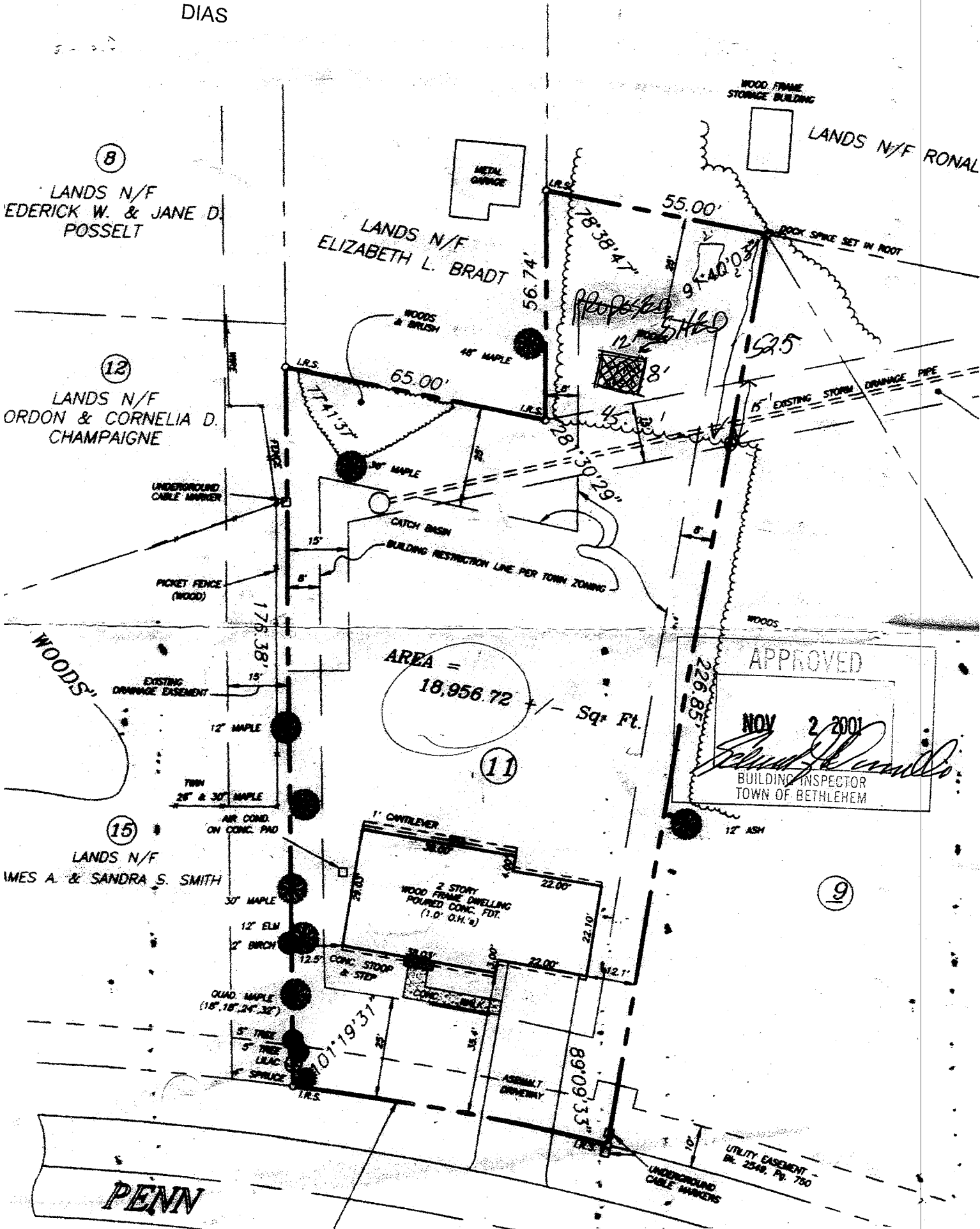

APPROVED
 NOV 2 2001
[Signature]
 BUILDING INSPECTOR
 TOWN OF BETHLEHEM

UTILITY EASEMENT -
 BK. 2549, P. 750