

We hereby certify to Mechanics Exchange Savings Bank and Chicago Title Insurance Company, Home Title Division that the survey shown is correct.

**FONT GROVE ROAD**  
(FORMERLY OLIVER ROAD)

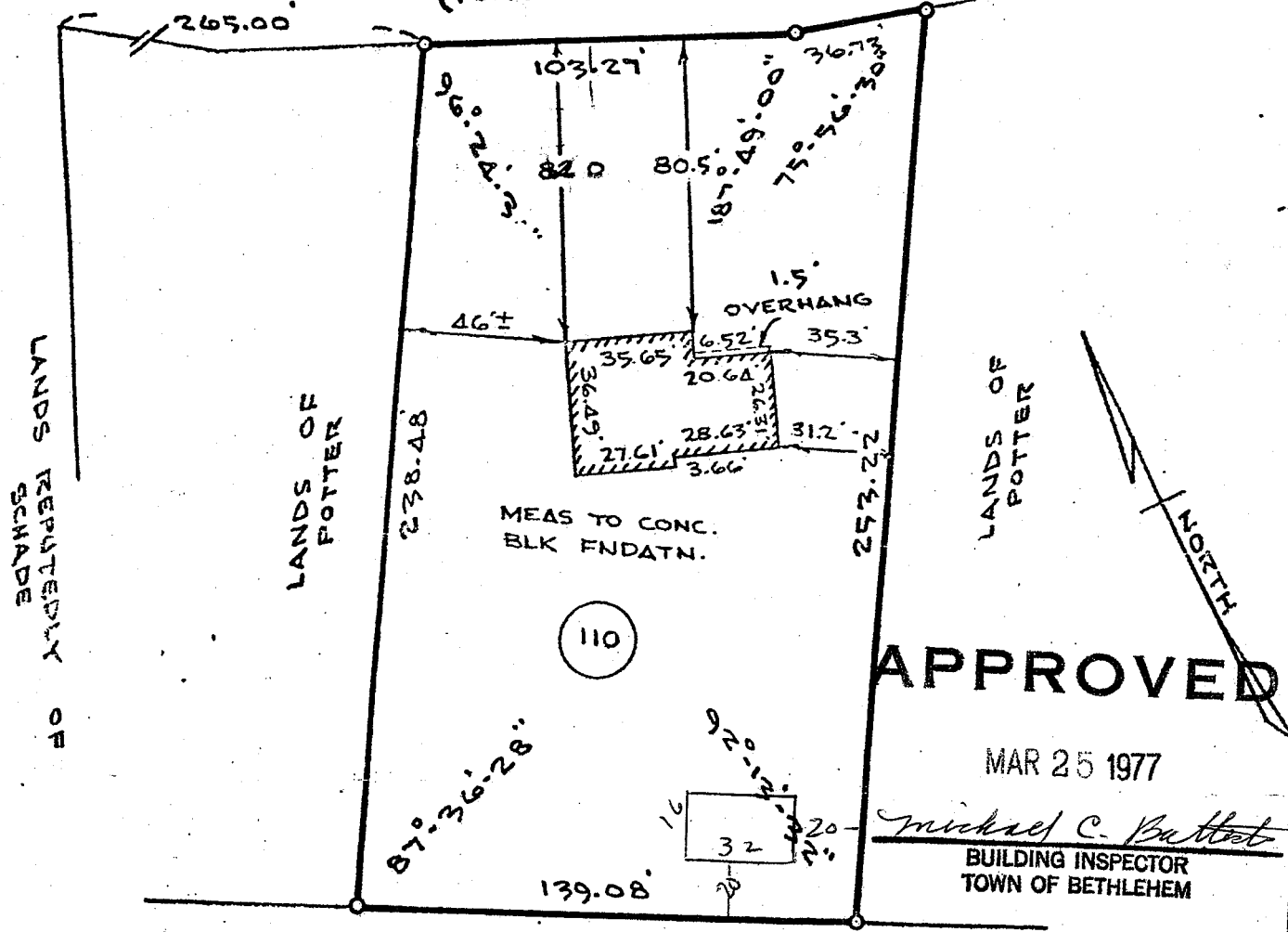

LANDS OF THE DELAWARE AND HUDSON RAILROAD CORP.

*Sindryin Buttel*

REVISED - 7 MAR. 1969  
 CERTIFICATION ADDED  
 REVISED - 26 FEB. 1969  
 OVERHANG ADDED  
 NOTE  
 COMPLETED HOUSE LOCATION

COUNTY	MAP OF PROPERTY OF GLENMONT BUILDING CORP. SLINGERLANDS	SCALE
ALBANY		1" - 50'
STATE	EDWARD W. BOUTELLE AND SON CIVIL ENGINEERS AND SURVEYORS DELMAR, NEW YORK	DATE
NEW YORK		May 10, 1968
ORDER NO.		REVISION
63 - 292		9 SEPT. 1968 HOUSE LOCATED