

WILLOW DRIVE - 50' ROW.  
 ± 135.00' S 09° 11' 40" E

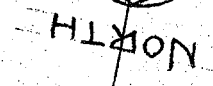
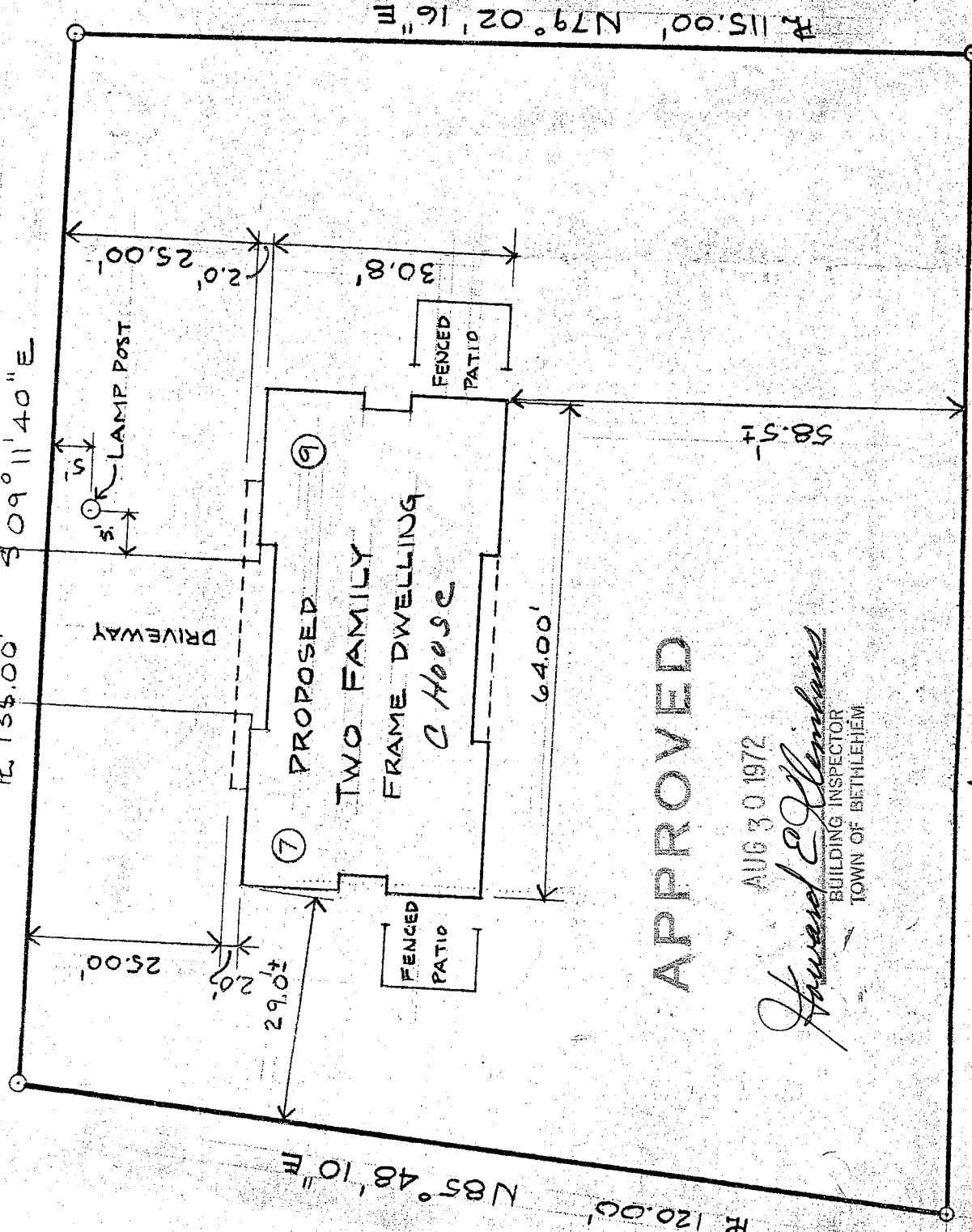

16,780#

APPROVED

AUG 30 1972

*Howard E. Ellman*  
 BUILDING INSPECTOR  
 TOWN OF BETHLEHEM

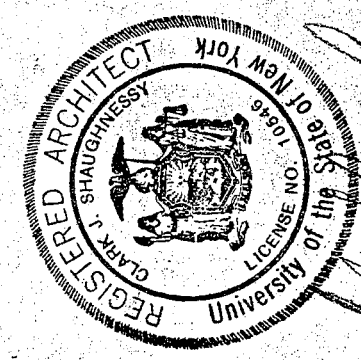

*Clark J. Shaughnessy*

TWO FAMILY FRAME DWELLING  
 WOODGATE

PROPERTY LINE AND BASEMENT DATA  
 TAKEN FROM MAP DATED AUG. 23, 1971  
 AND DRAINAGE MAP DATED AUG. 23, 1971

AUGUST 23, 1972