

Existing 2470[±] Lot 20,280[±]
 8'x16' Addition 128[±] + 20.01 3042[±] Allowable
 2598[±]

Lot = 20,160[±]

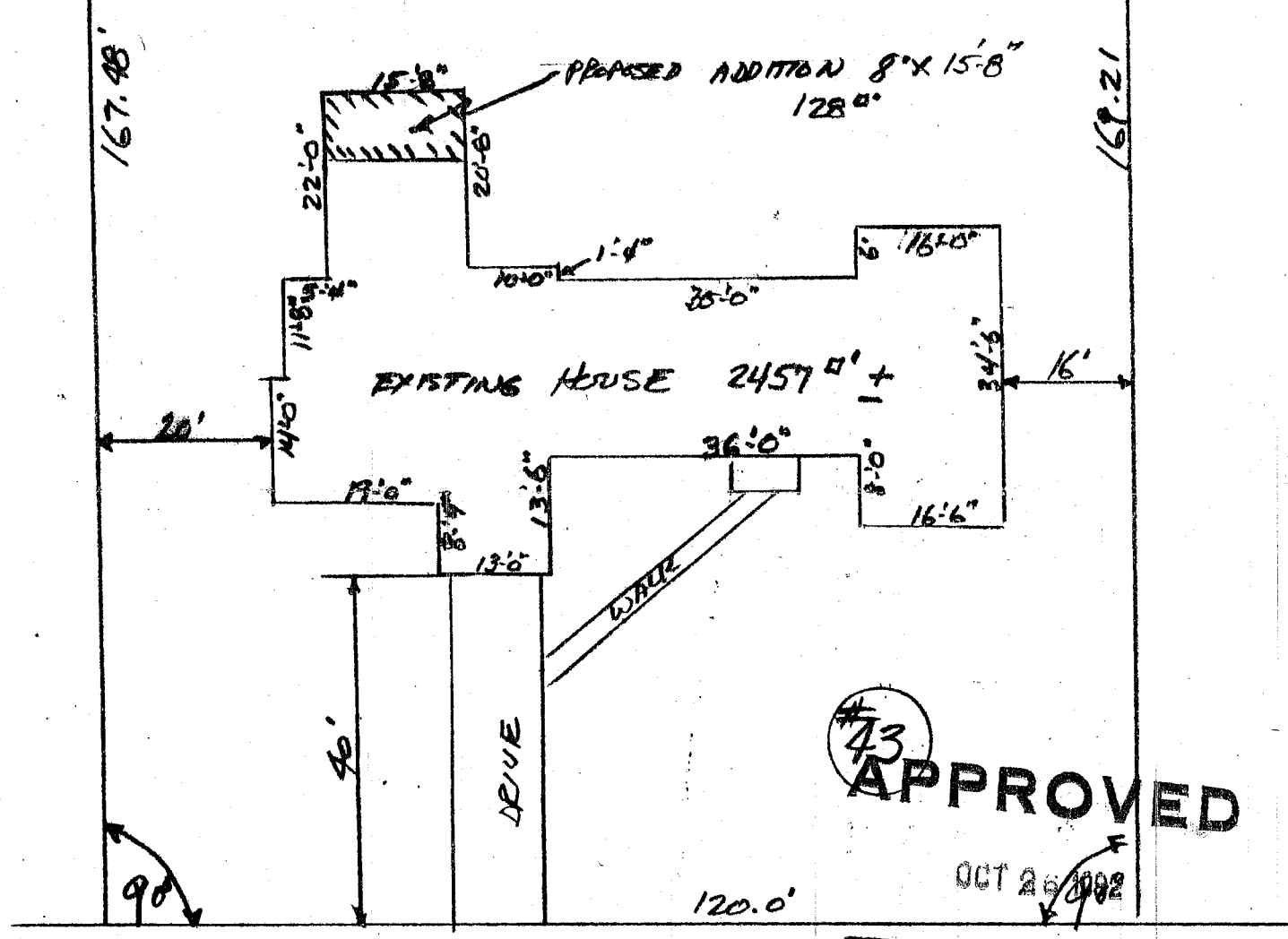

#43
APPROVED
 OCT 26 1982

BUILDING INSPECTOR
TOWN OF BETHLEHEM

DOUGLAS RD.

ALBANY COUNTY	PROPERTY OF	SCALE 1" = 20'
NEW YORK	MR + MRS. ROBERT KUHN	10-21-82
WEWER BROS INC		by JCU