

REFER TO "MAP OF PROPERTY OF T.E. BURHANS," MADE BY NORDIN J. SHAMBROOK, C.E., DATED MAY 1, 1925, AND FILED IN THE OFFICE OF THE ALBANY COUNTY CLERK ON AUGUST 1, 1925. (SEE BOOK 791 of DEEDS at page 471 for restrictive covenants and agreements) AS MAP no.1171 AT DRAWER 53 IN BOOK 53 AND A REVISED MAP FILED JUNE 2, 1926, AS MAP no.11 AT DRAWER 61. IN BOOK 61.

IT IS HEREBY CERTIFIED THAT THIS SURVEY WAS PREPARED IN ACCORDANCE WITH THE EXISTING CODE OF PRACTICE FOR LAND SURVEYORS ADOPTED BY THE NEW YORK STATE ASSOCIATION OF PROFESSIONAL LAND SURVEYORS.

Michael J. Cirillo

TO: MARK D. and PAMELA J. BRODY; EMPIRE OF AMERICA, FEDERAL SAVINGS BANK, ITS SUCCESSORS and ASSIGNS; AMERICAN TITLE INSURANCE COMPANY TITLE NO. 23-4944

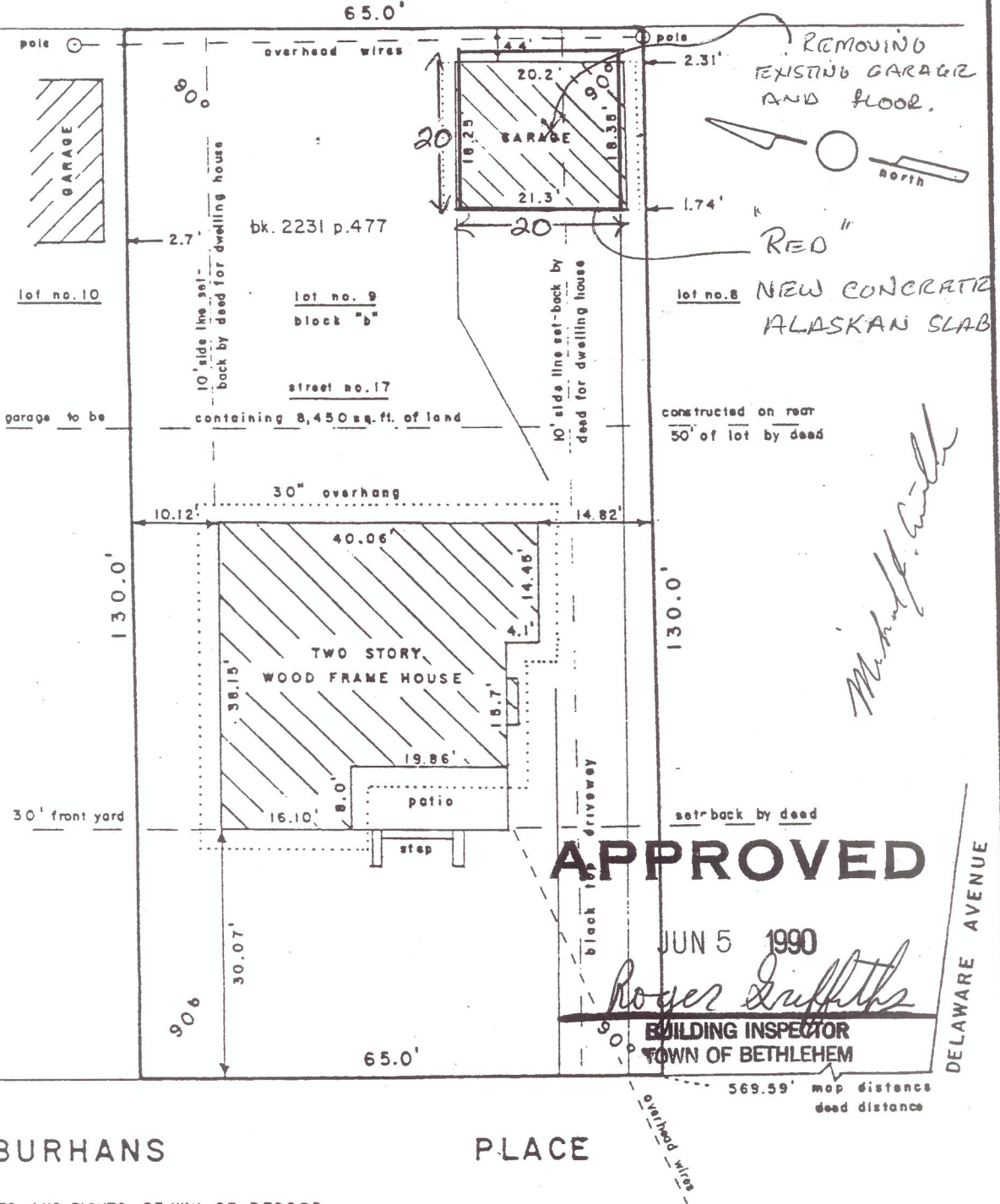

APPROVED

JUN 5 1990

Roger Griffiths

BUILDING INSPECTOR TOWN OF BETHLEHEM

Michael J. Cirillo

BURHANS PLACE

SUBJECT TO EASEMENTS AND RIGHTS OF WAY OF RECORD

COUNTY	Survey of Lands Located at No. 17 Burhans Place Town of Bethlehem	SCALE
STATE		1" = 20"
ORDER NO.		DATE
Albany		Nov. 9, 1982
New York		REVISION
	Survey and Map by Michael J. Cirillo- licensed Land Surveyor	SURVEY UPDATED AUG. 6, 1985

August 23, 1985 added deed set-backs & filing date on map

17 Burhans 17055 permit #