

ED POTTER
34 HARRISON AVE.
ELSMERE, N.Y.

SCALE 1" = 20'

50'

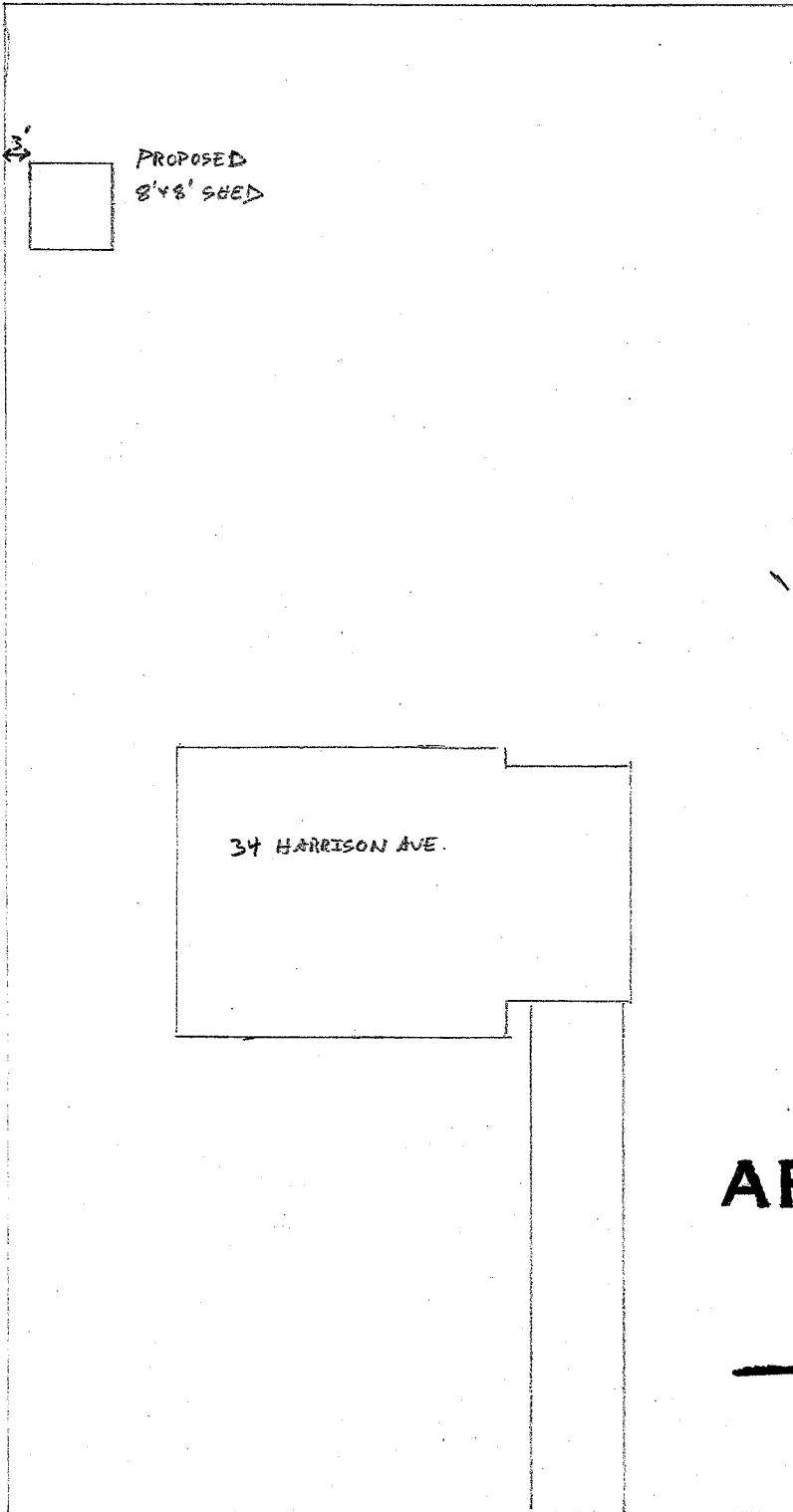

195.63

195.63

34 HARRISON AVE.

HARRISON AVE. 50'

APPROVED

MAY 7 1991

BUILDING INSPECTOR
TOWN OF BETHPAGE

86.13-4-50