

**MAP REFERENCE:**

Lots are as shown on a map entitled, "AMENDED PLAT, LOT LAYOUT, 'COLONIAL WOODLANDS', SECTION No. 1 PHASE I AND II PROPERTY OF KARL A. PAULSEN AND SWIFT DEVELOPMENT CORPORATION", dated May 15, 1991, last revised November 29, 1993, prepared by Edward W. Boutelle and Son, Civil Engineers and Surveyors, A Division of J. Kenneth Fraser and Associates, PE, LS, P.C. and filed in the Albany County Clerk's Office on March 4, 1994 in drawer 172, as map no. 99187 DEC

**CERTIFICATION:**

Survey shown is in accordance with the minimum standards of "Code of Practice for Land Surveys" as adopted by the New York State Association of Professional Land Surveyors.

**CERTIFIED TO:**

1. Hudson River Bank & Trust Company, its successors and/or assigns.
2. Old Republic National Title Insurance Company (Title No. SA-99-1499).
3. William M. O'Connell and Jane M. O'Connell.

**NOTES:**

1. Drainage Rights in Bk. 572, Pg. 271 do not affect surveyed premises.
2. Subject to Drainage Agreement in Bk. 46 of Miscellaneous Records, Pg. 473.
3. Utility easement contained in Bk. 2522, Pg. 744 does not affect surveyed parcel.

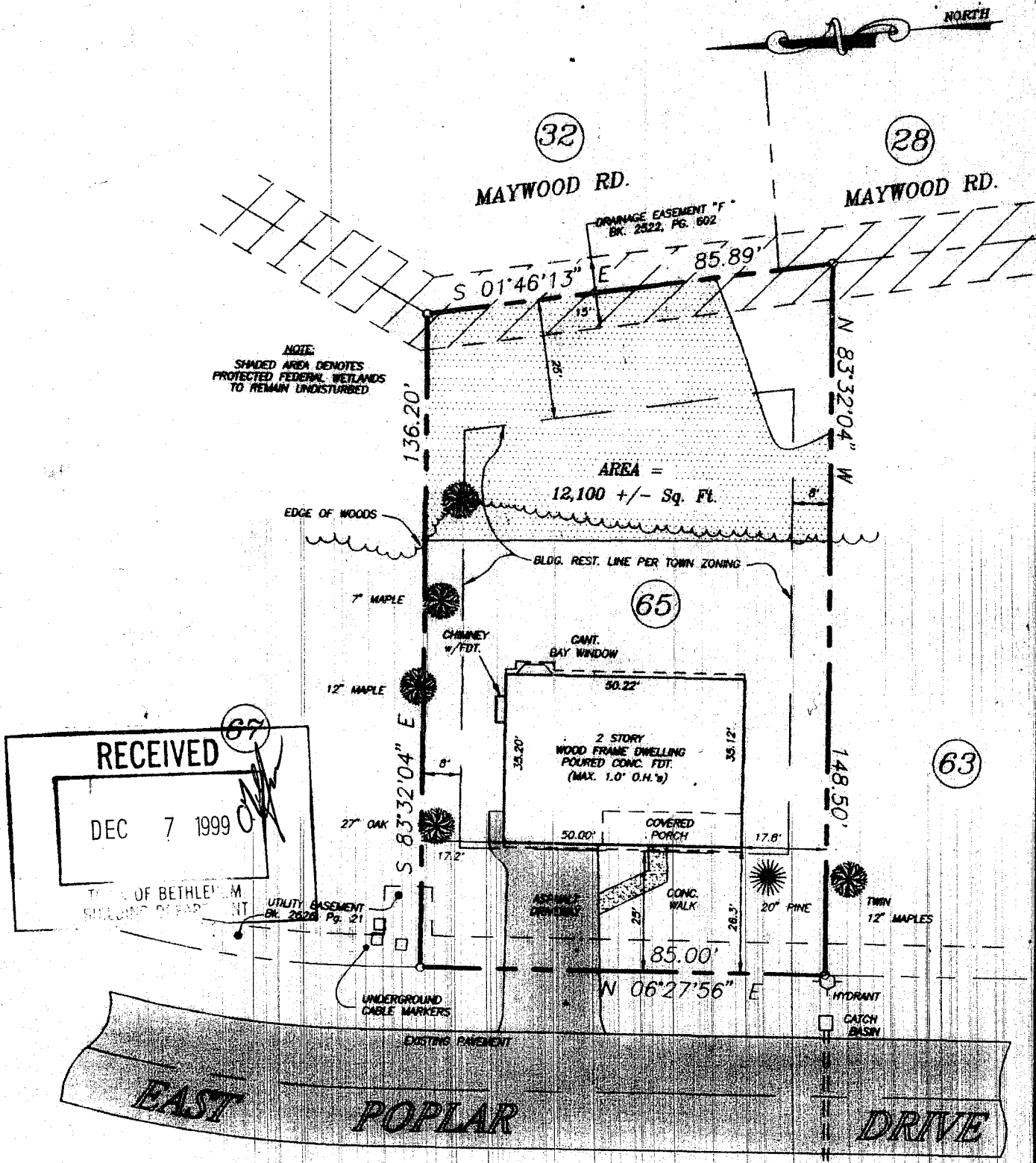

RECEIVED  
 DEC 7 1999  
 TOWN OF BETHLEHEM  
 BUILDING DEPARTMENT



County: ALBANY  
 State: NEW YORK  
 Scale: 1" = 30'  
 Date: DEC 1, 1999

MAP OF SURVEY  
 LOT No. 65  
 EAST POPLAR DRIVE  
 COLONIAL WOODLANDS  
 SECTION No. 1  
 TOWN OF BETHLEHEM  
 PAUL E. HITE  
 Licensed Land Surveyor - Delmar, New York

FB 375, Pg. 61  
 D.d.  
 ROT. 96°15'0.0  
 FMD 47  
 ADCADD 25