

CERTIFIED TO:

1. MAURICE BURKE
2. CHICAGO TITLE INSURANCE COMPANY
3. PROVANTAGE MORTGAGE, INC., ITS SUCCESSORS AND/OR ASSIGNS AS THEIR INTEREST MAY APPEAR

NOTES:

1. SURVEY SHOWN WAS PREPARED FROM AN JUNE 2006 FIELD SURVEY,
2. NO SEARCH OF PUBLIC RECORD WAS MADE IN CONNECTION WITH EASEMENTS OR RESTRICTIONS THAT MAY NOT HAVE BEEN CONTAINED IN COMMITMENT FOR TITLE INSURANCE (TITLE NO. 2603-42045) ISSUED BY CHICAGO TITLE INSURANCE COMPANY ON APRIL 20, 2006.
3. SURVEY SHOWN IS SUBJECT TO ANY SUBSURFACE CONDITIONS THAT MAY EXIST, IF ANY.
4. UNAUTHORIZED ALTERATION OR ADDITION TO A SURVEY MAP BEARING A LICENSED LAND SURVEYOR'S SEAL IS A VIOLATION OF SECTION 7209, SUBDIVISION 2, OF THE NEW YORK STATE EDUCATION LAW.
5. ONLY COPIES FROM THE ORIGINAL OF THIS SURVEY MARKED WITH AN ORIGINAL OF THE LAND SURVEYOR'S EMBOSSED SEAL, AND SIGNATURE IN RED, SHALL BE CONSIDERED TO BE TRUE AND VALID COPIES.
6. CERTIFICATIONS INDICATED OR IMPLIED HEREON SIGNIFY THAT THIS SURVEY WAS PREPARED IN ACCORDANCE WITH THE EXISTING CODE OF PRACTICE FOR LAND SURVEYS ADOPTED BY THE NEW YORK STATE ASSOCIATION OF PROFESSIONAL LAND SURVEYORS. SAID CERTIFICATIONS SHALL RUN ONLY TO THE PERSON OR PERSONS FOR WHOM THIS SURVEY WAS PREPARED, AND ON HIS OR THEIR BEHALF TO THE TITLE COMPANY, GOVERNMENTAL AGENCY AND LENDING INSTITUTION LISTED HEREON, AND TO THE ASSIGNEES OF THE LENDING INSTITUTION. CERTIFICATIONS ARE NOT TRANSFERABLE TO ADDITIONAL INSTITUTIONS OR SUBSEQUENT OWNERS.

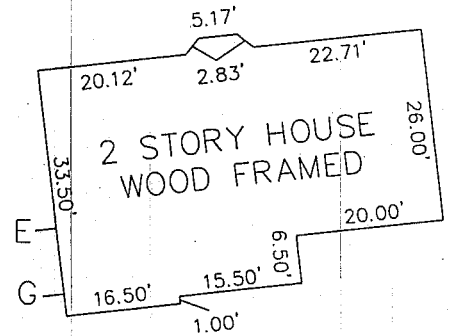

ENLARGED HOUSE PLAN:

SCALE = 1" / 20'

Reduced from 11 x 17

Final OK Date 7/7/06

MAP REFERENCE:

MAP ENTITLED "MILLTOWNE PLAZA SUBDIVISION" DATED FEBRUARY 27, 2002 LAST REVISED OCTOBER 4, 2002 AND PREPARED BY BOSWELL ENGINEERING AND FILED IN THE ALBANY COUNTY CLERK'S OFFICE ON OCTOBER 16, 2002 IN DRAWER NO. 172 AS MAP NO. 11232.

<p>MICHAEL P. WHEELER, L.S. NEW YORK STATE LIC. NO. 49717</p>	<p>MAP OF SURVEY LOT 98-BROOKHAVEN LANE MILLTOWNE PLAZA COUNTY OF ALBANY TOWN OF BETHLEHEM STATE OF NEW YORK</p>						
<p>BOSWELL ENGINEERING 799 MADISON AVE., ALBANY, N.Y. 12208 518-436-6310</p>	<table border="1" style="width: 100%; border-collapse: collapse;"> <tr> <td style="font-size: small;">SURVEYED BY: <u>GRM</u></td> <td style="font-size: small;">CHECKED BY: <u>MPW</u></td> <td style="font-size: small;">DATE: <u>JUNE 14, 2006</u></td> </tr> <tr> <td style="font-size: small;">DRAWN BY: <u>MER</u></td> <td style="font-size: small;">JOB NO. <u>A02-036</u></td> <td style="font-size: small;">DWG NO. <u>LOT_98BROOK_FINAL</u></td> </tr> </table> <p style="text-align: center; font-weight: bold;">SCALE 1" = 40' SHEET 1 OF 1</p>	SURVEYED BY: <u>GRM</u>	CHECKED BY: <u>MPW</u>	DATE: <u>JUNE 14, 2006</u>	DRAWN BY: <u>MER</u>	JOB NO. <u>A02-036</u>	DWG NO. <u>LOT_98BROOK_FINAL</u>
SURVEYED BY: <u>GRM</u>	CHECKED BY: <u>MPW</u>	DATE: <u>JUNE 14, 2006</u>					
DRAWN BY: <u>MER</u>	JOB NO. <u>A02-036</u>	DWG NO. <u>LOT_98BROOK_FINAL</u>					