

Demolition Notes

- Contractor shall visit the site to observe all existing site conditions prior to submitting bid documents.
- Prior to commencing work the contractor shall verify and stake the locations of all underground utilities. It is the responsibility of the contractor to utilize a locating service to verify underground utility locations.
- Contractor shall verify the following: Field Measurements, Field Construction Criteria, Catalogue Numbers, and similar data.
- Contractor shall obtain and comply with all necessary approvals, permits, inspections and certifications prior to and during the course of construction.
- Contractor is responsible to repair or replace all items damaged outside of construction limits, or any items disturbed on the site which are not part of the identified work of this contract. Contractor shall provide proper signs, barricades, fences, to protect the work, property, equipment and persons from damage during all phases of construction.
- Protect all vegetation to remain during all phases of construction. Do not drive vehicles, store equipment, spill liquids or store chemicals below the canopies of existing vegetation to remain. Contractor is responsible for damage to all vegetation and roots outside the construction limit line and within tree protection areas.
- Contractor shall strip, store, and reuse all topsoil from areas to be paved or resurfaced. Provide sediment control fence around base of topsoil stockpile.
- In areas where plant material is proposed on areas of existing pavement, excavate existing soil to a depth of 30" and replace with approved topsoil, coordinate with planting plan.
- All existing material to be salvaged shall be verified by the owner's representative and removed and stored by contractor in a location coordinated with owner. Contractor shall compensate owner for any damage to salvaged materials that occurs during removal, storage or reinstallation.
- All utilities to remain, unless otherwise noted.
- All work in the Public R.O.W shall be coordinated and approved by local, county and state authorities and shall be staged to allow regular uninterrupted traffic flow to the extent possible. All daily traffic and emergency vehicle traffic in the vicinity of the site shall not be impeded.
- Contractor shall take all precautions during construction to minimize damage to the existing 22" Maple and 2" Walnut that are to remain. Excavation around the existing 22" Maple and 2" Walnut shall be performed by hand. Tree roots encountered during excavation shall be hand trimmed with shears to create clean cuts, and exposed root ends must be kept moist until permanent backfill is in place. Excavation and root pruning shall ideally occur during dormancy.
- When practical all saw-cuts into existing concrete shall occur at existing construction or expansion joints.
- All existing storm structures and culverts to remain.
- Contractor to coordinate safe storage location with owner for the (4) trees to be re-planted. Trees are to be cared for according to the standards of the American Association of Nurserymen.
- Re-use as many of the salvaged parking lot signage as possible. Coordinate with owner and Landscape Architect.
- Demolition of the existing garage will involve known asbestos containing building materials (ACBM), approximately 30 sf of dry wall. Prior to any work starting at the project site, an asbestos abatement plan must be submitted to the State Education Department Office of Facilities Planning for review and approval. All work will be done in accordance with Industrial Code Rule #56. (Work to be performed by others).
- At pre-construction meeting, contractor to coordinate with library staff any additional plant material they want saved for re-planting by groundskeepers.
- During demolition of the former homes, the contractor removed the old foundations to a minimum of 18" below grade. Approximately 12" of additional foundation will need to be removed as part of this project in the vicinity of the former homes. Additional foundation material may need to be removed near proposed culvert and catch basin locations, see Grading Plan.
- Trees and large shrubs to be retained shall be balled-and-burlapped and stored in the location shown on the plans. Smaller shrubs can be temporarily transplanted in the area shown. Keep plant material watered until time for transplanting. Mulch-in root balls and root zones if weather gets cold.
- Contractor to avoid operating heavy machinery on Infiltration Trench locations prior to installation. Install construction fencing around areas to protect locations. See Layout Plan.

Legend

- Contract Limit Line
- Pavement Sawcut Line
- Pavement and Subbase for Removal
- Remove Curb and Subbase
- Waterline Removal
- Building pads/ foundations and backfill to be removed
- Remove Gravel/ Stone pavements
- Benchmark
- Remove Tree or shrub
- Tree Protection Fence
- Silt Fence
- Chain Link Construction Fence
- Inlet Protection
- Salvage Item

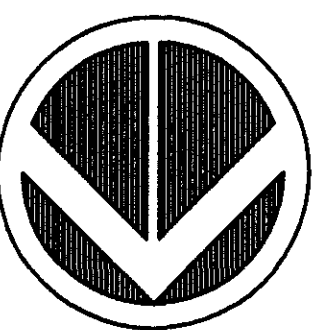

N

GRAPHIC SCALE

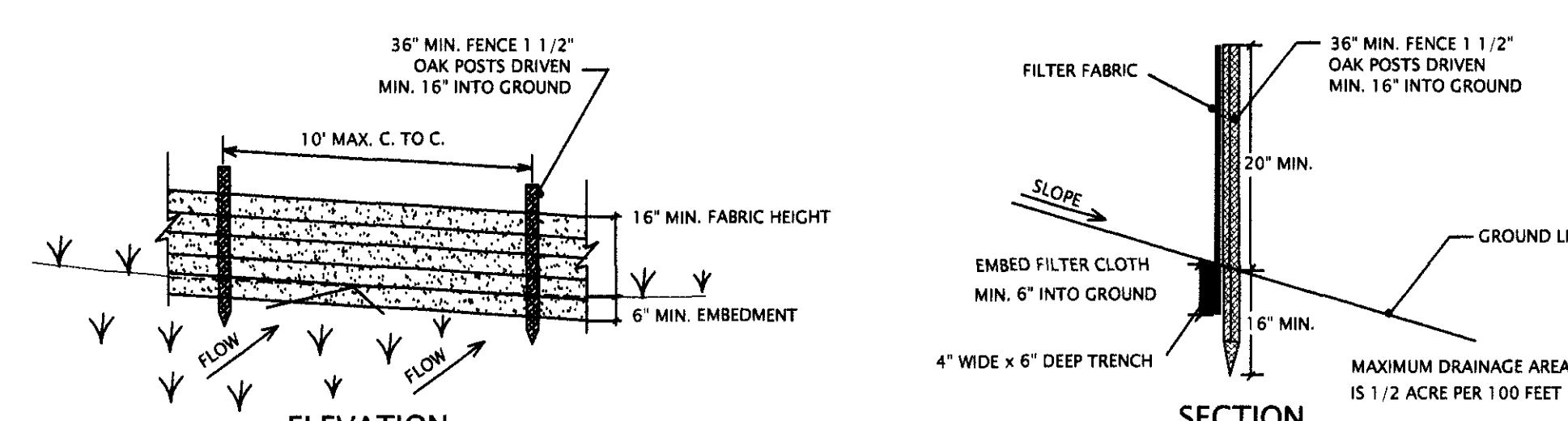
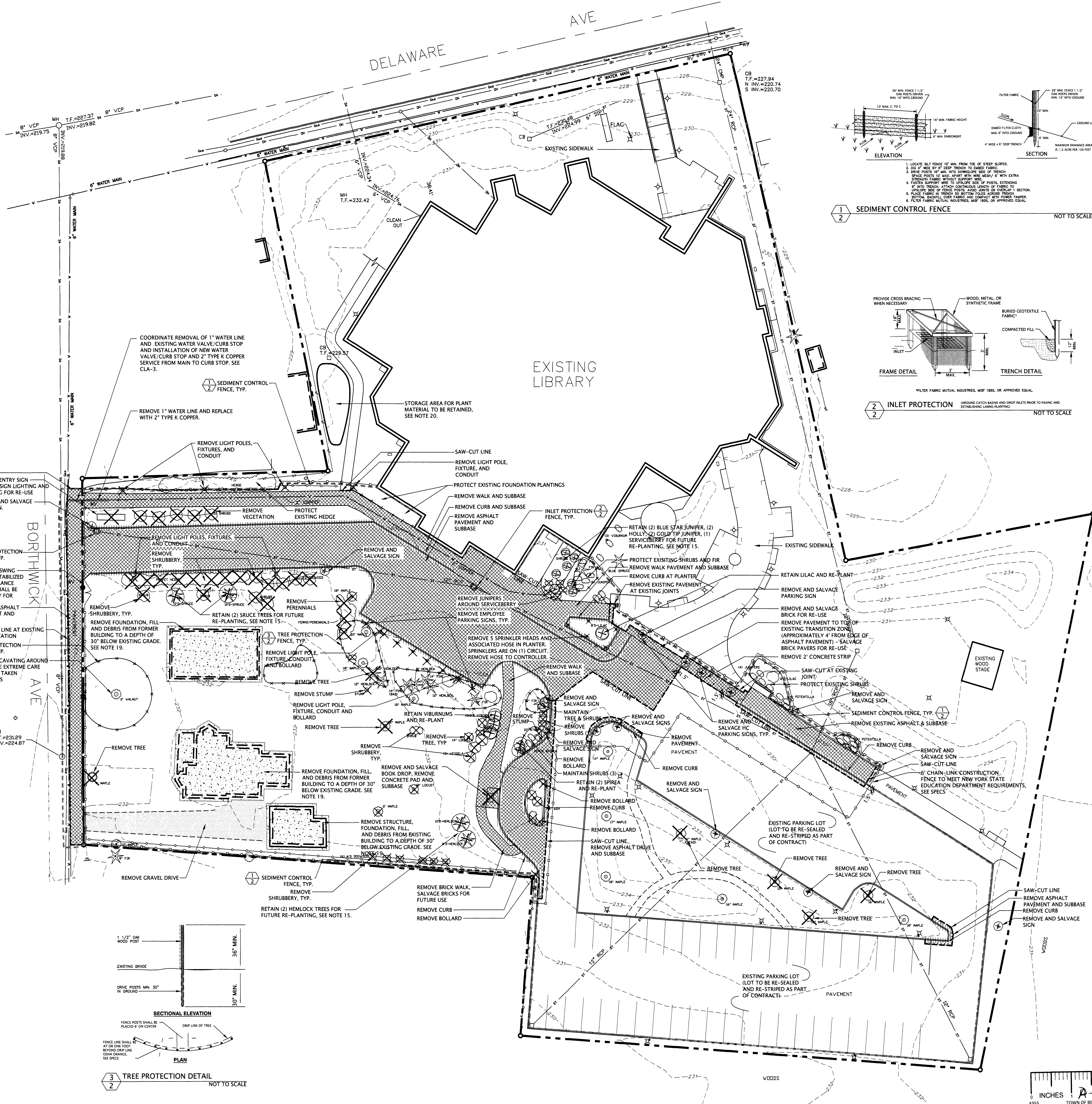
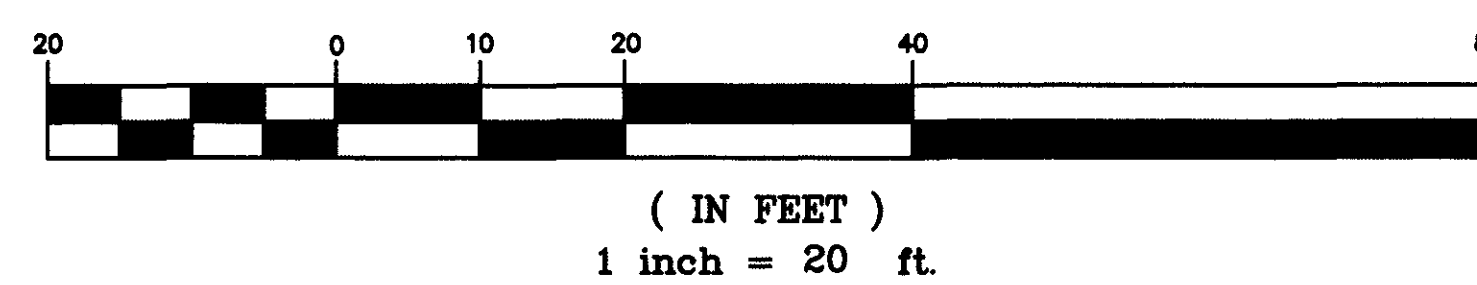

- LOCATE SILT FENCE 10' MIN. FROM TOE OF STEEP SLOPES.
- USE 4" WIDE 10' P. DEEP TRENCH TO SHIELD FENCEPOSTS FROM MIN. AND UNDESIRABLE SIDE IMPACTS. SPACE POSTS 10' MAX. APART WITH WIRE MESH/ 6" WITH EXTRA STRENGTH FABRIC RETAIN SUPPORT WIRE.
- FASTEN SUPPORT WIRE TO UPOURSE SIDE OF POSTS, EXTENDING 4" INTO TRENCH. ATTACH CONTINUOUS LENGTH OF FABRIC TO UPOURSE SIDE OF TRENCH POSTS. ADD ZONE OF FABRIC TO BOTTOM. BRACKET OVER FABRIC AND COMPACT WITH POWER TAMPER.
- USE FABRIC MUTUAL INDUSTRIES, MIF 1855, OR APPROVED EQUAL.

SEDIMENT CONTROL FENCE

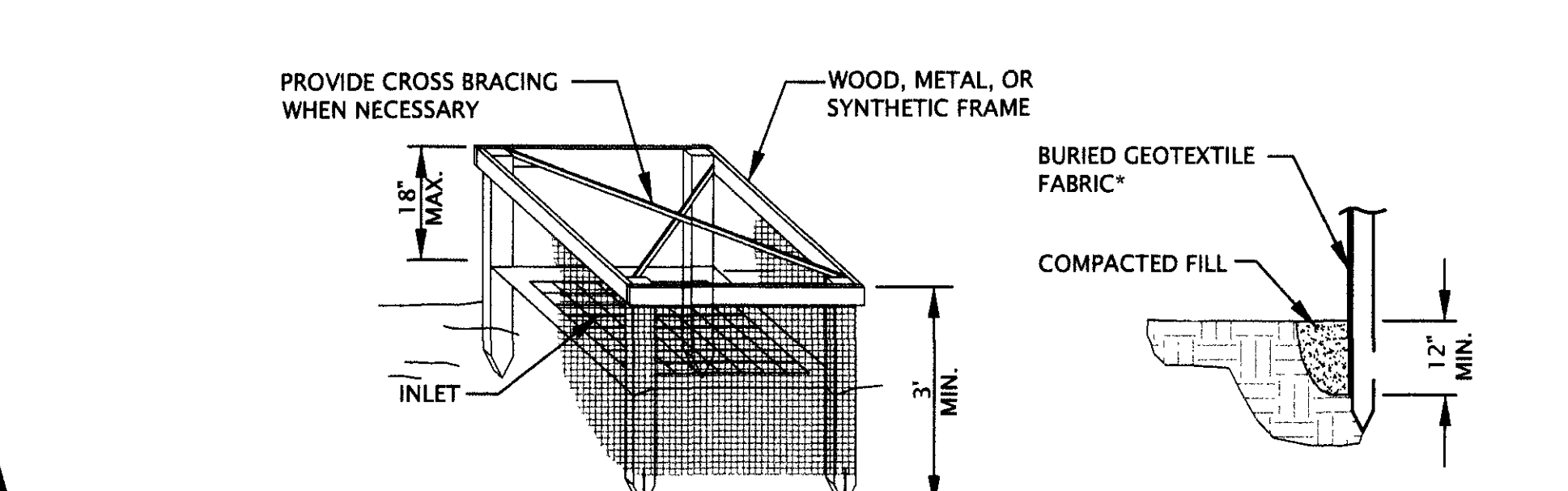

INLET PROTECTION



TREE PROTECTION DETAIL

Date	8-28-08
Checked By	PAL
Drawn By	SEM
REVISION DESCRIPTION	Revisions per NYSED Comments
REVISION NUMBER	1
REVISION DESCRIPTION	Revisions per Bethlehem Library
REVISION NUMBER	2
REVISION DESCRIPTION	Scale Revised
REVISION NUMBER	3
Designed By	PAL
Drawn By	WRS
Checked By	PAL
Approved By	PAL
Filename	
Project No.	80-409
Project Date	08-08-08
BETHLEHEM PUBLIC LIBRARY PARKING AND CIRCULATION IMPROVEMENTS SED CONTROL NO. 01-03-06-06-6-021-007 451 DELAWARE AVENUE DELMAR, NEW YORK	
DEMOLITION PLAN	
Landscape Architecture, Engineering & Planning, P.C. 137 Lorie Ave. Santiago Springs, NY 12864 Phone: 518/584-8661 Fax: 518/584-8661	
Sheet No.	2 of 8
Drawing No.	CLA-2