

B-40

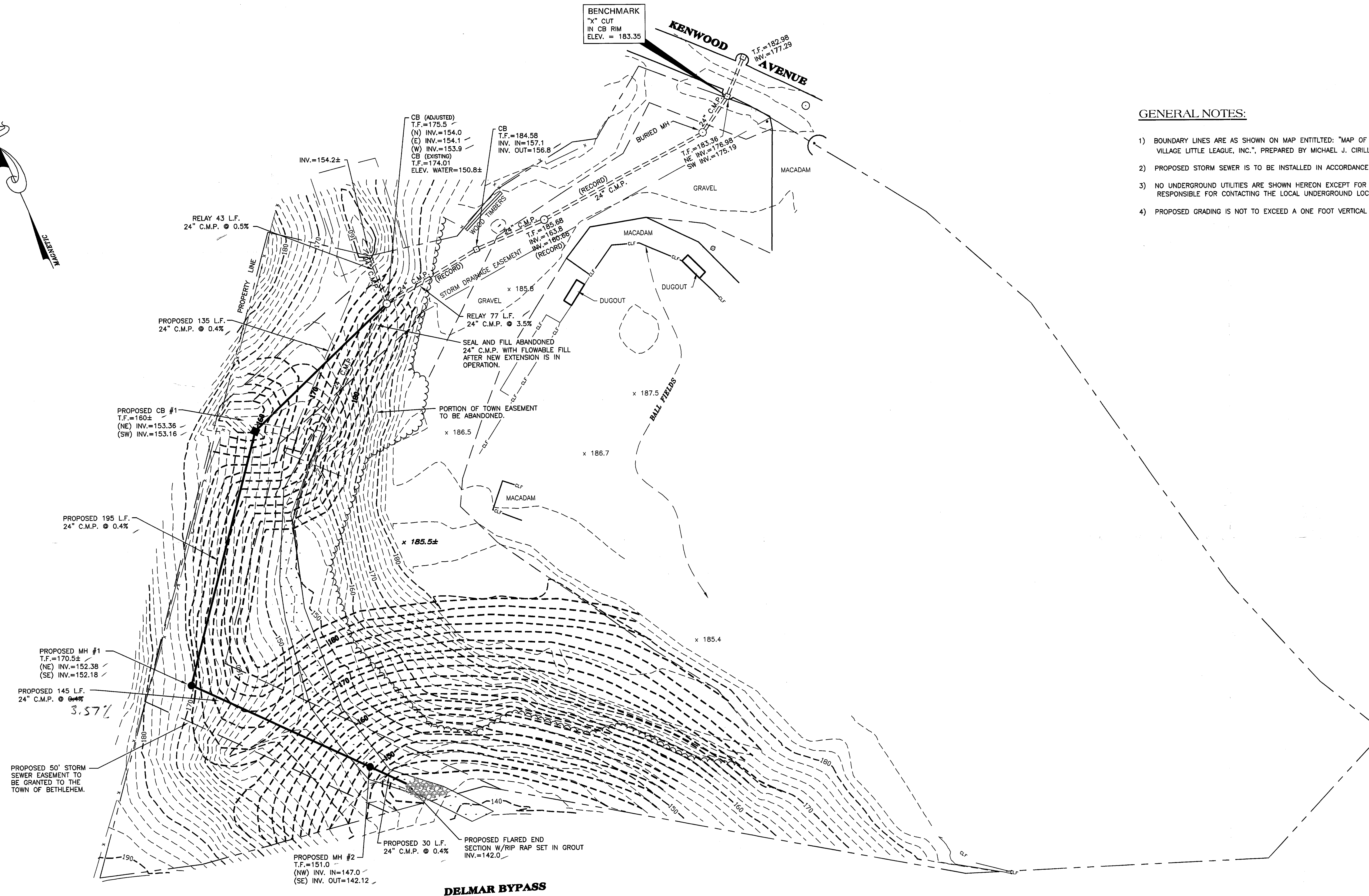

GENERAL NOTES:

- 1) BOUNDARY LINES ARE AS SHOWN ON MAP ENTITLED: "MAP OF SURVEY LANDS OF THE TRI-VILLAGE LITTLE LEAGUE, INC.", PREPARED BY MICHAEL J. CIRILLO, PLS, AND DATED MARCH 17, 1988.
- 2) PROPOSED STORM SEWER IS TO BE INSTALLED IN ACCORDANCE WITH TOWN STANDARDS AND SPECIFICATIONS.
- 3) NO UNDERGROUND UTILITIES ARE SHOWN HEREON EXCEPT FOR THE EXISTING STORM SEWERS. CONTRACTOR IS RESPONSIBLE FOR CONTACTING THE LOCAL UNDERGROUND LOCATION SERVICE PRIOR TO ANY EXCAVATION.
- 4) PROPOSED GRADING IS NOT TO EXCEED A ONE FOOT VERTICAL TO THREE FOOT HORIZONTAL GRADE.

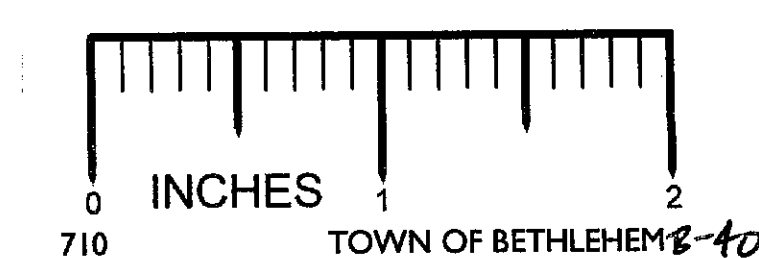

UNAUTHORIZED ALTERATION OR ADDITION TO A SURVEY MAP BEARING A LICENSED LAND SURVEYOR'S SEAL IS A VIOLATION OF SECTION 7209, SUBDIVISION 2 OF THE NEW YORK STATE EDUCATION LAW. ONLY COPIES FROM THE ORIGINAL OF THIS SURVEY MARKED WITH AN ORIGINAL OF THE LAND SURVEYOR'S INKED SEAL OR HIS EMPOWERED SEAL SHALL BE CONSIDERED TO BE VALID TRUE COPIES. CERTIFICATIONS SHALL RUN ONLY TO THE PERSON FOR WHOM THE SURVEY IS PREPARED, AND ON HIS BEHALF TO GOVERNMENTAL AGENCY AND LENDING INSTITUTION HEREON, AND TO THE ADDRESSEE OF THE LENDING INSTITUTION. CERTIFICATIONS ARE NOT TRANSFERABLE TO ADDITIONAL INSTITUTION OR SUBSEQUENT OWNERS.

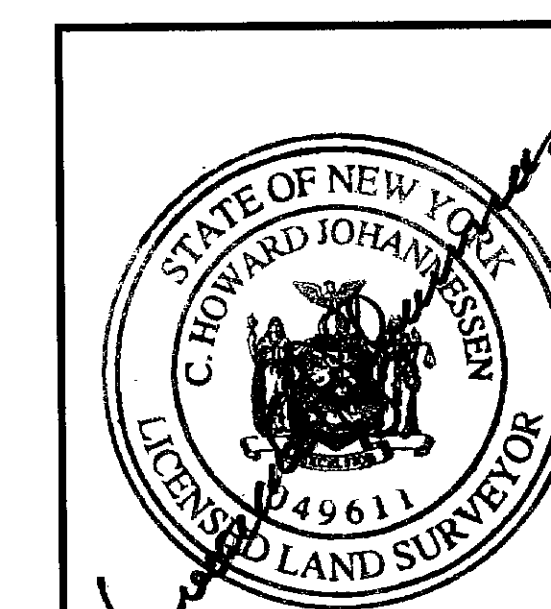

REVISIONS	
DATE	DESCRIPTION
10/22/02	MISCELLANEOUS
10/21/02	MISCELLANEOUS
10/30/02	MISCELLANEOUS

SCALE: 1"=40'
CAD FILE: 2048-100
FIELD BK. 709 PG. 45

TOPOGRAPHIC SURVEY OF A PORTION OF LANDS OF	
TRI-VILLAGE LITTLE LEAGUE, INC.	
TOWN OF BETHLEHEM COUNTY OF ALBANY STATE OF NEW YORK	
PREPARED BY EDWARD W. BOUTELLE & SON CIVIL ENGINEERS AND SURVEYORS A DIVISION OF J. KENNETH FRASER AND ASSOCIATES, P.E., L.S., L.A. P.C. 423 KENWOOD AVE. DELMAR, NEW YORK / (518) 439-9981	
DATE: AUGUST 14, 2002	DRAWING No. 2048-100.DWG

B-40