

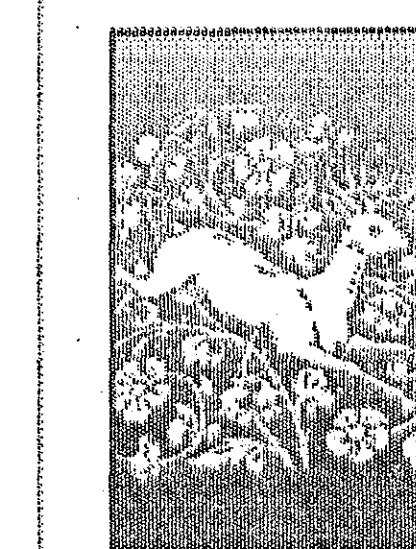

Project



Beverwyck 
Setting the Standard in Independent
Retirement and Assisted Living

PHASE IV COTTAGES

Beverwyck, Inc.
40 Autumn Drive
Slingerlands, New York 12159

Consultants

Civil:
Brett Steenburgh, P.E. P.L.L.C.
2832 Rosendale Road, Niskayuna, NY 12309
Phone: (518) 365-0675

Landscape Architect:
Miller Associates
169 Haviland Road, Queensbury, NY 12804
Phone: (518) 792-4458 Fax: (518) 792-8511

Revisions
REVISED 02-16-0
REVISED 01-30-0

Title

TYPICAL COTTAGE PLANTING PLAN

Do not scale drawings - use dimensions shown, verify all dimensions on site. Unauthorized alterations or additions to this document is a violation of Sec. 7205 Sub. 2 of the NYS Education Law. Copyright 2006 Angeramo Architects, P.C. All right reserved. No use or reproduction of this material is permitted without the express written consent of Angeramo

Drawing Number

L-102

Date: APRIL 17, 2006

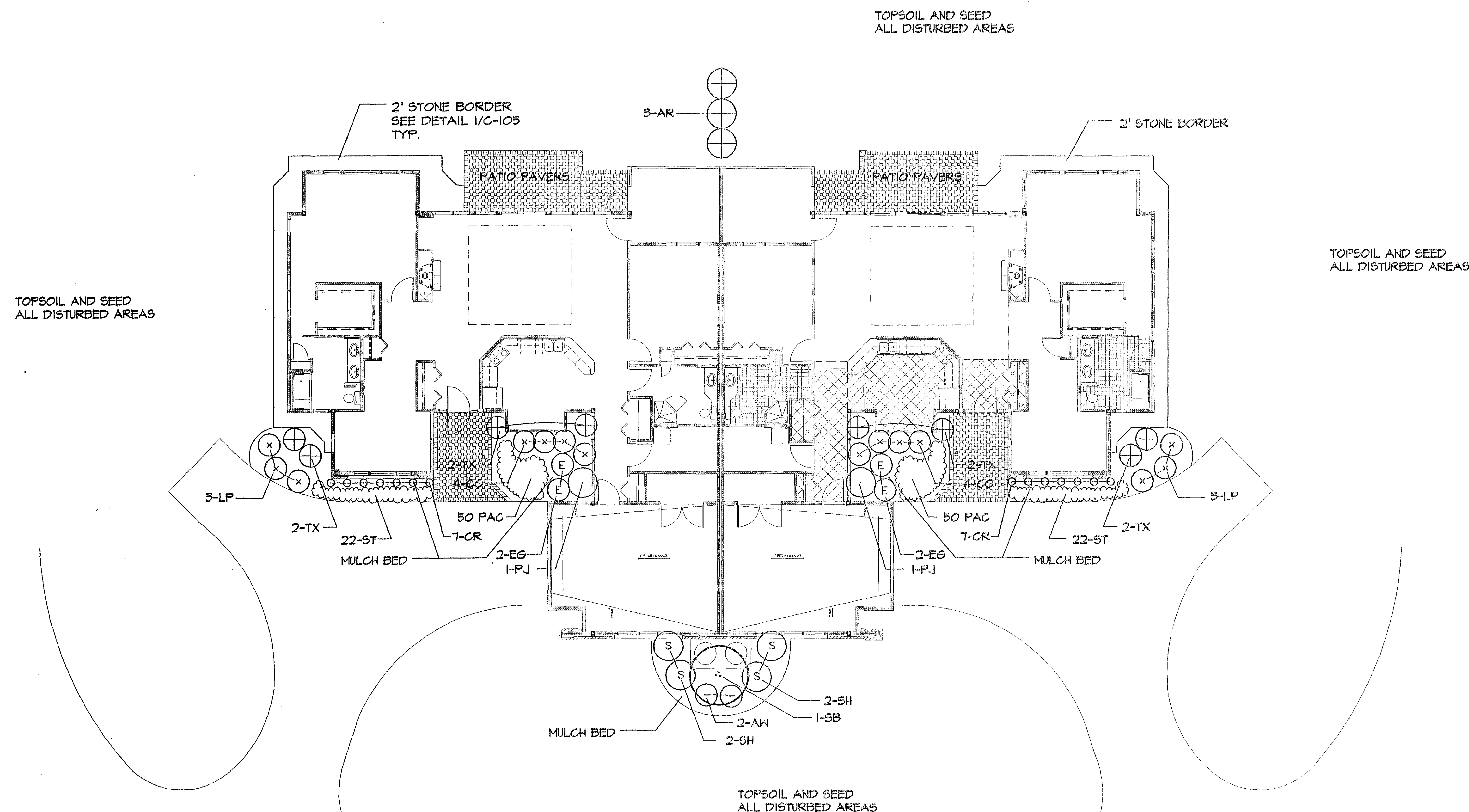

GENERAL NOTES:

1. LOCATE ALL UTILITIES BEFORE STARTING WORK. SEE SPECIFICATION SECTIONS, AND EXISTING SITE SURVEY DRAWING AND OTHER SITE DRAWINGS.
2. PROVIDE ENTIRE MULCH COVERED BED WHEN SHRUBS ARE PLANTED IN GROUPS WITH WIDE BARRIER.
3. PLANT PLANTS OF SAME SPECIES IN HOMOGENOUS GROUPS SPACED TO "CLOSE-IN" TO EACH OTHER IN 3 YEARS.
4. PROVIDE 6" OF TOPSOIL AND SEED TO ALL DISTURBED AREAS BY THE WORK OF THIS CONTRACT.
5. ALL SIZES ARE MINIMUM SIZES AT THE TIME OF PLANTING.
6. CALIPER OF TREES WILL BE MEASURED AT 6" ABOVE GROUND LEVEL.
7. QUANTITIES VERIFIED BY CONTRACTOR - PROVIDE # OF PLANTS AS SHOWN ON PLANS.
8. ALL TREES TO BE PLANTED A MINIMUM OF 10'-0" FROM TOWN OWNED UTILITIES.
9. THE CONTRACTOR SHALL INSTALL 6" TOPSOIL IN LAWN AREAS AND 4" TOPSOIL IN PLANT BEDS AND ROUGH GRADE. THE CONTRACTOR WILL PROVIDE FINE GRADING AND SOIL AMENDMENTS.
10. AREAS INDICATED AS LAWN SHALL BE SEEDDED WITH LOFTS TRIPLEX GENERAL MIX, OR APPROVED MIX, AT A RATE OF 5LBS PER 1000 SF, STARTER FERTILIZER (9-0-5) AT 40 LBS. PER 1000 SF AND MULCHED WITH STRAW OR HYOSSEED.
11. PLANTING SOIL FOR BACKFILL OF NEW PLANTS AND PREPARATION OF PLANT BEDS SHALL BE A MIXTURE OF 1 PART TOPSOIL, 1 PART COMPOSTED MANURE, 1 PART RENT HULDS AND 5 LBS PER TON FERTILIZER AT 1 LB PER 200 SF.
12. MULCH FOR TREES AND SHRUBS SHALL BE COARSE SHREDDED BARK, FREE OF WOOD CHIPS, LEAVES OR OTHER UNACCEPTABLE MATERIAL.
13. MULCH FOR PERENNIALS SHALL BE FINE SHREDDED BARK, FREE OF WOOD CHIPS, LEAVES OR OTHER UNACCEPTABLE MATERIAL.

PLANT LIST AND KEY

KEY	COMMON NAME	SCIENTIFIC NAME	SIZE	REMARKS
WB	JACQUEMONTI WHITE BIRCH	BETULA JACQUEMONTII	8 - 10' HT	B & B, CLUMP
CP	ARISTOCRAT GALLERY FEAR	PRYUS CAL. ARISTOCRAT	3 - 5.5' GAL	B & B
AM	AMUR MAPLE	ACER GINNALA	8 - 10' HT	B & B
SB	SHADBLow	AMELANCHIER CANADENSIS	5 - 6' HT	B & B, MULTI-STEM
AR	DARK AM. ARBORVITAE	THUJA OCCIDENTALIS NIGRA	4 - 5' HT	B & B
FV	COMP. FRAGRANT VIBURNUM	VIBURNUM GR. COMFACTA	18 - 24"	B & B
TX	DENSE JAPANESE YEN	TAXUS CUS. DENSIFORMIS	18 - 24"	B & B
AW	ANTHONY WATERER SPIREA	SPIREA BUN. ANTHONY WATERER	3 GAL	CONTAINER GROWN
EG	EMERALD GAITY EUONYMUS	EUONYMUS FORT. EMERALD GAITY	18 - 24"	CONTAINER GROWN
PJ	PJM RHODODENDRON	RHODODENDRON PJM	30 - 36"	B & B
CC	CRANEBERRY COTONEASTER	COTONEASTER APICULATA	15 - 18"	B & B
SH	COMPACT SHAMROCK INKERRY	ILEX GLABRA COM. SHAMROCK	18 - 24"	CONTAINER GROWN OR B & B
LP	SPIREA JAP LITTLE PRINCESS	LITTLE PRINCESS SPIREA	15 - 18"	CONTAINER GROWN
PB	CRIMSON PIGMY BARBERRY	BERBERIS TH. CRIMSON PIGMY	15 - 18"	CONTAINER GROWN
PAC	JAPANESE FACHYSANDRA	FACHYSANDRA TERMINALIS	RG	PLANT 8' oc
ST	STELLA D' ORO DAYLILY	HEMEROCALLIS STELLA D' ORO	1 GAL	
CR	CLOUDLAND RHODODENDRON	RHODODENDRON IMPEDITUM	12-18"	B & B

HT.=HEIGHT, SP.=SPREAD, CAL.=CALIPER, B*B=BALLED & BURLAPPED, BR=BARE ROOTED, RC= ROOTED CUTTINGS
N=NURSERY GROWN, PL.=PLANTATION GROWN, CONT.=CONTAINER GROWN
*=PROVIDE MALES INSIDE FENCE AND IN COURTYARDS

TYPICAL COTTAGE PLANTING PLAN

SCALE: 1" = 10'-0"

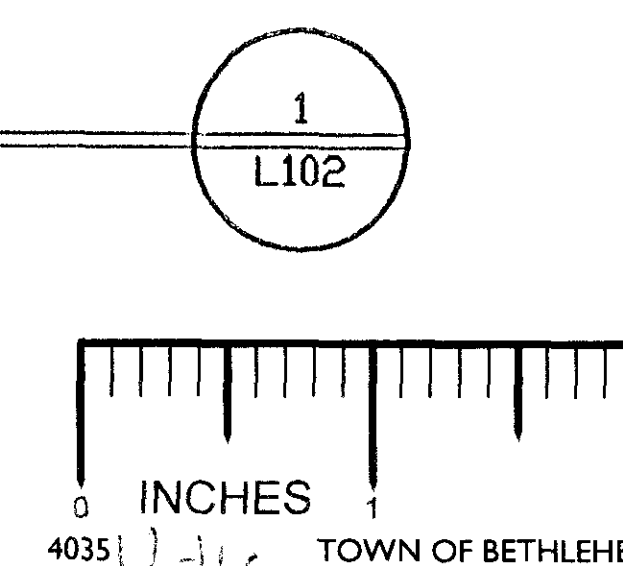

PLANNING BOARD
TOWN OF BETHLEHEM
ALBANY COUNTY, NEW YORK

This plan APPROVED Subject to such
conditions as are stated in Building
Project Approval (BPA)

No. B22 Dated 3-7-06
Consent of Parker D. Mathusa
Title Chairman
Date 3-16-06