

- ~ NOTES ~
- 1 - SANITARY SEWER SHOWN DESIGNED BY J.K. FRASER AND ASSOCIATES FOR BETHLEHEM SEWER DISTRICT JUNE 1977.
 - 2 - PROPOSED FINISHED GRADE SHOWN THUS: 218.17
 - 3 - ALL EASEMENTS TO BE GRANTED TO TOWN OF BETHLEHEM, UNLESS OTHERWISE NOTED.
 - 4 - ELEVATIONS REFER TO U.S.G.S. DATUM, BENCH MARK-TOP NUT POINT OF ARROW ON HYDRANT AT INTERSECTION OF MURRAY AVENUE AND WOODMONT DRIVE, EL. 223.66 FEET.
 - 5 - LOT NUMBERS TO BE USED AS STREET NUMBERS.
 - 6 - WATER MAIN SIZE AND LOCATION DETERMINED BY BETHLEHEM WATER DISTRICT, SHOWN THUS: W
 - 7 - SANITARY SEWER M.H. COVERS TO BE SET 0.30' BELOW FINISHED GRADES SHOWN.
 - 8 - ALL STRUCTURES CONTAINING PIPES OVER 24" DIA. MUST BE AT LEAST 5'-0" I.D.
 - 9 - □ - DENOTES INLET STRUCTURE
○ - DENOTES MANHOLE
 - 10 - COUNTOUR INTERVAL 5 FEET
 - 11 - W.V. - WATER VALVE

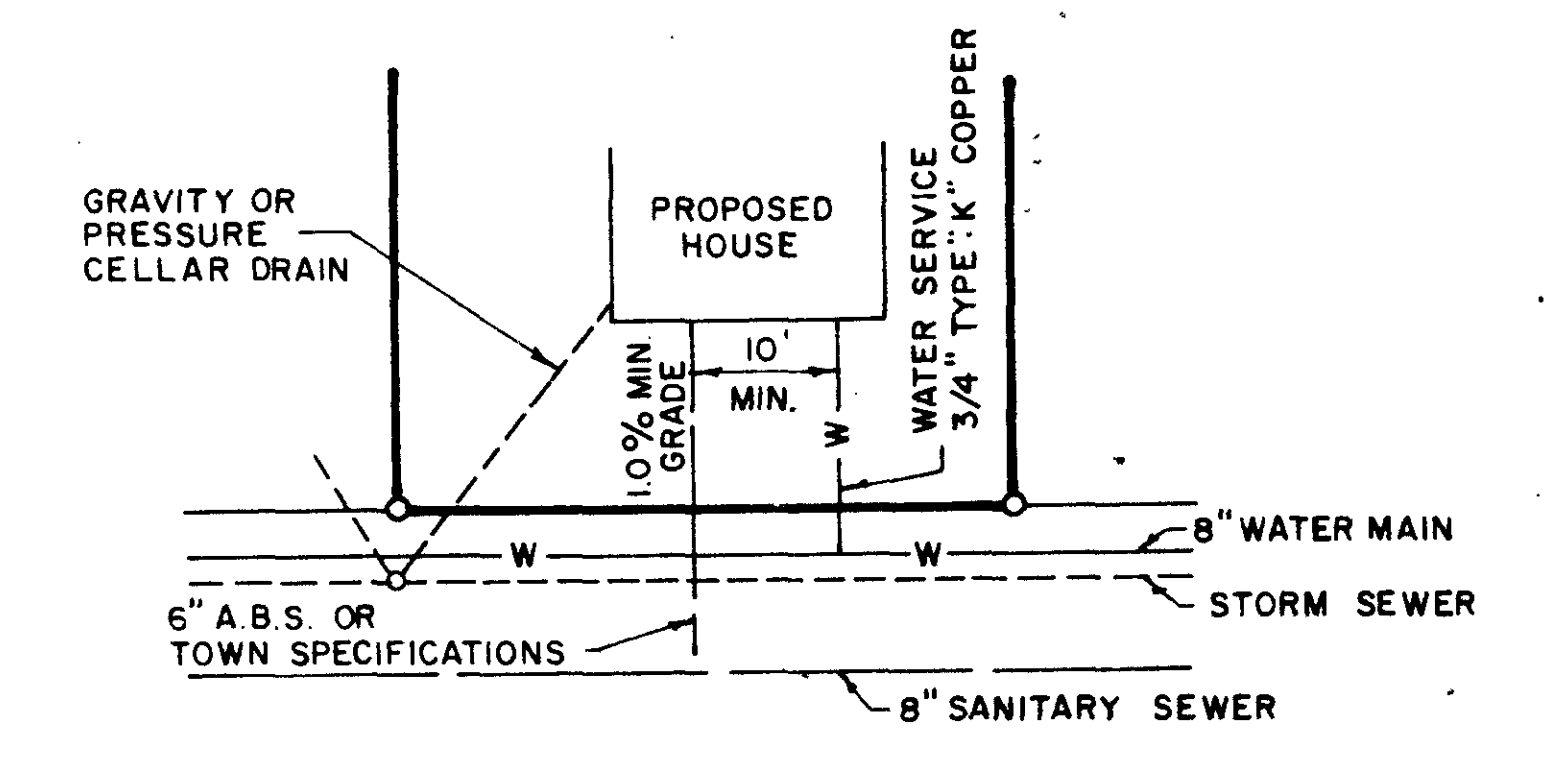

PLAN
SCALE 1" = 50'

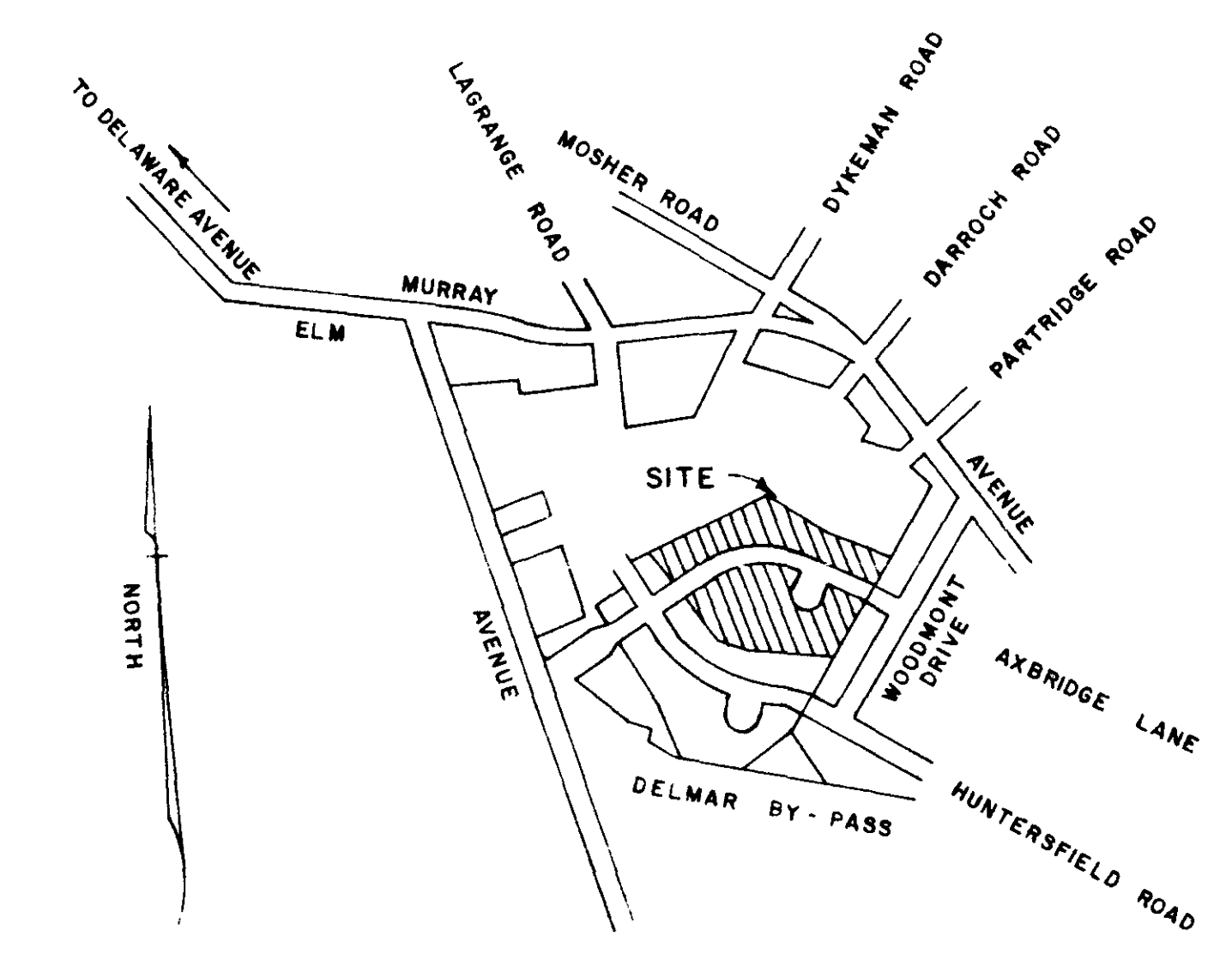
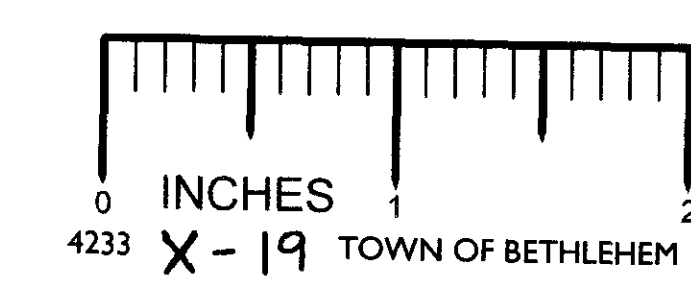

MAP OF
SECTION 2

**WESTCHESTER WOODS
EXTENSION NO.1**

PROPERTY OF
KLERSY BUILDING CORP.

TOWN OF BETHLEHEM

ALBANY CO. NEW YORK

SCALES AS SHOWN JUNE 27, 1974

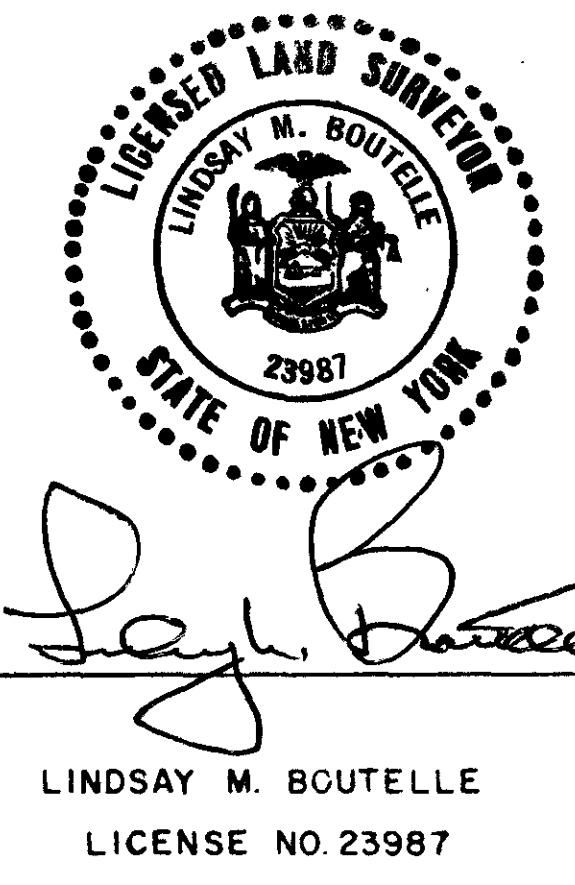

PLANNING BOARD APPROVAL
TOWN OF BETHLEHEM
ALBANY COUNTY, NEW YORK

FINAL PLAT APPROVAL

When signed by the duly authorized officer of the Planning Board, this endorsement constitutes final approval of this Plat.

Signed William F. Weber

Title CHAIRMAN

Date JUN 6 1978

See also Certificate of Approval of Final Plat No. 160-R

ALBANY COUNTY HEALTH DEPARTMENT APPROVAL

ALBANY COUNTY DEPARTMENT OF HEALTH

This is to certify that the proposed arrangements for water supply and sewerage for Westchester Woods Extension No. 1 are approved subject to the conditions listed in letter of this date, and in accordance with Article X of the Albany County Sanitary Code. Consent is hereby given for the filing of this map in the Office of the Albany County Clerk.

Date MAY 31 1978 Commissioner of Health

Richard M. Merson Dir. Div. Environmental Health Services

SURVEY AND MAP BY
EDWARD W. BOUTELLE AND SON
CIVIL ENGINEERS
SURVEYORS
DELMAR
N.Y.

REVISED AUG
REVISED JAN.
WATER LINE C/I